

FED. RD. DIV. NO.	STATE	PROJECT	FISCAL YEAR
2	OHIO		1946

1/21

LUCAS COUNTY  
S.H.697 SEC. TOLEDO (PT.) & MAUMEE (PT.)  
& TOLEDO (PT.)

STATE OF OHIO  
DEPARTMENT OF HIGHWAYS

TOLEDO - WATERVILLE ROAD  
S.H.697 SEC. TOLEDO (PT.) & MAUMEE (PT.)  
LUCAS COUNTY  
CITY OF TOLEDO AND VILLAGE OF MAUMEE

CONVENTIONAL SIGNS

STATE LINE	-----
COUNTY LINE	-----
TOWNSHIP LINE	-----
SECTION LINE	-----
CENTER LINE	-----
PROPERTY LINE	-----
CITY OR VILLAGE LINE	-----
FENCE LINE	-----
STEAM RAILROAD	-----
ELECTRIC RAILROAD	-----
POLE LINE	-----
GUARD RAIL	-----
DRAIN PIPE, NEW	-----
DRAIN PIPE, OLD	-----

INDEX OF SHEETS

TITLE SHEET	SHEET 1
TYPICAL SECTION	2
PLAN AND PROFILE	4-20
GENERAL NOTES	21
CURB INLET DETAILS	21
MONUMENT DETAILS	3
APPROACH DETAILS	3
PAVEMENT COMPUTATIONS	3
GENERAL SUMMARY	3

LINE DATA

Begin Sec. Toledo (Pt.) and Project	Sta. 53+20.86
End Sec. Toledo (Pt.)	Sta. 279+45.83
Sec. Toledo (Pt.) Gross Length	22,624.97 lin. ft.
Deduct for P.F. Sta. 96+01.00 to Sta. 96+10.92	984 lin. ft.
Net Length	22,615.13 lin. ft.
	or 4.283 Miles
Begin Maumee (Pt.)	Sta. 279+45.83
End Maumee (Pt.) & Project	Sta. 293+50.00
Sec. Maumee (Pt.) Net Length	1,404.17 lin. ft.
	or 0.265 Miles
Net Length of Project	24,019.30 lin. ft.
	or 4.549 Miles

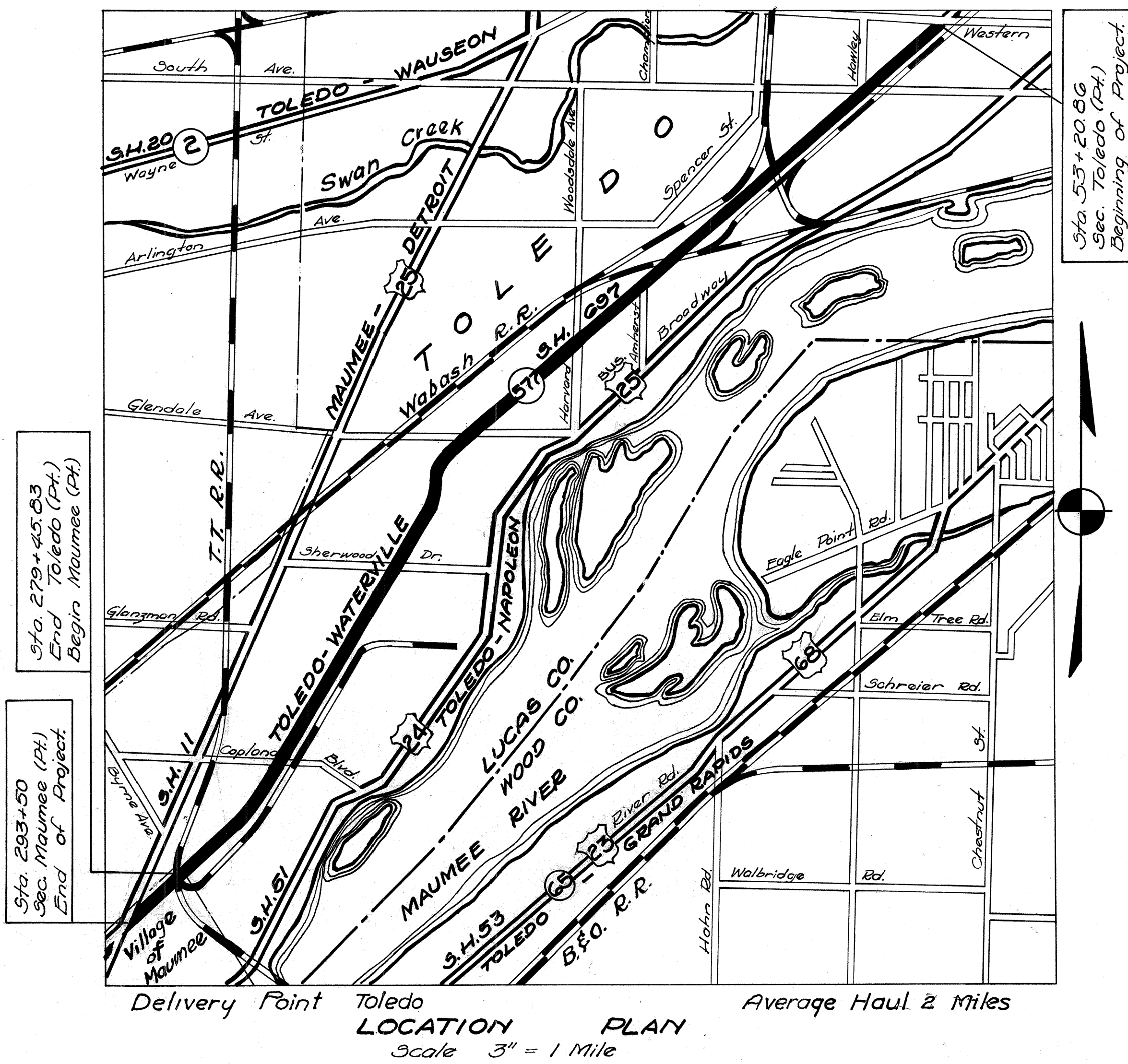

PORTION TO BE IMPROVED  
STATE HIGHWAYS  
OTHER HIGHWAYS

STANDARD DRAWINGS	
6-7-07	6-1-42
I-12	7-1-42
I-1, 2, 3, 4, & 5	2-20-45
B-7-50-70-71 EN#1	12-1-43

SCALES	
Plan	1" = 50'
Profile - Vertical	1" = 5'

SUPPLEMENTAL SPECIFICATIONS	
T-171.19	5-10-46
177	Rev. 4-21-44

The Standard Specifications of The State of Ohio, Department of Highways, including Changes and Supplemental Specifications listed in the proposal shall govern this improvement.

I hereby approve these plans and declare that the making of this improvement will not require the closing to traffic of the highway and that traffic will be maintained as shown on the Plans and Estimates.

The Right-of-Way necessary for this improvement will be provided by The State of Ohio.

Approved Arnold V. Finch  
Date 4/17/46 Assistant to the Chief Engineer.

Approved \_\_\_\_\_  
Date \_\_\_\_\_ Chief Engineer, Bureau of Maintenance.

Approved \_\_\_\_\_  
Date \_\_\_\_\_ Chief Engineer, Bureau of Bridges & R.R. Crossings.

Approved Charles E. Crable  
Date 5-28-46 Chief Engineer, Bureau of Location & Design.

Approved Edison W. Collopy  
Date 5-28-46 First Asst. Director & Chief Engineer.

Approved Perry J. Ford  
Date 5-28-46 Director of Highways.

File No.	Lucas Co. S.H.697 Sec. Toledo (Pt.) & Maumee (Pt.)
DATE OF LETTING	194
CONTRACT NO	

CONSTRUCTION BUREAU  
JUL 5 1955  
GROUND PHOTOLAB

ITEM	QUAN.	UNIT	DESCRIPTION
E-1	136	Cu. Yds.	Roadway Excavation (Unclassified)
E-8	155	Sq. Yds.	Removal & Disposal of existing Concrete Pavement
E-8	94	Sq. Ft.	Removal & Disposal of existing 4" Conc. Sidewalk
E-8	207	Lin. Ft.	Removal for Re use of existing Stone Curb
E-8	131	Lin. Ft.	Removal and Storage of Existing Stone Curb
E-9	1	Ea.	Removal of Trees & Stumps
I-4	380	Lin. Ft.	6" Pipe Underdrains (for Curb)
I-11	207	Lin. Ft.	Stone Curbs Re-set
I-12	114	Lin. Ft.	Concrete Curbs Type 2-B
I-13	44	Sq. Ft.	4" Concrete Sidewalks
E-8	68	Sq. Yd.	Removal & Disposal Existing Wearing Surface
B-70	258	Sq. Yds.	8" Portland Cement Concrete Base Course
T-30	226	Sq. Yds.	Bituminous Tack Coat
B-35	226	Sq. Yds.	1 1/2" Asphaltic Concrete Leveling Course
T-35	226	Sq. Yds.	1" Asphaltic Concrete Surface Course

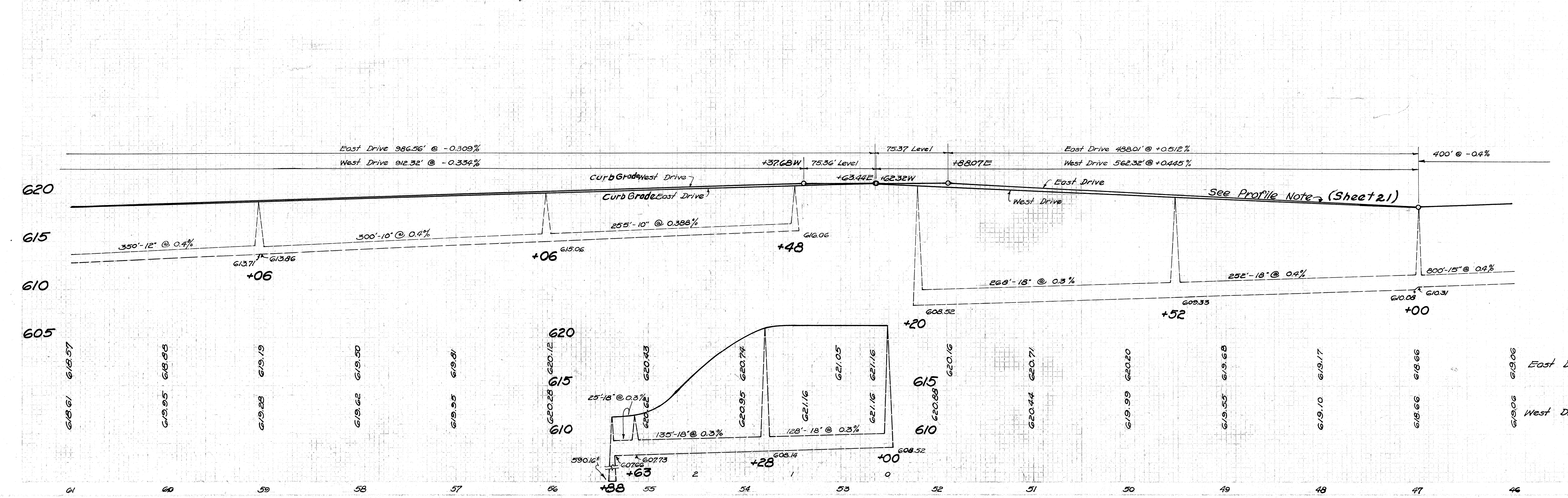
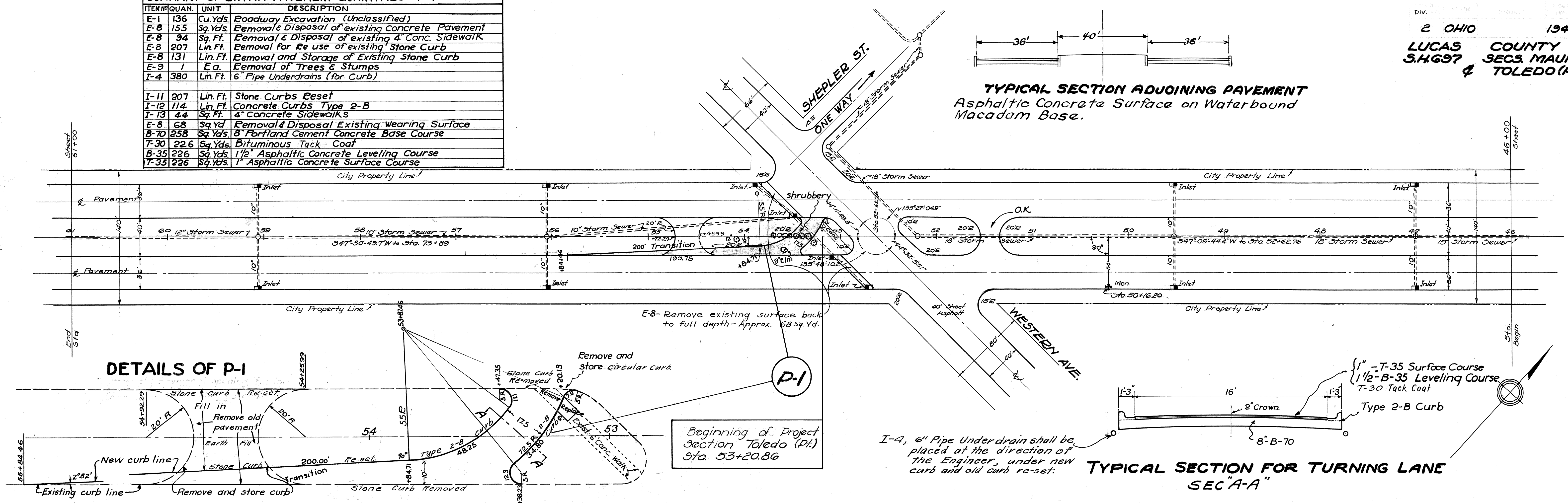

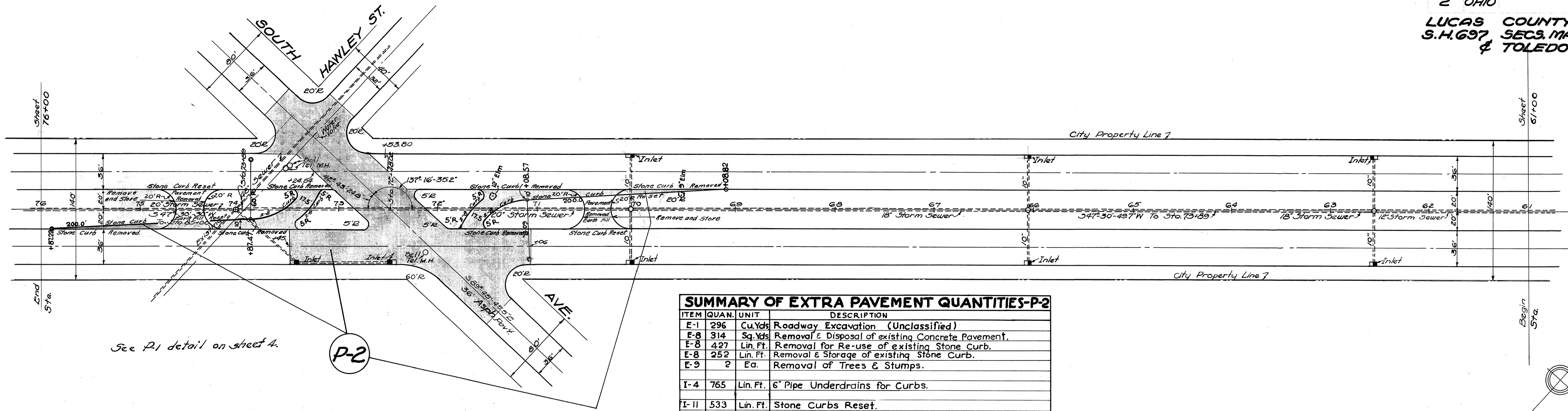

See P-1 detail on sheet 4.

P-2

**SUMMARY OF EXTRA PAVEMENT QUANTITIES-P-2**

ITEM	QUAN.	UNIT	DESCRIPTION
E-1	296	Cu.Yds	Roadway Excavation (Unclassified)
E-8	314	Sq.Yds	Removal & Disposal of existing Concrete Pavement.
E-8	427	Lin.Ft.	Removal for Re-use of existing Stone Curb.
E-8	252	Lin.Ft.	Removal & Storage of existing Stone Curb.
E-9	2	Ea.	Removal of Trees & Stumps.
I-4	765	Lin.Ft.	6" Pipe Underdrains for Curbs.
I-11	533	Lin.Ft.	Stone Curbs Reset.
I-12	232	Lin.Ft.	Concrete Curb, Type 2-B
B-70	518	Sq.Yds.	8" Portland Cement Concrete Base Course.
T-30	2942	Sq.Yds.	Bituminous Tack Coat.
B-35	2765	Sq.Yds.	1 1/2" Asphaltic Concrete Leveling Course
T-35	2942	Sq.Yds.	1" Asphaltic Concrete Surface Course

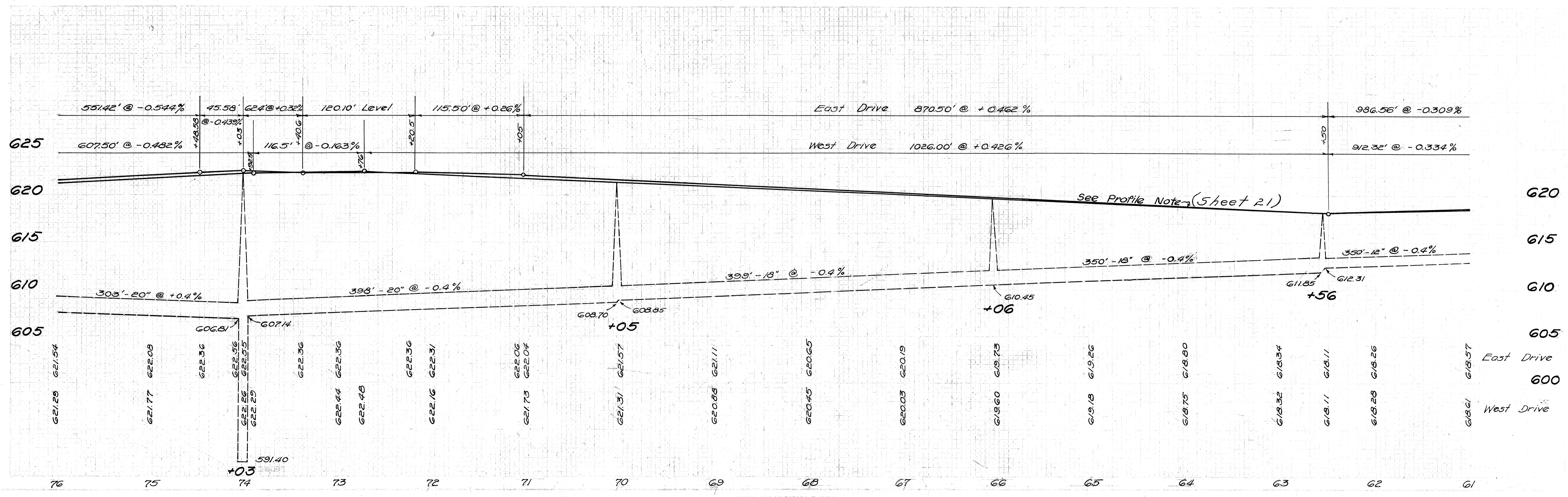

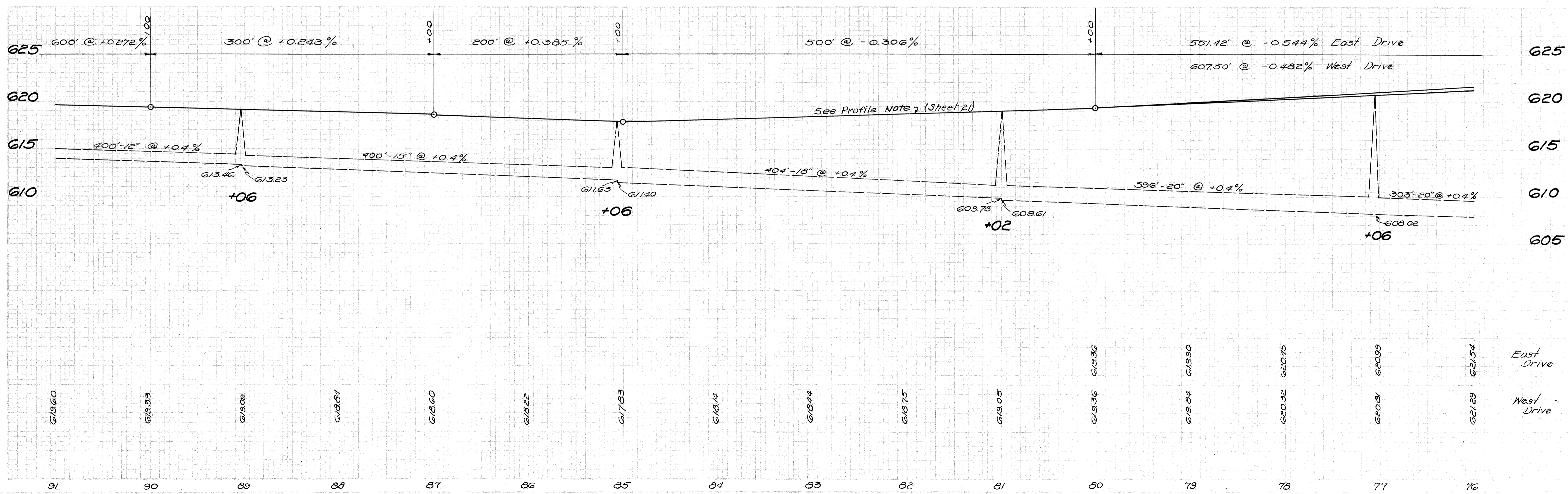
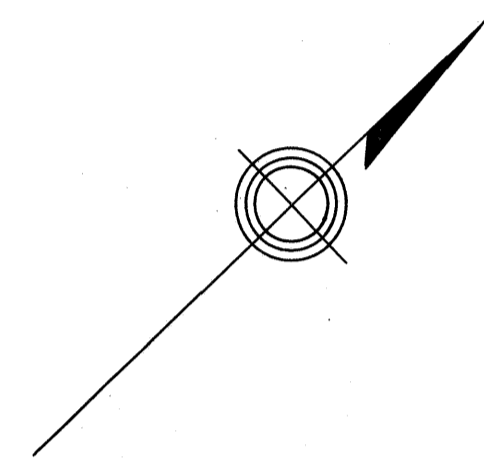
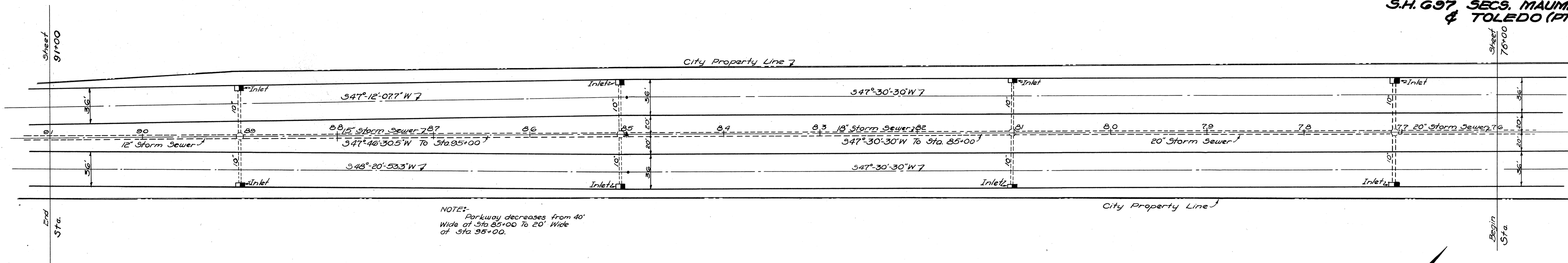

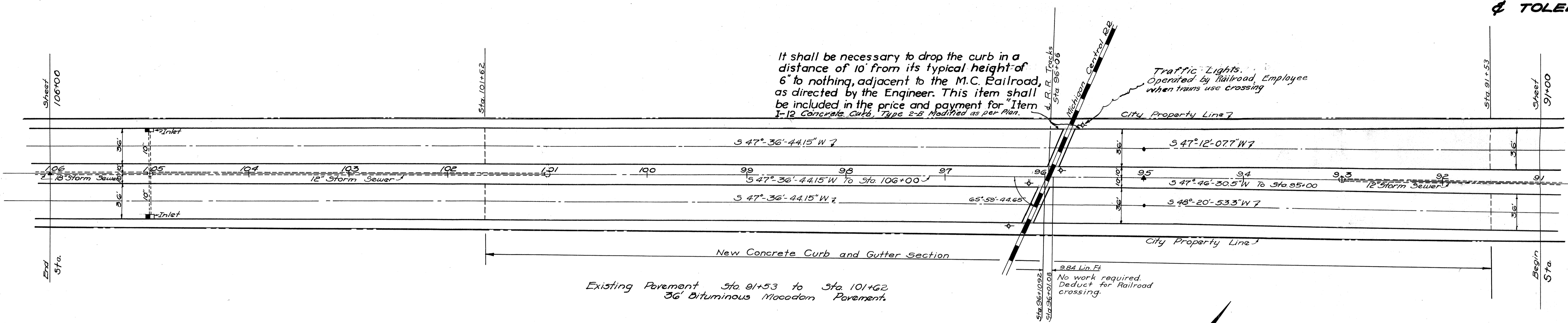

Note: Necessary feathering of leveling and surface courses shall be accomplished between sta. 95+75 and sta. 96+01.08 and between sta. 96+10.92 and sta. 96+35.

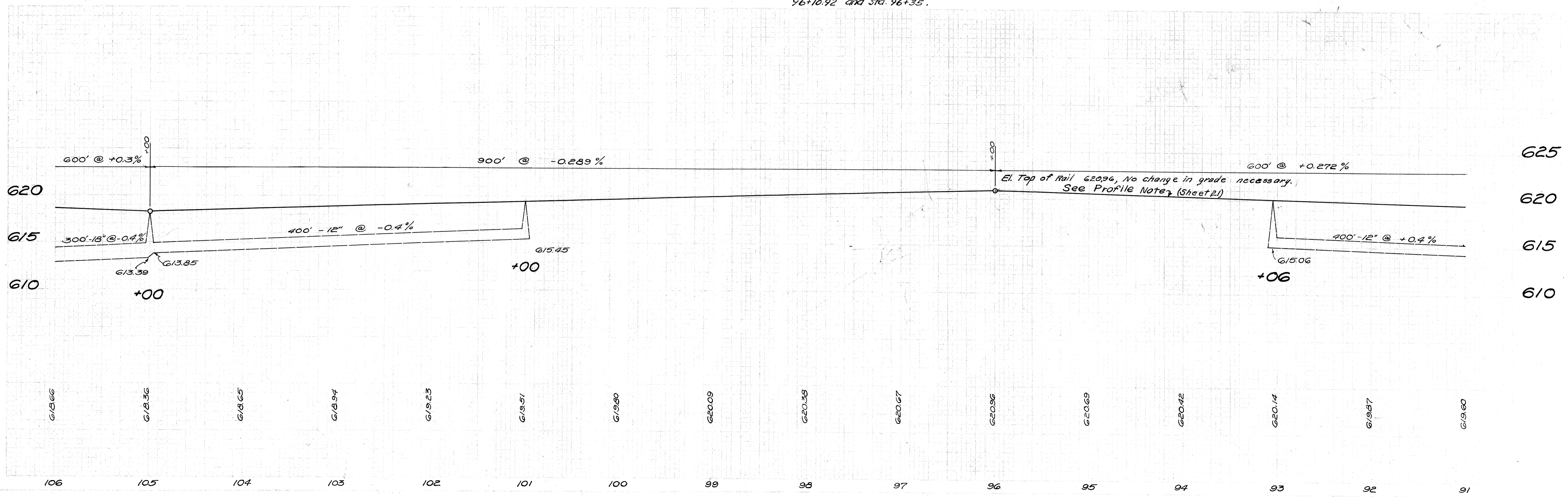
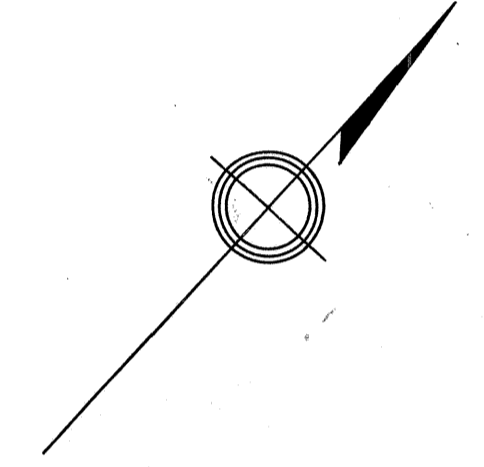

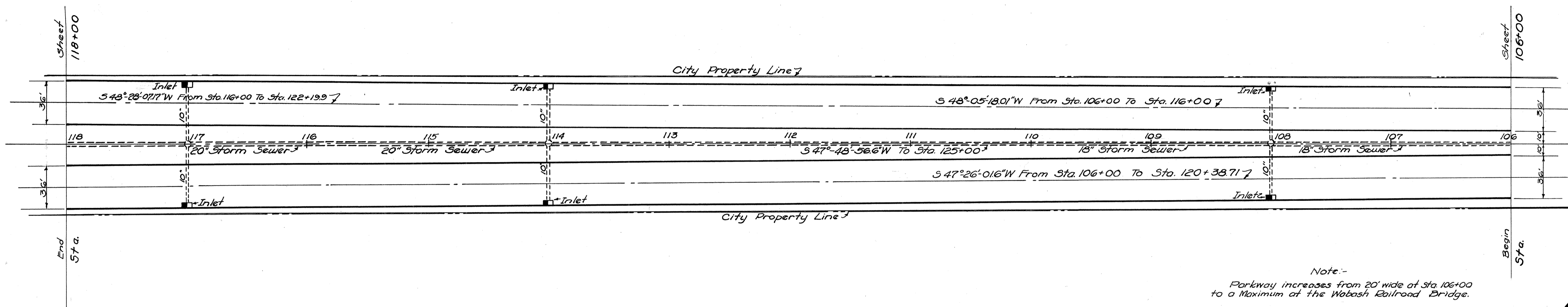

Note:-  
Parkway increases from 20' wide at Sta. 106+00 to a Maximum at the Wabash Railroad Bridge.

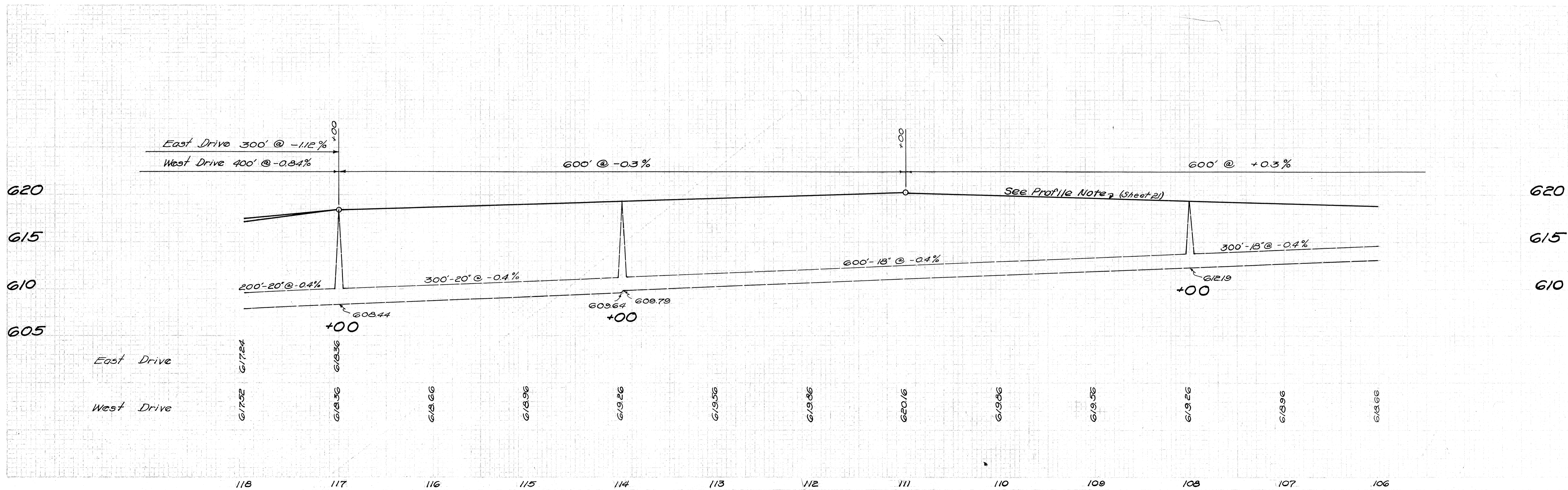
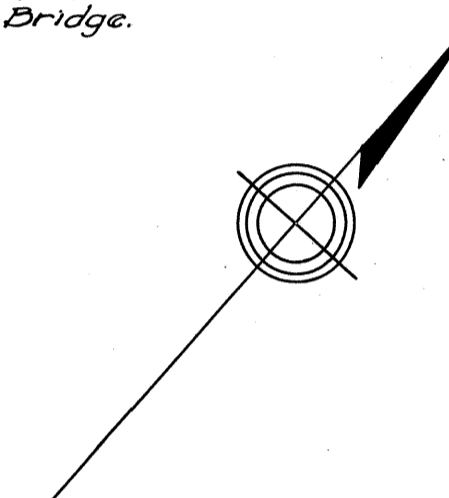

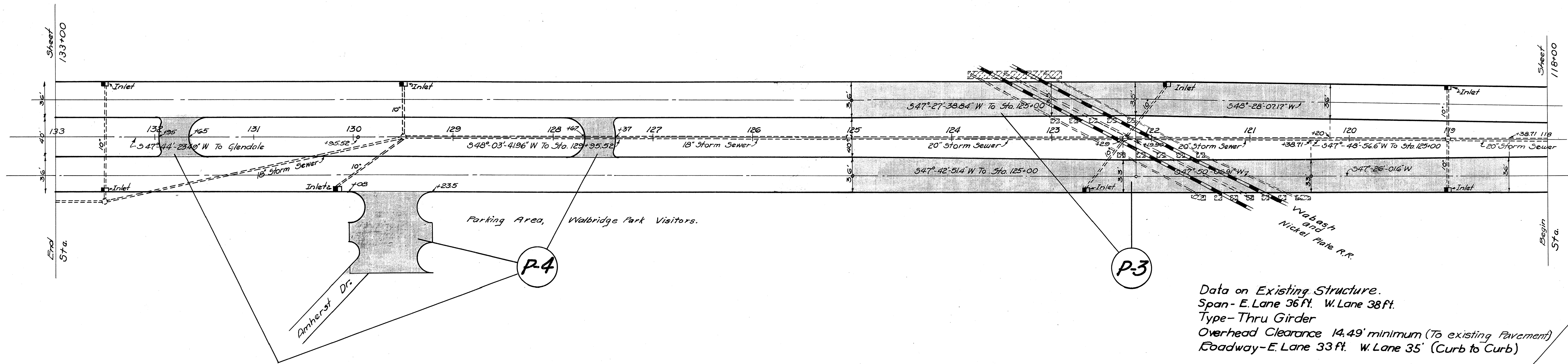

Data on Existing Structure.  
 Span - E. Lane 36 ft. W. Lane 38 ft.  
 Type - Thru Girder  
 Overhead Clearance 14.49' minimum (To existing Pavement)  
 Roadway - E. Lane 33 ft. W. Lane 35' (Curb to Curb)

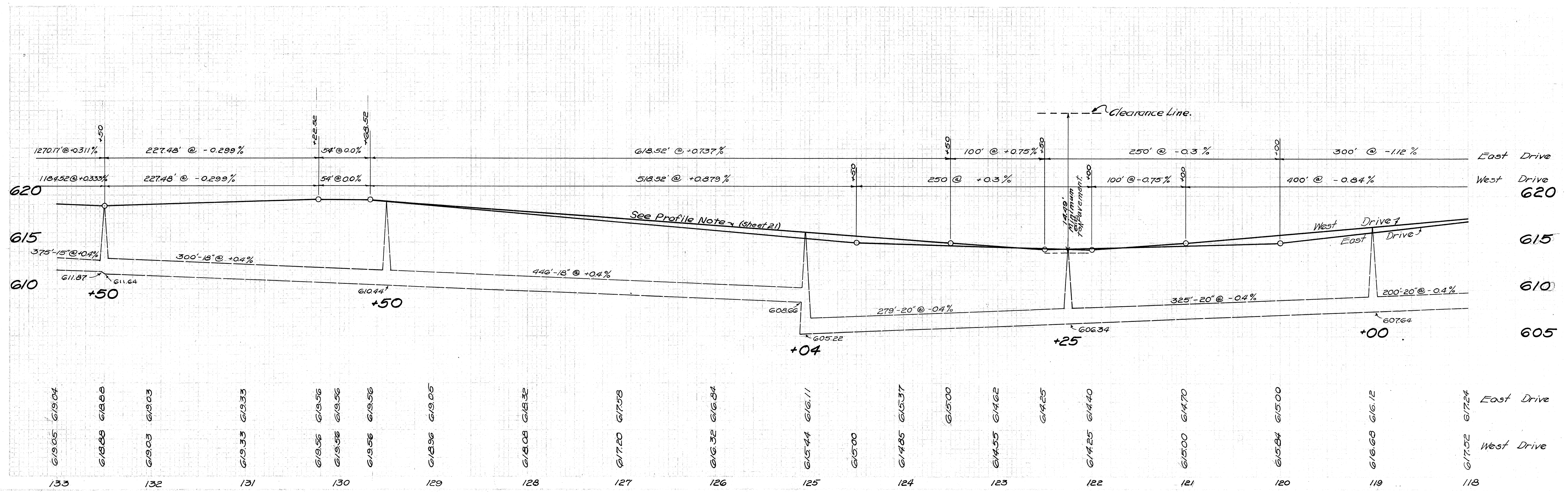

DIV. 2 OHIO  
 1946 21  
 LUCAS COUNTY  
 S.H. 697 SECS. MAUMEE (PT.)  
 & TOLEDO (PT.)

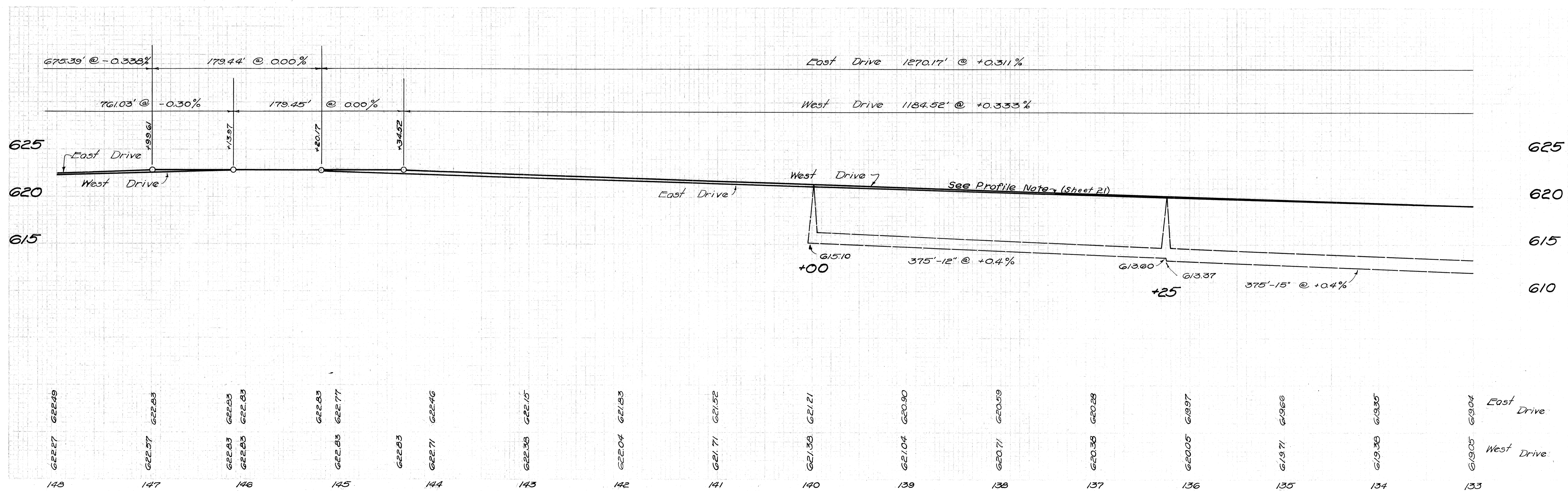
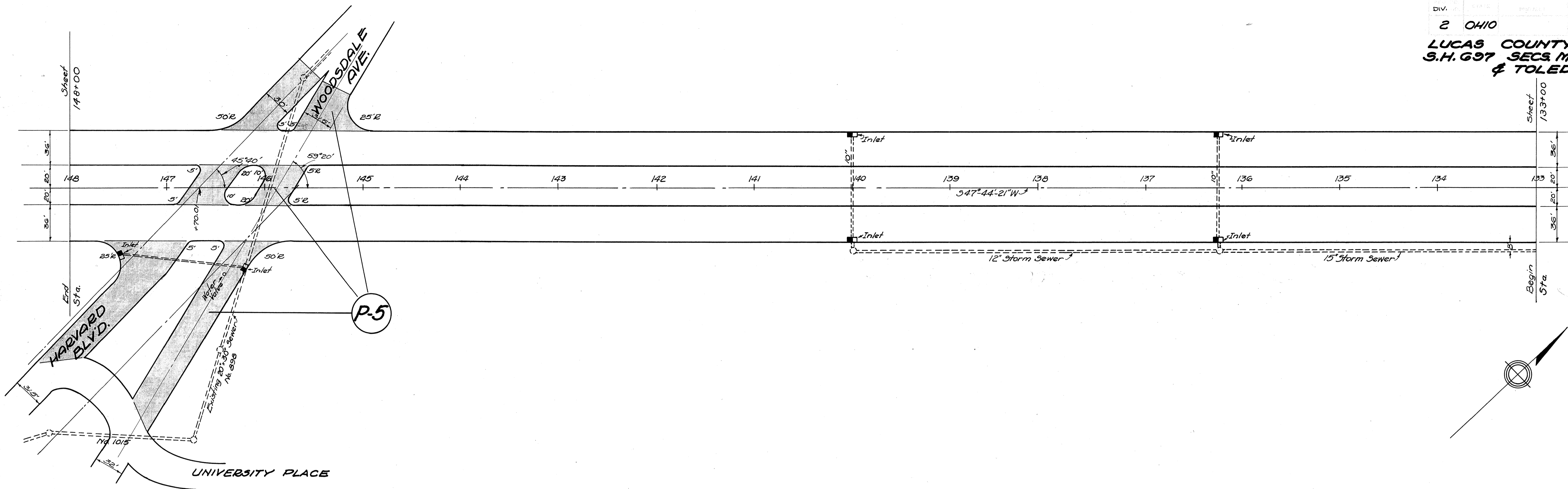



DIV. 2 OHIO 1946 11 21  
 LUCAS COUNTY  
 S.H. 697 SEC. MAUMEE (PT.)  
 & TOLEDO (PT.)

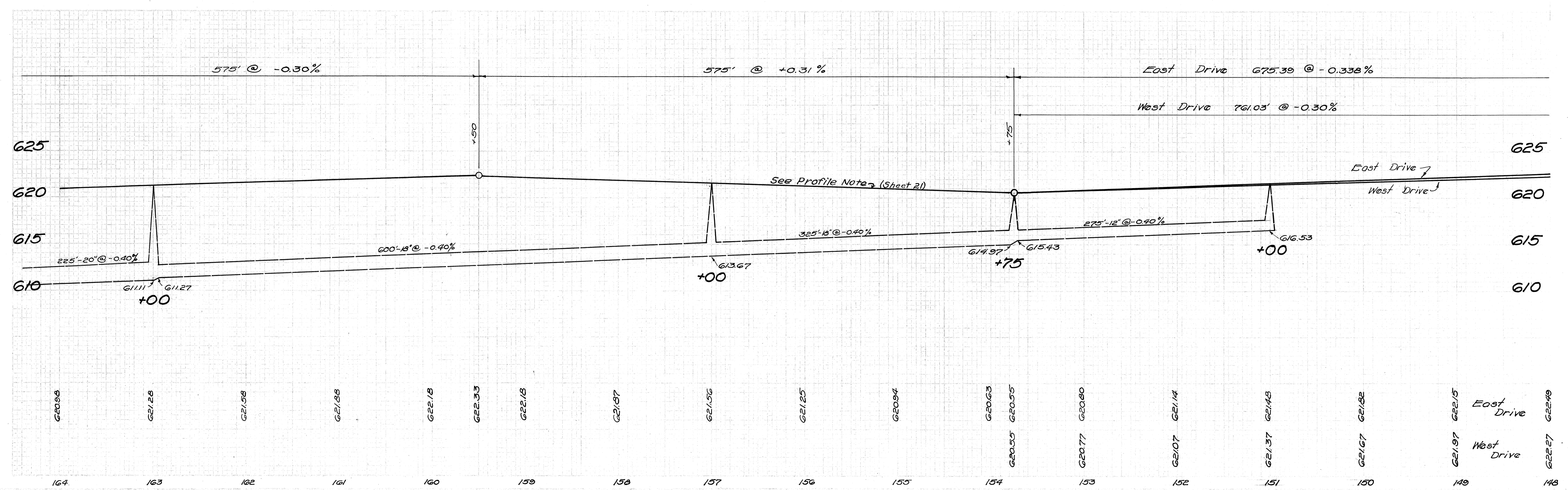
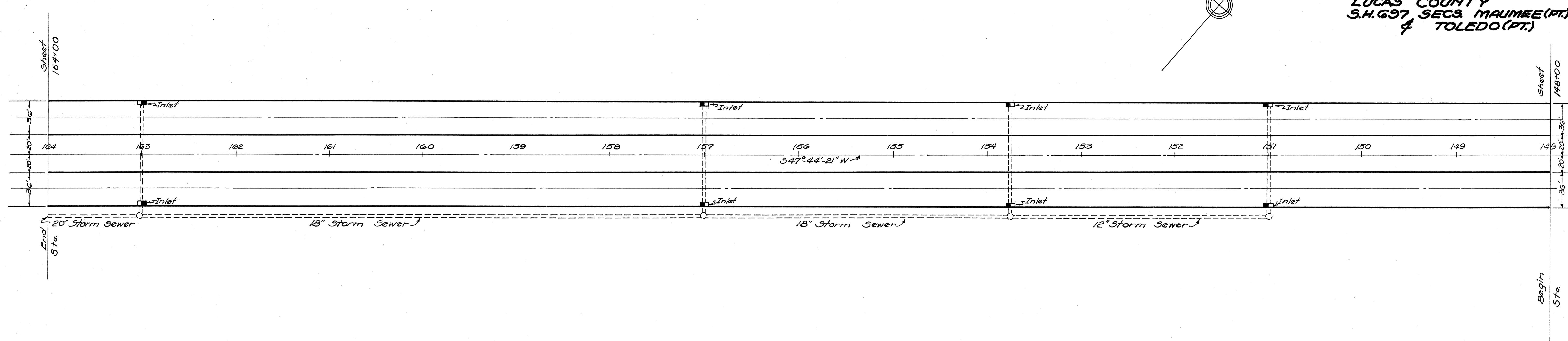
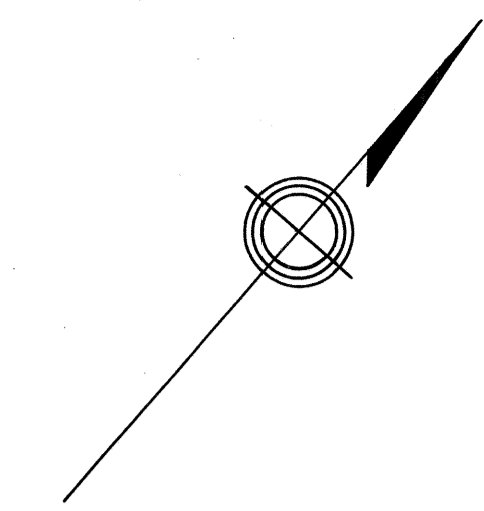

DIV. 2 OHIO 1946 12 21  
 LUCAS COUNTY SECS. MAUMEE (PT.) & TOLEDO (PT.)

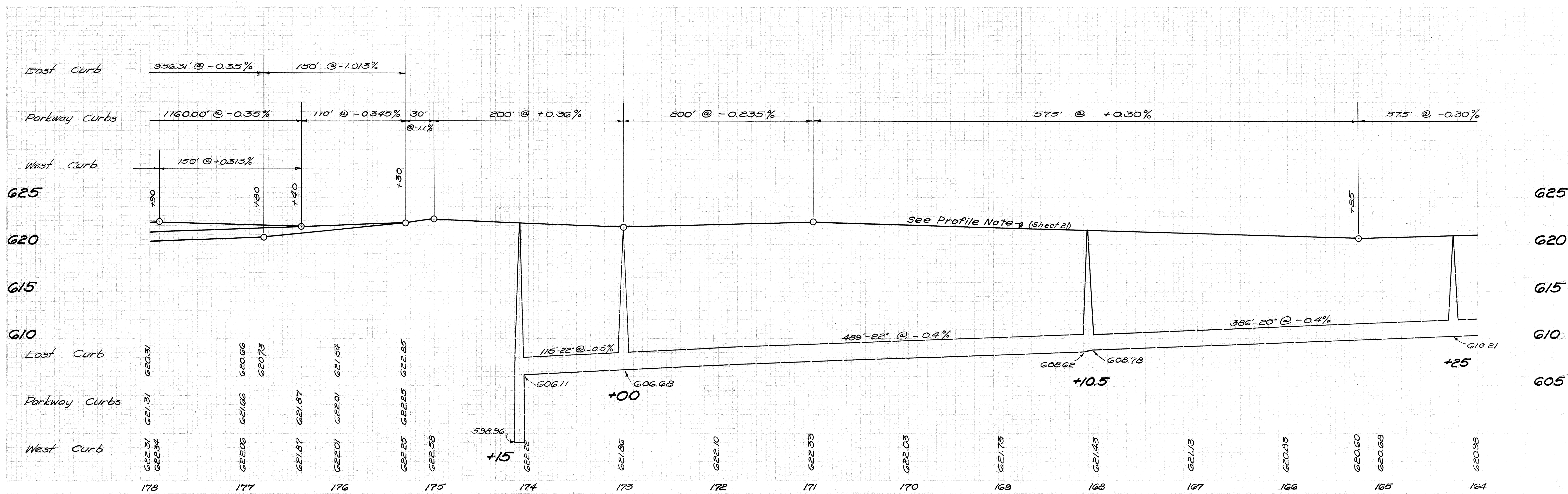
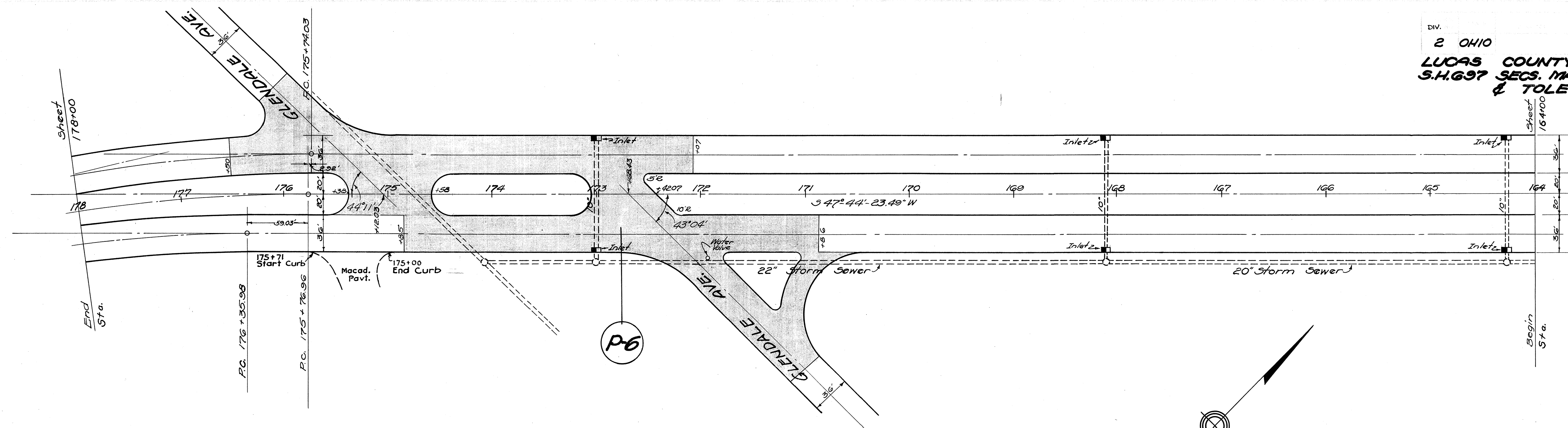

Center Line		West Drive			East Drive	
"A"	"B"	"C"	"D"	"E"	"F"	"G"
D 3°-59'-59"	3°-59'-59"	D 4°-38'-25"	2°-49'-59"	3°-55'-23"	D 4°-40'-34"	4°-04'-46"
Δ 19°-13'-49.24"	23°-08'-26"	Δ 13°-22'-16.89"	5°-51'-32.35"	23°-08'-26"	Δ 19°-13'-49.24"	23°-08'-26"
B 1432.500'	1432.500'	B 1234.734'	2022.41'	1460.500'	B 1225.239'	1404.500'
T 242.680'	293.276'	T 144.735'	103.425'	299.008'	T 207.576'	287.543'
L 480.797'	578.557'	L 288.155'	206.809'	589.865'	L 411.247'	567.248'
C 99.98'	99.98'	C 99.972'	99.99'	99.98'	C 99.972'	99.979'
L.C. 478.541'	574.632'	L.C. 287.502'	206.721'	585.864'	L.C. 409.320'	563.401'

Note: Degree of Curve "D" and Chord "C" Based on 100' of Arc.

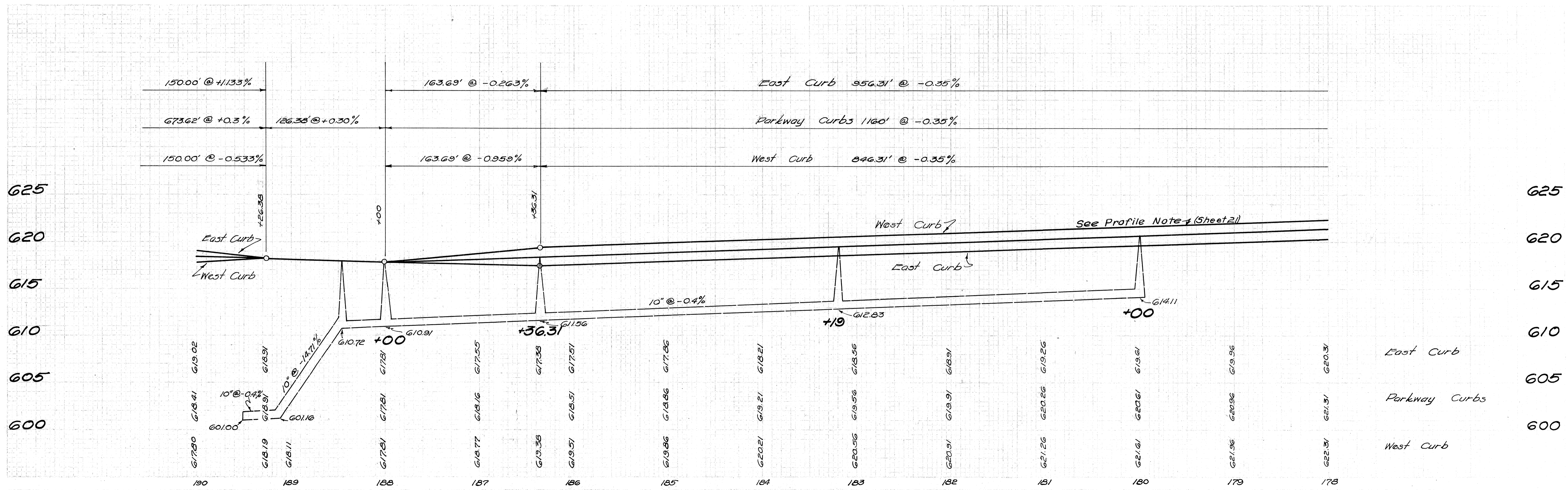
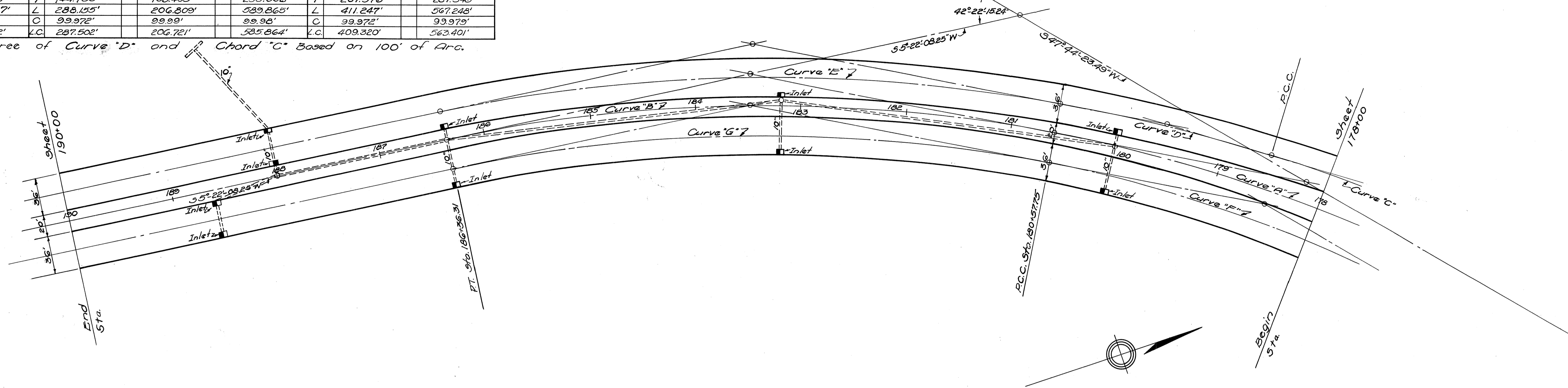

DIV. 2 OHIO 1946 14 21  
 LUCAS COUNTY  
 S.H. 697 SECS MAUMEE (PT.)  
 & TOLEDO (PT.)

**E & W Drives**  
 "D" "E" "F" "G"

D	1°-30'
Δ	2°-45'-33.32"
R	389.83'
T	91.996'
L	183.96'
C	99.997'
L.C.	183.94'

CENTER LINE CURVE "A"	WEST DRIVE CURVE "B"	EAST DRIVE CURVE "C"	
D	4°-59'-54"	5°-07'-25"	4°-52'-45"
Δ	23°-05'-02.02"	23°-05'-02.02"	23°-05'-02.02"
R	1146.28'	1118.28'	1174.28'
T	234.087'	228.369'	239.805'
L	461.825'	450.544'	473.106'
C	99.963'	99.967'	99.970'
L.C.	458.708'	447.503'	469.312'

NOTE: DEGREE OF CURVE "D" AND CHORD "C" BASED ON 100' OF ARC.

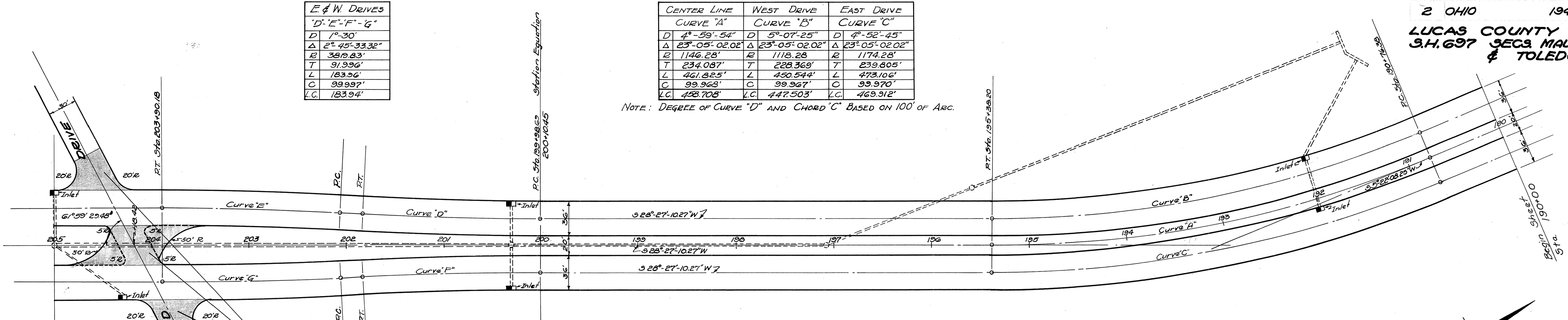

DETAIL OF PART OF P-7.  
 P-8 ON SHEET IT IS SIMILAR.

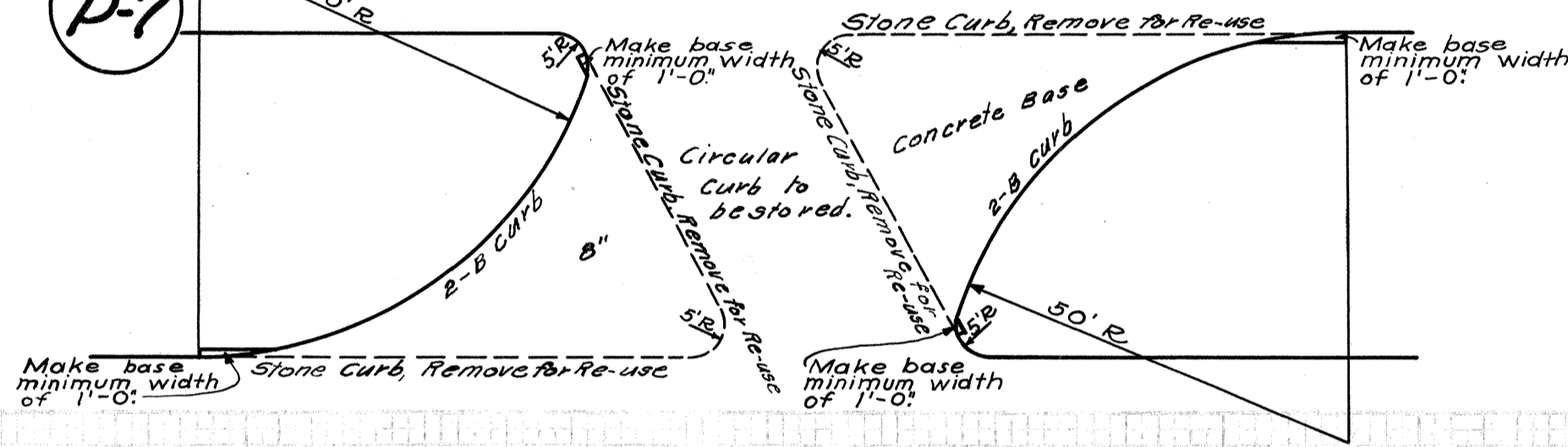

**SUMMARY OF EXTRA PAVEMENT QUANTITIES P-7**

ITEM	QUAN.	UNIT	DESCRIPTION
E-1	90	Cu.Yd.	Excavation, Unclassified.
E-8	21	Lin. Ft.	Removal & storage, Existing Stone Curb.
E-8	183	Lin. Ft.	Removal for re-use, Existing Stone Curb.
I-12	130	Lin. Ft.	Concrete Curb, Type 2-B.
B-70	181	Sq. Yd.	8" Concrete Base Course.
T-30	718	Sq. Yd.	Bituminous Tack Coat.
B-35	652	Sq. Yd.	1 1/2" Asphaltic Concrete Leveling Course.
T-35	718	Sq. Yd.	1" Asphaltic Concrete Surface Course.

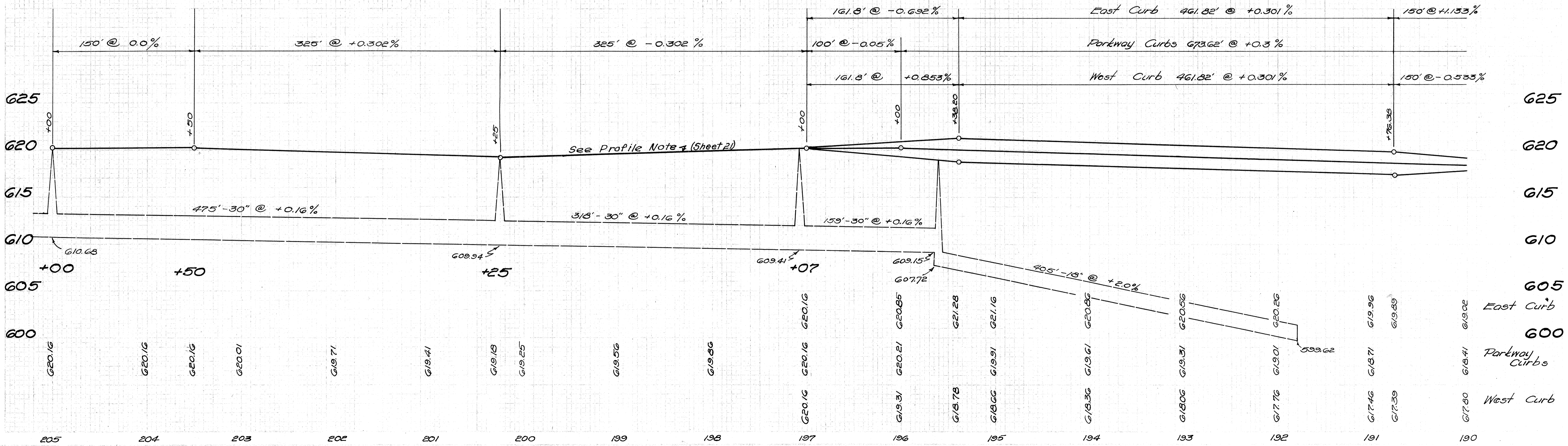

DIV. 2 OHIO 15  
 1946 21  
 LUCAS COUNTY  
 S.H. 697 SEC. 3, MAUMEE (PT.)  
 & TOLEDO (PT.)

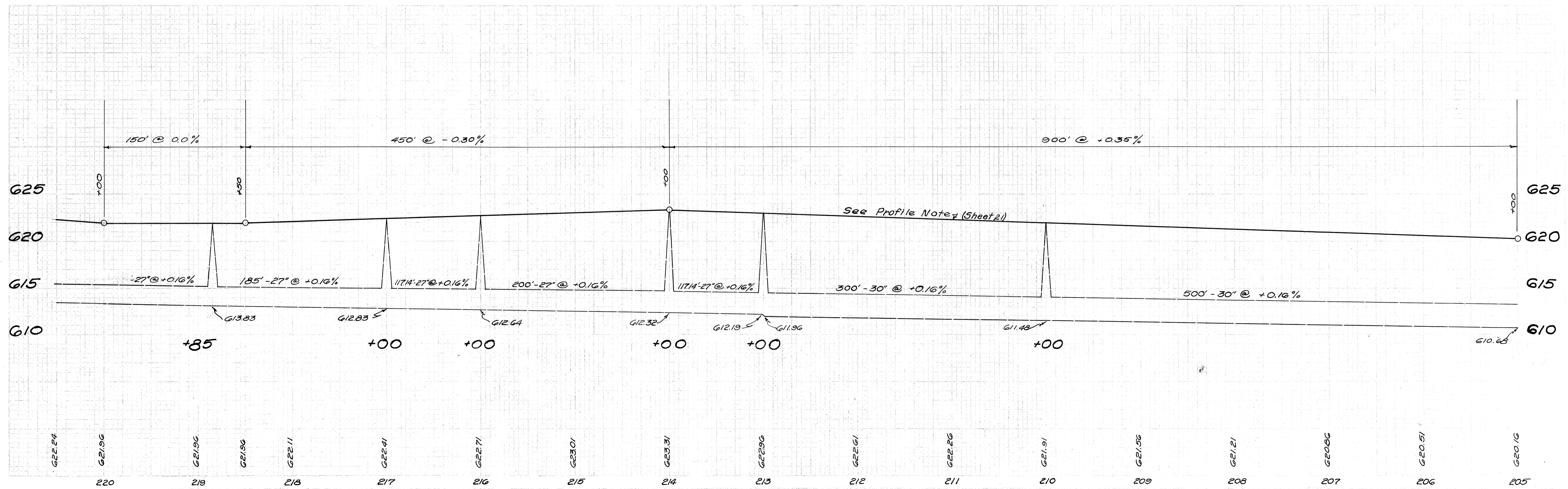
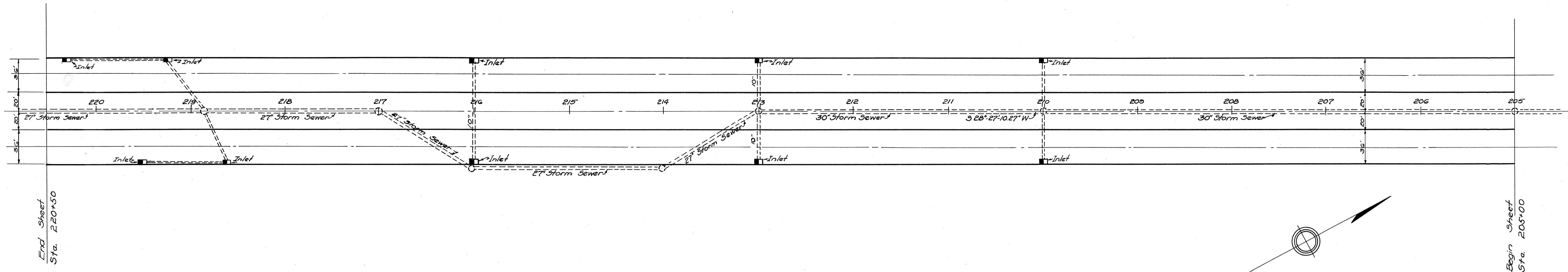

DIV. 2 OHIO 1946 16  
 21  
 LUCAS COUNTY  
 S.H.697 SECS. MAUMEE (PT.)  
 & TOLEDO (PT.)

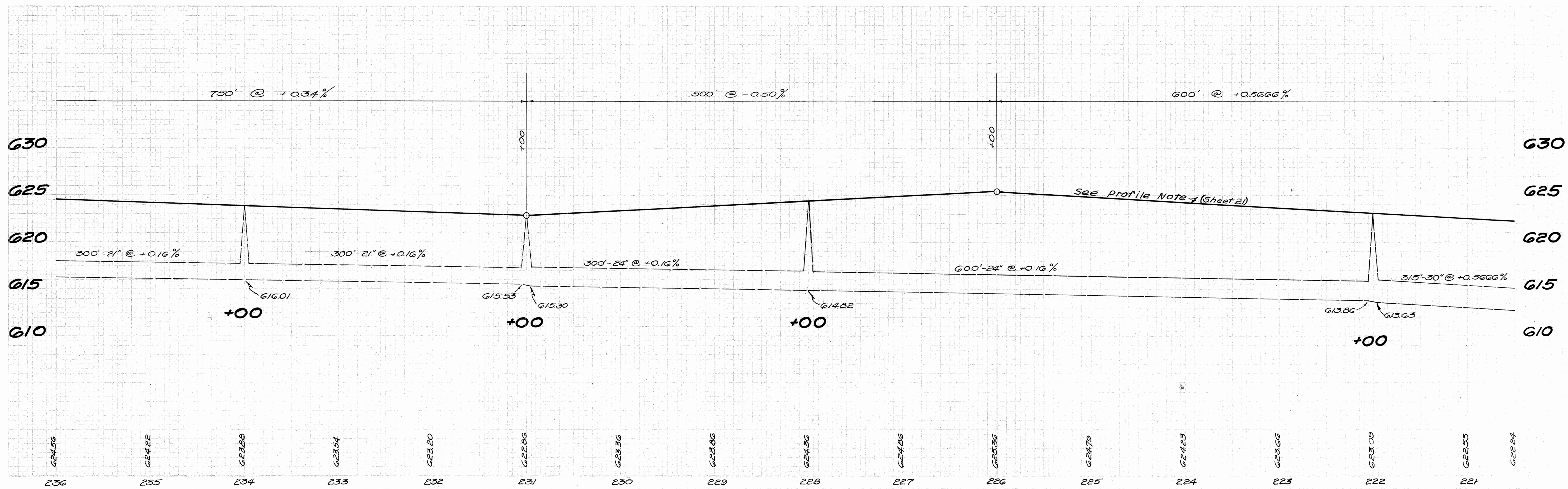
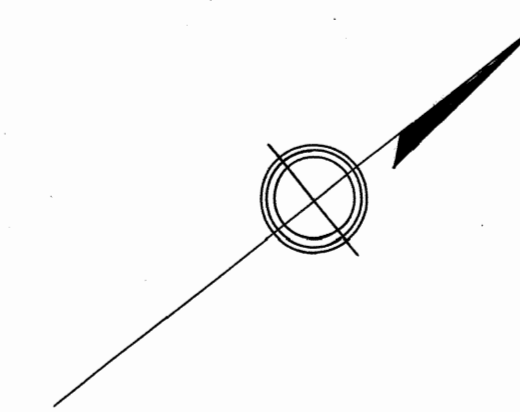
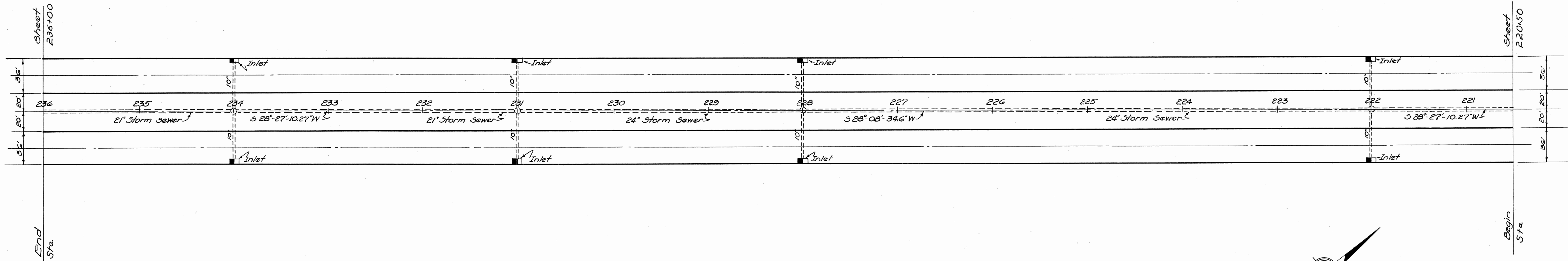

ITEM	QUAN.	UNIT	DESCRIPTION
E-1	90	Cu. Yd.	Excavation, Unclassified.
E-8	21	Lin. Ft.	Removal & storage, Existing Stone Curb.
E-8	183	Lin. Ft.	Removal for re-use, Existing Stone Curb.
I-12	130	Lin. Ft.	Concrete Curb, Type 2-B.
B-70	181	Sq. Yd.	8" Portland Cement Concrete Base Course.
T-30	836	Sq. Yd.	Bituminous Tack Coat.
B-35	756	Sq. Yd.	1 1/2" Asphaltic Concrete Leveling Course.
T-35	836	Sq. Yd.	1" Asphaltic Concrete Surface Course.

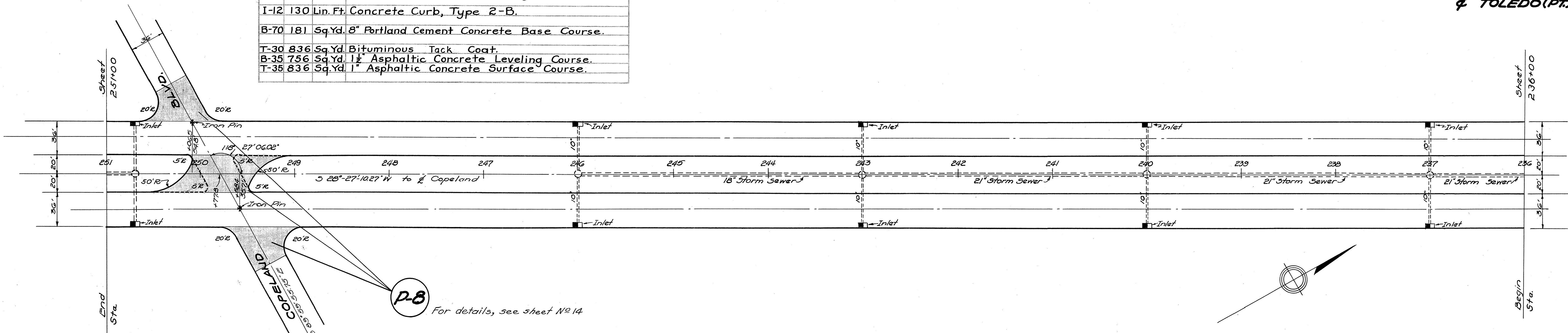

Sta. 249+58.4 ~ 35.7 Lt. Monument (Iron Pin) Adjusted To Grade.  
 Sta. 250+06.5 ~ 54.8 Rt. " " " " "  
 (For details, see sheet N23)

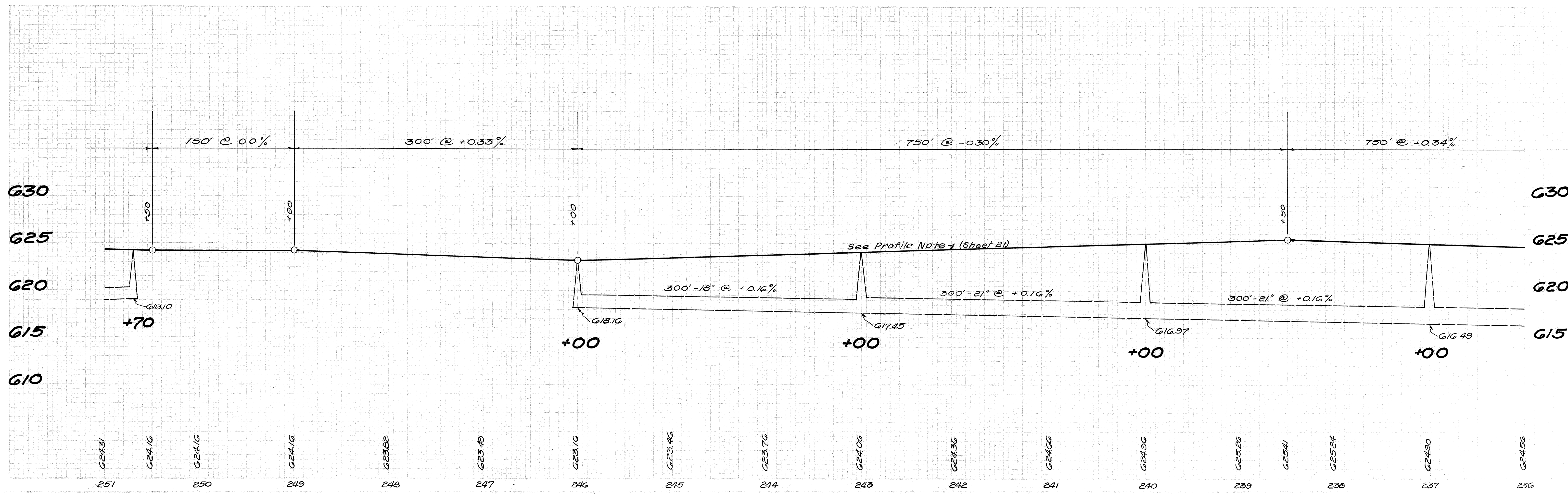

D 0°53'35"  
 Δ 4°41'07.56"  
 R 6403.097'  
 T 261.955'  
 L 523.621'  
 C 523.474'

D 1°02'54"  
 Δ 5°55'35.05"  
 R 5455.158'  
 T 282.379'  
 L 564.255'  
 C 564.002'

D 0°58'50"  
 Δ 5°32'18.91"  
 R 5844.617'  
 T 282.710'  
 L 564.979'  
 C 564.759'

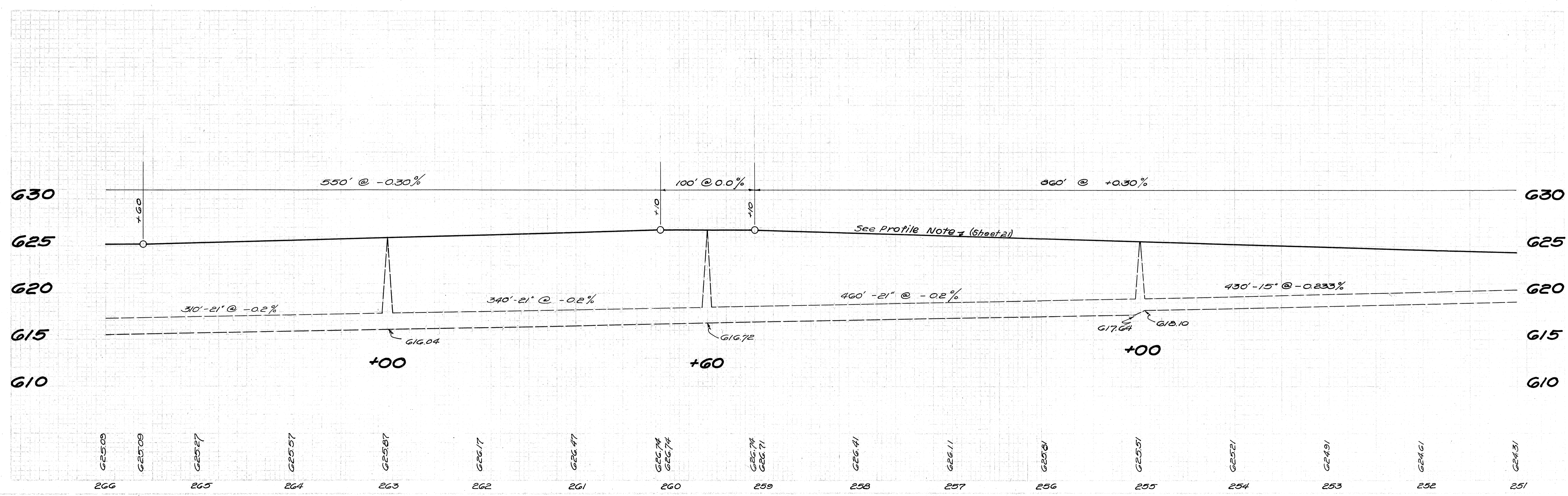
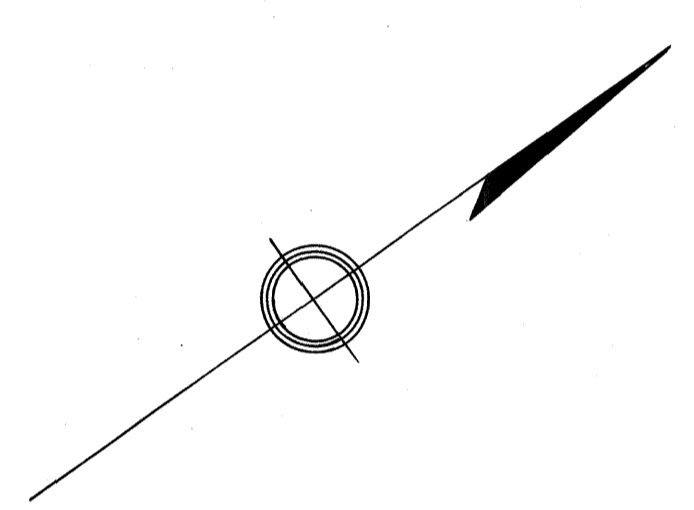
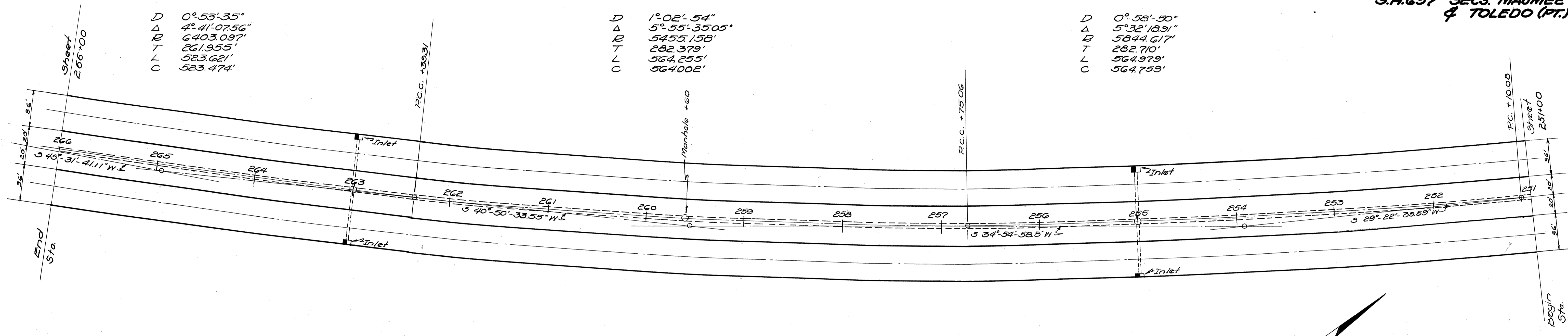



DIV. 2 OHIO 1946 19  
 LUCAS COUNTY 21  
 S.H. 697 SECS. MAUMEE (PT.)  
 & TOLEDO (PT.)

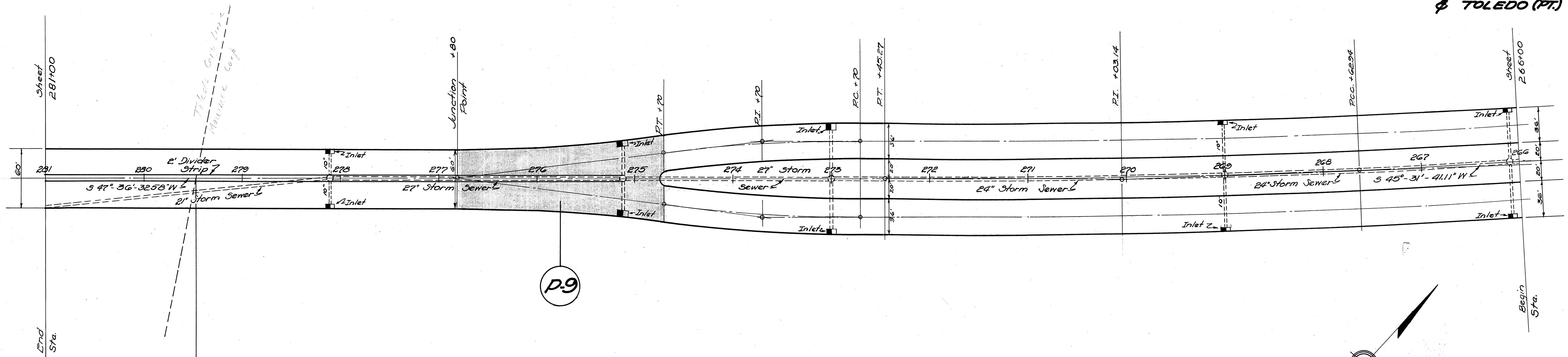

Begin S.H. 697 Section Maumee (Pt.) Sta. 279+45.83	End S.H. 697 Section Toledo (Pt.) Sta. 279+45.83
--	--

P.9

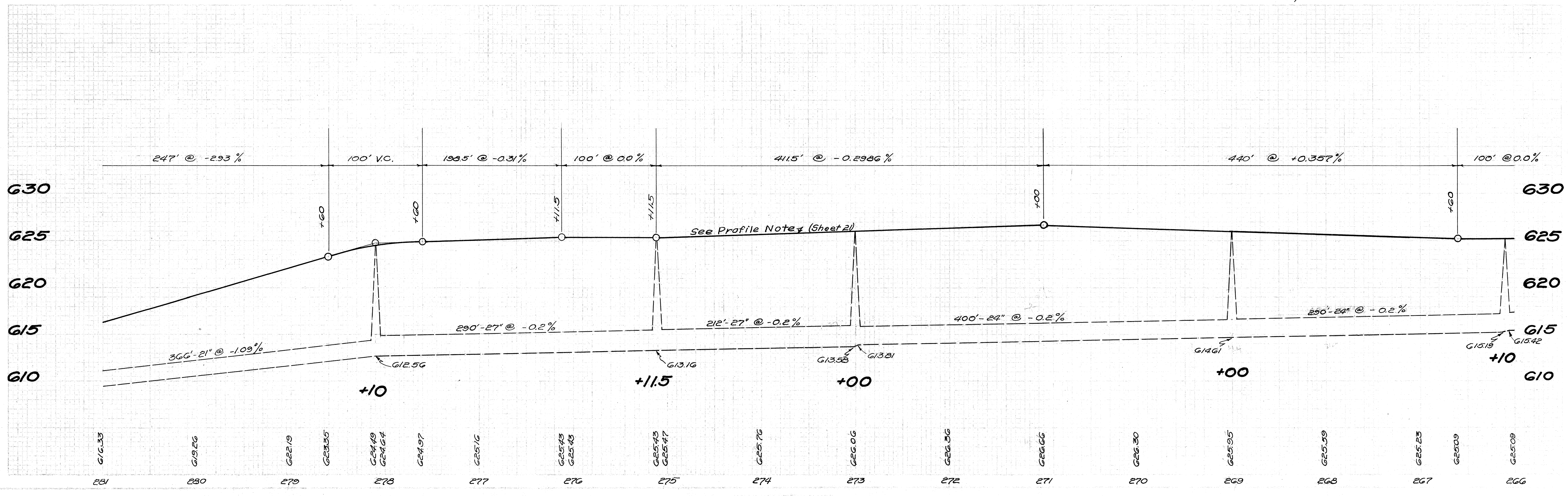

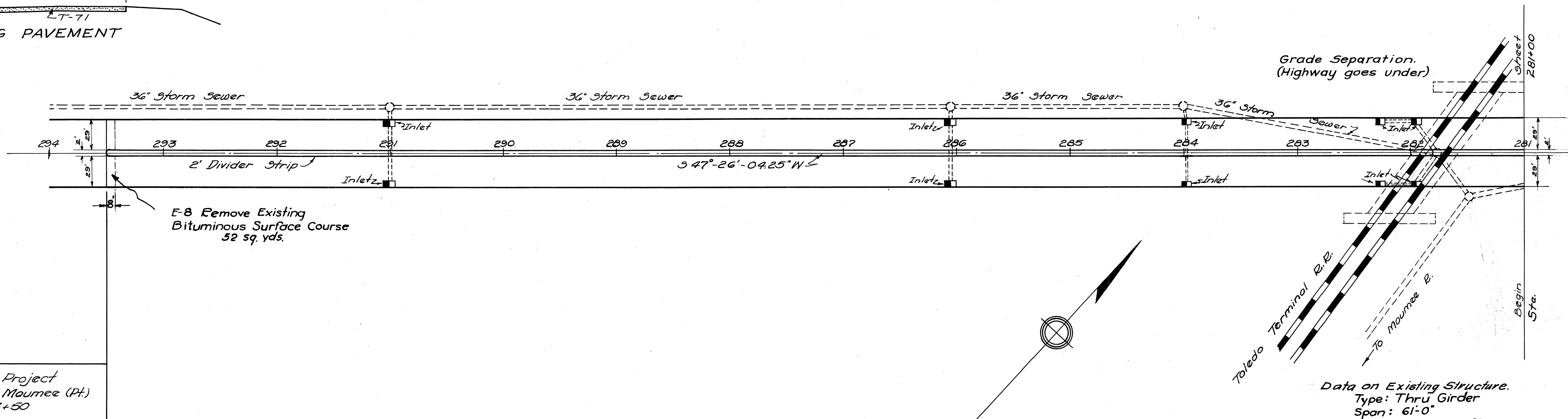
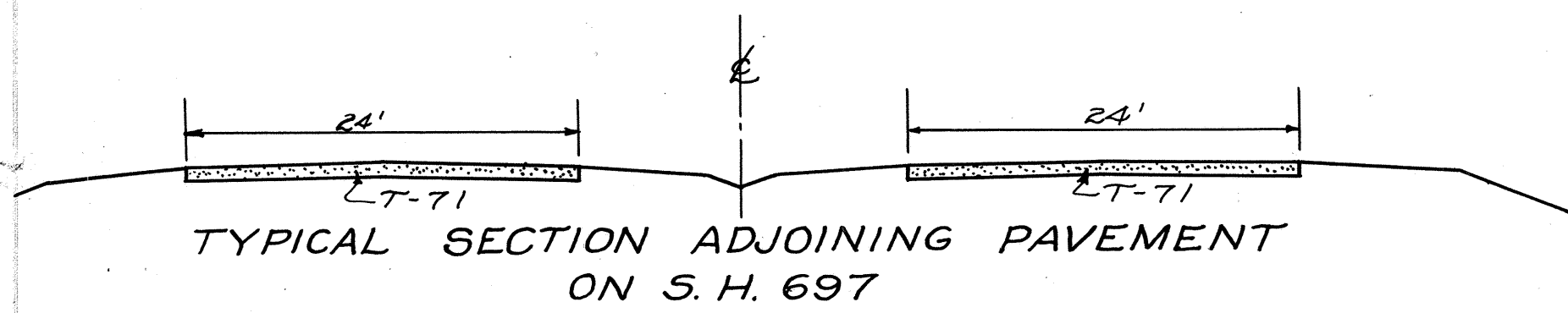

End of Project  
 Section Maumee (Pt.)  
 Sta. 293+50

Data on Existing Structure.  
 Type: Thru Girder  
 Span: 61'-0"  
 Roadway: 2-29 ft. Lanes.  
 Clearance: 14.25 ft. min. (at median strip conc. base to bottom girder)

