

STATE OF OHIO  
DEPARTMENT OF TRANSPORTATION  
**LUC - 223 - 1.40**  
CITY OF SYLVANIA  
LUCAS COUNTY

T-4017(9)

1973 SPECIFICATIONS

The standard specifications of the State of Ohio, Department of Transportation, including changes and supplemental specifications listed in the proposal shall govern this improvement.

The right of way for this improvement will be provided by the State of Ohio.

I hereby approve these plans and declare that the making of this improvement will not require the closing to traffic of the highway and that provisions for the maintenance and safety of traffic will be as set forth on the plans and estimates.

Approved Warren A. Schuster  
Date 3-27-73 Mayor - City of Sylvania

Approved John P. Annot  
Date 3-27-73 Service Director - City of Sylvania

Approved James M. Callahan  
Date 2 Apr 73 District Deputy Director of Transportation  
Approved \_\_\_\_\_  
Date \_\_\_\_\_ Engineer, Bureau of Bridges

Approved E.J. Schaefer  
Date 4-27-73 Engineer, Bureau of Roadway Design

Approved William E. Skell  
Date 4-27-73 Assistant Deputy Director for Highway Design

Approved \_\_\_\_\_  
Date \_\_\_\_\_ Assistant Deputy Director for Real Estate

Approved William Pankley  
Date 4-27-73 Assistant Deputy Director for Program Development

Approved William A. Baker  
Date 4-27-73 Chief Engineer, Division of Highways

Approved R.A. Neillinger  
Date 4-27-73 Deputy Director, Division of Highways

Approved William P. McKenna  
Date 4-27-73 Assistant Director, Department of Transportation

Approved John P. Ruddy  
Date 4-27-73 Director, Department of Transportation

CONVENTIONAL SIGNS

County Line	-----	Limited Access (only)	-----LA-----
Township Line	-----	Right of Way (only)	-----RW-----
Section Line	-----	Limited Access & Right of Way	-----LA&RW-----
Corporation Line	----- or -----	Existing Right of Way	-----
Fence Line (existing)	-x-x- (proposed) -x-x-	Property Line	----- (in existing fence) -x-x-
Center Line	352 ----- 353	Railroad	-----
Trees	⊙, Stumps ⊙ (to be removed) ⊗ ⊗	Guardrail (existing)	----- (proposed) -----
Utility Poles: Telephone	⊕, Power ⊕, Light ⊕		

INDEX OF SHEETS

Title Sheet	-----	1
Schematic Plan & Design Designation	-----	2
Typical Sections	-----	3 & 4
General Notes	-----	5
General Summary	-----	6 & 7
Computations & Subsummaries	-----	8 to 14
Plan & Profile	-----	15 to 26
Cross Sections	-----	27 to 37
Intersection Details	-----	38 to 41
Signing	-----	42 to 57, 57A
Signalization	-----	58 to 77, 60A
Pavement Marking	-----	78 to 82

LINE DATA

Begin Project	Sta. 74+00.00
Suspend Project	Sta. 94+75.00
Resume Project	Sta. 111+25.00
End Project	Sta. 115+00.00
Length of Project	= 245.0 Lin. Ft. = 0.464 Miles
Begin Work	Sta. 60+00.00
End Work	Sta. 116+00.00
Monroe St. Sta. Eq.	Sta. 74+40.17 = Sta. 73+97.65 = 42.52 Lin. Ft.
Length of Work	= 5,642.52 Lin. Ft.

ADD WORK

Alexis Rd.	Sta. 0+00.00 to Sta. 4+00.22 = 400.22 Lin. Ft.
Corey Rd.	Sta. 0+34.00 to Sta. 4+00.00 = 366.00 Lin. Ft.
Corey Rd. Sta. Eq.	Sta. 3+21.71 = Sta. 3+80.24 = 58.53 Lin. Ft.
Total Add Work	= 824.75 Lin. Ft.

Length of Work = 5,642.52 Lin. Ft. + 824.75 Lin. Ft. = 6,467.27 Lin. Ft. = 1.224 Miles

BEGIN PROJECT  
STA. 74+00

SUSPEND PROJECT  
STA. 94+75

RESUME PROJECT  
STA. 111+25

END PROJECT  
STA. 115+00

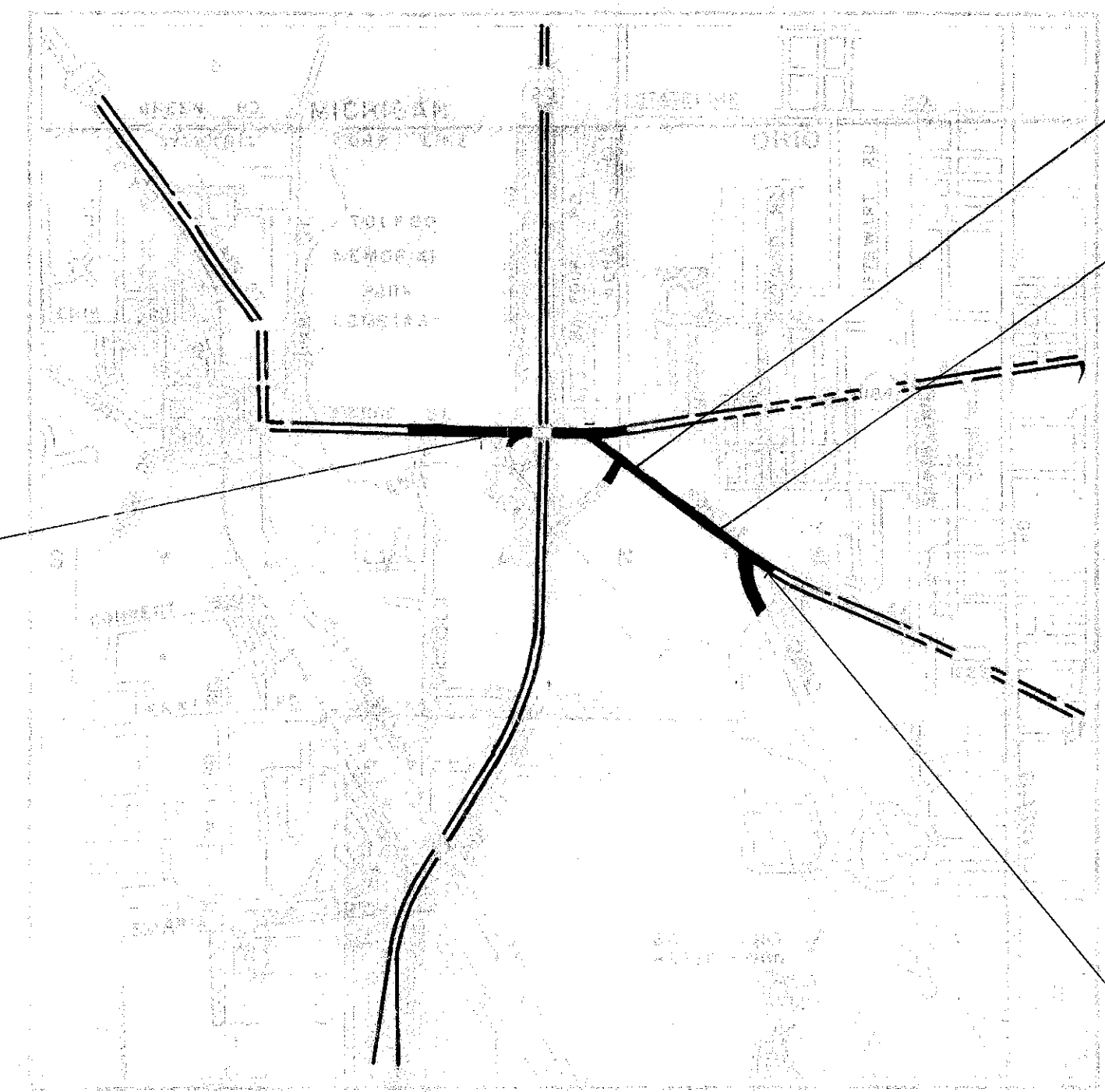

LOCATION MAP

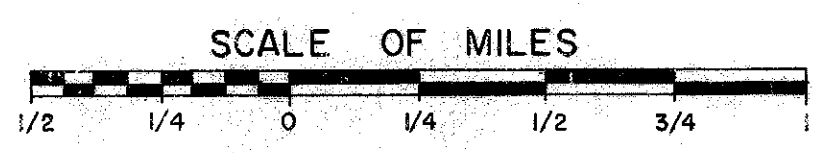

Portion to be improved	-----
State Roads	=====
Other Roads	-----

SCALES

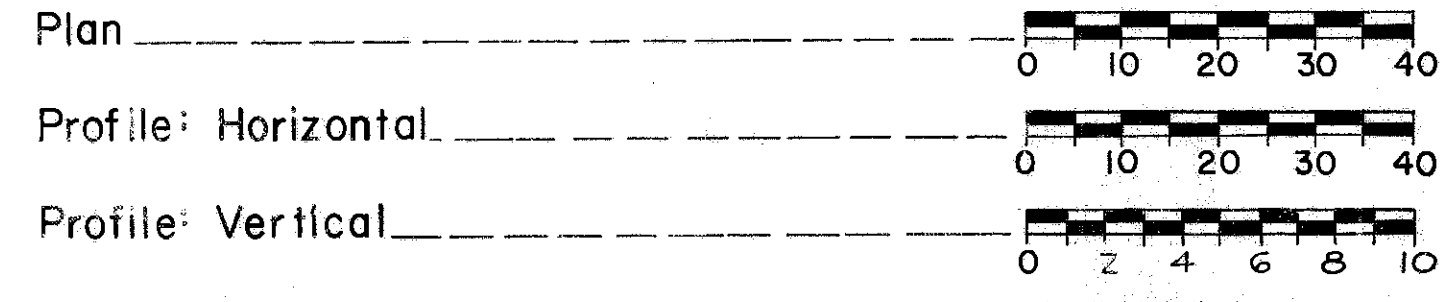

SUPPLEMENTAL PRINTS OF STANDARD CONSTRUCTION DRAWINGS					
NUMBER	DATE	NUMBER	DATE	NUMBER	DATE
BP-5	6-1-72	HW-4	1-1-70	MH-1	10-1-68
BP-6	6-1-65			MH-1A	10-1-68
BP-7	1-1-66				
		L-1	6-1-65	MC-3	6-20-69
				MC-6	6-1-65
CB 2-2-A	6-1-65				
CB-3	6-1-65	MC-1	6-13-69		
CB-3-A	6-1-65	MC-2	6-1-65		
FACI-1	4-20-71	MC-4	6-13-69		
FACI-2	4-20-71	MC-5	6-1-65		
F-1	6-1-72				

SUPPLEMENTAL SPECIFICATIONS	
NUMBER	DATE
815	9-20-72
816	9-20-72
941	11-25-70
1001	9-20-72

DEPARTMENT OF TRANSPORTATION  
FEDERAL HIGHWAY ADMINISTRATION

APPROVED: \_\_\_\_\_

DIVISION ENGINEER \_\_\_\_\_ DATE \_\_\_\_\_

Plan Prepared By:  
McDONNELL PROUDFOOT & ASSOCIATES, INC.  
CONSULTING ENGINEERS, TOLEDO, OHIO.

BY: Paul E. Proudfoot DATE: \_\_\_\_\_  
PAUL E. PROUDFOOT P.E. No. 22529

FED. RD. DIVISION	STATE	PROJECT
5	OHIO	T-4017(9)







15  
82



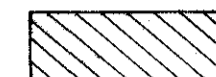

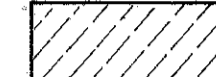
LUC-723-140

SITE BENCH MARK  
R.R. SPIKE IN POWER POLE  
STA 74+23.86, 3' LT. OF C. CONSTR.  
ELEV. = 646.042

BEGIN PROJECT  
STA. 74+00

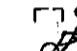
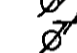
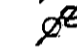
BEGIN RESURFACING  
W/ 404 ASPHALT CONCRETE  
FEATHER RESURFACING FROM 0"  
TO 1 1/2" IN 15' FROM STA. 74+00  
TO STA. 74+15

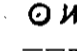
-  NEW ASPHALT CONCRETE PAVEMENT
-  EXISTING PAVEMENT TO BE RESURFACED
-  EXISTING CONCRETE PAVEMENT TO BE REMOVED
-  EXISTING ASPHALT PAVEMENT TO BE REMOVED
-  NEW ASPHALT CONCRETE DRIVE APPROACH
-  REMOVE EXISTING WEARING COURSE TO THE SPECIFIED DEPTH
-  REMOVE EXISTING MACADAM WEARING COURSE

- LEGEND**
-  M.H. --- MANHOLE
  -  C.B. --- CATCH BASIN
  -  P. --- POWER POLE
  -  T. --- TELEPHONE POLE
  -  L. --- LIGHT POLE
  -  H. --- HYDRANT
  -  W. --- WATER VALVE
  -  G. --- GUY WIRE
  -  S. --- SIGN

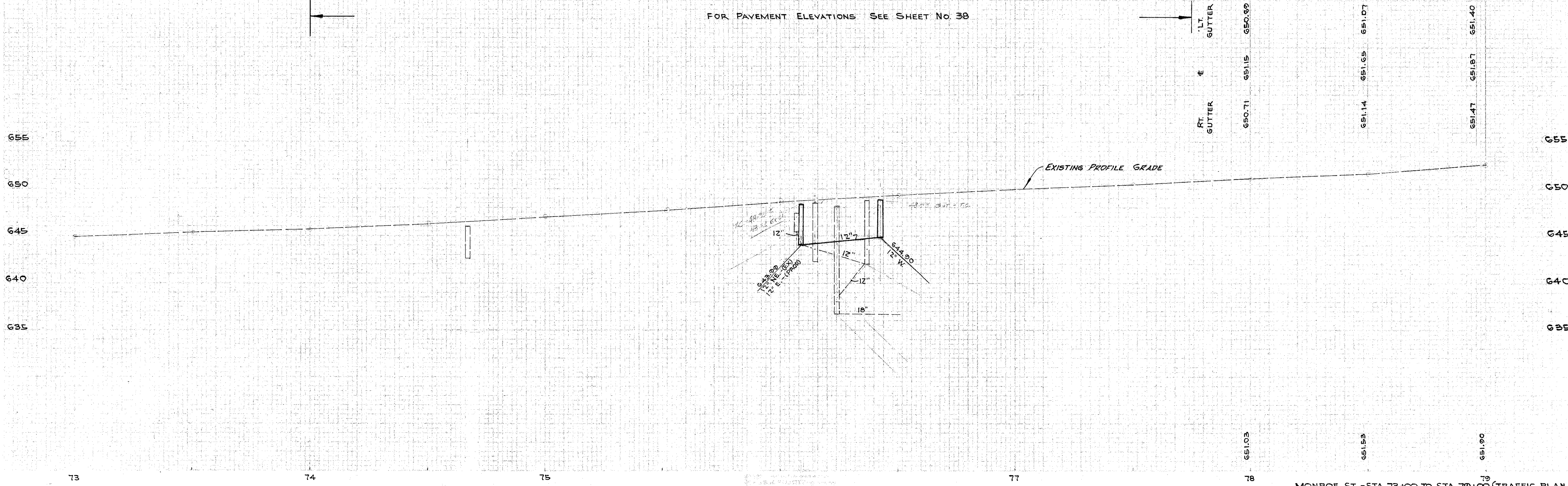
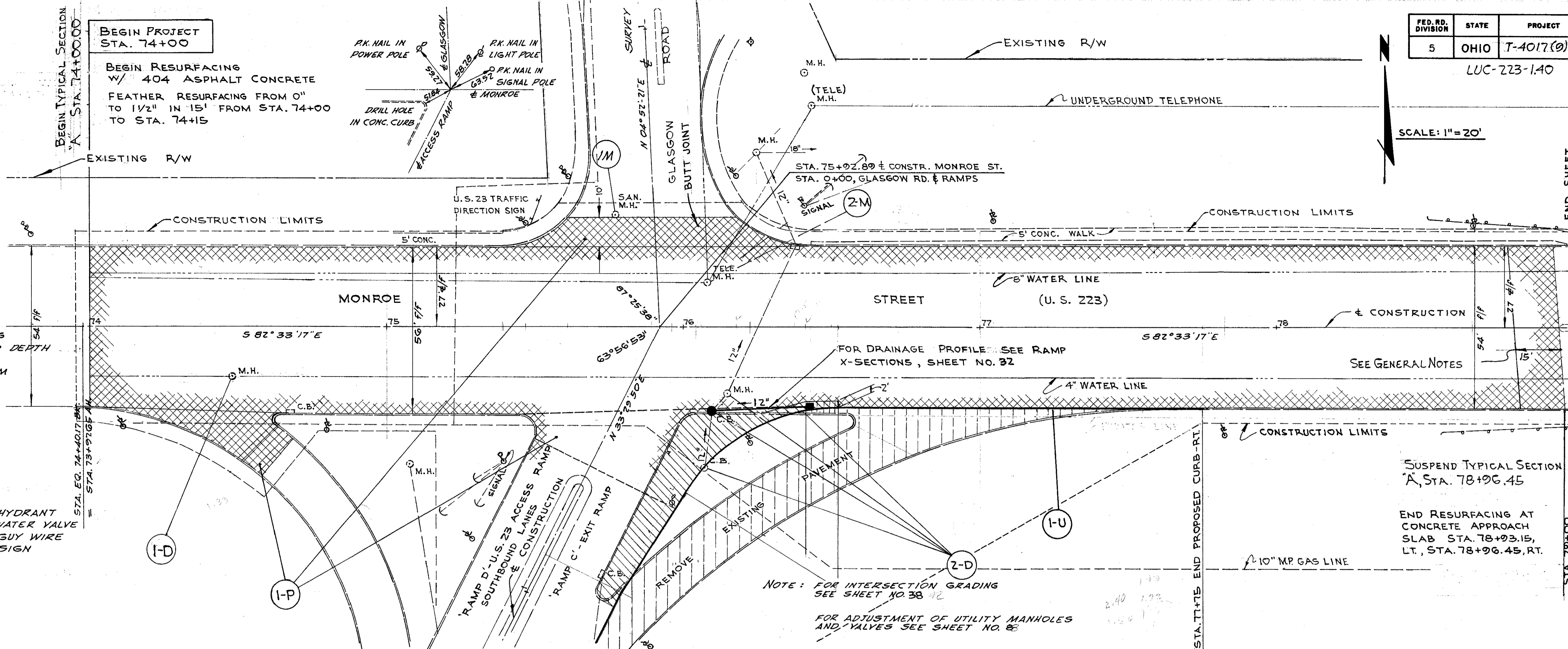

FED. RD. DIVISION	STATE	PROJECT	
5	OHIO	T-4017(9)	

16  
82

LUC-223-1A0

SCALE: 1" = 20'

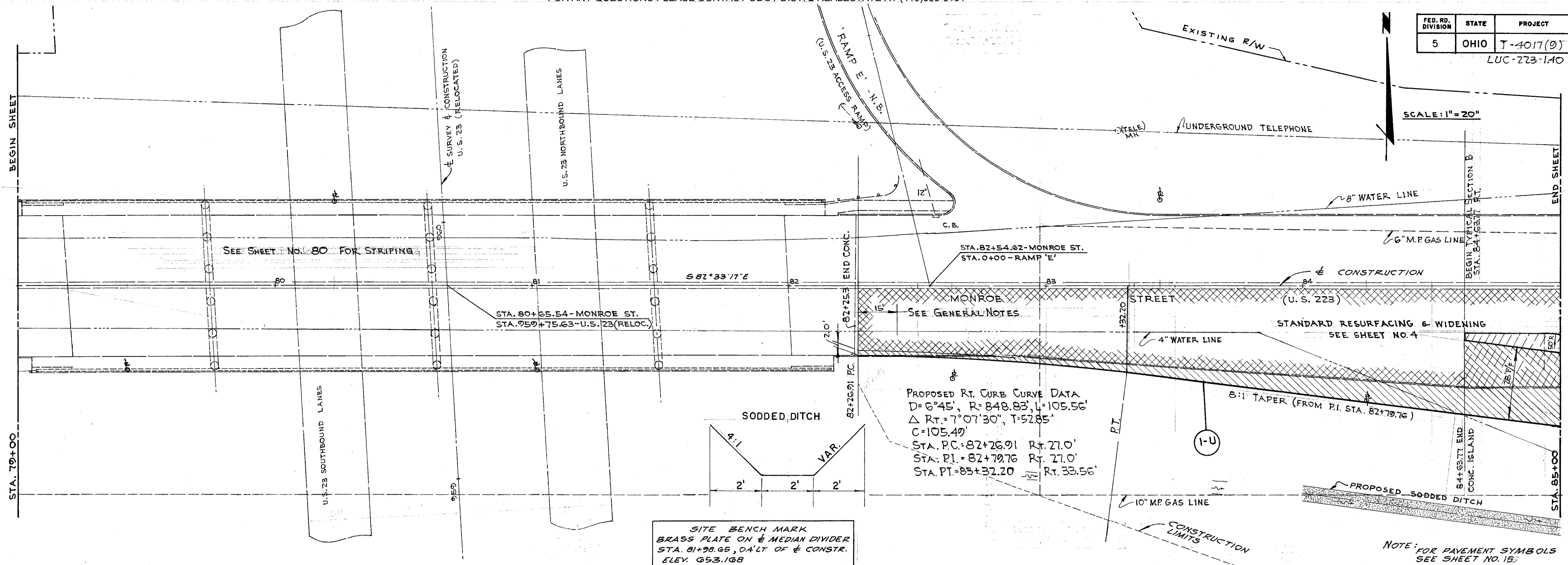

SITE BENCH MARK  
BRASS PLATE ON & MEDIAN DIVIDER  
STA. 81+98.65, O.A.L.T. OF & CONSTR.  
ELEV. 653.168

PROPOSED RT. CURVE CURVE DATA  
D = 6°45', R = 848.83', L = 105.56'  
Δ Rt = 7°07'30", T = 52.85'  
C = 105.49'  
STA. P.C. = 82+26.91 Rt. 27.0'  
STA. P.I. = 82+70.76 Rt. 27.0'  
STA. P.T. = 83+32.20 Rt. 33.56'

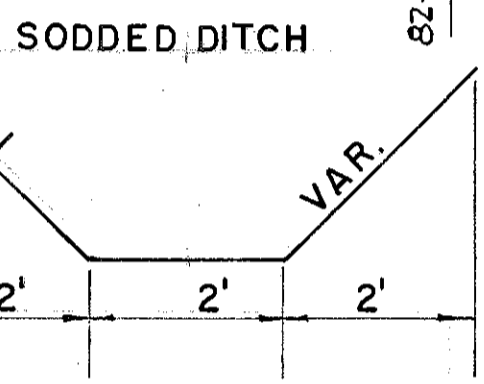

FOR PAVEMENT ELEVATIONS SEE SHEET 39

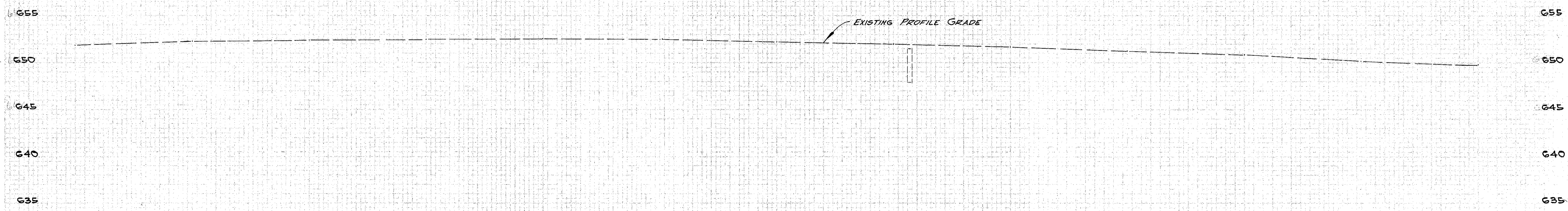

FED. RD. DIVISION	STATE	PROJECT
5	OHIO	T-407(0)

LUC-723-1,40

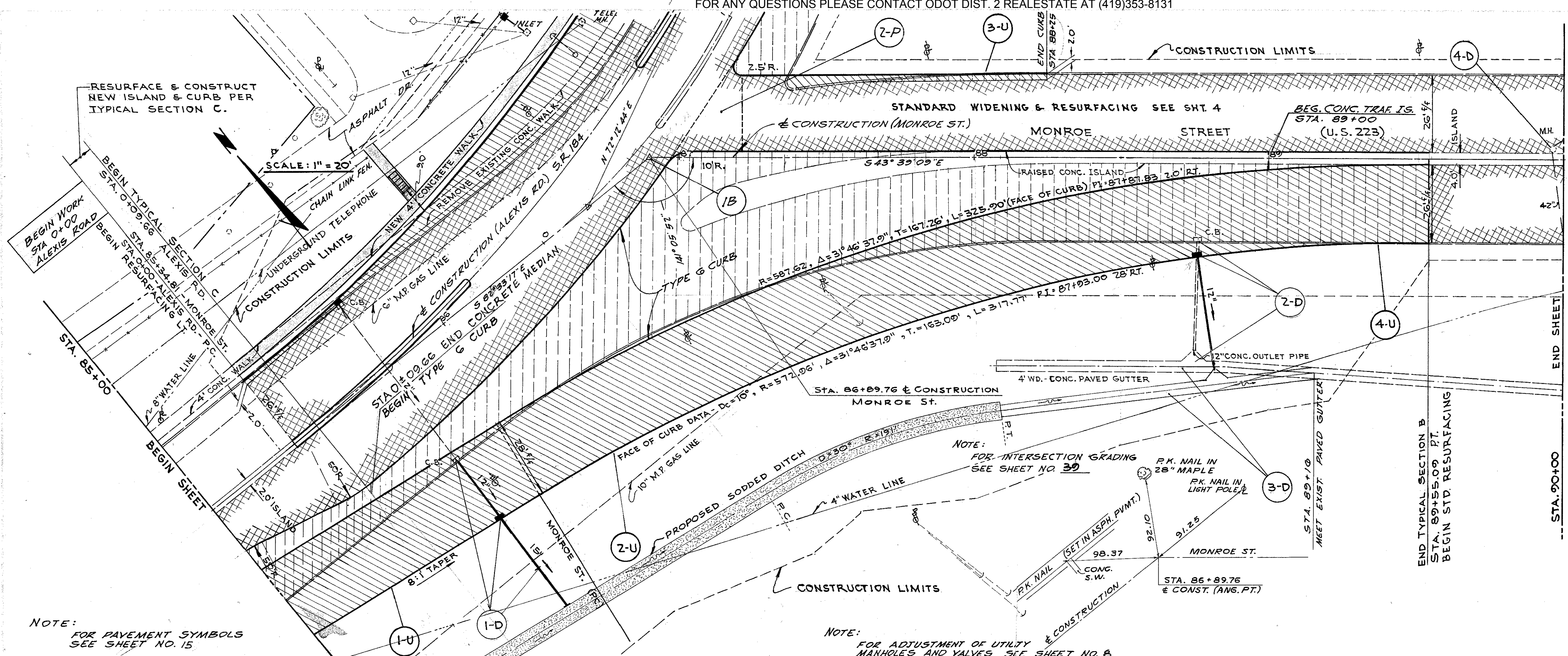

NOTE:  
FOR PAVEMENT SYMBOLS  
SEE SHEET NO. 15

NOTE:  
FOR ADJUSTMENT OF UTILITY  
MANHOLES AND VALVES SEE SHEET NO. 8

FOR PAVEMENT ELEVATIONS SEE SHEET 30.

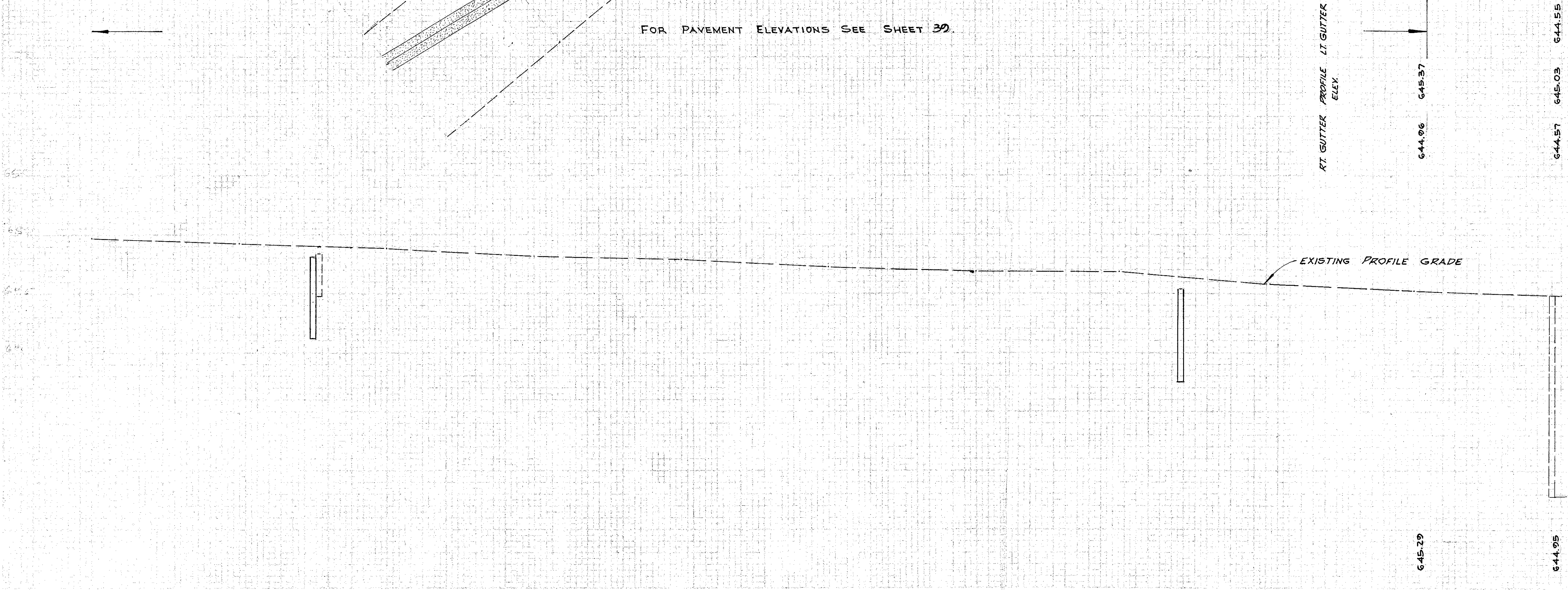

FED. RD. DIVISION	STATE	PROJECT	
5	OHIO	T-4017(9)	

LUC-223-140

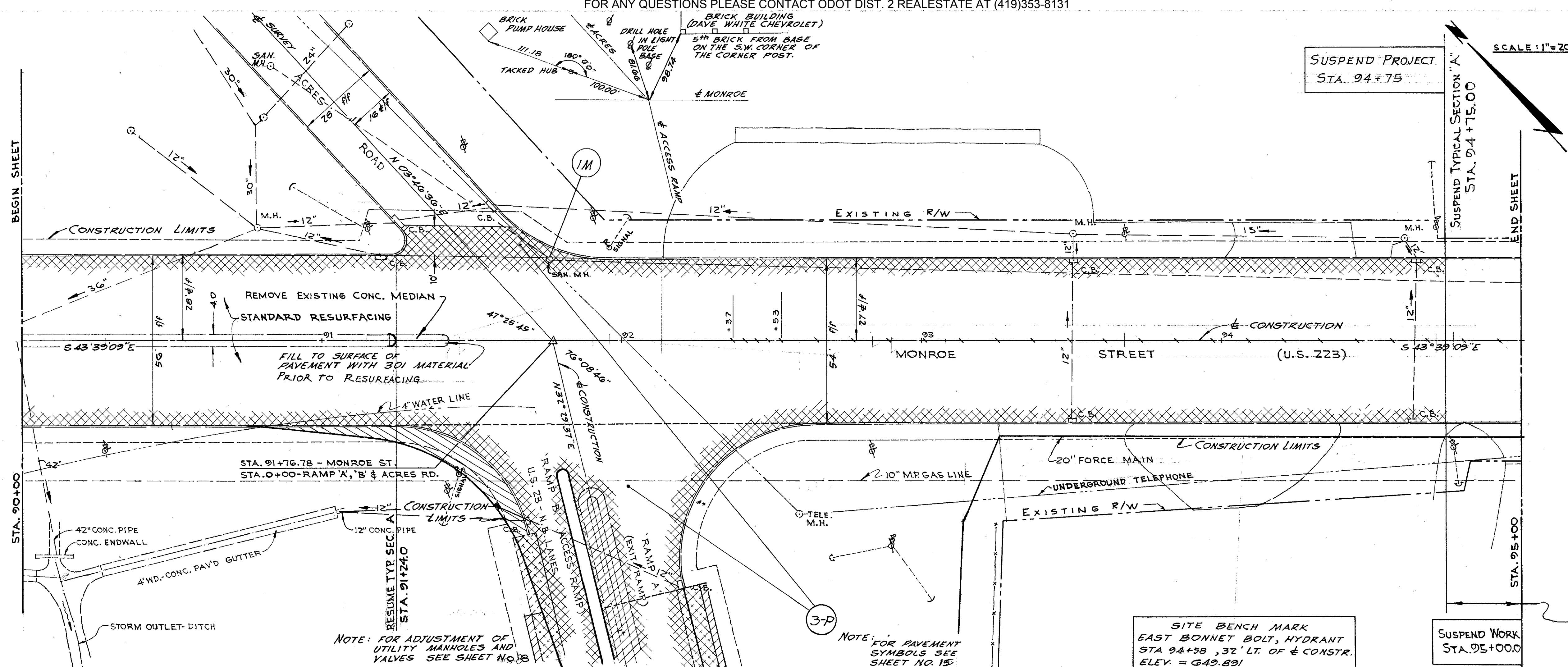

SUSPEND PROJECT  
STA. 94+75

SCALE: 1"=20'

SUSPEND TYPICAL SECTION "A"  
STA. 94+75.00

BEGIN SHEET

END SHEET

STA. 90+00

STA. 95+00

NOTE: FOR ADJUSTMENT OF UTILITY MANHOLES AND VALVES SEE SHEET NO. 18

NOTE: FOR PAVEMENT SYMBOLS SEE SHEET NO. 15

SITE BENCH MARK  
EAST BONNET BOLT, HYDRANT  
STA 94+58, 32' LT. OF & CONSTR.  
ELEV. = 649.891

SUSPEND WORK  
STA. 95+00.0

25' BUTT JOINT, SEE DETAIL SHEET NO. 4

FOR PAVEMENT ELEVATIONS SEE SHEET 40

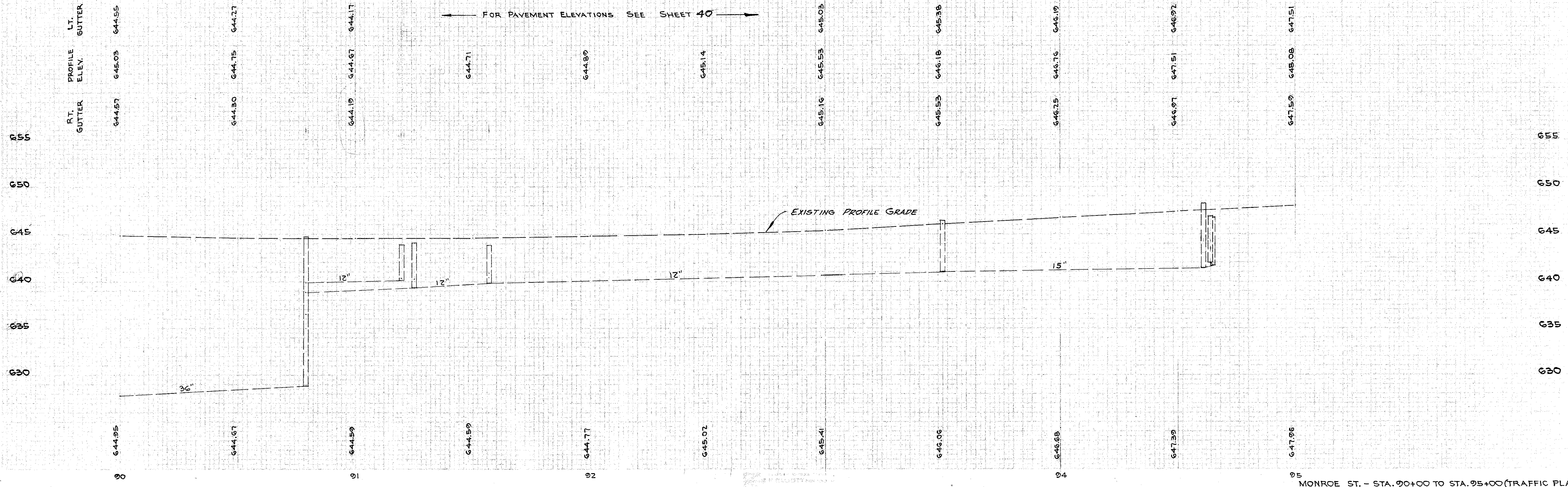

SCALE: 1"=20'

FED. RD. DIVISION	STATE	PROJECT
5	OHIO	T-4017(9)

19  
82

LUC-223-140

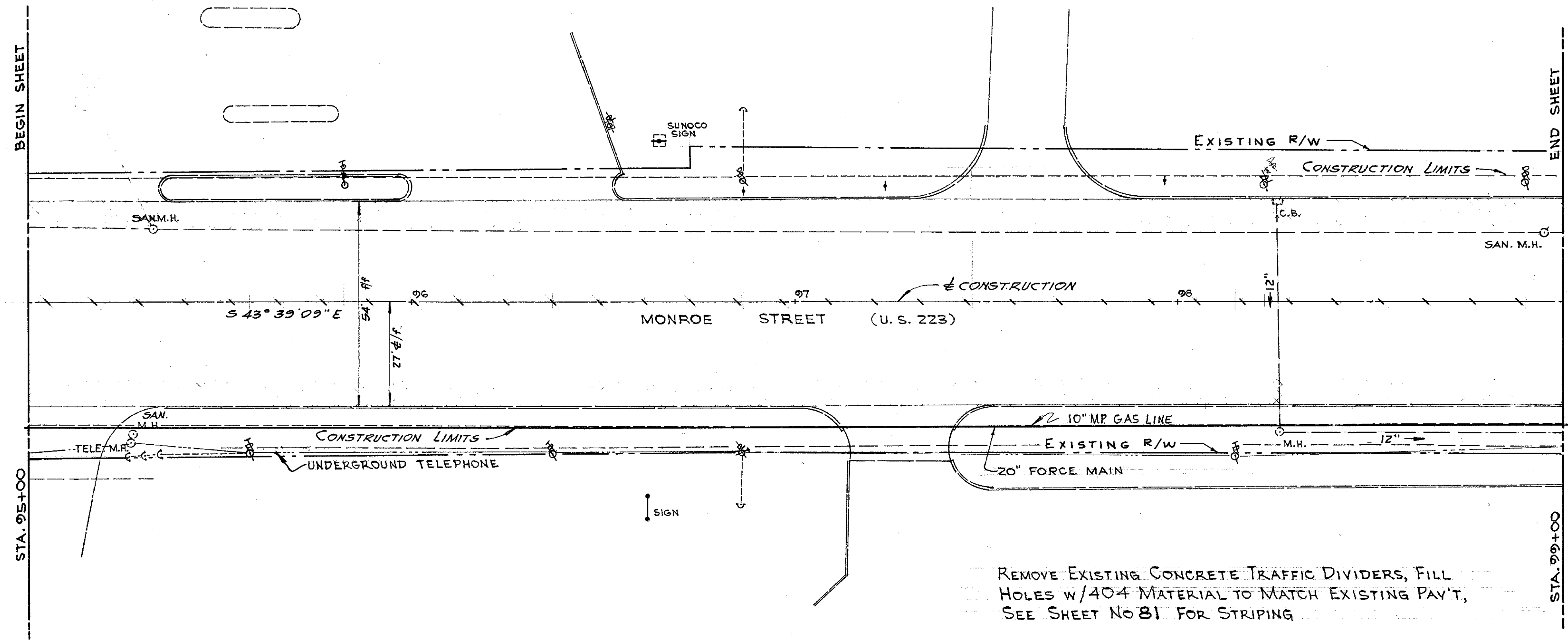

REMOVE EXISTING CONCRETE TRAFFIC DIVIDERS, FILL HOLES W/404 MATERIAL TO MATCH EXISTING PAY'T, SEE SHEET NO 81 FOR STRIPING

NOTE: FOR PAVEMENT SYMBOLS SEE SHEET NO. 15

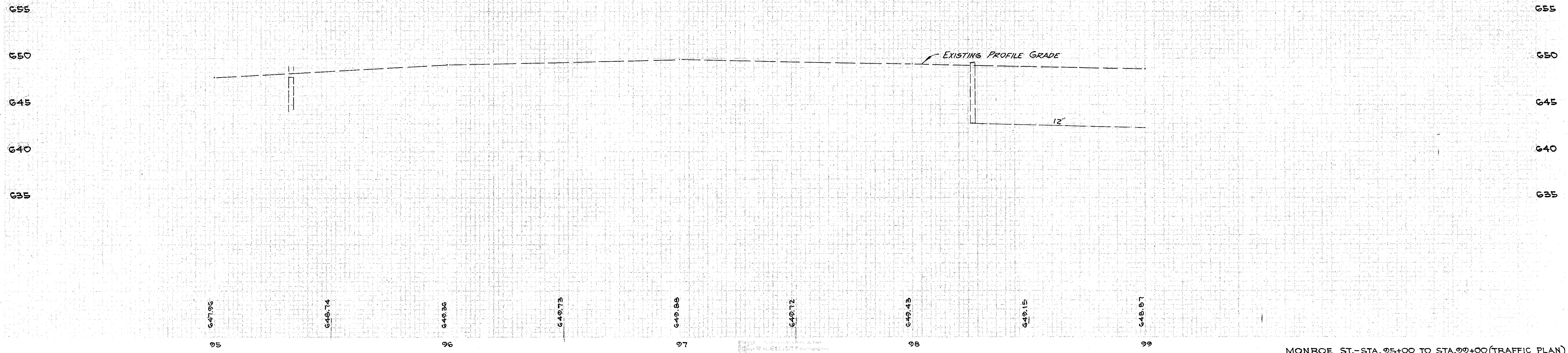

FED. RD. DIVISION	STATE	PROJECT
5	OHIO	T-4017(9)

SCALE: 1" = 20'

LUC-223-140

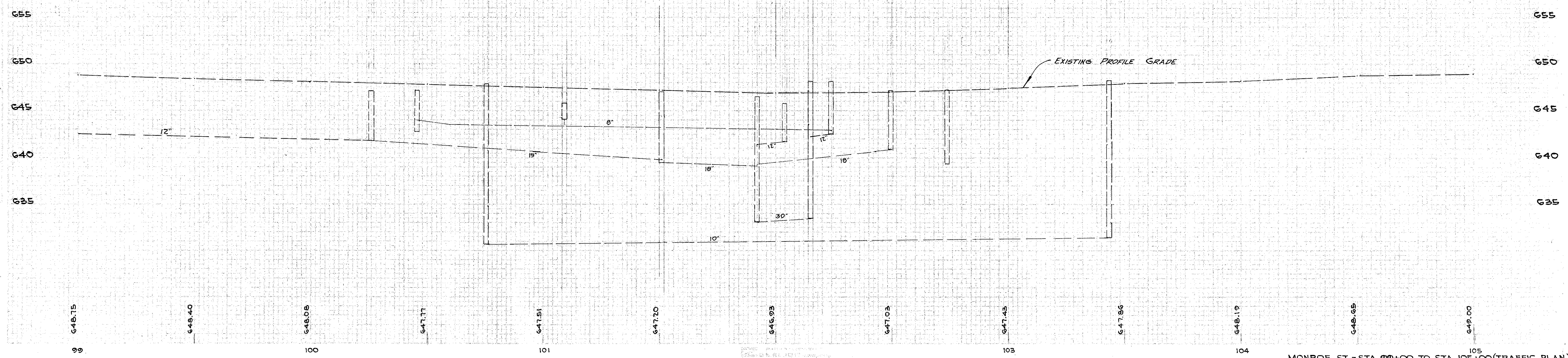
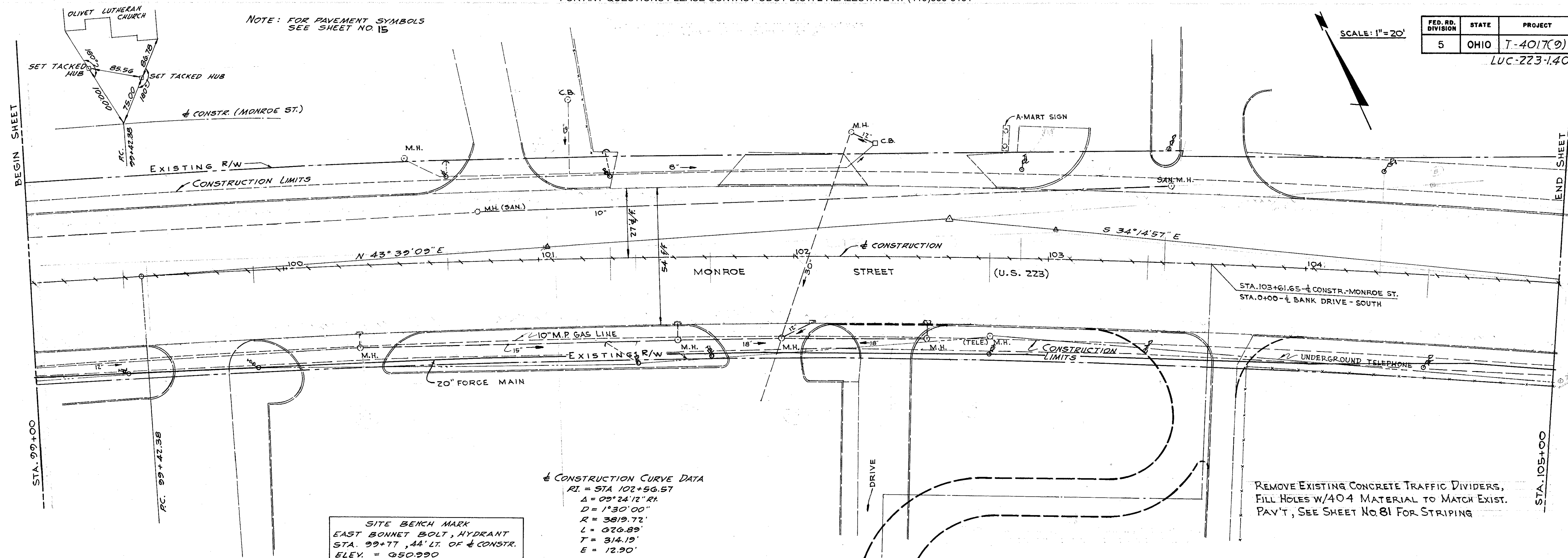

NOTE: FOR PAVEMENT SYMBOLS SEE SHEET NO. 15

SCALE: 1" = 20'

FED. RD. DIVISION	STATE	PROJECT
5	OHIO	T-4017(2)

LUC-223-1.40

21  
82

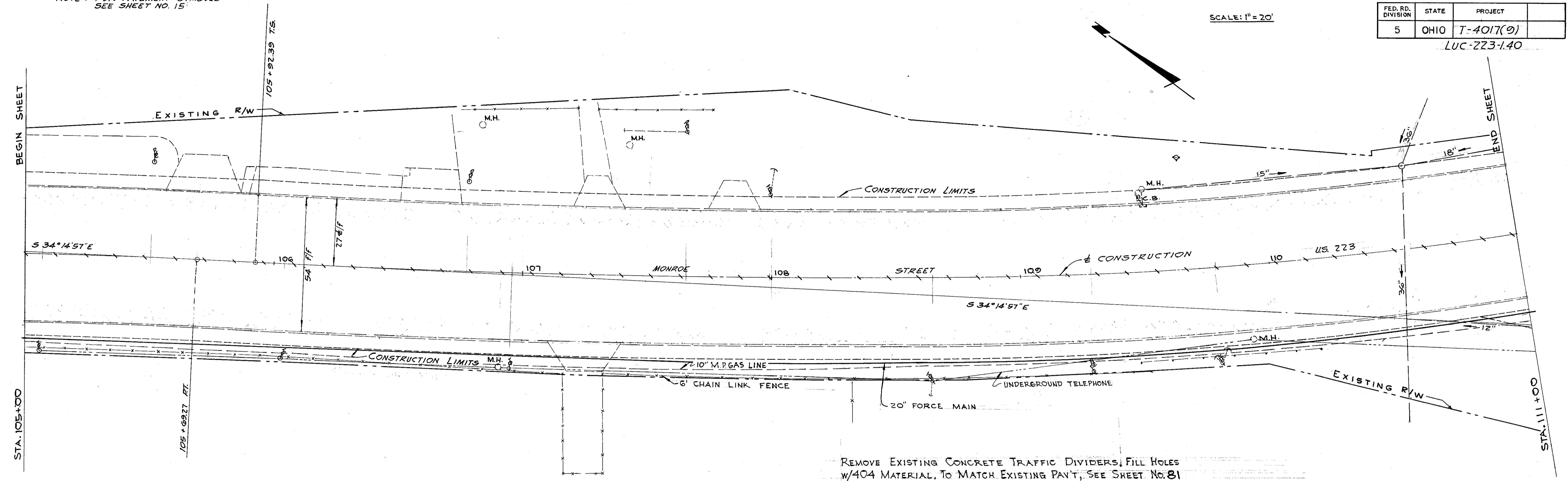

REMOVE EXISTING CONCRETE TRAFFIC DIVIDERS, FILL HOLES W/404 MATERIAL, TO MATCH EXISTING PAV'T, SEE SHEET NO. 81 FOR STRIPING

SITE BENCH MARK  
EAST BONNET BOLT, HYDRANT  
STA. 105+95, 43' LT. OF & CONSTR.  
ELEV. 651.619

SITE BENCH MARK  
EAST BONNET BOLT, HYDRANT  
STA. 109+66, 45' LT. OF & CONSTR.  
ELEV. 646.313

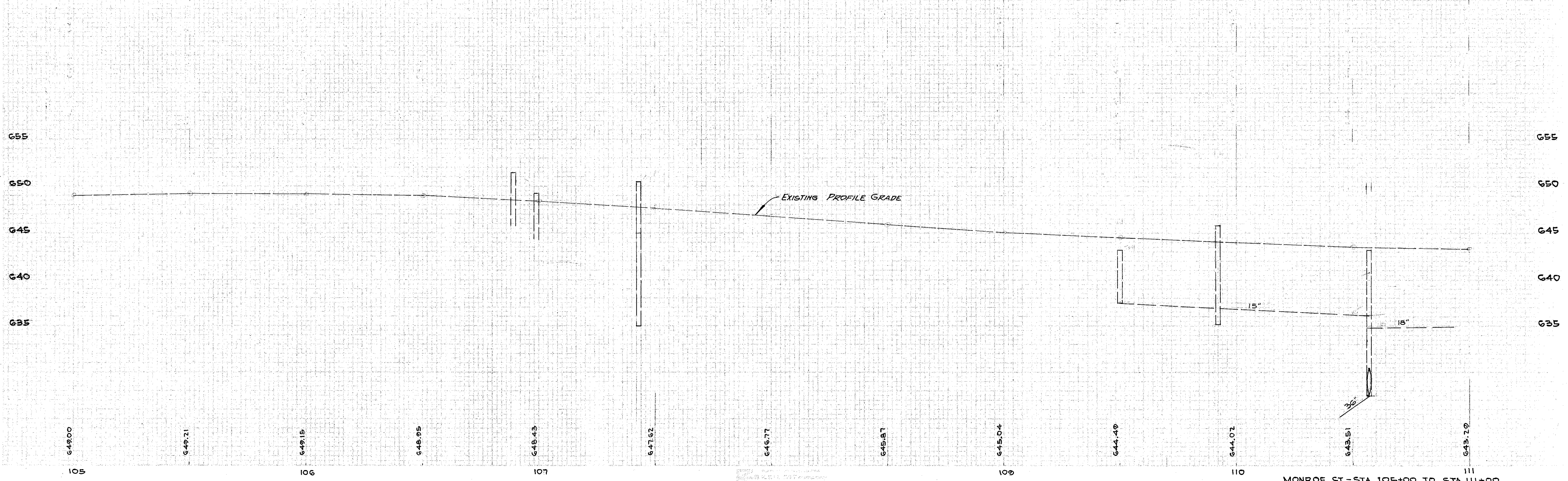

MONROE ST.-STA. 105+00 TO STA. 111+00



FED. RD. DIVISION	STATE	PROJECT
5	OHIO	T-4017(9)

LUC-223-140

CONSTRUCTION CURVE DATA  
 P.I. = STA. 111+63.90  
 $\Delta = 29^{\circ}0'0''$  LT.  $D_c = 4^{\circ}0'0''$   
 $T_s = 571.51$   $\theta_s = 8^{\circ}0'0''$   
 $E_s = 51.90'$   $L.T. = 266.94'$   
 $L_s = 400.00$   $S.T. = 133.58$   
 $L_c = 325.00$   $L.C. = 399.64$   
 $T.S. = 105+92.39$   $K = 199.87$   
 $S.C. = 109+92.39$   $P = 4.65$   
 $C.S. = 113+17.39$   $X_c = 399.22$   
 $S.T. = 117+17.39$   $Y_c = 18.59$

NOTE: FOR PAVEMENT SYMBOLS SEE SHEET NO. 15

NOTE: FOR ADJUSTMENT OF UTILITY MANHOLES AND VALVES SEE SHEET NO. 6

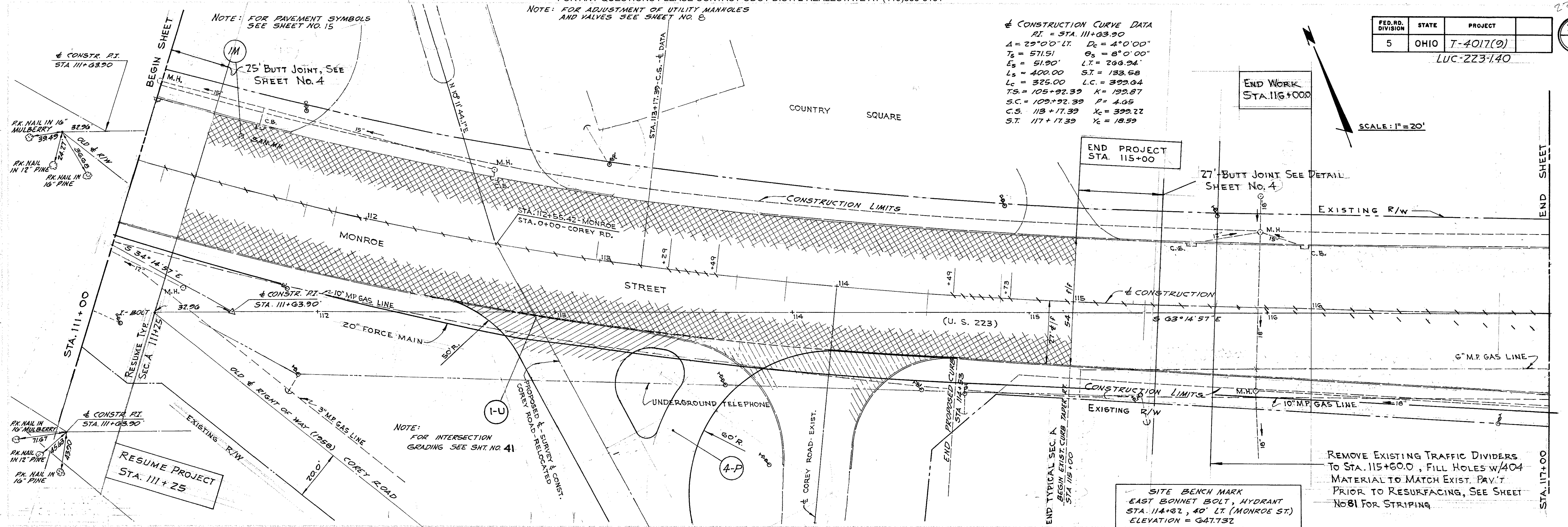

END WORK STA. 116+00

END PROJECT STA. 115+00

27' BUTT JOINT SEE DETAIL SHEET NO. 4

SCALE: 1" = 20'

RESUME PROJECT STA. 111+25

REMOVE EXISTING TRAFFIC DIVIDERS TO STA. 115+60.0, FILL HOLES w/404 MATERIAL TO MATCH EXIST. PAV'T PRIOR TO RESURFACING, SEE SHEET NO. 81 FOR STRIPING

SITE BENCHMARK EAST BONNET BOLT, HYDRANT STA. 114+62, 40' LT. (MONROE ST.) ELEVATION = 647.132

NOTE: FOR INTERSECTION GRADING SEE SHT. NO. 41

FOR PAVEMENT ELEVATIONS SEE SHEET 41

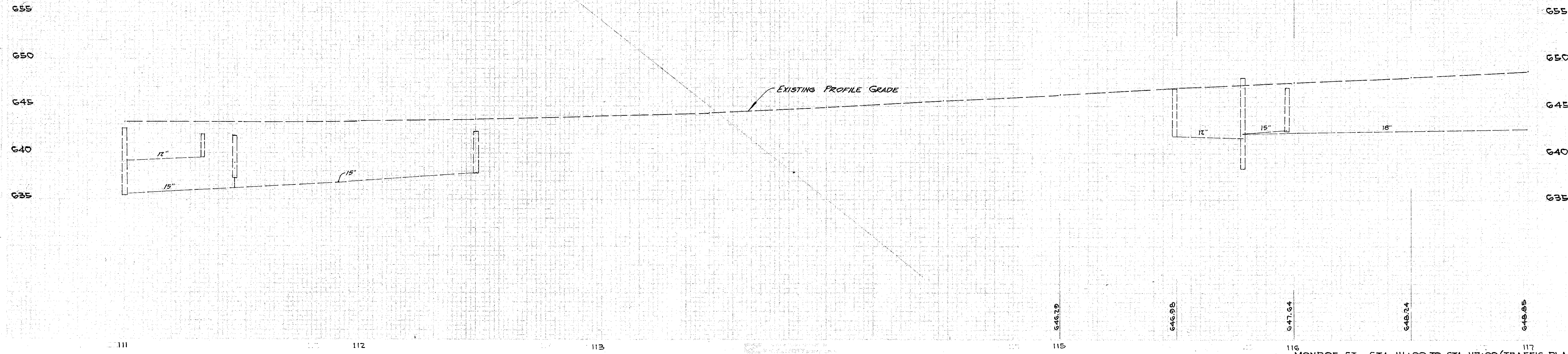

EXISTING PROFILE GRADE

646.29 646.98 647.64 648.24 648.85

FED. RD. DIVISION	STATE	PROJECT	
5	OHIO	T-4017(9)	

23  
87

LUC-223-140

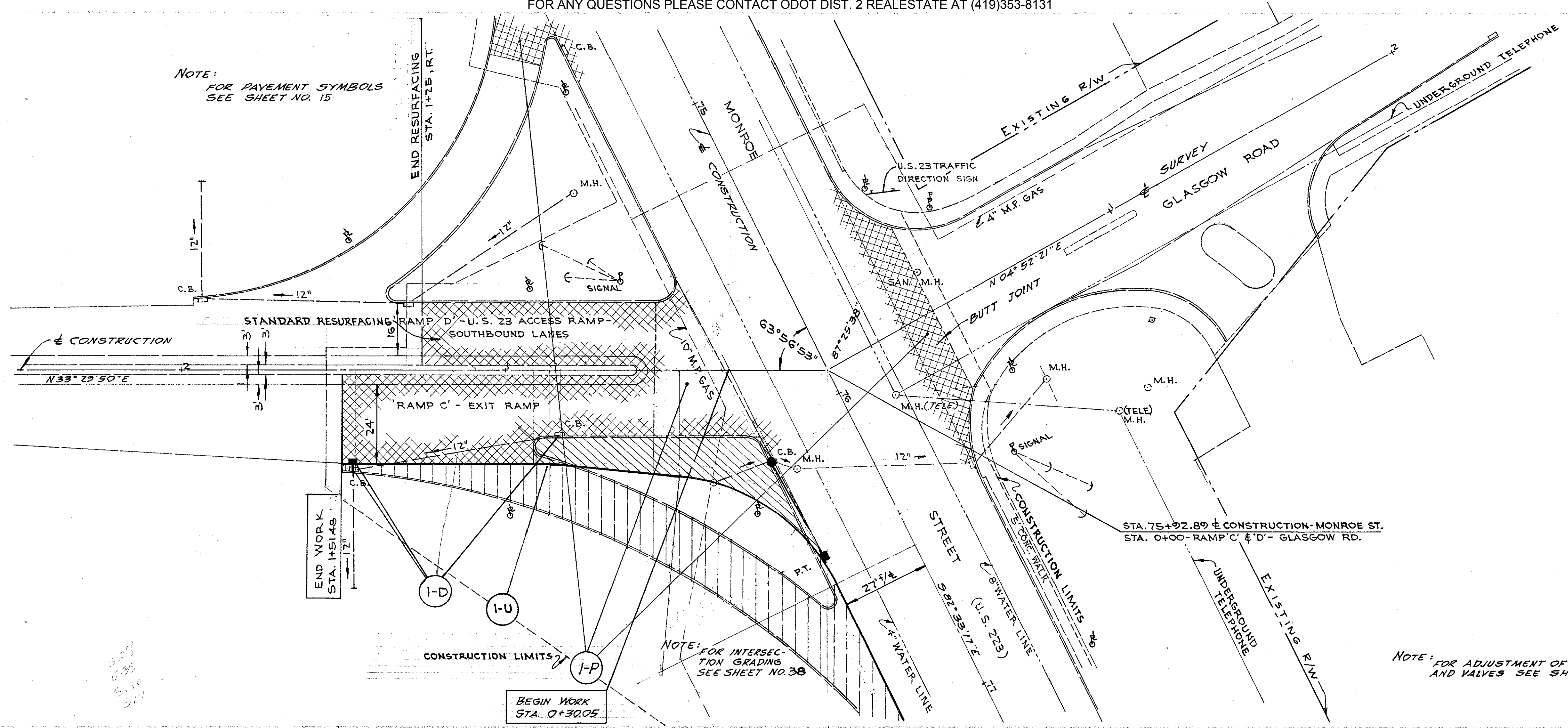
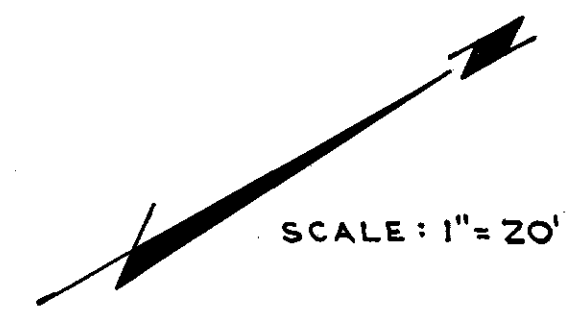

NOTE: FOR PAYEMENT SYMBOLS SEE SHEET NO. 15

NOTE: FOR INTERSECTION GRADING SEE SHEET NO. 38

NOTE: FOR ADJUSTMENT OF UTILITY MANHOLES AND VALVES SEE SHEET NO. 8

FOR PAVEMENT ELEVATIONS SEE SHEET 38

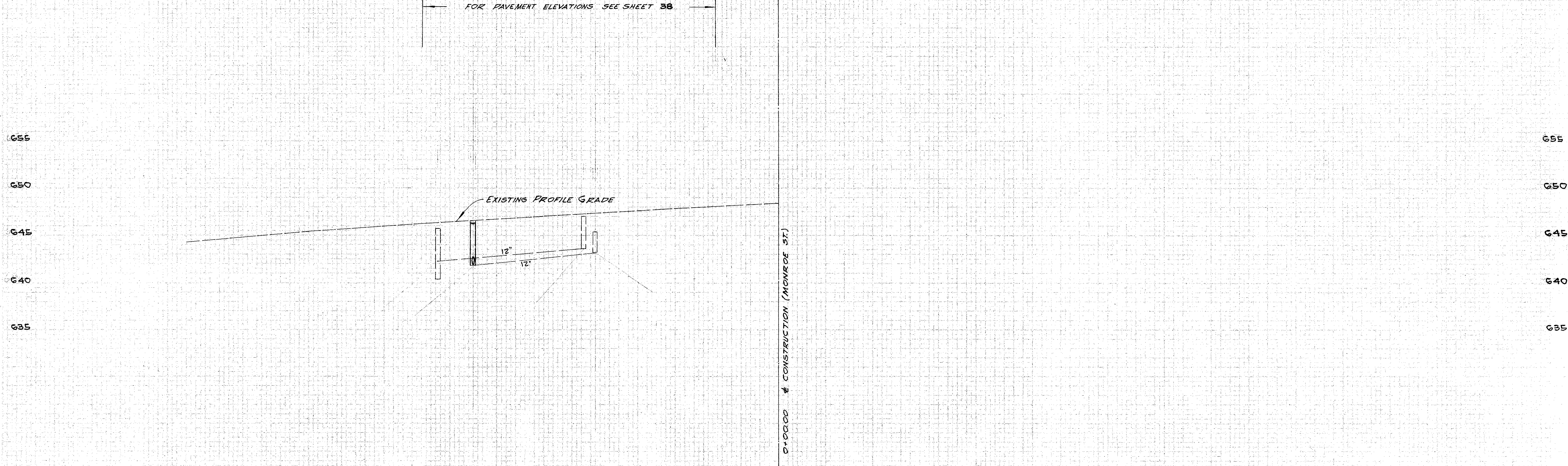

FED. RD. DIVISION	STATE	PROJECT
5	OHIO	T-4017(9)

LUC-223-140

24  
82

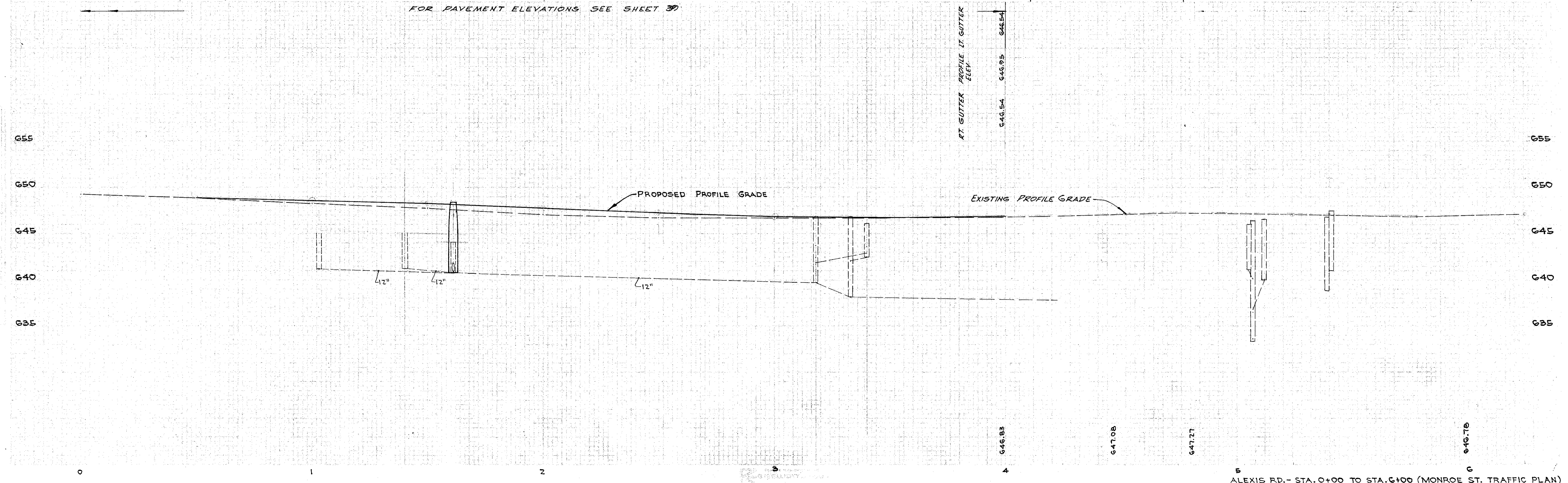
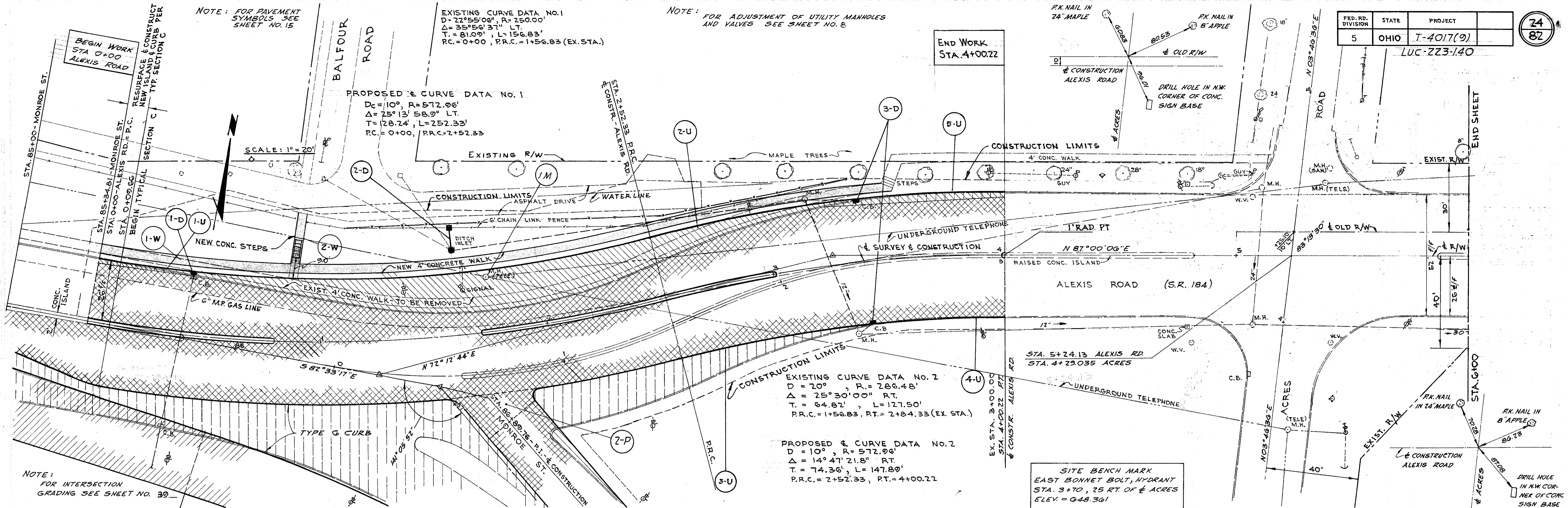

FED. RD. DIVISION	STATE	PROJECT	
5	OHIO	T-4017(9)	

25  
82

LUC-223-140

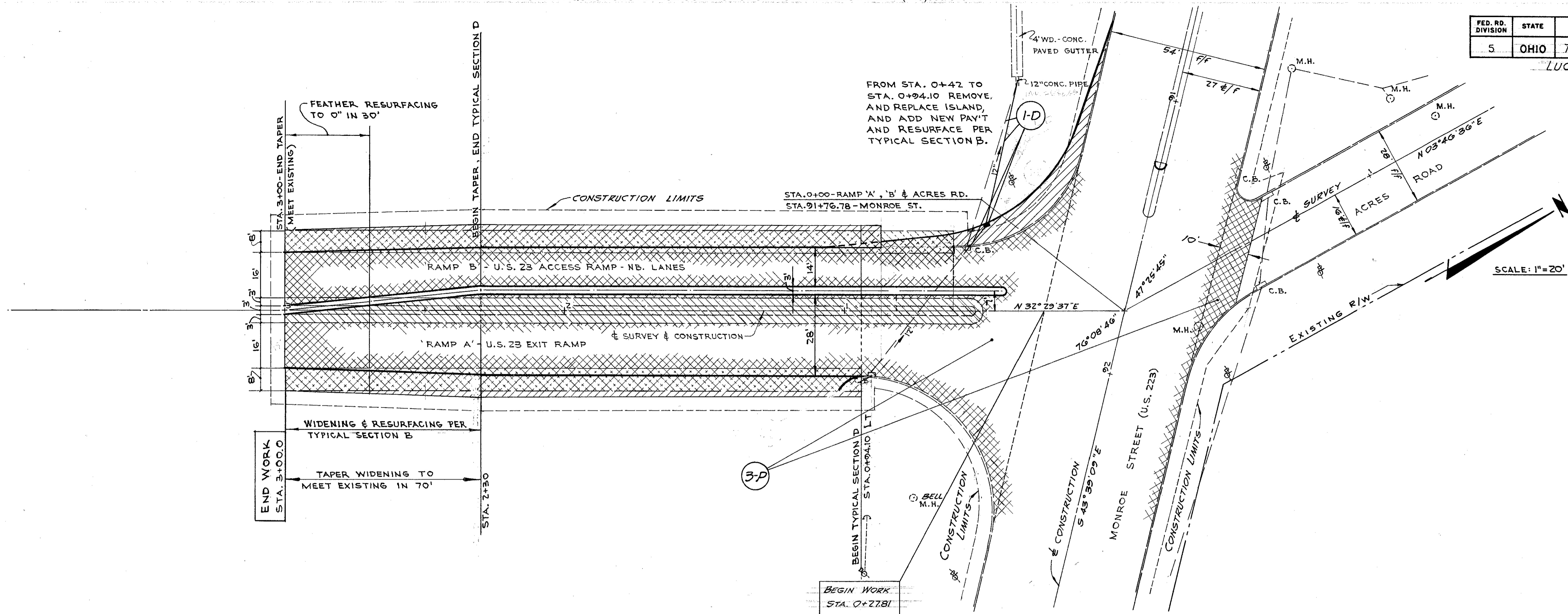

- NOTE: FOR PAVEMENT SYMBOLS SEE SHEET NO. 15
- NOTE: FOR ADJUSTMENT OF UTILITY MAN-HOLES AND VALVES SEE SHEET NO. 8
- NOTE: FOR INTERSECTION GRADING SEE SHEET NO. 40

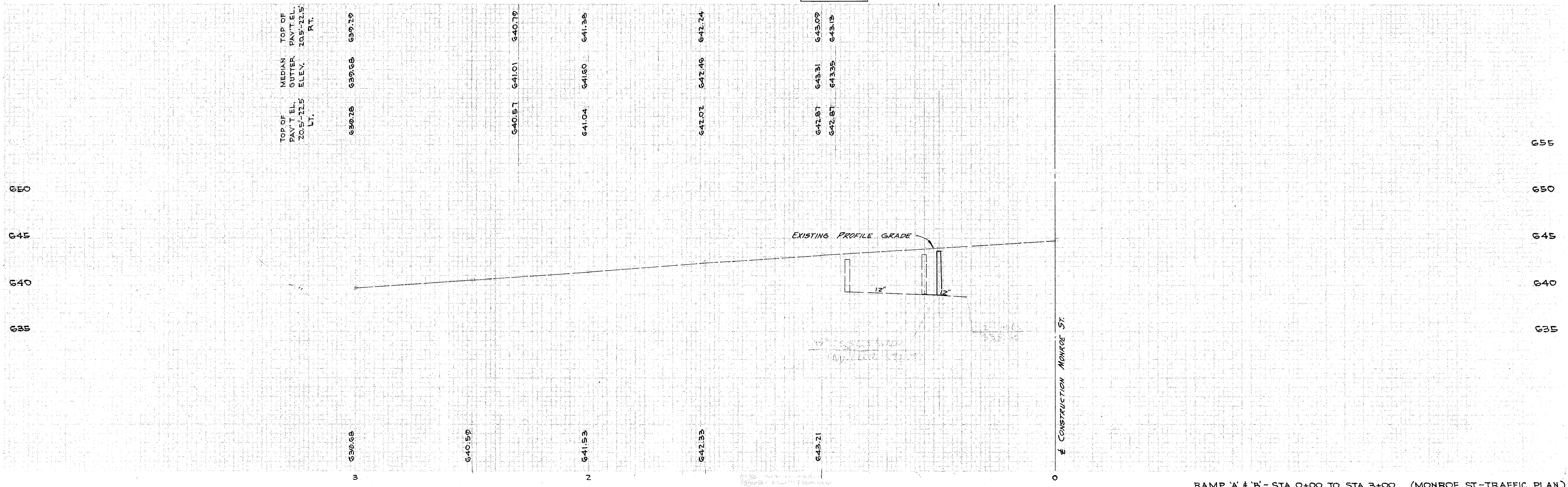

RAMP 'A' & 'B' - STA. 0+00 TO STA. 3+00 (MONROE ST.-TRAFFIC PLAN)

FED. RD. DIVISION	STATE	PROJECT
5	OHIO	T-4017(9)

LUC-223-140

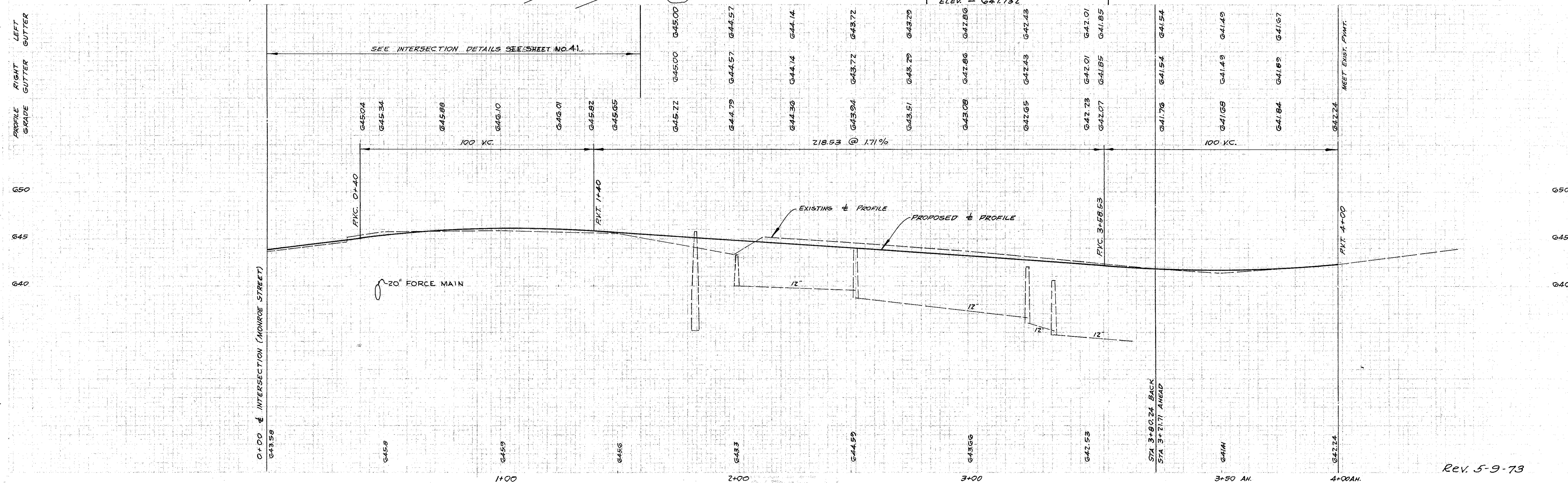
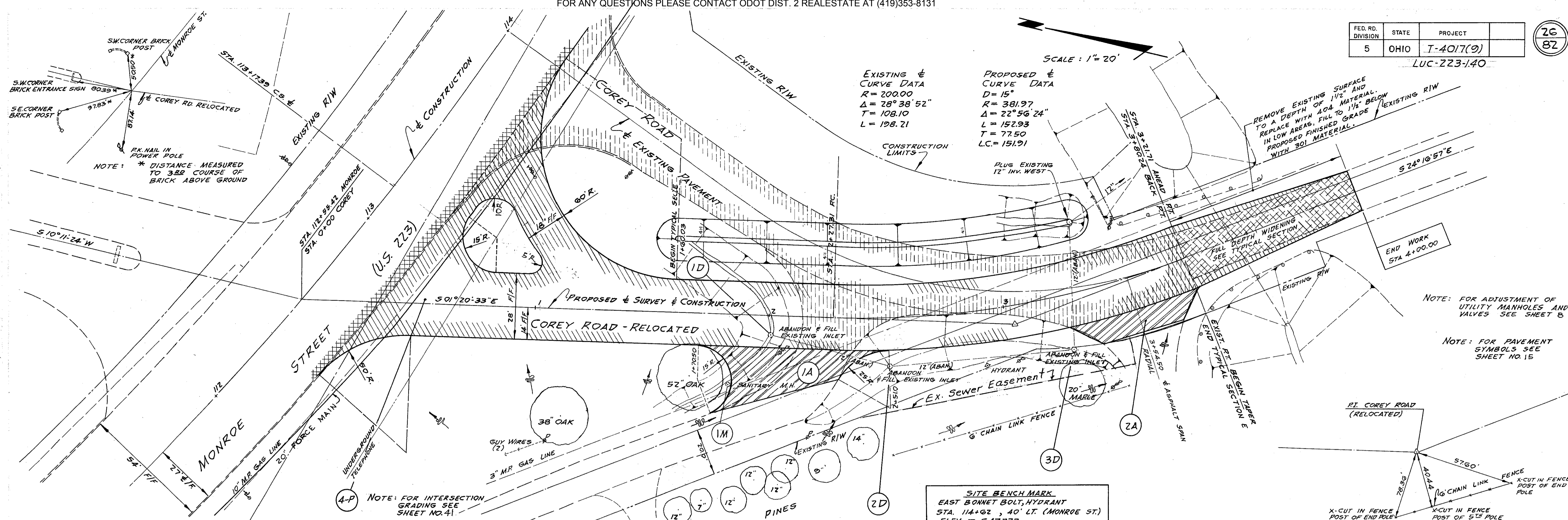

Rev. 5-9-73

COREY ROAD RELOCATED (MONROE ST. TRAFFIC PLAN)