

O.D.O.T. DISTRICT 2 SURVEY OFFICE (USE ONLY)

PERSONNEL _____

REFERENCE NO. 2 GH

SHEET 7 OF 8

NOTES LOEHRKE

DATE 10/11/95

ROUTE SR 51

H.C. ROUSOS

WEATHER NICE

COUNTY LUCAS

R.C. CANTERBURY

TEMP. 75°

TOWNSHIP CITY OF TOLEDO

DWG BY NIESE

PID _____

SECTION 7

T 10 S R 8 E

TYPE MONUMENT MONBOX

ON SURFACE - ~~BELOW~~ ON

OFFSET C PAVEMENT ON LT : RT

- TO - EDGE PAVEMENT

STATION: 93+10

HORZ.DATUM: _____

GEOID: _____

GRID: NORTHING: _____

EASTING: _____

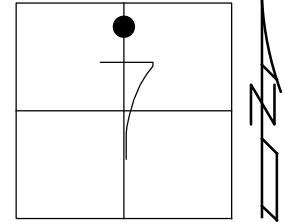

RECORD:
FD MONBOX
9" ROUND
10/11/95, CL

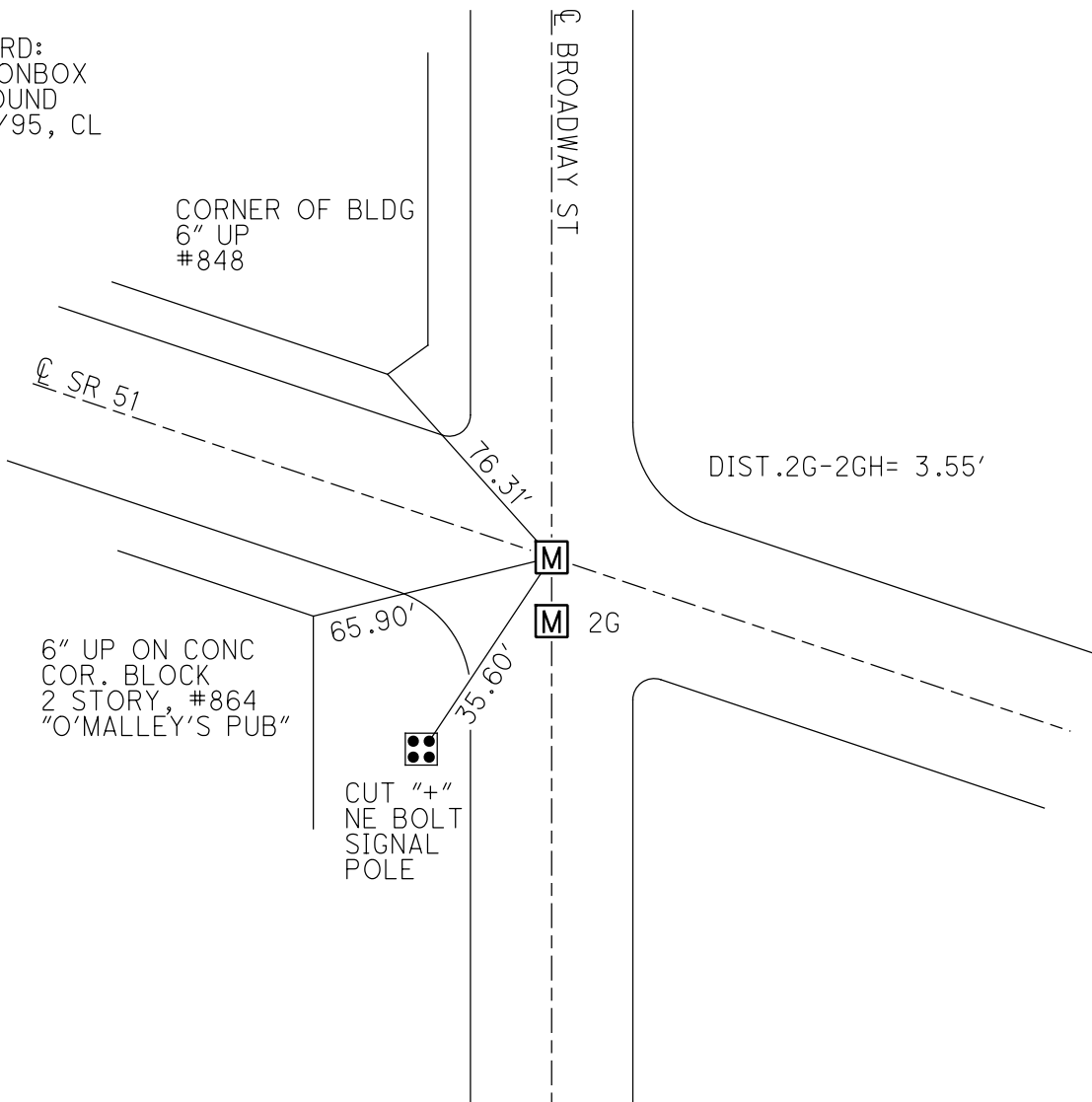

O.D.O.T. DISTRICT 2 SURVEY OFFICE

PERSONNEL

REFERENCE NO. 2 "G"

SHEET _____ OF _____

NOTES LOEHRKE

H.C. ROUSOS

R.C. CANTERBURY

DATE 10/11/95

WEATHER NICE

TEMP. +75°

ROUTE S.R. 51

COUNTY LUCAS

TOWNSHIP _____

SECTION _____

T _____ R _____

TYPE MONUMENT MAN BOX

ON SURFACE - BELOW ON SURFACE

LEFT - Q PAVT. - RIGHT ON Q

TO EDGE PAVEMENT

S.L.M. PT "A" = 93+09 PT "B" = 93+10

SLM = 1.77 (BOOK)

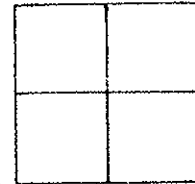

NOTE: FO 2 MON BOXES, BOTH ARE ROUND W/ 9" LIDS.

