

PERSONNEL	TITLE	PERSONNEL	TITLE
W. DENNO			
D. CURTIS			
R. BRANNAN			

COUNTY LUCAS DATE AUGUST 30, 1971
 S. R. # 223 WEATHER SUNNY
 SEC. _____ TEMP. 85°±

DESCRIPTION REFERENCES TO CONTROL POINTS JOB NO. _____

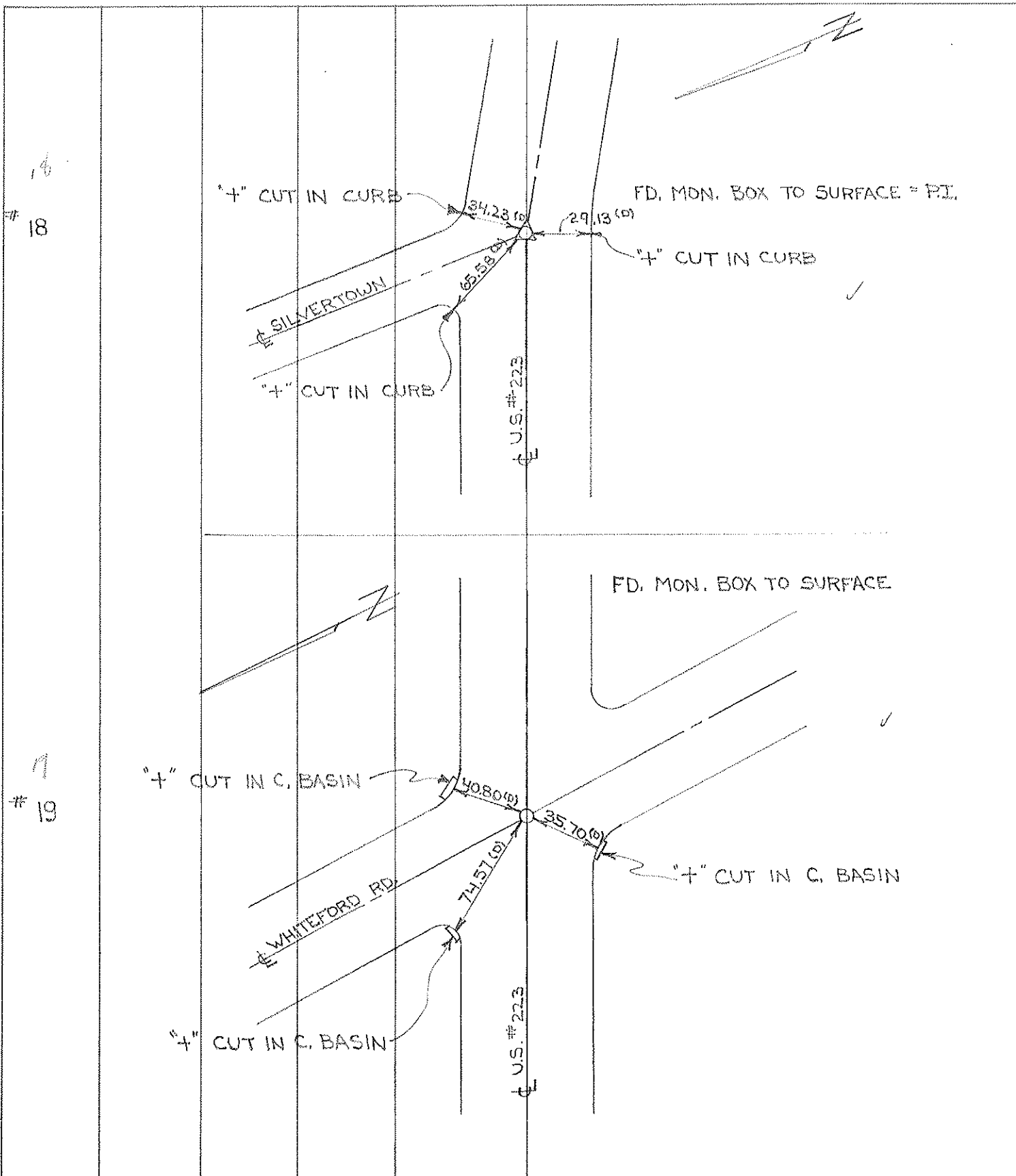

18

19

PERSONNEL	TITLE	PERSONNEL	TITLE	COUNTY	DATE	WEATHER	TEMP.
Danno				Lucas	May 4, 1966	Sunny	50'
Curtis				S. R. 203			
Omel				SEC.			
Granata							

DESCRIPTION Monument Reference 203 Monroe St. JOB NO. _____

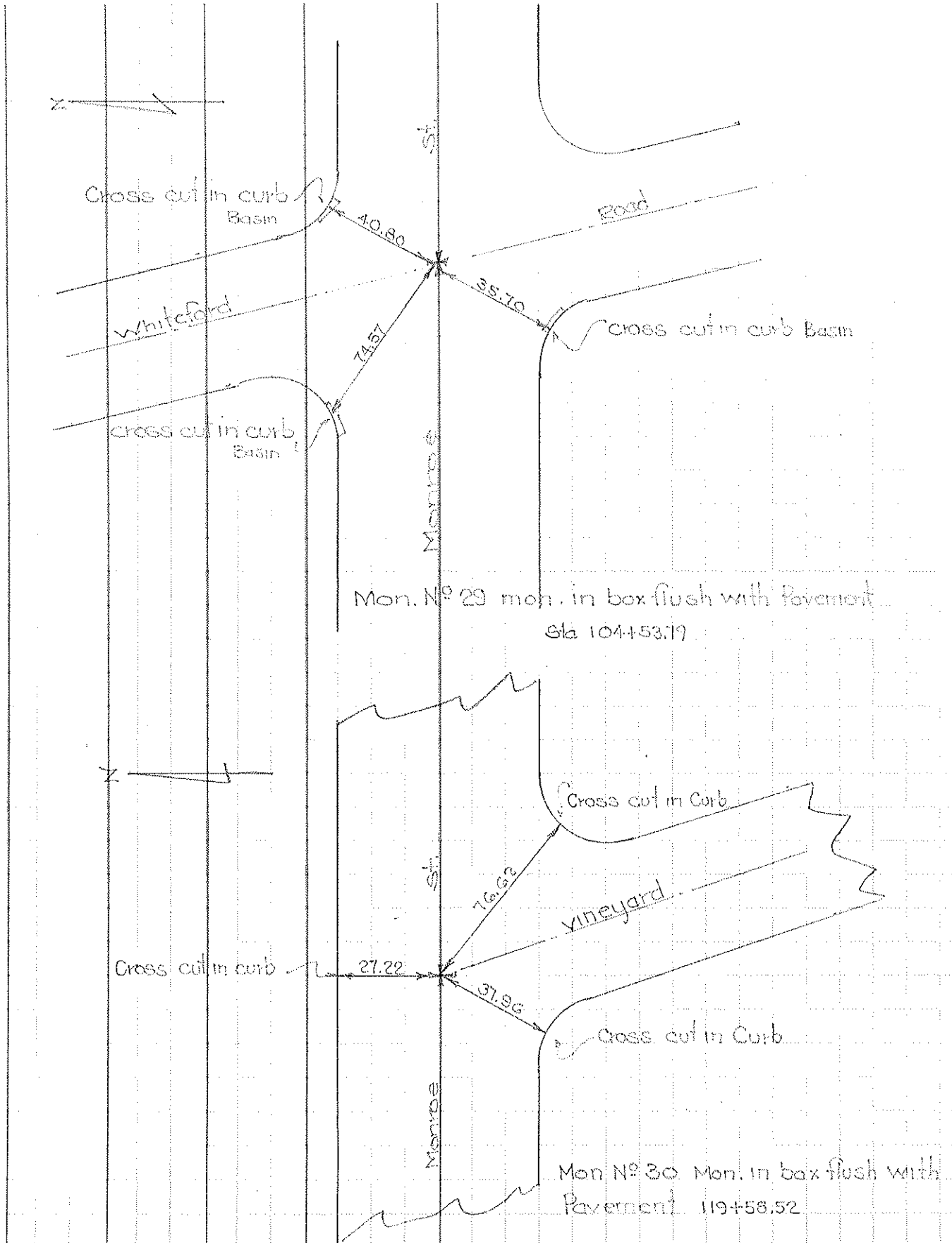

PERSONNEL	TITLE	PERSONNEL	TITLE	COUNTY	DATE
Stone				Lucas	7 Mar. 62
+				S. R. 223	WEATHER Mild
Grow				SEC.	TEMP. 33°
DESCRIPTION				References to Control Pts.	JOB NO. 02263
	LEFT	CENTER LINE	RIGHT		

142+32.76 -	+	Skelly Dr. (Set PK Nail)	$\Delta = 0^{\circ} 00'$
37.44'	N.	To skinner in	B
82.14'	S.E.	To skinner in	B
45.52'	S.W.	To skinner in	B
153+22.71 -	+	White Sand Rd. (Set Monument)	$\Delta = 0^{\circ} 57' Rt.$
63.78'	N.E.	To "4" in S. End Pump Island	
81.02'	N.W.	To skinner in	B
41.38'	S.S.W.	To skinner in	B
164+52.27 -	+	Laskoy Rd. (Set PK Nail)	$\Delta = 0^{\circ} 00'$
61.31'	N.W.	To skinner in	B
85.42'	S.E.	To skinner in	B
84.32'	S.W.	To skinner in	B
165+42.71 -	+	Colgate (Set PK Nail)	$\Delta = 0^{\circ} 00'$
65.32'	S.W.	To skinner in	B
38.27'	N.	To skinner in	B
92.81'	S.E.	To skinner in	B
168+25.15 -	+	Vineyard (Set Monument)	$\Delta = 0^{\circ} 19' Rt.$
58.00'	N.W.	To skinner in	B
87.48'	N.E.	To skinner in	B
97.00'	S.	To skinner in	B

1 Town 95 Range 6E
E 1/4 Corner of Sections 13

Kind of Monument **BR. PLATE** Remarks **SET FLUSH**

WITH CONC. SURF.

FOUND SET 9-10-37 BY **C. BALLMAN**

N. & S. Road **TALMADGE RD.** F. B. P.

E. & W. Road **241935. of Monroe St F. B. P.**

~~800~~ S. OF **MONROE ST.**

Date Checked:

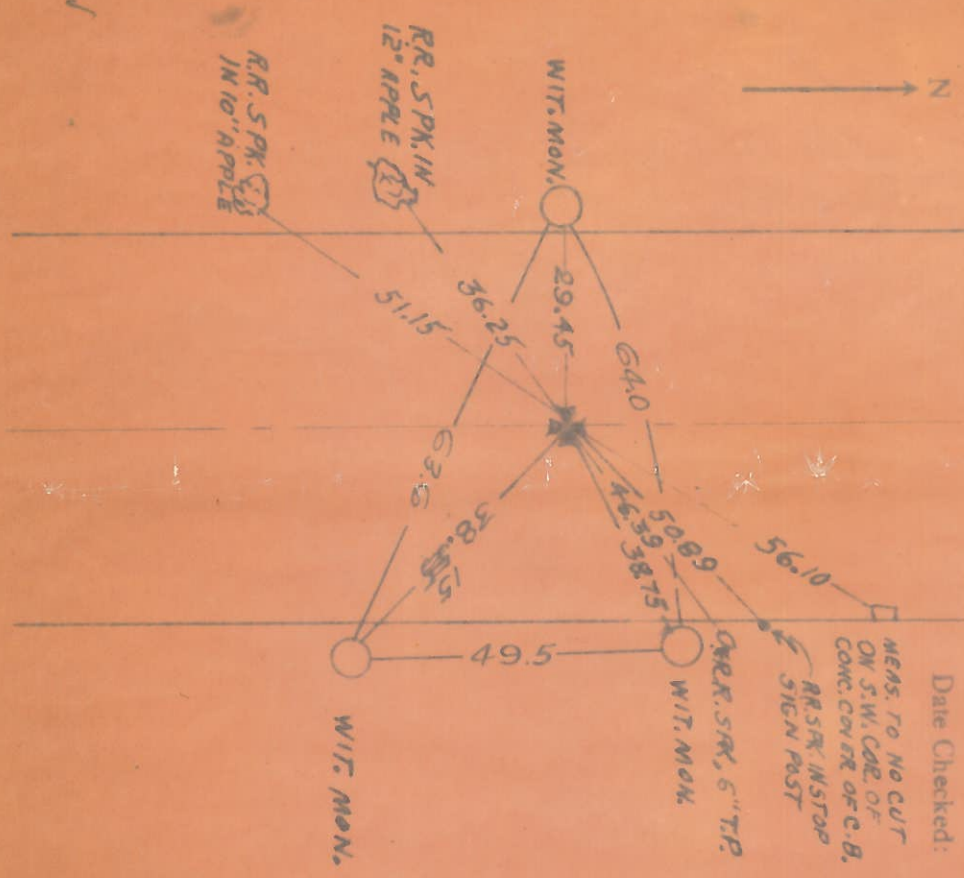

1/4 Town 95 Range 6E
Corner of Sections 13-14

Kind of Monument **STONE** Remarks

BOLT AT SURF SET 8-28-45

FOUND SET 8-28-45 BY **WILSON**

N. & S. Road **WHITEFORD RD.** F. B. P.

E. & W. Road **CHERRINGTON RD.** F. B. P.

Date Checked:

20 HOFFMAN
37 BALLMAN
42 MAYERS
1950 Miller

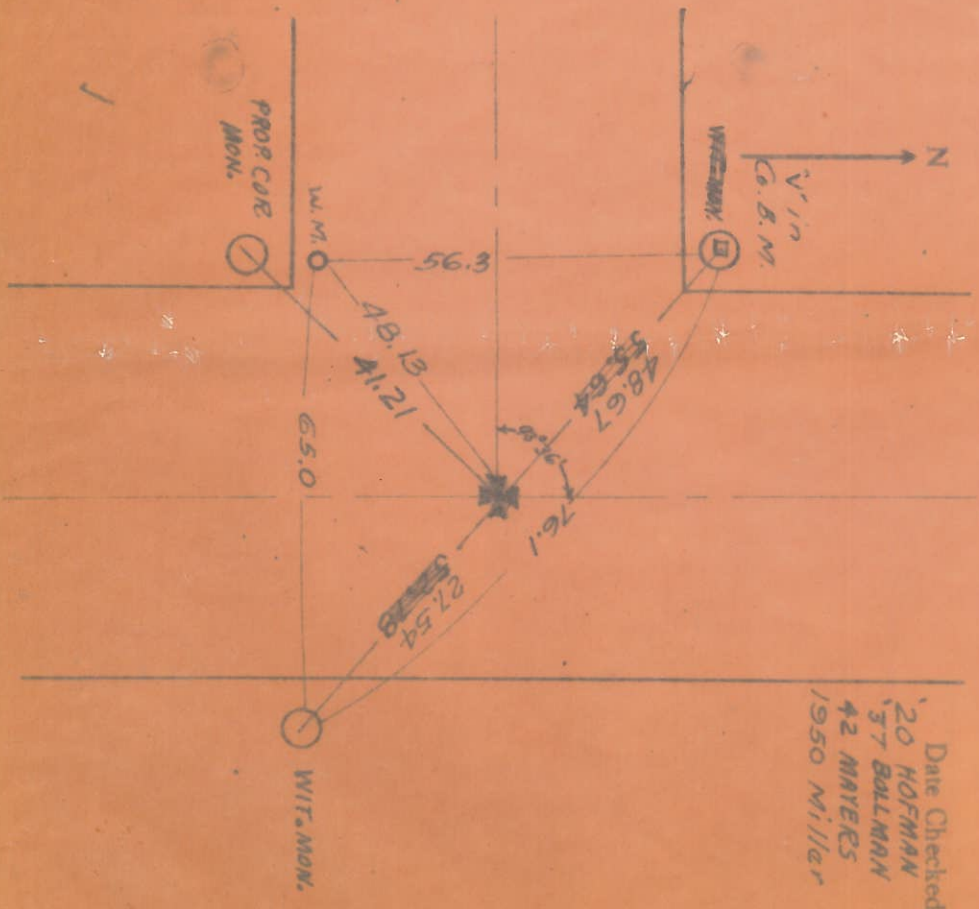

(26)

Town 95 Range 6E

COR. Corner of Sections 11-12-13-14
Kind of Monument IRON BOLT Remarks AT SURF.

FOUND SET 8-28-45 BY WILSON

N. & S. Road WHITEFORD RD. F. B. P.
E. & W. Road ~~150's~~ of Monroe St. F. B. P.

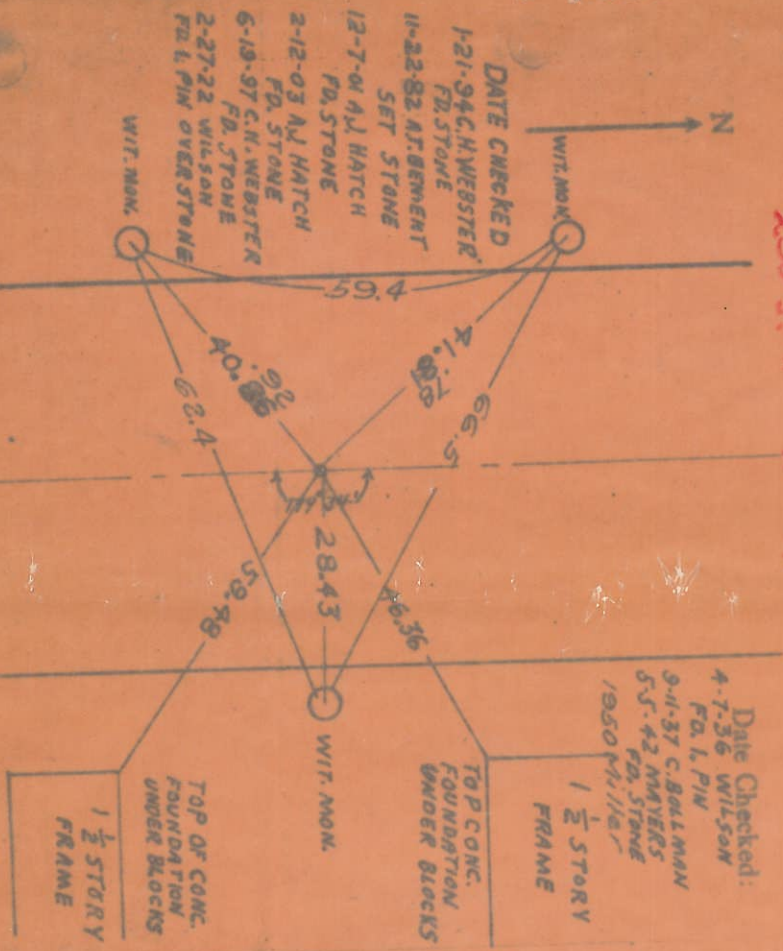

(27)

Town 95 Range 6E
1/4 Corner of Sections 11-12

Kind of Monument IRON PIN Remarks HOLE IN
CEN. FLUSH WITH TAR SURF. SETS WIT. MON.

FOUND SET 9-11-37 BY C. BOLLMAN

N. & S. Road WHITEFORD RD. F. B. P.
E. & W. Road Mc GREGOR LANE F. B. P.

