

FED. RD. DIVISION	STATE	PROJECT	FISCAL YEAR
2	OHIO		1950

1/6

LUCAS COUNTY
LUC-24-25.38
LUC-23-(3.20-3.60)

STATE OF OHIO
DEPARTMENT OF HIGHWAYS

LUC-24-25.38 LUC-23-(3.20-3.60)

LUCAS COUNTY

CITY OF TOLEDO

352

CONVENTIONAL

- COUNTY LINE
- TOWNSHIP LINE
- SECTION LINE
- CORPORATION LINE
- FENCE LINE
- CENTER LINE
- POLE LINE
- RAILROAD
- GUARD RAIL

SIGNS

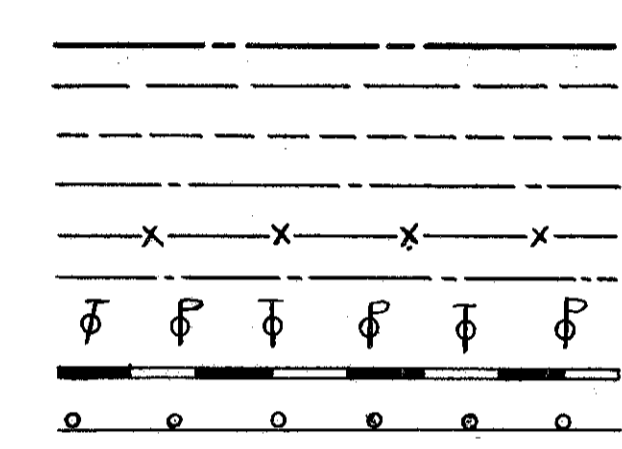

INDEX OF SHEETS

TITLE SHEET	1
TYPICAL SECTIONS	2
GENERAL SUMMARY	3
GENERAL NOTES	3
PAVEMENT COMPUTATIONS	3
PLAN & PROFILE	4-5-6

LINE DATA

BEGIN PROJECT STA. 1368+36.75
END PROJECT STA. 1397+17
GROSS LENGTH = 2880.25 LIN. FT.
DEDUCT FOR BRIDGE 116.00 LIN. FT.
NET LENGTH = 2764.25 LIN. FT. = 0.523 MI.

END PROJECT
STA. 1397+17

BEGIN PROJECT
STA. 1368+36.75

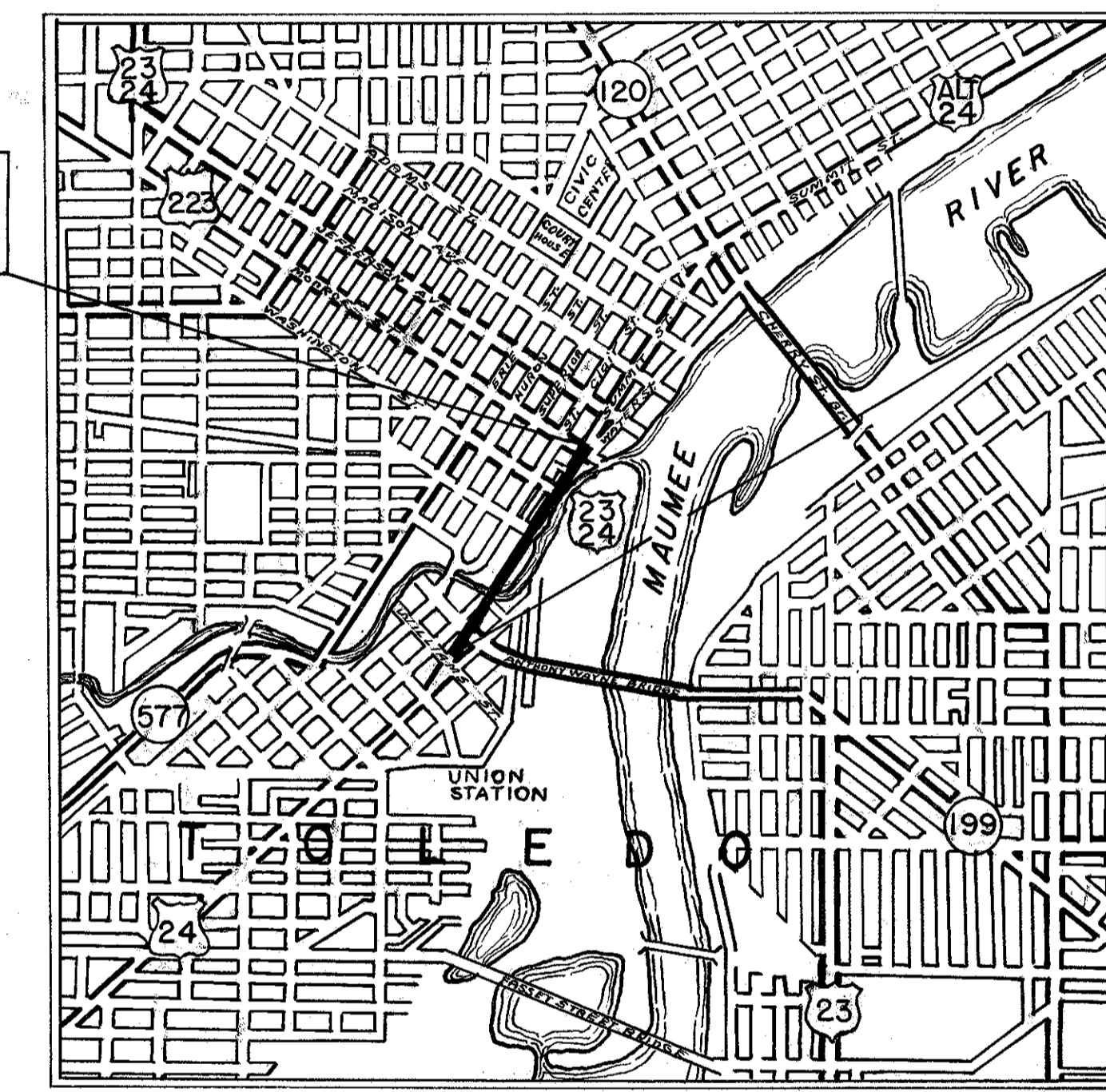

LOCATION PLAN

Scale 1" = 1,760'



SCALES

PLAN	1" = 50'
PROFILE HORIZONTAL	1" = 50'
PROFILE VERTICAL	1" = 5'
CROSS SECTIONS	NONE

The Standard Specifications of the State of Ohio, Department of Highways, including changes and Supplemental Specifications listed in the proposal Shall Govern this Project.

The right of way necessary for this improvement will be provided by the State of Ohio.

I hereby approve these plans and declare that the making of this improvement will not require the closing to traffic of the highway and that provisions for the maintenance and safety of traffic will be as set forth on the plans and estimates.

- Approved: George W. Rieher
Date: 1/31/50 Division Deputy Director
- Approved: _____
Date: _____ Chief Engineer, Bureau of Maintenance
- Approved: _____
Date: _____ Chief Engineer, Bureau of Bridges & R.R. Crossings
- Approved: W. J. Kogambler
Date: 1-27-50 Chief Engineer, Bureau of Location & Design
- Approved: W. J. Kogambler
Date: 1-27-50 First Asst. Director & Chief Engineer
- Approved: W. J. Kogambler
Date: 1-31-50 Director of Highways

SUPPLEMENTAL SPECIFICATIONS		STANDARD	DRAWINGS
31	6-13-49	NONE	

CONSTRUCTION BUREAU
JUN 29 1950
GROUND PHOTOLAB

FILE NO.	LUCAS COUNTY LUC-24-25.38
NO.	LUC-23-(3.20-3.60)
DATE OF LETTING	
CONTRACT NO.	

352

LUCAS COUNTY
LUC. - 24 - 25.38
LUC. - 23 - (3.20-3.60)

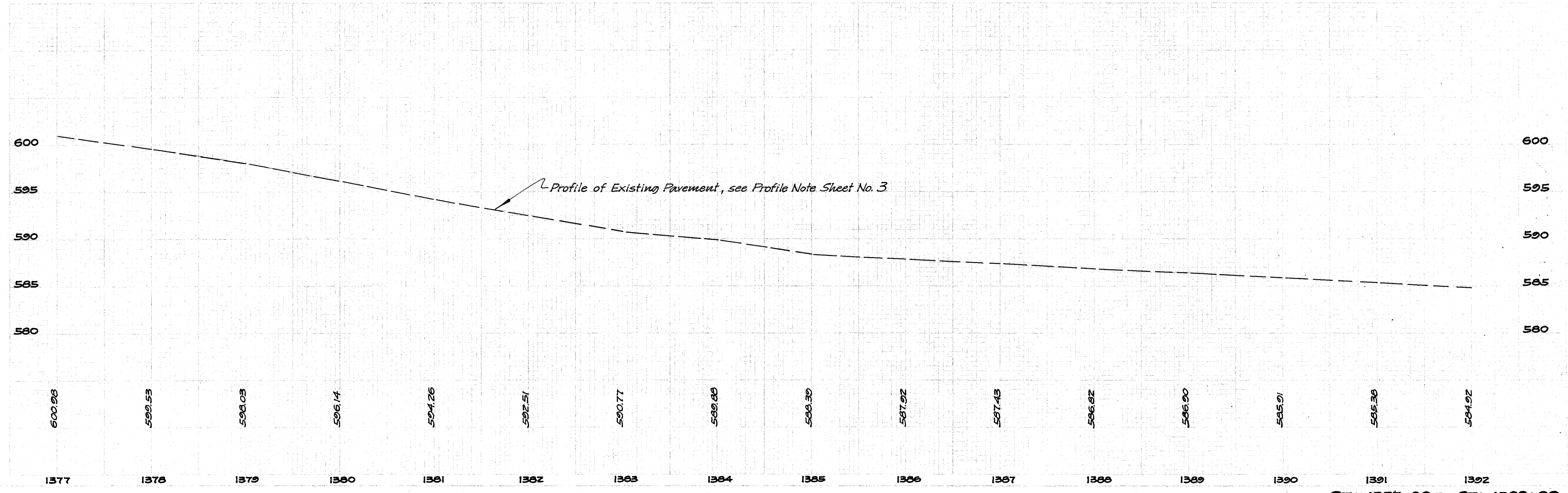
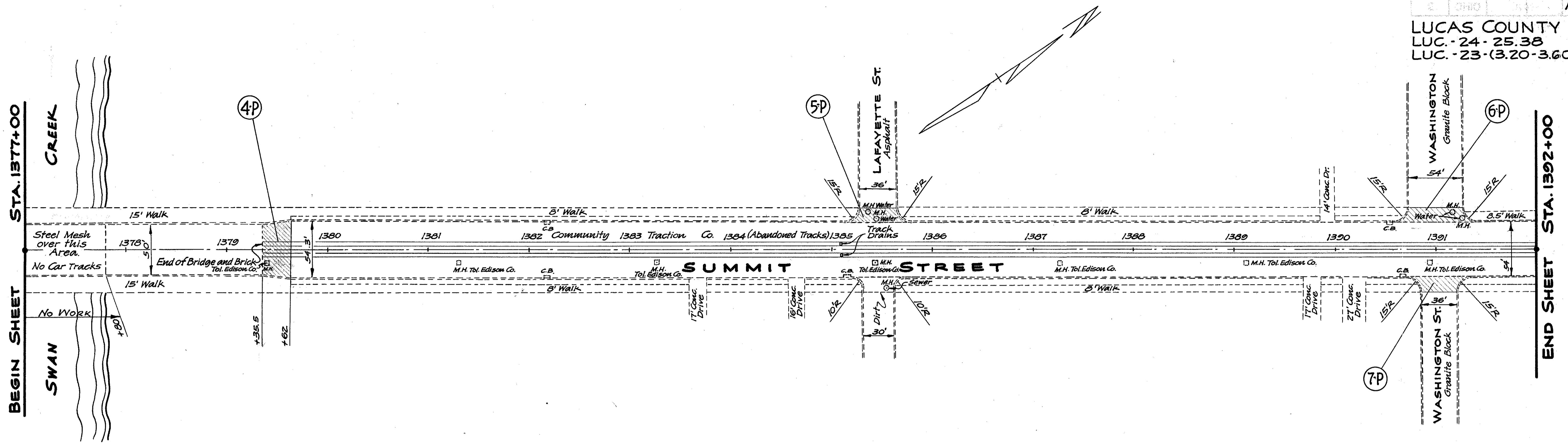

LUCAS COUNTY
 LUC. - 24 - 25.38
 LUC. - 23 - (3.20 - 3.60)

6
6

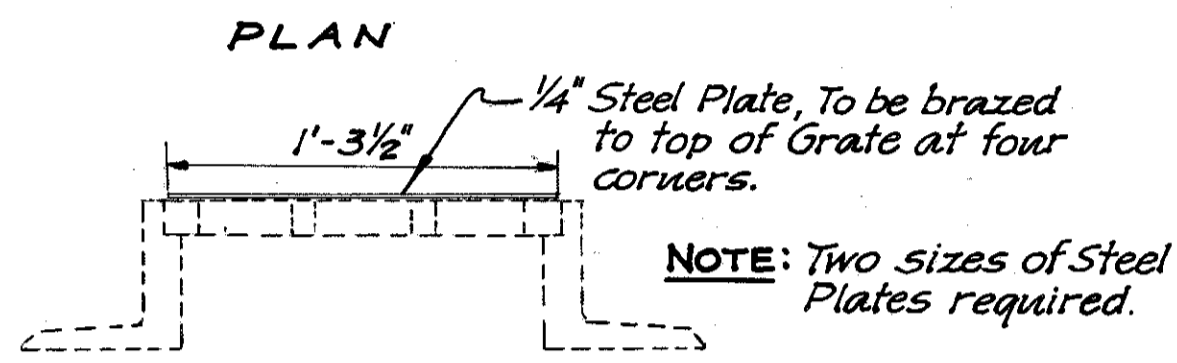
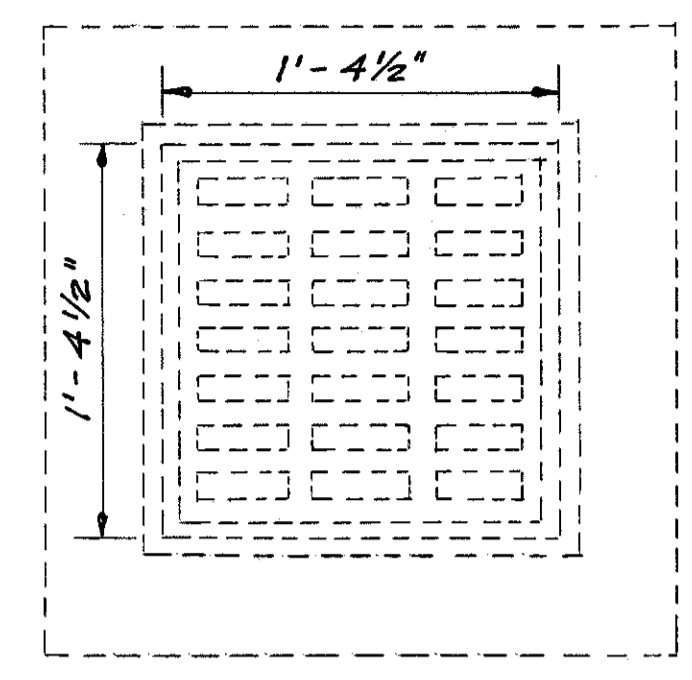
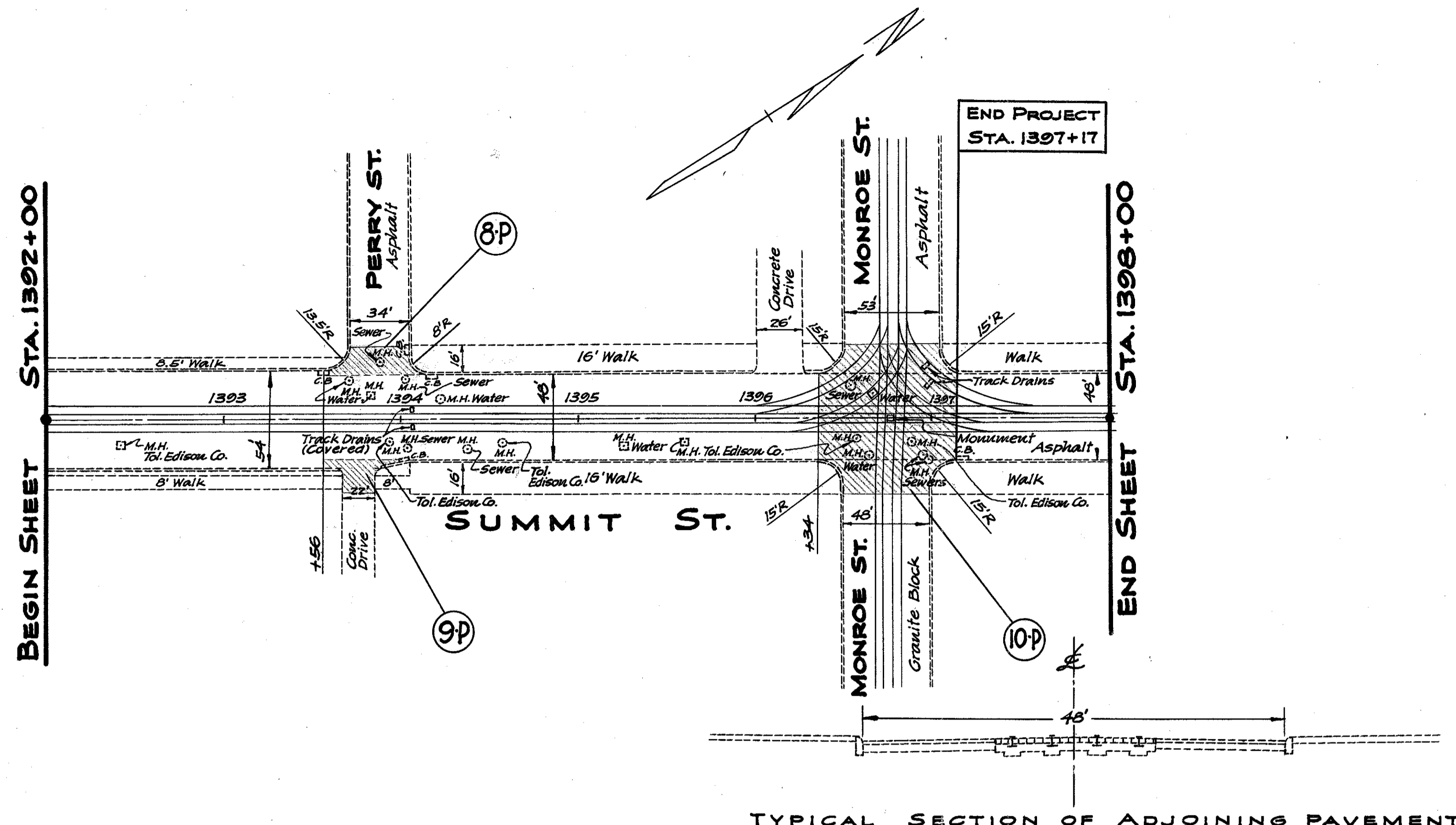

NOTE: Two sizes of Steel Plates required.

DETAIL: Showing Method of Covering Abandoned Track Drains.

SIZE	NO. REQUIRED	WEIGHT, LBS.
1'-3 1/2" x 1'-3 1/2"	5	85
1'-7" x 2'-1 1/2"	1	34
Total Weight		119

TYPICAL SECTION OF ADJOINING PAVEMENT
 Type: Stone Curb, Sheet Asphalt on Concrete Base.
 Car Track Area - Granite Block on Concrete Base.

B.M. So. Flange Bolt Hydrant Corner Perry & Summit El. 585.81

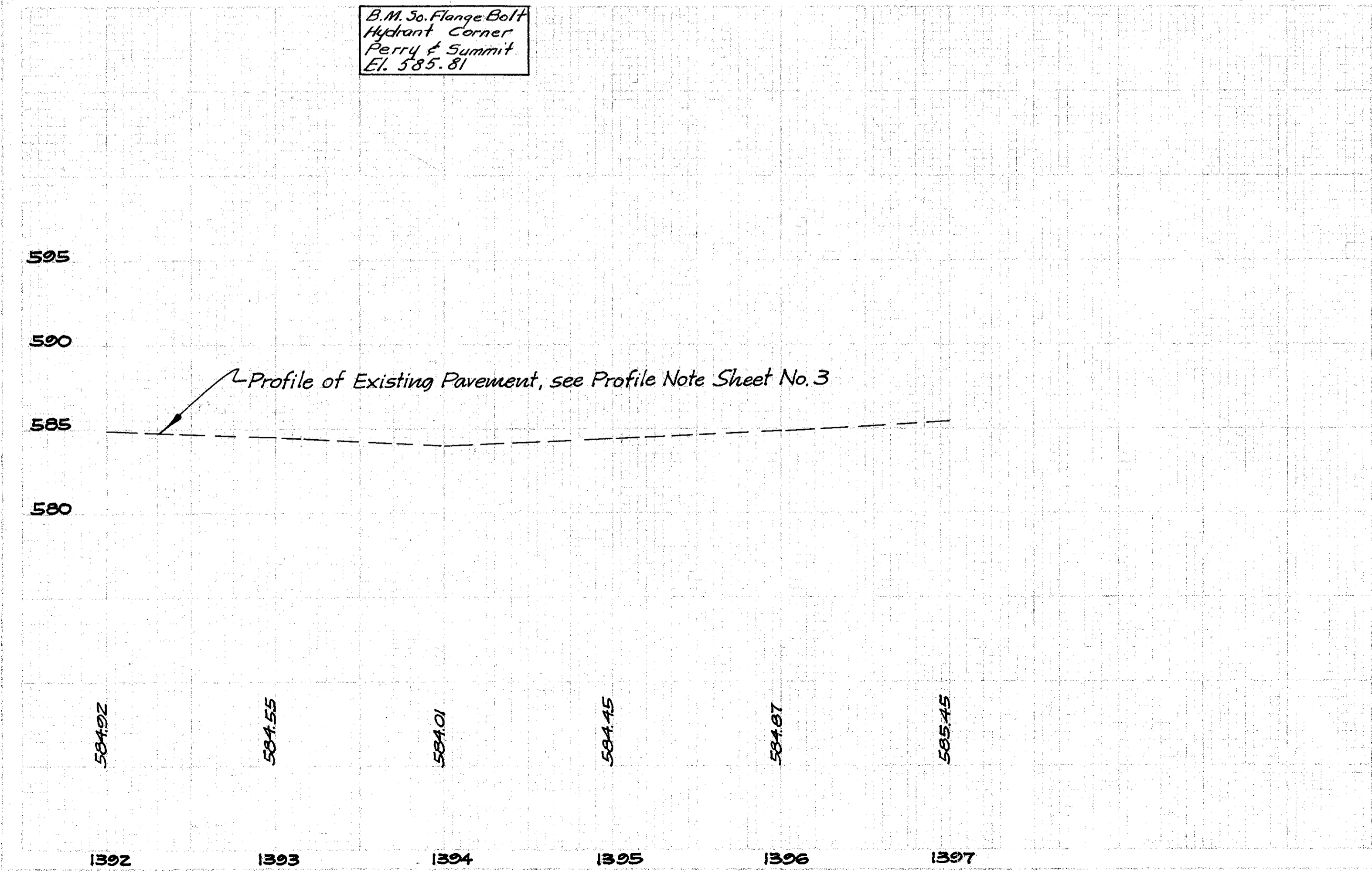

FNC-26.02 13-V-1