

O.D.O.T. DISTRICT 2 SURVEY OFFICE (USE ONLY)

PERSONNEL _____

REFERENCE NO. 3

SHEET 3 OF 14

NOTES CITY _____ DATE 1/13/92

H.C. OF _____ WEATHER _____

R.C. TOLEDO _____ TEMP. _____

ROUTE _____ SR 65

COUNTY _____ LUCAS

TOWNSHIP 12 MILE RESERVE

SECTION _____ RT 84

DWG BY NIESE _____ PID _____

T 3 US R E

TYPE MONUMENT BRASS PLATE

ON SURFACE - ~~BELOW~~ ON _____

OFFSET \odot PAVEMENT _____ - _____ LT : RT

_____ TO _____ EDGE PAVEMENT

STATION: 10+86.48

HORZ. DATUM: _____

GEOID: _____

GRID: NORTHING: _____

EASTING: _____

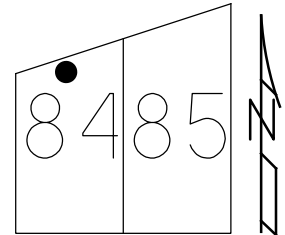

RECORD:
 STA. 10+86.55
 FD R.R. SPIKE
 1966 PLANS
 TOLEDO PLAN
 LUC-SR65-0.00
 FD BRASS PLATE
 8/24/71.TOMSIC
 1/13/97, TOLEDO
 SET 5/8" IPIN
 IN MONBOX USING
 12/31/96, MRC

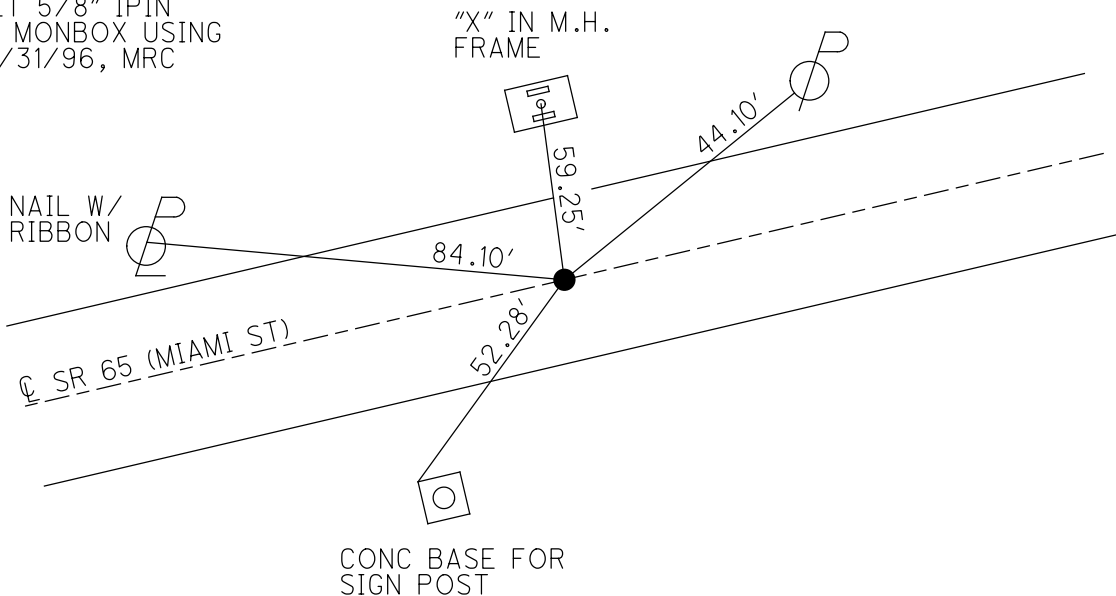

O.D.O.T. DISTRICT 2 SURVEY OFFICE

PERSONNEL _____

REFERENCE NO. 3

SHEET 3 OF 5

NOTES CITY

H.C. OF

R.C. TOLEDO

DATE 1-13-92

WEATHER _____

TEMP. _____

ROUTE 65

COUNTY LUCAS

TOWNSHIP _____

SECTION _____

T _____ R _____

TYPE MONUMENT BRASS PLATE

ON SURFACE - BELOW _____

LEFT- & PAW'T. - RIGHT _____

TO _____ EDGE PAVEMENT

S.L.M. 10+86.48

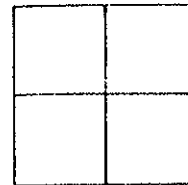

TOLEDO PLAN Luc-SR-65-00.00

DRAWN By WmLucas

Set 5/8" Iron Rod
in monument box
using straddle
Nails found on
surface
12-31-96
M.R.C.

"X" IN MH
FRAME

W/LIGHT
NAIL W/ RIBBON

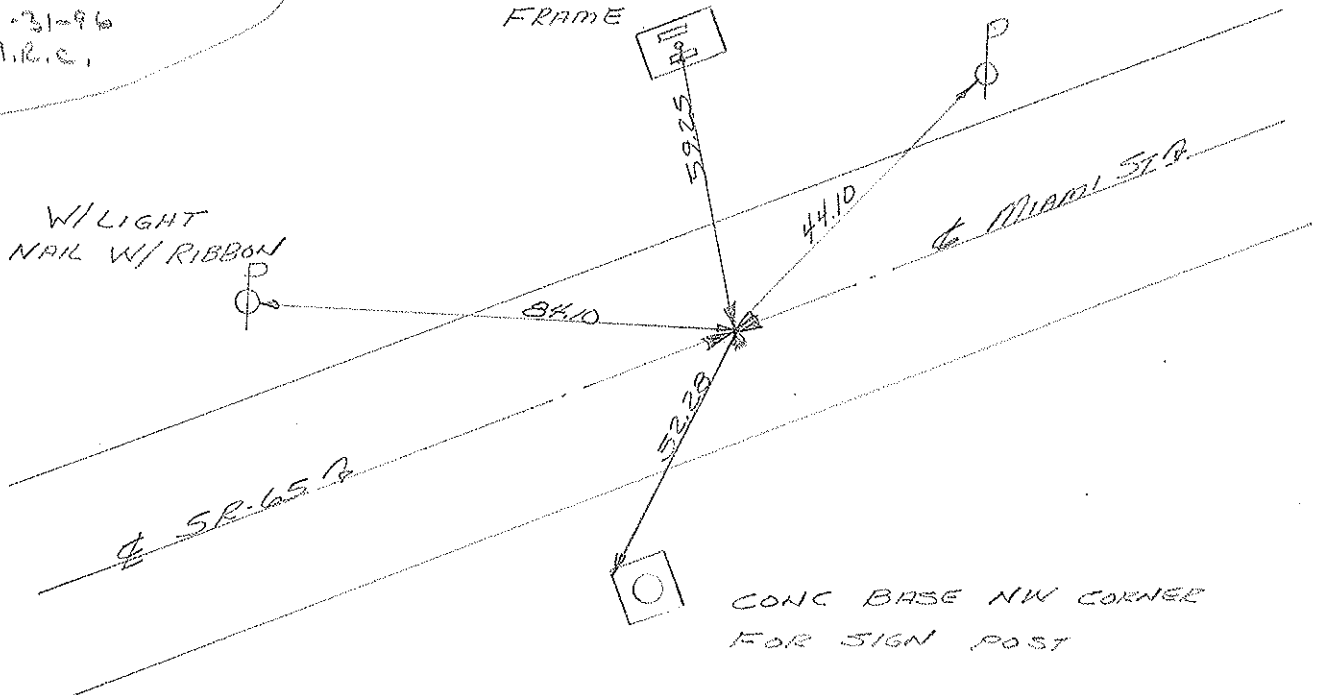

CONC BASE NW CORNER
FOR SIGN POST

PERSONNEL	TITLE	PERSONNEL	TITLE	COUNTY	DATE
VAN DUSEN				LUCAS	1-7-97
MOSER				S. R. 65	WEATHER CLOUDY
MARK C.				SEC. 0.00	TEMP. +22°F
TED R.					

DESCRIPTION RE-SET P.I. @ STA. 17+92.81 JOB NO. 621039

