

O.D.O.T. DISTRICT 2 SURVEY OFFICE (USE ONLY)

PERSONNEL

REFERENCE NO. 4

SHEET 5 OF 14

NOTES VAN DUSEN

DATE 1/7/97

ROUTE SR 65

H.C. ROUSOS

WEATHER CLOUDY

COUNTY LUCAS

R.C. MOSER
CANTERBURY

TEMP. 22°

TOWNSHIP 12 MILE RESERVE

DWG BY NIESE PID _____

SECTION RT 84

T 3 US R E

TYPE MONUMENT P.K./WASHER

ON SURFACE - ~~BELOW~~ ON

OFFSET Q PAVEMENT _____ LT : RT

- TO - EDGE PAVEMENT

STATION: 17+42.40

HORZ. DATUM: _____ GEOID: _____

GRID: NORTHING: _____ EASTING: _____

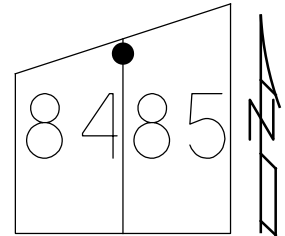

RECORD: P.I.
STA 17+92.8
 $\Delta = 3^\circ 09' 15''$ RT
1966 PLANS
SET P.K./WASHER
1/7/97, TR

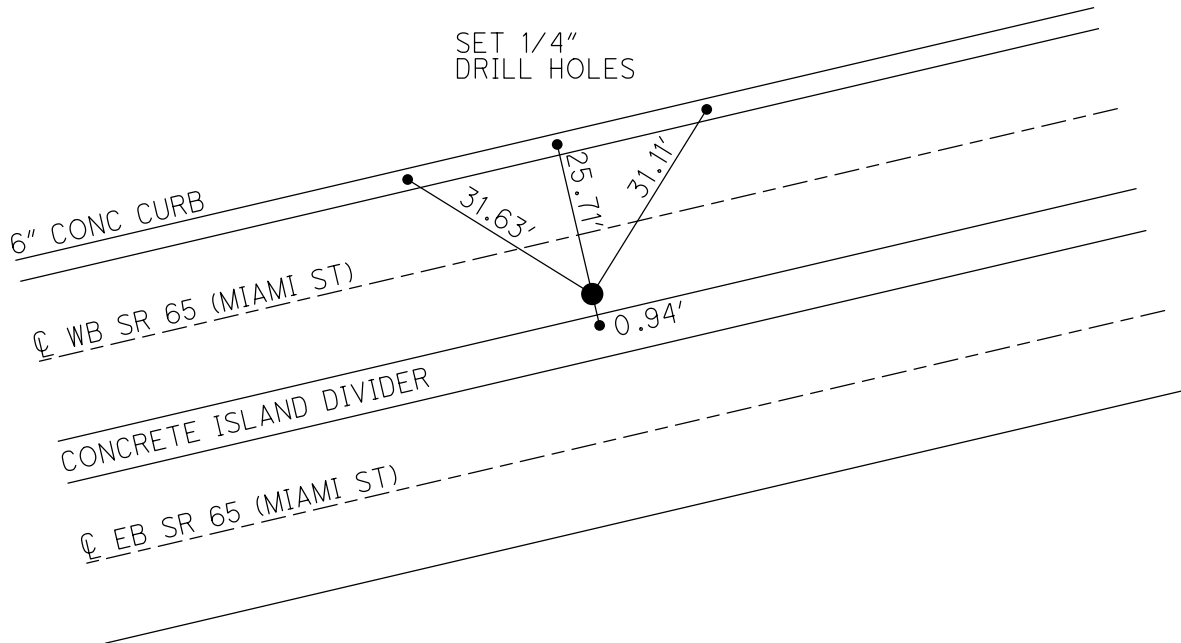

O.D.O.T. DISTRICT 2 SURVEY OFFICE

PERSONNEL _____

REFERENCE NO. 4

SHEET 4 OF 5

NOTES VAN DUJEN

H.C. ROUSOS

DATE 1-7-97

ROUTE 65

R.C. MOSEK

WEATHER CLOUDY

COUNTY LUCAS

CANTERBURY

TEMP. +22°F

TOWNSHIP _____

SECTION _____

T. _____ R. _____

TYPE MONUMENT PK & WASHER (SET)

ON SURFACE - BELOW YES

LEFT- & PAV'T. - RIGHT _____

_____ TO _____ EDGE PAVEMENT

S.L.M. PLAN STA. = 17+92.81

SLM-0.33

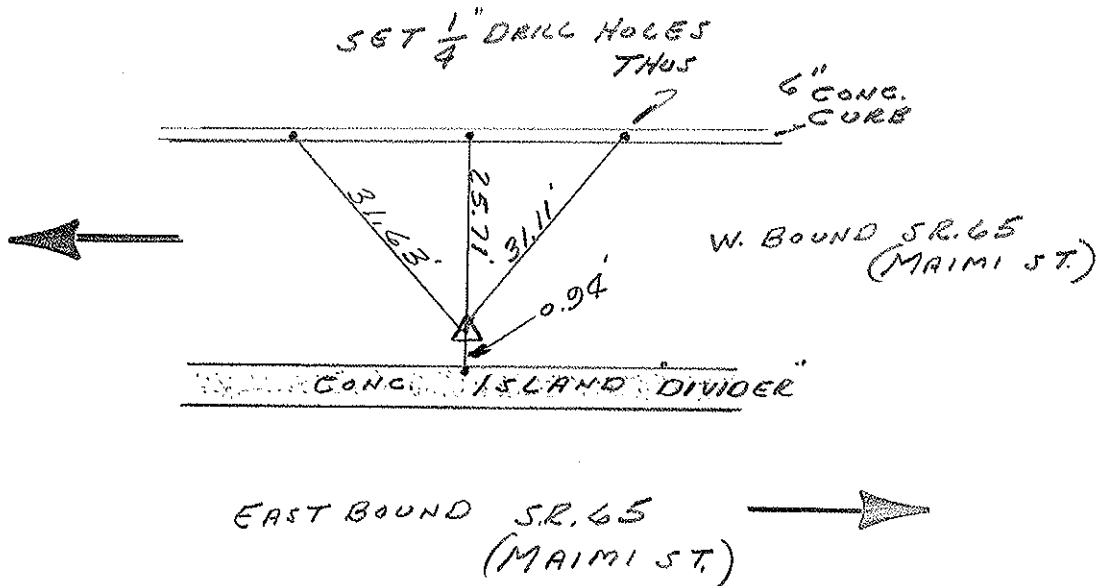
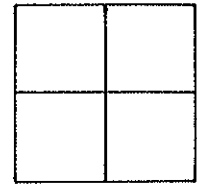

PERSONNEL	TITLE	PERSONNEL	TITLE	COUNTY	DATE
<u>VAN DUSEN</u>				<u>LUCAS</u>	<u>1-7-97</u>
<u>MOSER</u>				S. R. <u>65</u>	WEATHER <u>CLOUDY</u>
<u>MARK C.</u>				SEC. <u>0.00</u>	TEMP. <u>+22°F</u>
<u>TED R.</u>					

DESCRIPTION RE-SET P.I. @ STA. 17+92.81 JOB NO. 621039

