

O.D.O.T. DISTRICT 2 SURVEY OFFICE (USE ONLY)

PERSONNEL _____ REFERENCE NO. _____ SHEET 13 OF 20
 NOTES TOMSIK DATE 11/9/72 ROUTE I-75
 H.C. NEUSER WEATHER _____ COUNTY LUCAS
 R.C. VANYO TEMP. _____ TOWNSHIP CITY OF TOLEDO
 GRANATA SECTION 22
 DWG BY NIESE PID _____ T 9 S R 7 E

TYPE MONUMENT IPIN
 ON SURFACE - BELOW _____ ON _____
 OFFSET \odot PAVEMENT _____ LT : RT _____
 _____ TO _____ EDGE PAVEMENT
 STATION: 279+00

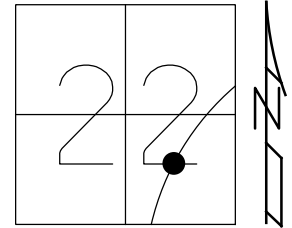

HORZ.DATUM: _____ GEOID: _____
 GRID: NORTHING: _____ EASTING: _____

RECORD:
 REFERENCE CONTROL POINT
 SET BY PIERCE SURVEY
 11/9/72, TOMSIK

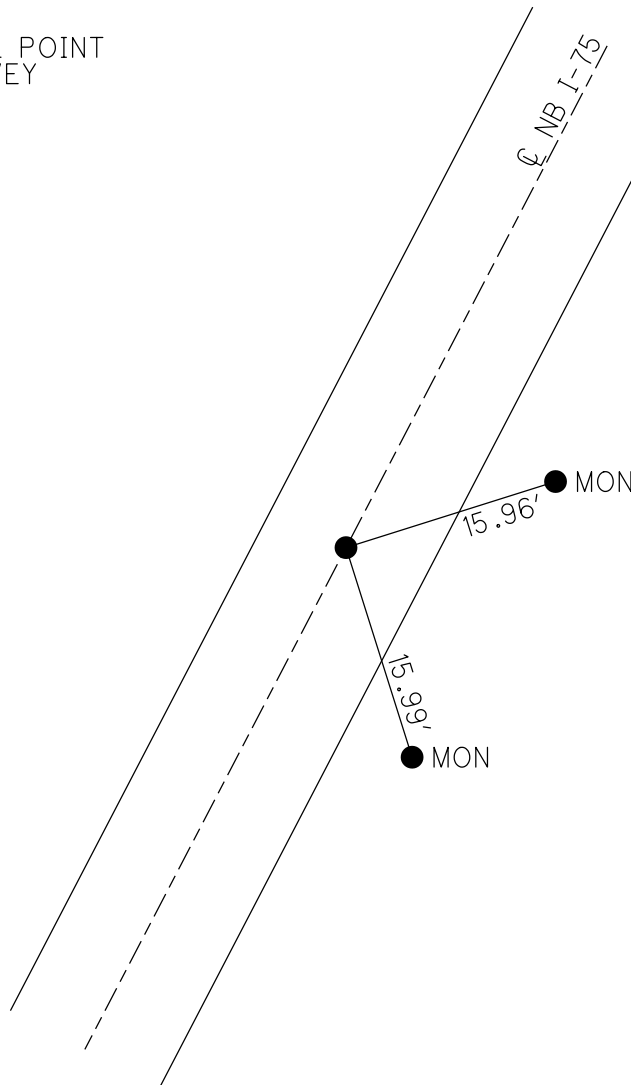

NORTH BOUND LANE

PERSONNEL	TITLE	PERSONNEL	TITLE	COUNTY	DATE
Tomsic				Lucas	Nov.-9-72
KEUSER				S. R.	I-75
VANZO				SEC.	Central to Drexel
Granata				TEMP.	
DESCRIPTION	Reference	Control	POINTS	(Set by Peirce Survey)	JOB NO.
	LEFT	CENTER LINE	RIGHT		0516

