

O.D.O.T. DISTRICT 2 SURVEY OFFICE (USE ONLY)

PERSONNEL

REFERENCE NO. _____

SHEET 15 OF 20

NOTES TOMSIK

DATE 11/9/72

ROUTE I-75

H.C. NEUSER

WEATHER _____

COUNTY LUCAS

R.C. VANYO

TEMP. _____

TOWNSHIP CITY OF TOLEDO

GRANATA

SECTION 22

DWG BY NIESE PID _____

T 9 S R 7 E

TYPE MONUMENT MONBOX

ON SURFACE - ~~BELOW~~ ON

OFFSET Q PAVEMENT _____ ~~LT~~ : RT

_____ TO _____ EDGE PAVEMENT

STATION: 284+97.43

HORZ. DATUM: NAD83(ADJUSTED 1995) GEOID: _____

GRID: NORTHING: 736589.838 EASTING: 1676483.608

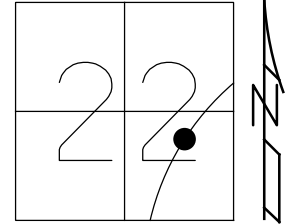

RECORD: P.T.
REFERENCE CONTROL POINT
SET BY PIERCE SURVEY
11/9/72, TOMSIK
MONBOX SET BY OTHERS
I-75 Q R/W NB ALIGNMENT
PID 77254
4/24/20

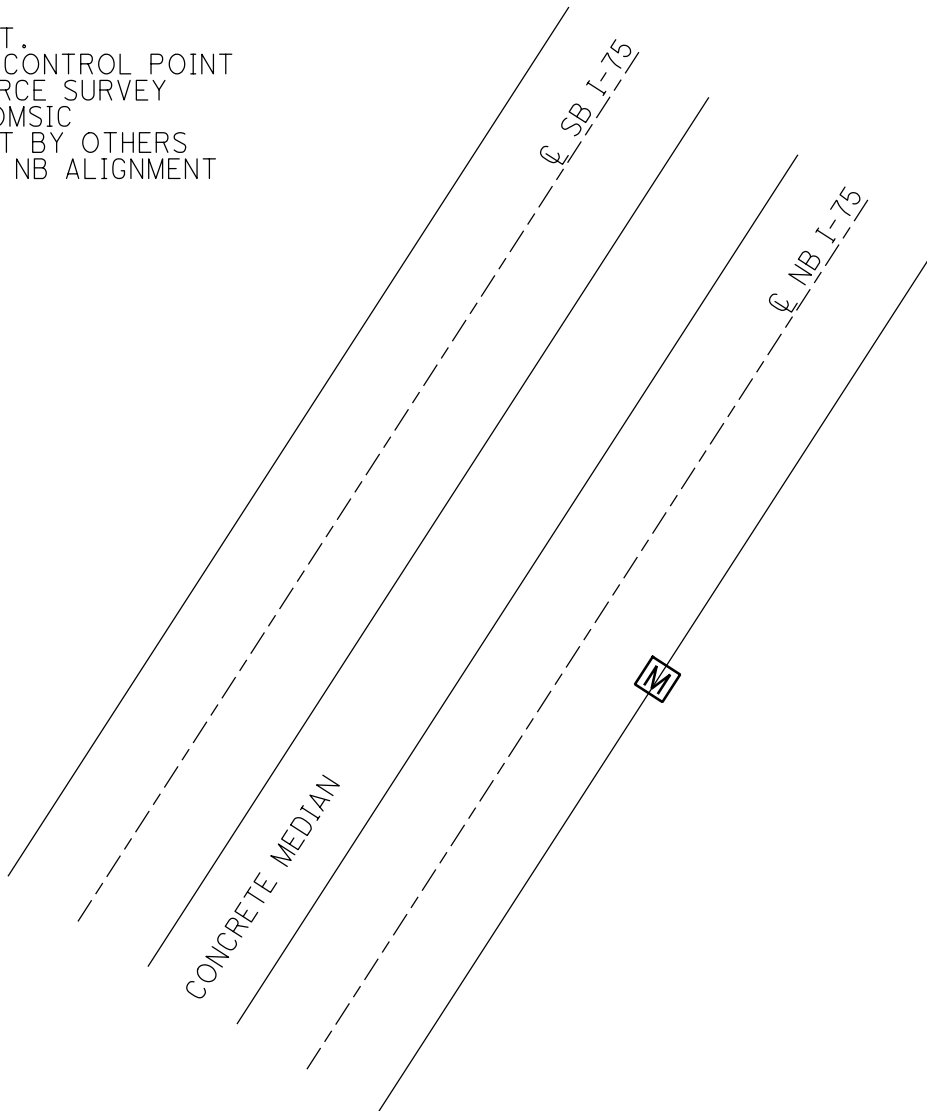

NORTH BOUND LANE

PERSONNEL	TITLE	PERSONNEL	TITLE
Tomsic			
Neuser			
Vargo			
Grant			

COUNTY LUCAS DATE Nov-9-72
 S. R. I-75 WEATHER _____
 SEC. Central To Drexel TEMP. _____

DESCRIPTION Reference CONTROL POINTS (Set by POIRCE SURVEY) JOB NO. 0516
 LEFT CENTER LINE RIGHT

