

O.D.O.T. DISTRICT 2 SURVEY OFFICE (USE ONLY)

PERSONNEL _____

REFERENCE NO. _____

SHEET 19 OF 20

NOTES _____

DATE 11/10/71

ROUTE I-75

H.C. _____

WEATHER _____

COUNTY LUCAS

R.C. _____

TEMP. _____

TOWNSHIP CITY OF TOLEDO

DWG BY NIESE PID _____

SECTION 23

T 9 S R 7 E

TYPE MONUMENT IPIN

ON SURFACE - ~~BELOW~~ ON

OFFSET 0.05' LT : ~~RT~~

- TO - EDGE PAVEMENT

STATION: 345+80.42

HORIZ.DATUM: NAD83(ADJUSTED 1995) GEOID: _____

GRID: NORTHING: 737954.886 EASTING: 1681714.574

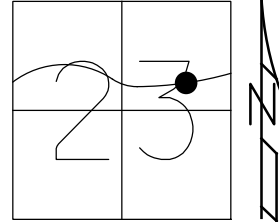

RECORD: S.T.
STA 345+80.62
11/10/71, RWB
FD IPIN
I-75 0 R/W
PROPOSED DISC
PID 77254
4/24/20

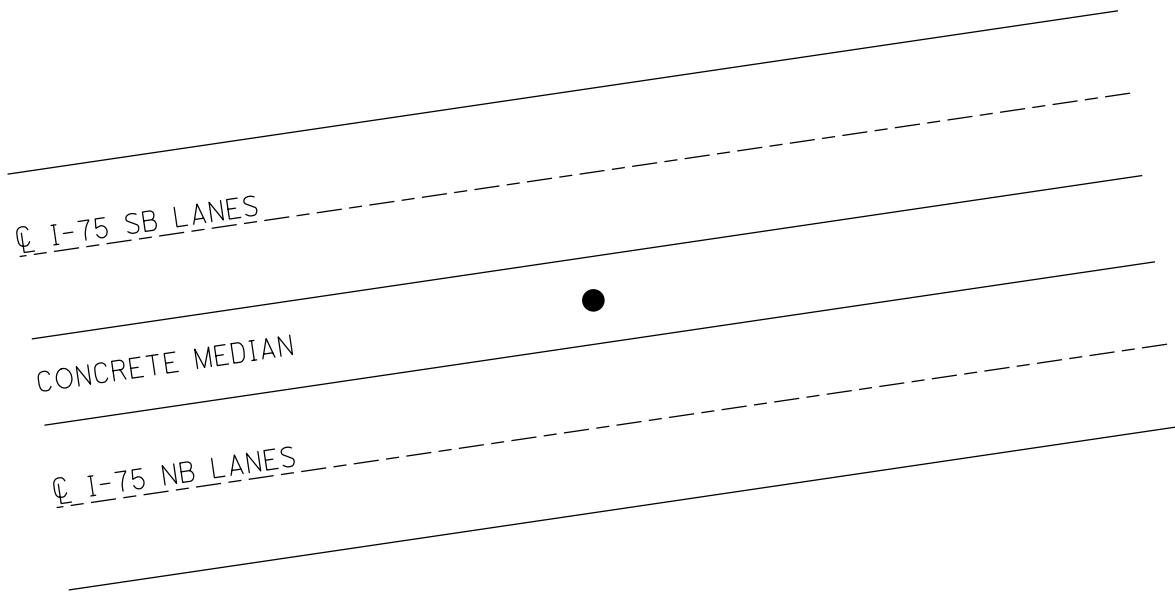

REF. NO. 1A SUBJECT CENTERLINE MONUMENTS MEASUREMENT DATE 11/10/71 INITIALS Sub

ITEM NO. 60A PROJECT NO. 573-6D COMPUTATION DATE _____

LOCATION U.I.R. 75-6.14

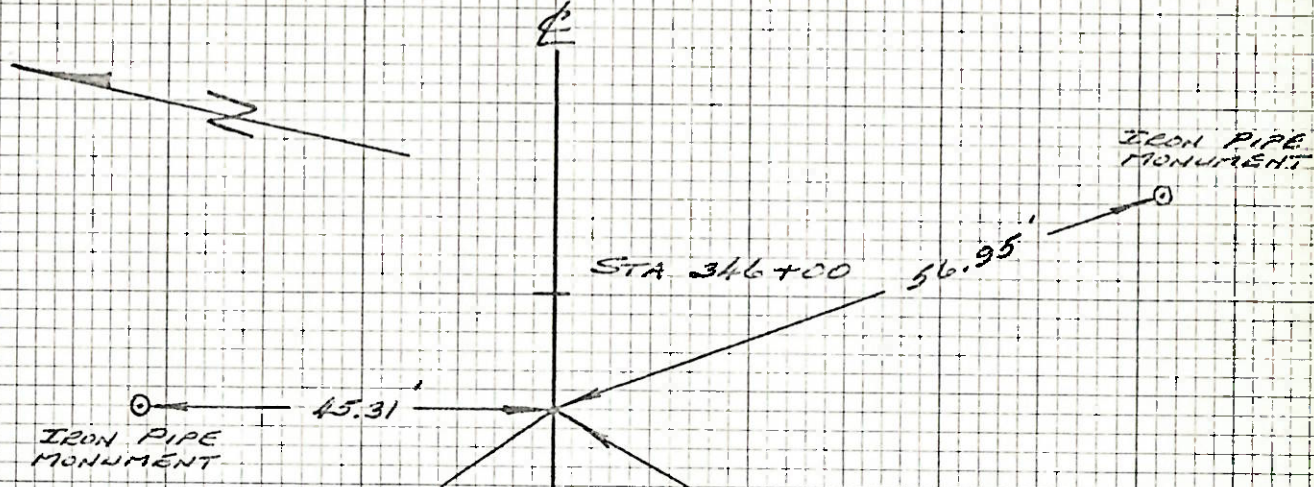
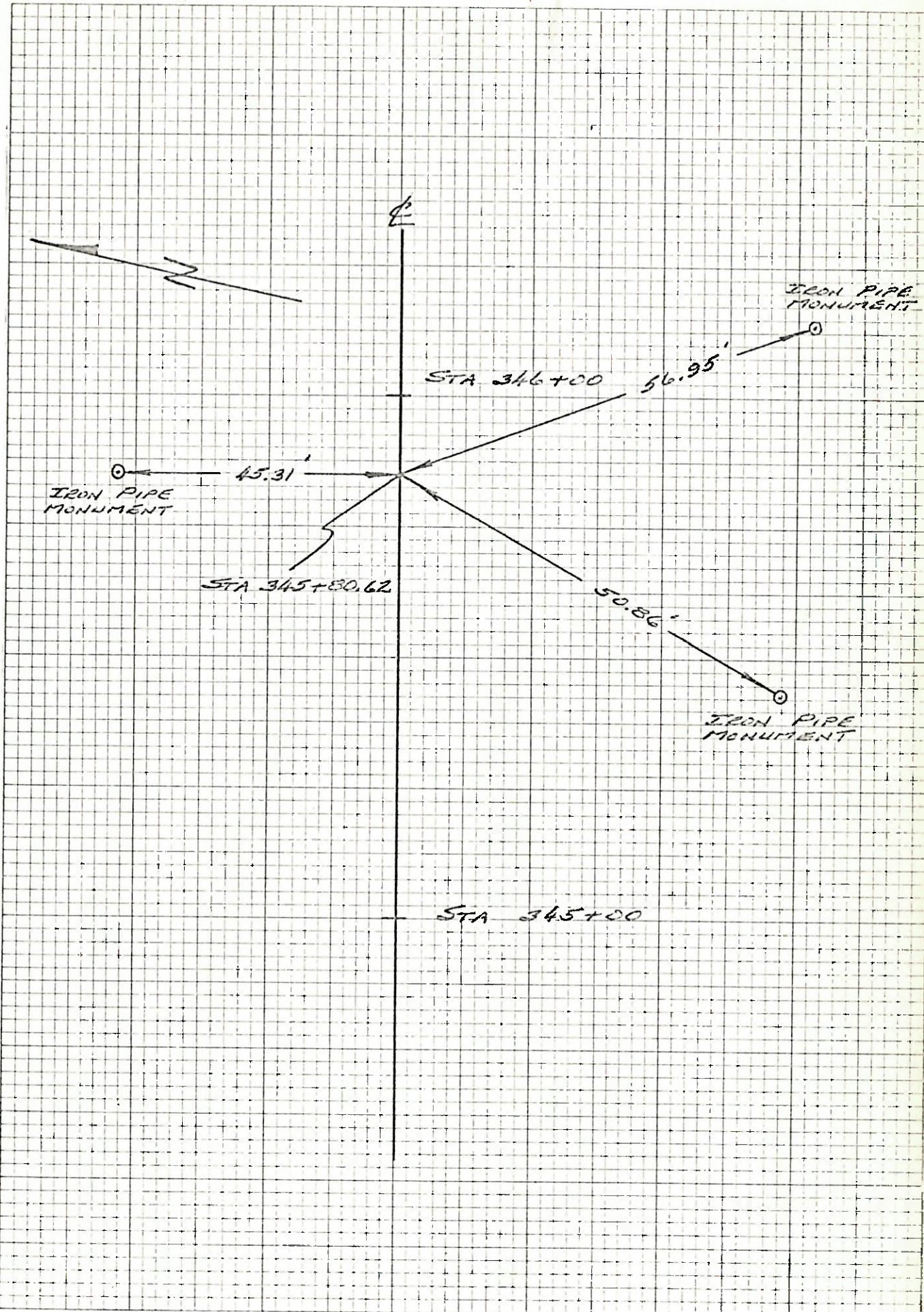

STA 345+00

STA 346+00

STA 345+80.62

IRON PIPE MONUMENT

IRON PIPE MONUMENT

IRON PIPE MONUMENT

45.31'

50.86'

56.95'

