

O.D.O.T. DISTRICT 2 SURVEY OFFICE (USE ONLY)

PERSONNEL

REFERENCE NO. _____

SHEET 22 OF 34

NOTES VAN DUSEN

DATE 1/30/98

ROUTE I-75

H.C. MOSER

WEATHER CLOUDY

COUNTY LUCAS

R.C. HUSS

TEMP. 35°

TOWNSHIP CITY OF TOLEDO

SECTION 5

DWG BY NIESE

PID _____

T 9 S R 8 E

TYPE MONUMENT IPIN

ON SURFACE - ~~BELOW~~ ON

OFFSET \varnothing PAVEMENT ON LT : RT

 TO EDGE PAVEMENT

STATION: 505+06.61

HORZ.DATUM: _____

GEOID: _____

GRID: NORTHING: _____

EASTING: _____

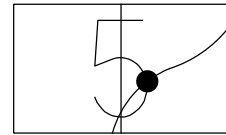

RECORD: C.S.
IPIN IN CONC WALL
N: 51005.80
E: 38384.38
1/30/98, VAN DUSEN

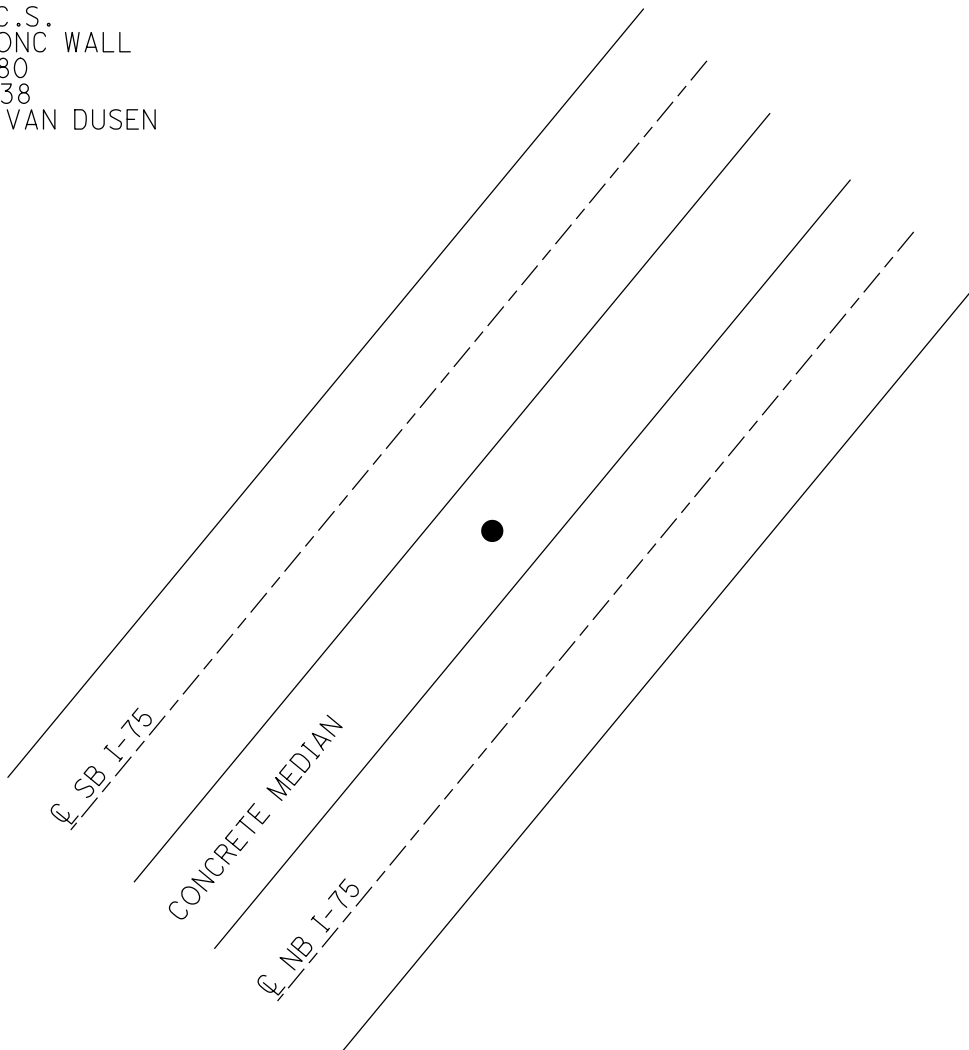

PERSONNEL	TITLE	PERSONNEL	TITLE
VAN DUSEN			
MOSEER			
HUSS			

COUNTY LUCAS DATE 1-30-98
 S.R. I-75 WEATHER CLOUDY
 SEC. 2.83 TEMP. +35° F

DESCRIPTION CONFIRMATION & LOCATION OF MONUMENTS JOB NO. 023350
 LEFT CENTER LINE RIGHT

