

O.D.O.T. DISTRICT 2 SURVEY OFFICE (USE ONLY)

PERSONNEL

REFERENCE NO. \_\_\_\_\_

SHEET 24 OF 34

NOTES VAN DUSEN

DATE 1/30/98

ROUTE I-75

H.C. MOSER

WEATHER CLOUDY

COUNTY LUCAS

R.C. HUSS

TEMP. 35°

TOWNSHIP CITY OF TOLEDO

DWG BY NIESE PID \_\_\_\_\_

SECTION 5

T 9 S R 8 E

TYPE MONUMENT 1/4" DRILL HOLE

ON SURFACE - ~~BELOW~~ ON

OFFSET  $\varnothing$  PAVEMENT 0.17' ~~LT~~ : RT

- TO - EDGE PAVEMENT

STATION: 507+07.22

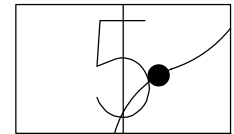

HORZ.DATUM: NAD83(2011)

GEOID: \_\_\_\_\_

GRID: NORTHING: 751576.739

EASTING: 1696525.222

RECORD: S.T.  
 1/4" DRILL HOLE  
 ORIGINAL POSITION OF  
 MONBOX, PRE-CONST  
 PT#1012  
 N: 51138.974  
 E: 38535.296  
 1/30/98, VAN DUSEN  
 FD DRILL HOLE  
 HELD FOR  $\varnothing$   
 FOR 2015 PLANS

DIST. PT#1012-PT#1013=1.20'

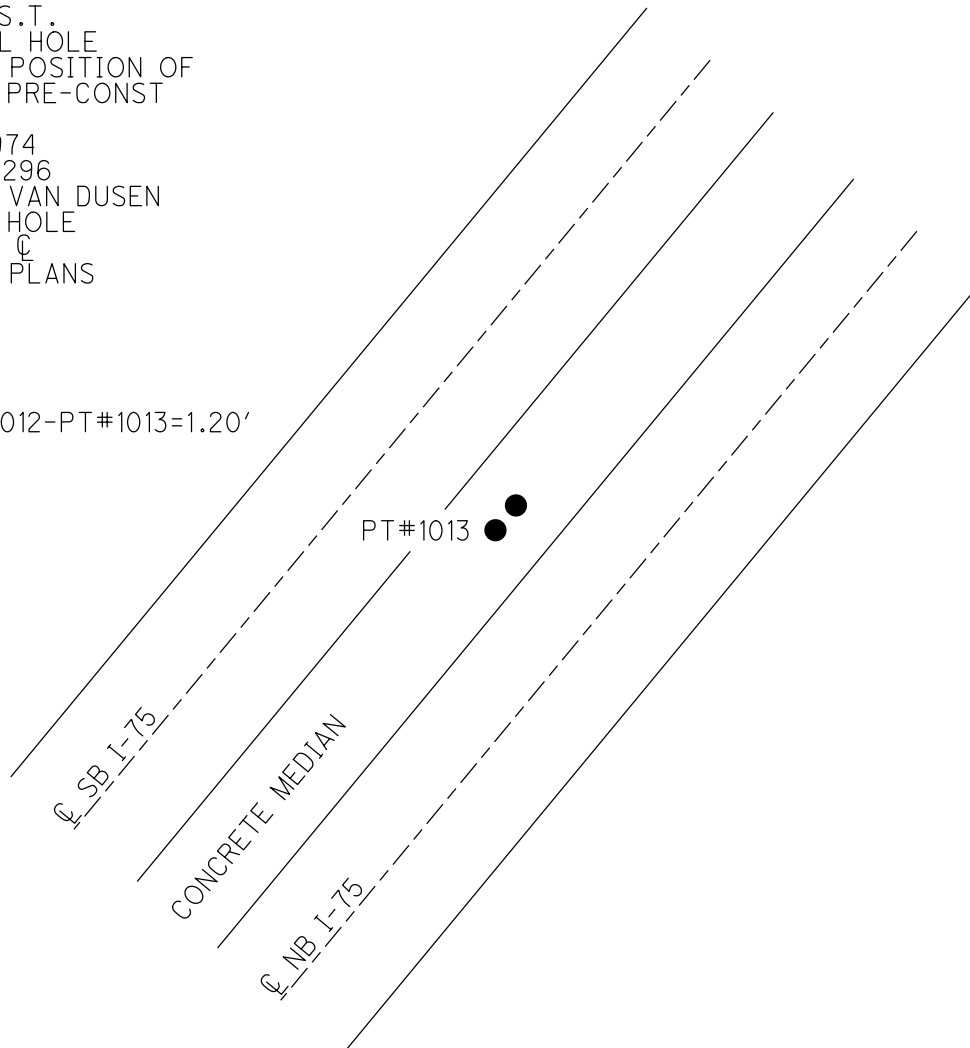

PERSONNEL	TITLE	PERSONNEL	TITLE
VAN DUSEN			
MOSEER			
HUSS			

COUNTY LUCAS DATE 1-30-98  
 S.A. I-75 WEATHER CLOUDY  
 SEC. 7.83 TEMP. +35° F

DESCRIPTION CONFIRMATION & LOCATION OF MONUMENTS JOB NO. 023350  
 LEFT CENTER LINE RIGHT

