

O.D.O.T. DISTRICT 2 SURVEY OFFICE (USE ONLY)

PERSONNEL _____

REFERENCE NO. _____

SHEET 25 OF 34

NOTES VAN DUSEN

DATE 1/30/98

ROUTE I-75

H.C. MOSER

WEATHER CLOUDY

COUNTY LUCAS

R.C. HUSS

TEMP. 35°

TOWNSHIP WASHINGTON

SECTION 5

DWG BY NIESE PID _____

T 9 S R 8 E

TYPE MONUMENT IPIN

ON SURFACE - ~~BELOW~~ ON

OFFSET 0.22' ~~LT~~ : RT

- TO - EDGE PAVEMENT

STATION: 512+82.77

HORZ.DATUM: NAD83(2011)

GEOID: _____

GRID: NORTHING: 751848.252

EASTING: 1697032.710

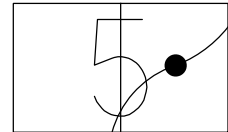

RECORD: CALC T.S.
IPIN IN CONC WALL
ORIGINAL POSITION OF
CONSULTANT'S "+" CUT
PRE-CONST
PT#1008
N: 51514.584
E: 38971.299
1/30/98, VAN DUSEN
FD IPIN IN CONC
2015

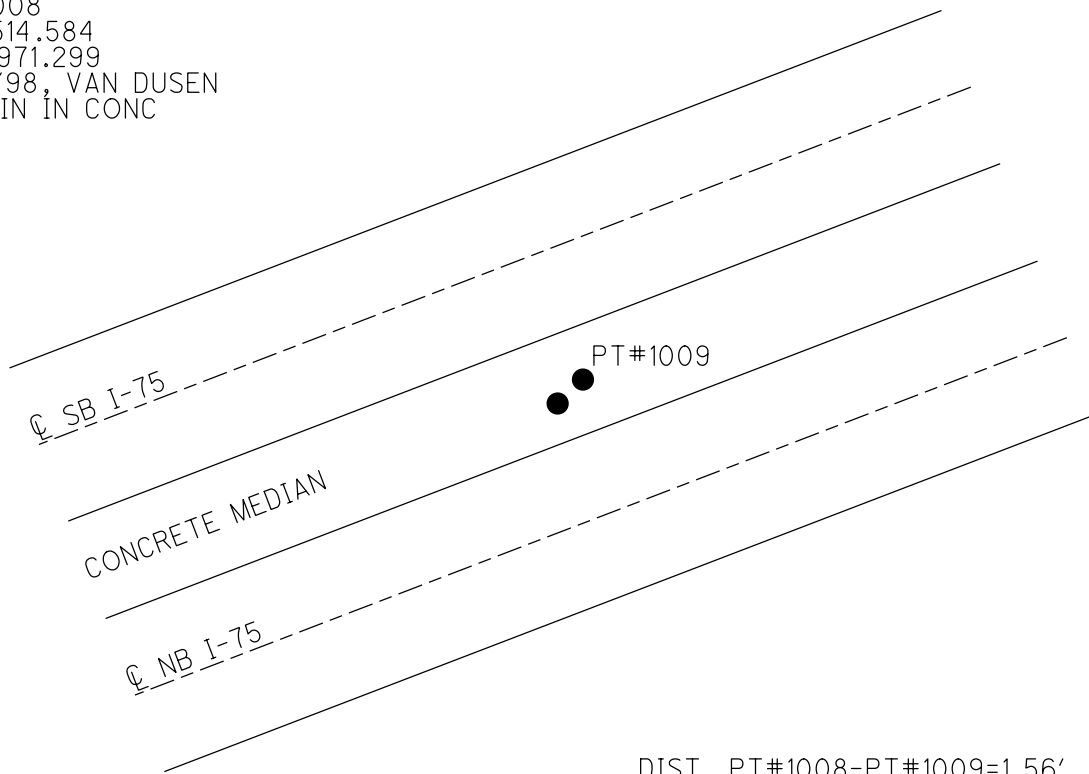

DIST. PT#1008-PT#1009=1.56'

PERSONNEL	TITLE	PERSONNEL	TITLE
VAN DUSEN			
MOJER			
HUSS			

COUNTY LUCAS DATE 1-30-98
 S.R. I-75 WEATHER CLOUDY
 SEC. 2.83 TEMP. +35° F

DESCRIPTION CONFIRMATION & LOCATION OF MONUMENTS JOB NO. 023350
 LEFT CENTER LINE RIGHT

