

O.D.O.T. DISTRICT 2 SURVEY OFFICE (USE ONLY)

PERSONNEL

REFERENCE NO. _____

SHEET 28 OF 34

NOTES VAN DUSEN

DATE 1/30/98

ROUTE I-75

H.C. MOSER

WEATHER CLOUDY

COUNTY LUCAS

R.C. HUSS

TEMP. 35°

TOWNSHIP WASHINGTON

DWG BY NIESE

PID _____

SECTION 5

T 9 S R 8 E

TYPE MONUMENT 1/4" DRILL HOLE

ON SURFACE - ~~BELOW~~ ON

OFFSET ϕ PAVEMENT _____ LT : RT

- TO - EDGE PAVEMENT

STATION: 516+66

HORZ.DATUM: _____

GEOID: _____

GRID: NORTHING: _____

EASTING: _____

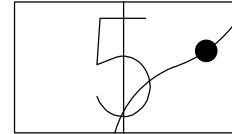

RECORD:

1/4" DRILL HOLE
IN RETAINING WALL

PT#1003

N: 51829.217

E: 39380.409

1/30/98, VAN DUSEN

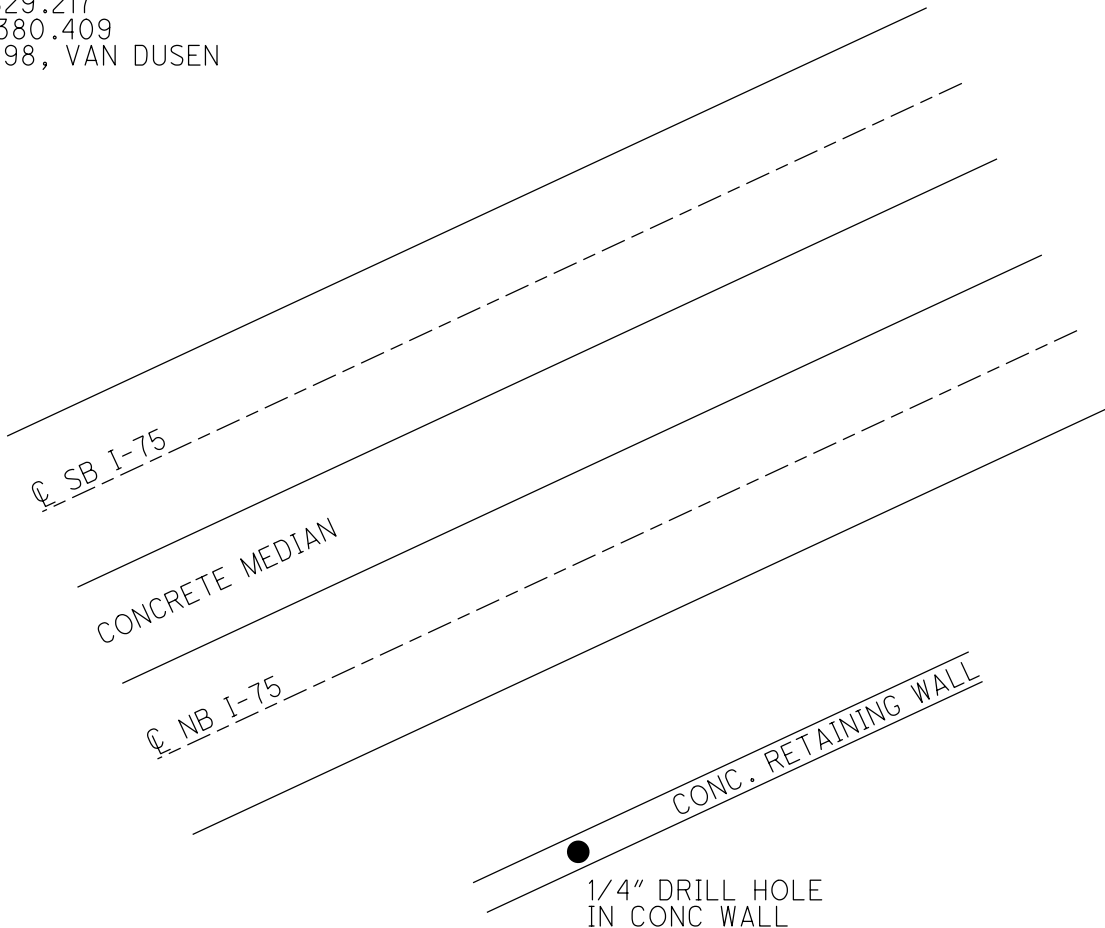

PERSONNEL	TITLE	PERSONNEL	TITLE
VAN DUSEN			
MOJER			
HUSS			

COUNTY LUCAS DATE 1-30-98
 S.R. I-75 WEATHER CLOUDY
 SEC. 2.83 TEMP. +35° F

DESCRIPTION CONFIRMATION & LOCATION OF MONUMENTS JOB NO. 023350
 LEFT CENTER LINE RIGHT

