

O.D.O.T. DISTRICT 2 SURVEY OFFICE (USE ONLY)

PERSONNEL

REFERENCE NO. 11

SHEET 1 OF 37

NOTES LOEHRKE

DATE 7/14/97

ROUTE US 120

H.C. CORDES

WEATHER HOT

COUNTY LUCAS

R.C. LOEHRKE

TEMP. 95°

TOWNSHIP CITY OF TOLEDO

DWG BY NIESE PID _____

SECTION 25

T 9 S R 6 E

TYPE MONUMENT MONBOX

ON SURFACE - ~~BELOW~~ ON

OFFSET Q PAVEMENT ON LT : RT

- TO - EDGE PAVEMENT

STATION: 631+32

HORIZ.DATUM: _____

GEOID: _____

GRID: NORTHING: _____

EASTING: _____

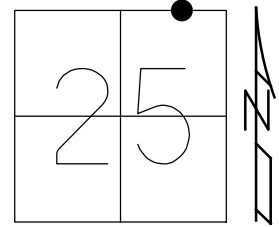

RECORD:
FD MONBOX
W/ LID OPEN
7/14/97, CL

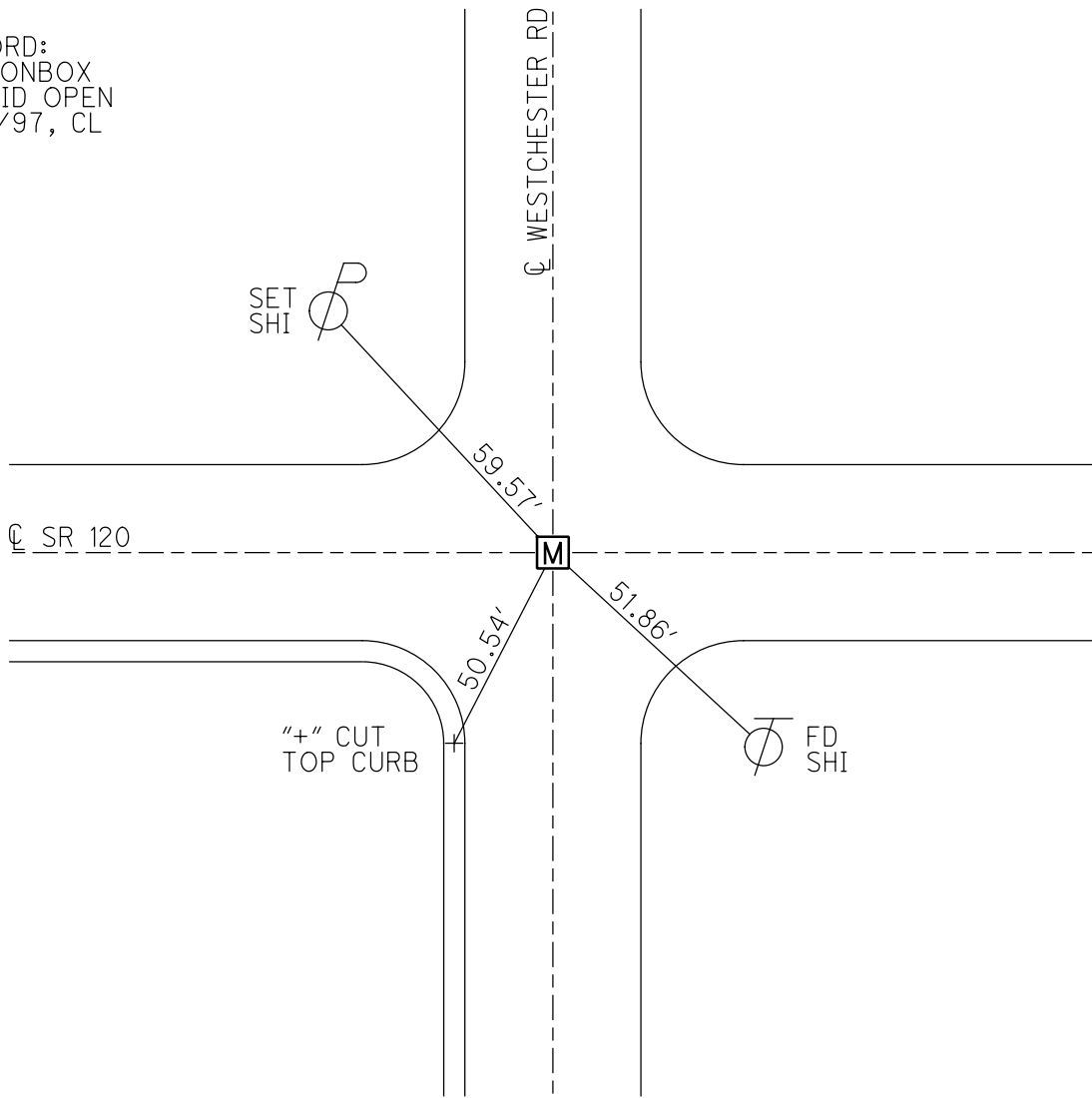

O.D.O.T. DISTRICT 2 SURVEY OFFICE

PERSONNEL _____

REFERENCE NO. 11

SHEET 3 OF 15

NOTES Lo ENRKE

H.C. COARES

R.C. Lo ENRKE

DATE 7-14-97

WEATHER HOT

TEMP. 95

ROUTE U.S. 120

COUNTY Lucas

TOWNSHIP City of Toledo

SECTION _____

T _____ R _____

TYPE MONUMENT Mon Box - Lid Open

ON SURFACE - ~~BELOW~~ Yes

LEFT - ~~PAV'T.~~ - RIGHT Yes

TO _____ EDGE PAVEMENT

S.L.M. 631+32 (19.242 km)

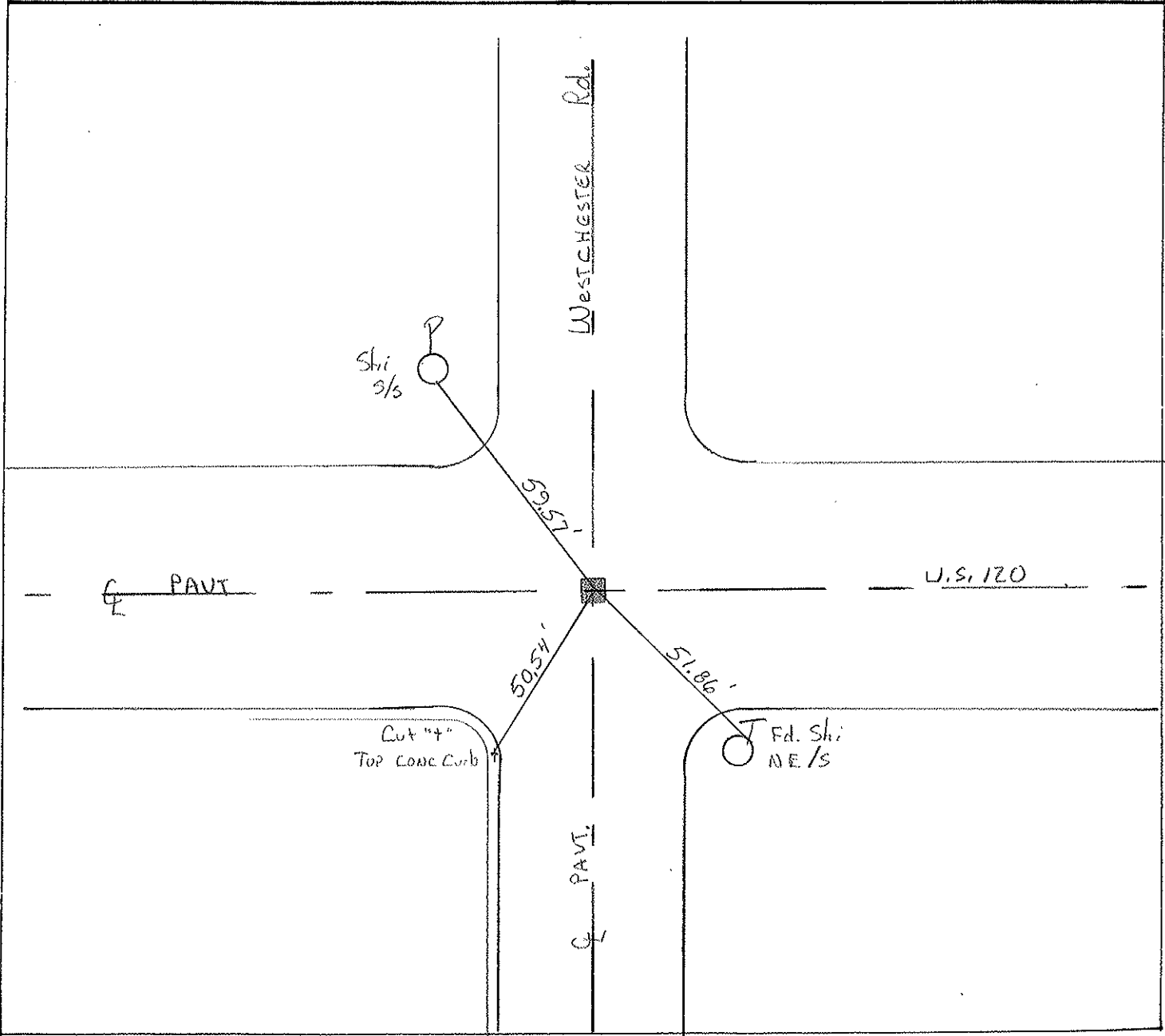
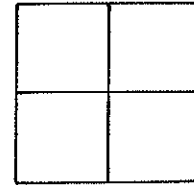

PERSONNEL	TITLE	PERSONNEL	TITLE
Tomsic			
Neuser			
Vanyo			
Granata			

COUNTY Lucas DATE Sept. 7, 1972
 S. R. U.S. 120 WEATHER _____
 SEC. _____ TEMP. _____

DESCRIPTION Central ave LEFT CENTER LINE RIGHT JOB NO. _____

