

O.D.O.T. DISTRICT 2 SURVEY OFFICE (USE ONLY)

PERSONNEL

REFERENCE NO. 14

SHEET 4 OF 37

NOTES LOEHRKE

DATE 7/15/97

ROUTE US 120

H.C. LOEHRKE

WEATHER NICE

COUNTY LUCAS

R.C. HUSS

TEMP. 82

TOWNSHIP CITY OF TOLEDO

SECTION 30

DWG BY NIESE

PID _____

T 9 S R 7 E

TYPE MONUMENT MONBOX

ON SURFACE - ~~BELOW~~ ON

OFFSET \bar{C} PAVEMENT ON LT : RT

27.3' TO LT EDGE PAVEMENT

STATION: 654+33

HORZ. DATUM: _____

GEOID: _____

GRID: NORTHING: _____

EASTING: _____

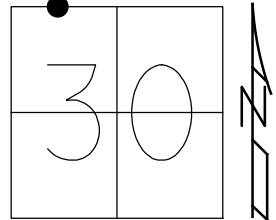

RECORD:
FD MONBOX
7/15/97, CL

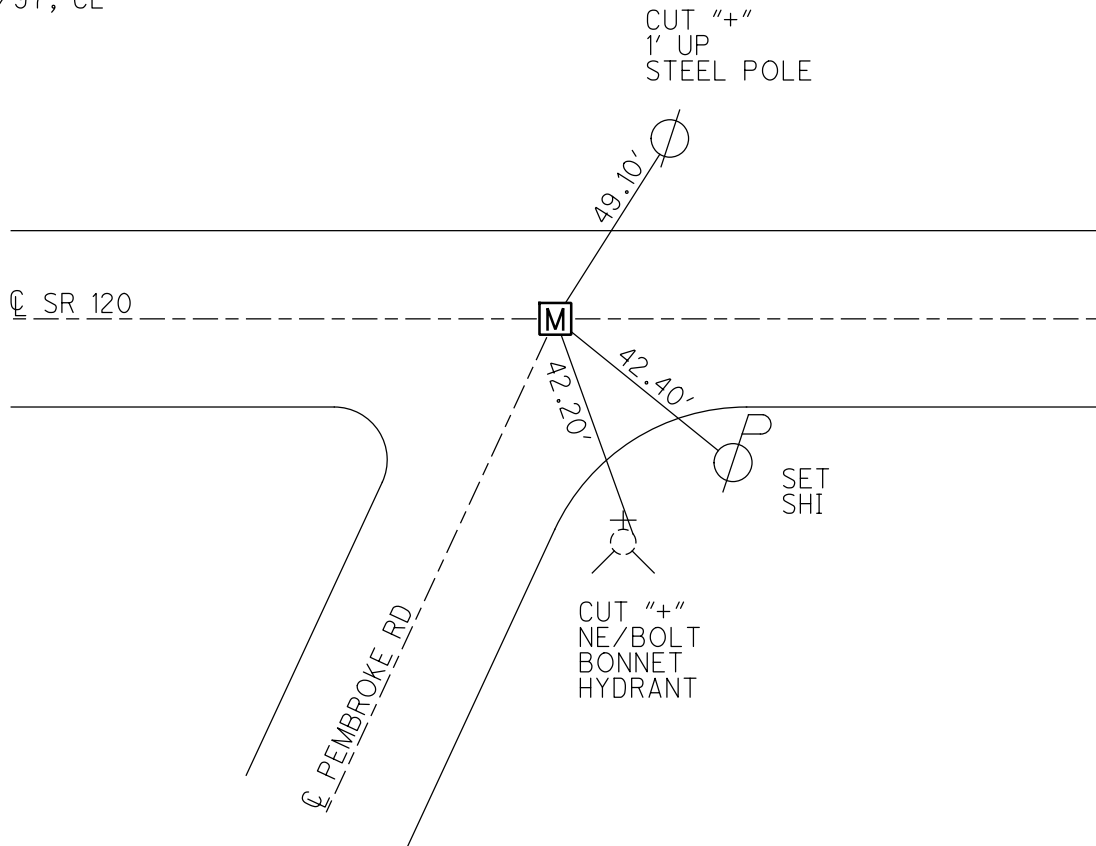

O.D.O.T. DISTRICT 2 SURVEY OFFICE

PERSONNEL _____

REFERENCE NO. 14

SHEET 6 OF 15

NOTES LOEHRKE

H.C. LOEHRKE

R.C. Huss

DATE 7-15-97

WEATHER Nice

TEMP. +82

ROUTE U.S. 120

COUNTY Lucas

TOWNSHIP City of Toledo

SECTION _____

T. _____ R. _____

TYPE MONUMENT MAN BAY - UNOPEN

ON SURFACE - BELOW Yes

LEFT - Q PAV'T. - RIGHT Yes

27.3 TO MAN EDGE PAVEMENT

S.L.M. 654+33 (19.943 Km)

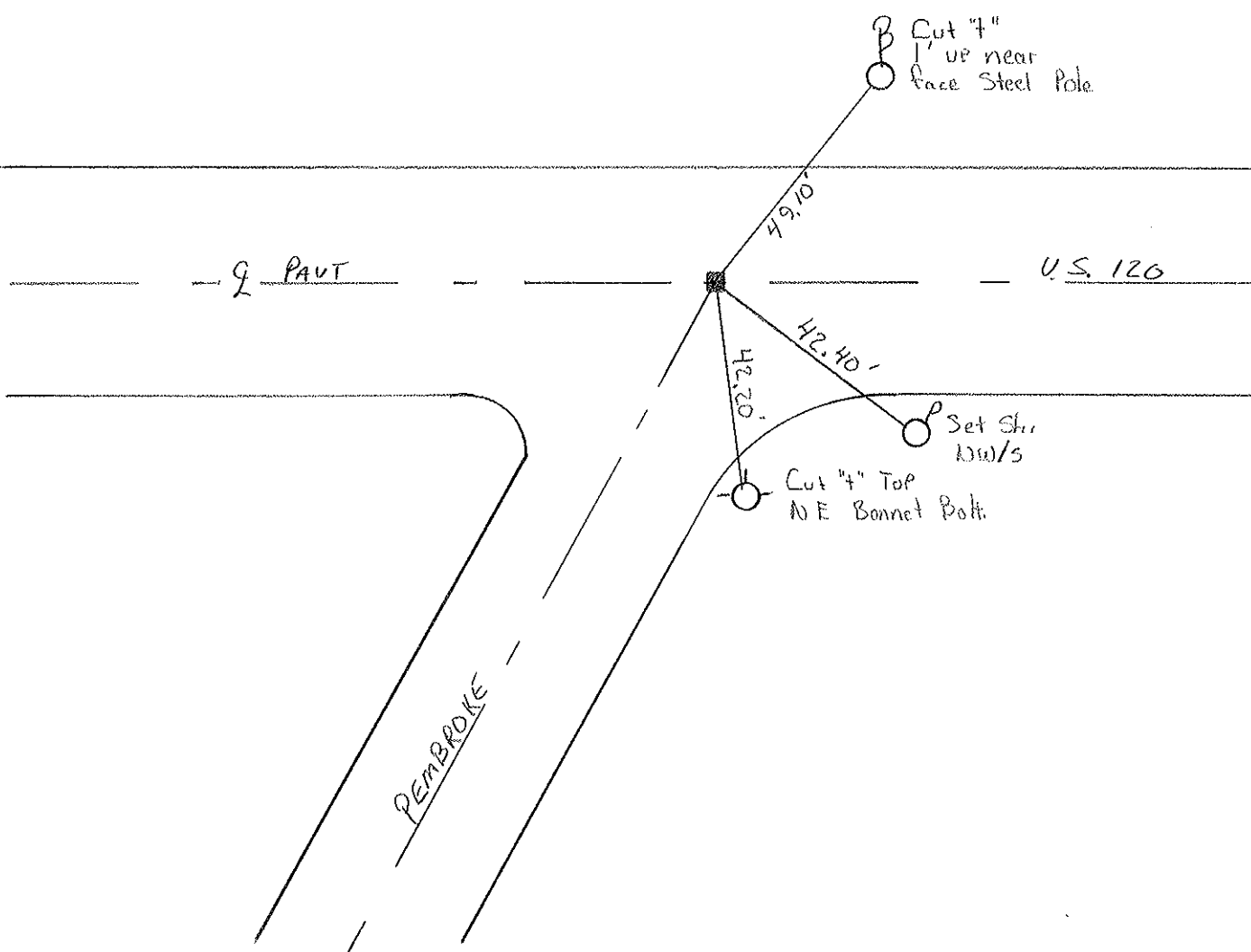
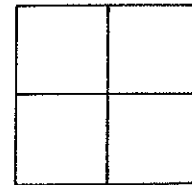

PERSONNEL	TITLE	PERSONNEL	TITLE
Tomsic			
Neuser			
Janyo			
Gronata			

COUNTY Lucas DATE Sept. 11, 1972
 S. R. U. S. 120 WEATHER _____
 SEC. Central Ave. TEMP. _____

DESCRIPTION Central ave LEFT CENTER LINE RIGHT JOB NO. _____

