

O.D.O.T. DISTRICT 2 SURVEY OFFICE (USE ONLY)

PERSONNEL

REFERENCE NO. 18 A

SHEET 10 OF 37

NOTES LOEHRKE

DATE 7/15/97

ROUTE SR 120

H.C. LOEHRKE

WEATHER FAIR

COUNTY LUCAS

R.C. HUSS

TEMP. 82°

TOWNSHIP CITY OF TOLEDO

COX

SECTION 30

DWG BY NIESE PID \_\_\_\_\_

T 9 S R 7 E

TYPE MONUMENT MONBOX

ON SURFACE - ~~BELOW~~ ON

OFFSET Q PAVEMENT ON LT : RT

- TO - EDGE PAVEMENT

STATION: 669+45

HORIZ.DATUM: \_\_\_\_\_ GEOID: \_\_\_\_\_

GRID: NORTHING: \_\_\_\_\_ EASTING: \_\_\_\_\_

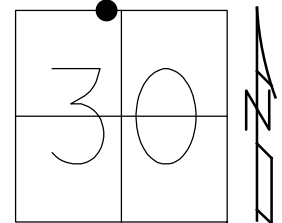

RECORD:  
FD MONBOX  
7/15/97, CL

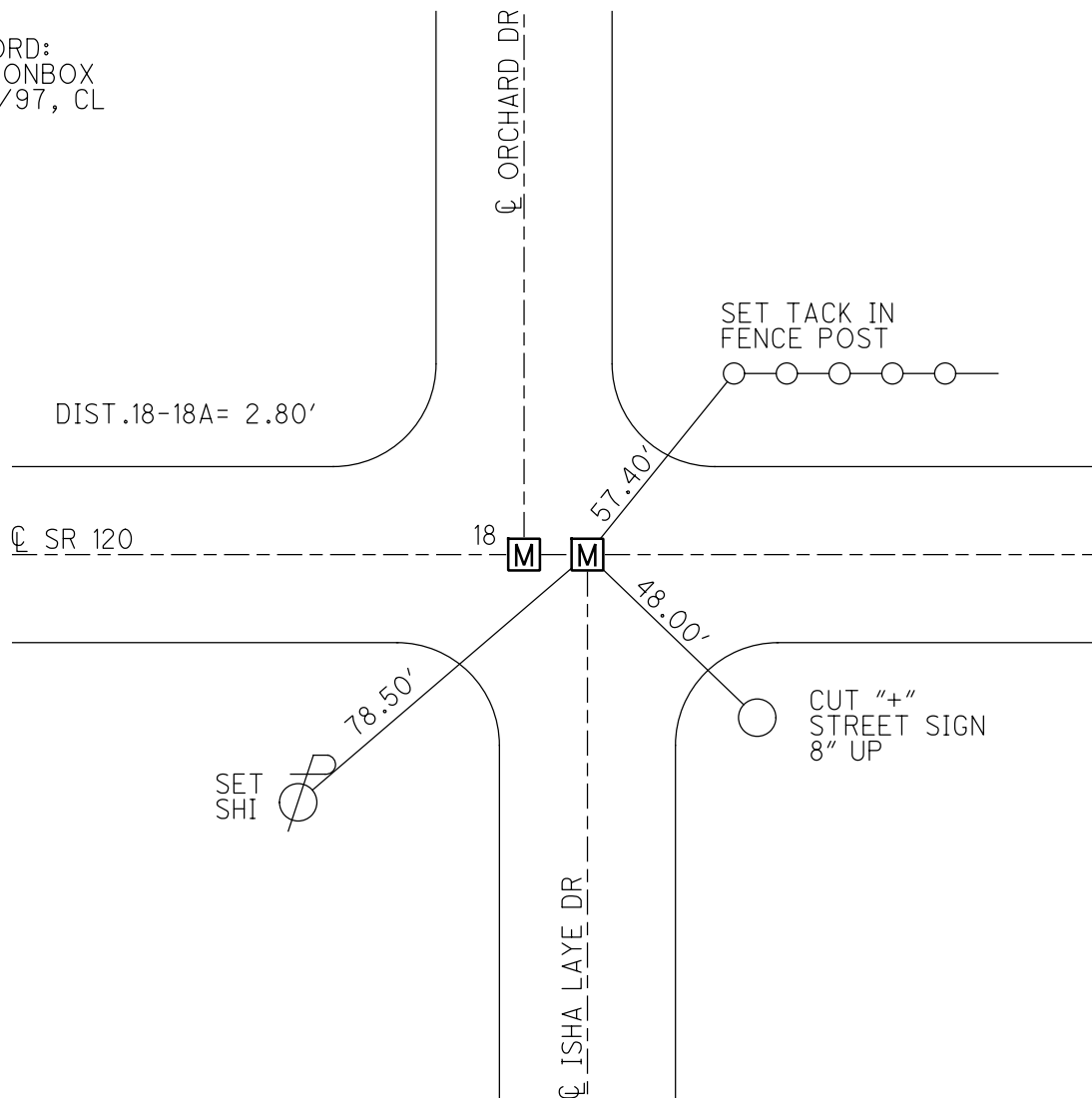

# O.D.O.T. DISTRICT 2 SURVEY OFFICE

PERSONNEL \_\_\_\_\_

REFERENCE NO. 18

SHEET 10 OF 15

NOTES LOENRKE

H.C. \_\_\_\_\_

DATE 7-15-97

ROUTE S.R. 120

R.C. Huss

WEATHER FAIR

COUNTY LUCAS

Cox F

TEMP. +82° F

TOWNSHIP \_\_\_\_\_

SECTION City of Toledo

T \_\_\_\_\_ R \_\_\_\_\_

TYPE MONUMENT Mon. Box - Un OPEN

ON SURFACE - ~~BELOW~~ Yes

~~LEFT - & PAV'T.~~ - RIGHT Yes

TO \_\_\_\_\_ EDGE PAVEMENT

S.L.M. 20+404    E 20+405    Km.

