

O.D.O.T. DISTRICT 2 SURVEY OFFICE (USE ONLY)

PERSONNEL \_\_\_\_\_

REFERENCE NO. 20

SHEET 12 OF 37

NOTES LOEHRKE DATE 7/15/97

ROUTE SR 120

H.C. LOEHRKE WEATHER FAIR

COUNTY LUCAS

R.C. HUSS TEMP. 84°  
COX

TOWNSHIP CITY OF TOLEDO

DWG BY NIESE PID \_\_\_\_\_

SECTION 30

T 9 S R 7 E

TYPE MONUMENT BOAT SPIKE

ON SURFACE - ~~BELOW~~ ON

OFFSET C PAVEMENT ON LT : RT

27.0' TO RT EDGE PAVEMENT

STATION: 674+10

HORIZ.DATUM: \_\_\_\_\_ GEOID: \_\_\_\_\_

GRID: NORTHING: \_\_\_\_\_ EASTING: \_\_\_\_\_

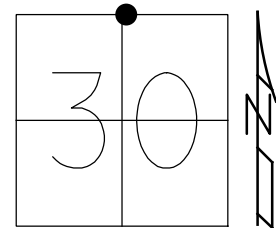

RECORD: P.I.  
STA 675+63.84  
 $\Delta = 00^{\circ}13'00''$  RT  
166.5' W OF  
W LINCOLNSHIRE RD S  
FD BOAT SPIKE  
7/15/97, CL  
SET P.K./WASHER  
12/29/97, CL

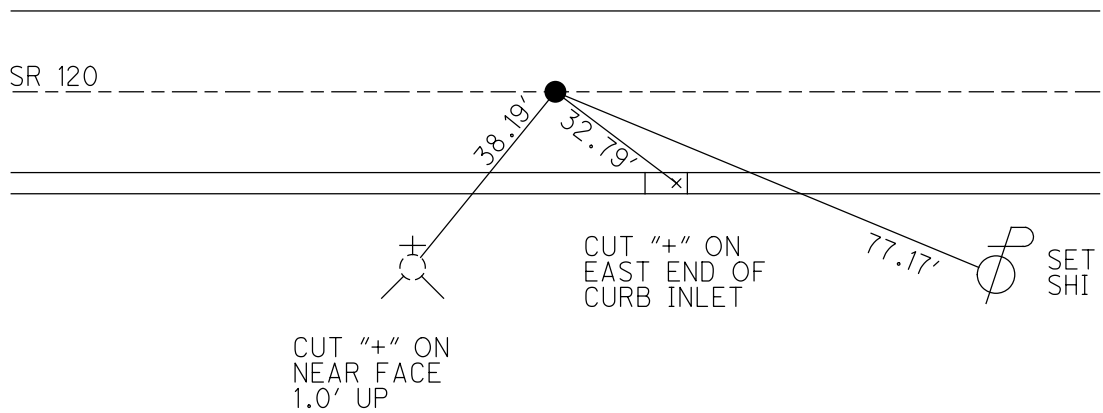

# O.D.O.T. DISTRICT 2 SURVEY OFFICE

PERSONNEL

REFERENCE NO. 20

SHEET 12 OF 15

NOTES LOEHRKE / HUSS

H.C. LOEHRKE

R.C. HUSS

Cox P

DATE 7-15-97

WEATHER FAIR

TEMP. +84

Set P.K. / W ASHER  
12-29-97

ROUTE S.R. 120

COUNTY Lucas

TOWNSHIP \_\_\_\_\_

SECTION City of Toledo

T \_\_\_\_\_ R \_\_\_\_\_

TYPE MONUMENT BOAT SPIKE

ON SURFACE - BELOW Yes

LEFT - & PAV'T. - RIGHT Yes

27.0' TO Rt EDGE PAVEMENT

S.L.M. 20 + 546.56

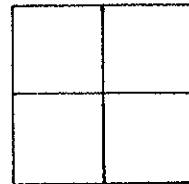

Record P.I.  
Sta 675 + 63.84  
 $\Delta = 00^\circ - 13' - 00''$  Rt.

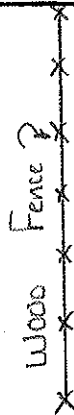

Notes: P.I. is  $\pm 166.5$  ft  
West of W. Lincolnshire Rd  
South.

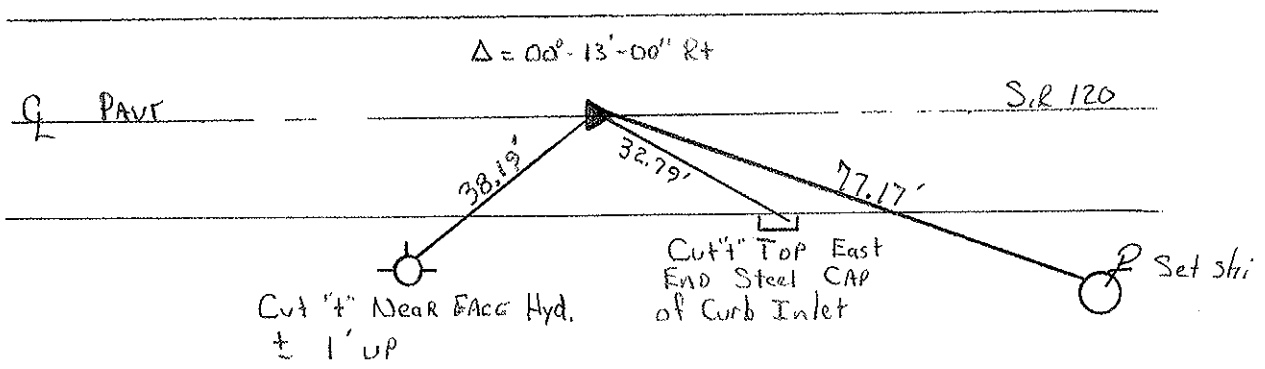

PERSONNEL	TITLE	PERSONNEL	TITLE
Tamsic			
Neuser			
Vanya			
Granata			

COUNTY Lucas DATE Sept. 11, 1972  
 S. R. U.S. 120 WEATHER \_\_\_\_\_  
 SEC. Central Ave TEMP. \_\_\_\_\_

DESCRIPTION Central LEFT CENTER LINE RIGHT JOB NO. \_\_\_\_\_

