

O.D.O.T. DISTRICT 2 SURVEY OFFICE (USE ONLY)

PERSONNEL

REFERENCE NO. 21

SHEET 14 OF 37

NOTES LOEHRKE

DATE 7/15/97

ROUTE SR 120

H.C. LOEHRKE

WEATHER FAIR

COUNTY LUCAS

R.C. HUSS

TEMP. 84°

TOWNSHIP CITY OF TOLEDO

COX

SECTION 30

DWG BY NIESE PID _____

T 9 S R 7 E

TYPE MONUMENT MONBOX

ON SURFACE - ~~BELOW~~ ON

OFFSET \varnothing PAVEMENT ON LT : RT
27.5' TO LT EDGE PAVEMENT

STATION: 674+78

HORZ. DATUM: _____ GEOID: _____

GRID: NORTHING: _____ EASTING: _____

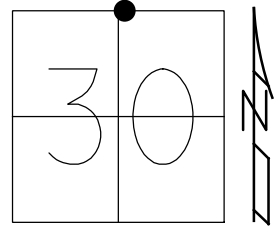

RECORD:
 FD MONBOX
 7/15/97, CL

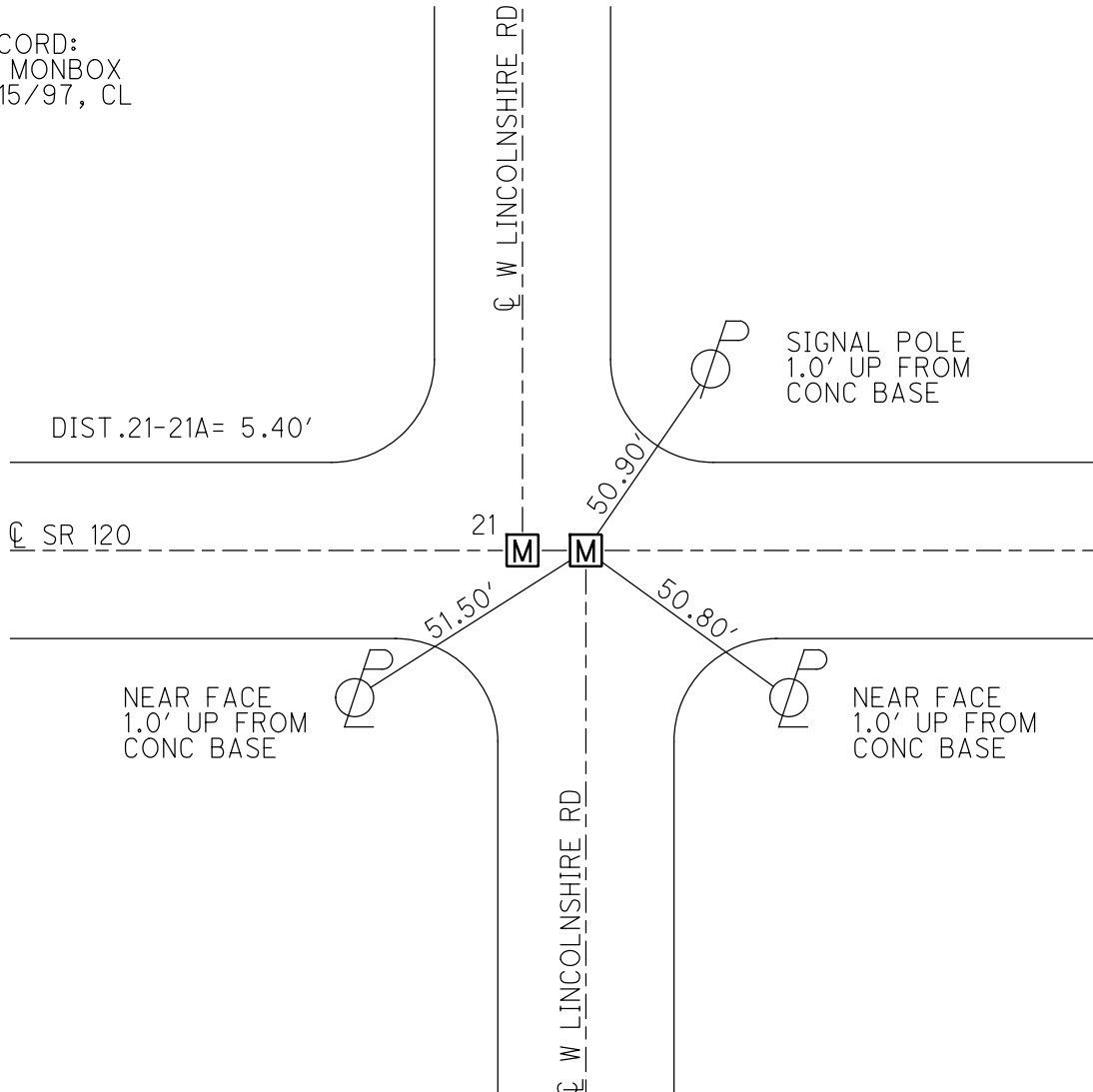

O.D.O.T. DISTRICT 2 SURVEY OFFICE

PERSONNEL

REFERENCE NO. 21

SHEET 13 OF 15

NOTES LOEHRKE / Huss

H.C. LOEHRKE

R.C. Huss

Cox P

DATE 7-15-97

WEATHER FAIR

TEMP. +84° F

ROUTE S.R. 120

COUNTY LUCAS

TOWNSHIP _____

SECTION City of Toledo

T _____ R _____

TYPE MONUMENT Mon Box - UN OPEN

ON SURFACE - ~~BELOW~~ Yes

LEFT - ~~CL~~ PAV'T. - RIGHT Yes

27.5' TO Lt EDGE PAVEMENT

S.L.M. ± 204565.7 & ± 204567.3

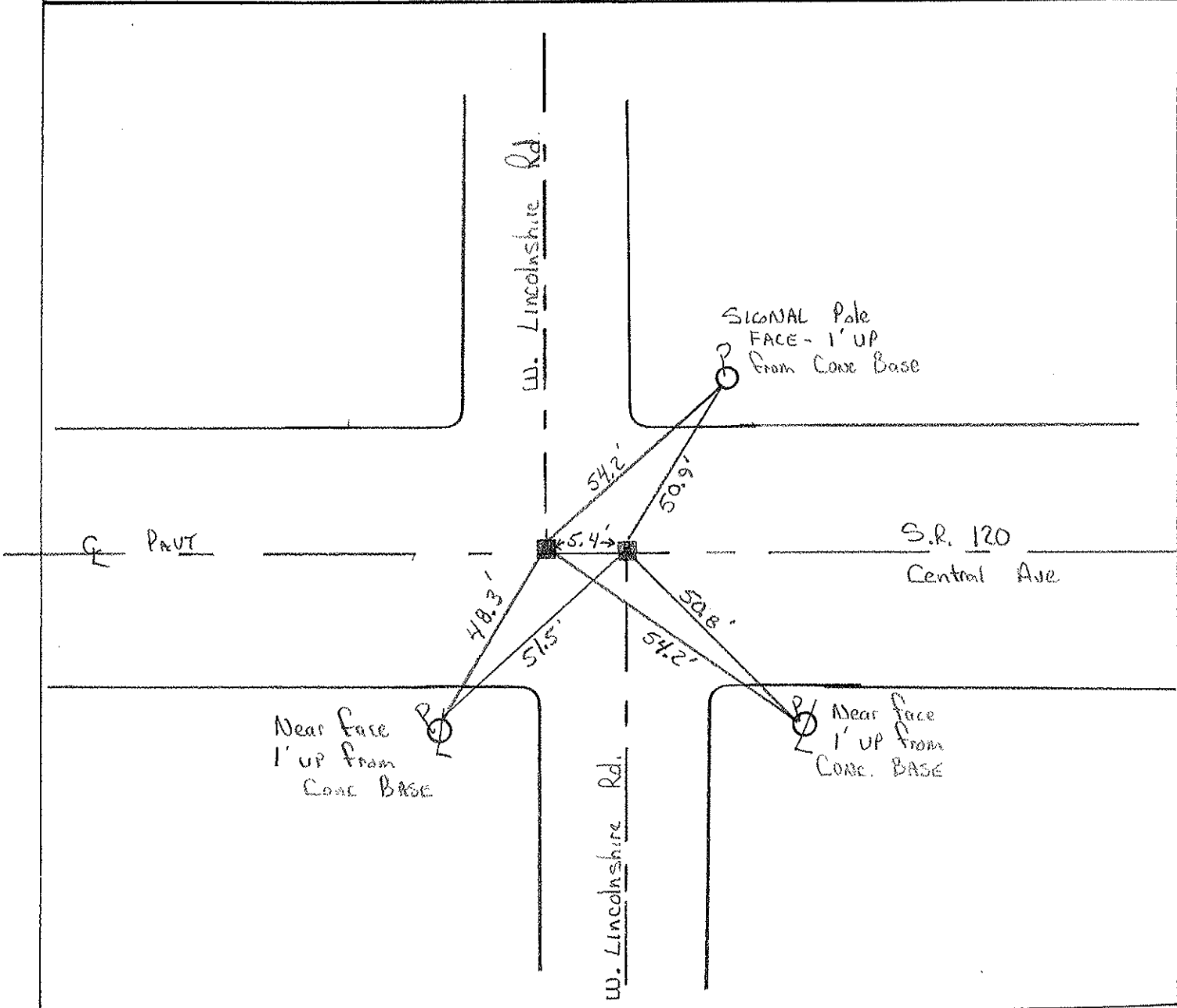
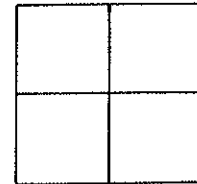

PERSONNEL TITLE PERSONNEL TITLE

COUNTY Lucas DATE Sept. 11, 1972

Tomsic _____

S. R. U.S. 120 WEATHER _____

Nasser _____

Vanyo _____

SEC. Central Ave. TEMP. _____

Granata _____

DESCRIPTION Central Ave LEFT CENTER LINE RIGHT JOB NO. _____

