

O.D.O.T. DISTRICT 2 SURVEY OFFICE (USE ONLY)

PERSONNEL

REFERENCE NO. 26

SHEET 1 OF 19

NOTES ALBRIGHT

DATE 10/24/77

ROUTE SR 120

H.C. GRDUZINSKI

WEATHER _____

COUNTY LUCAS

R.C. STUBLESKI

TEMP. 55°

TOWNSHIP CITY OF TOLEDO

SECTION 27

DWG BY NIESE PID _____

T 9 S R 7 E

TYPE MONUMENT CMON W/ HOLE

ON SURFACE - BELOW _____

OFFSET $\text{\textcircled{C}}$ PAVEMENT _____ LT : RT

_____ TO _____ EDGE PAVEMENT

STATION: 805+73

HORZ. DATUM: _____ GEOID: _____

GRID: NORTHING: _____ EASTING: _____

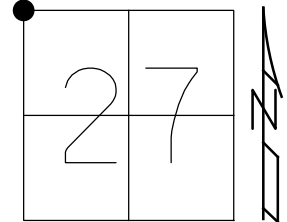

RECORD:
FD CMON
W/ HOLE IN CENTER
10/27/77, ALBRIGHT

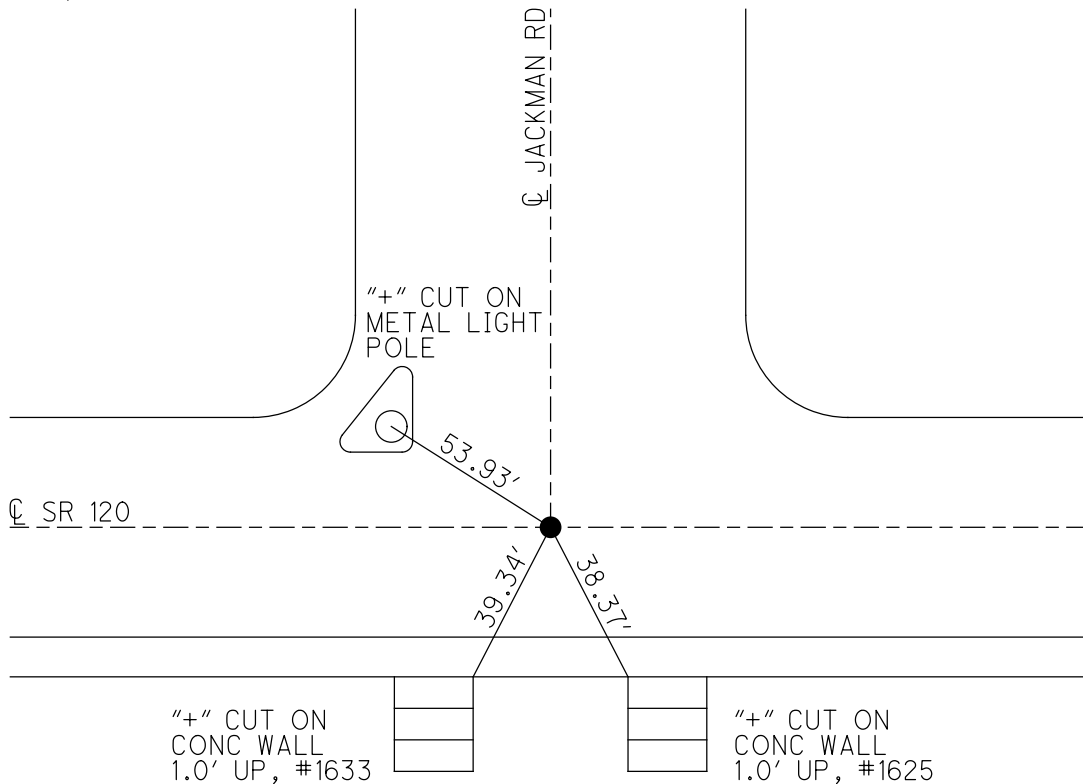

PERSONNEL	TITLE	PERSONNEL	TITLE
Albright			
Grdziejnski			
Stublencki			

PROJECT _____ DATE 10/24/77

PROJECT LIMITS _____ WEATHER _____

FROM STA. _____ TO STA. _____ TEMP 55°

DESCRIPTION MONUMENT REF: CENTRAL AVE - JACKMAN TO CHERRY

CONC. MON. WITH HOLE IN CENTER

SHINNER IN LIGHT & POWER POLE #09

+ CUT ON METAL POWER POLE 1' ABOVE GROUND

NOTE: ALL MEASUREMENTS PLUMBED

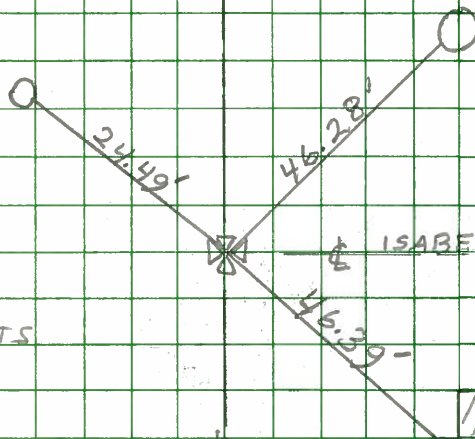

CONC. MON. WITH HOLE IN CENTER

#1625 CENTRAL

+ CUT ON CONC. WALL 1' ABOVE WALK

JACKMAN

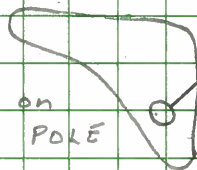

+ CUT ON METAL LIGHT POLE

+ CUT ON CONC. WALL 1' ABOVE WALK #1633

CENTRAL