

O.D.O.T. DISTRICT 2 SURVEY OFFICE (USE ONLY)

PERSONNEL

REFERENCE NO. 13

SHEET 14 OF 18

NOTES HOMAN
 H.C. ROUSOS
 R.C. FINTEL

DATE 8/4/10
 WEATHER SUNNY
 TEMP. 80°F

ROUTE SR 184
 COUNTY LUCAS
 TOWNSHIP SYLVANIA
 SECTION 11
 T 9 N R 6 E

DWG BY NIESE PID 99662

TYPE MONUMENT MONBOX

ON SURFACE - ~~BELOW~~ ON

OFFSET Q PAVEMENT 8.9' LT : ~~RT~~
- TO - EDGE PAVEMENT

STATION: 59+58.78

HORZ.DATUM: NAD83(2011)

GEOID: 2012A

GRID: NORTHING: 749448.692

EASTING: 1650203.564

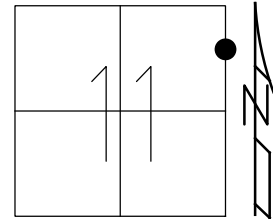

RECORD:
 SLM 1.34
 FD MONBOX
 MEAS. TO CTR.
 7/19/93, CL
 MONBOX
 W/ 1" IPIN
 REF13
 7/5/18, JFO

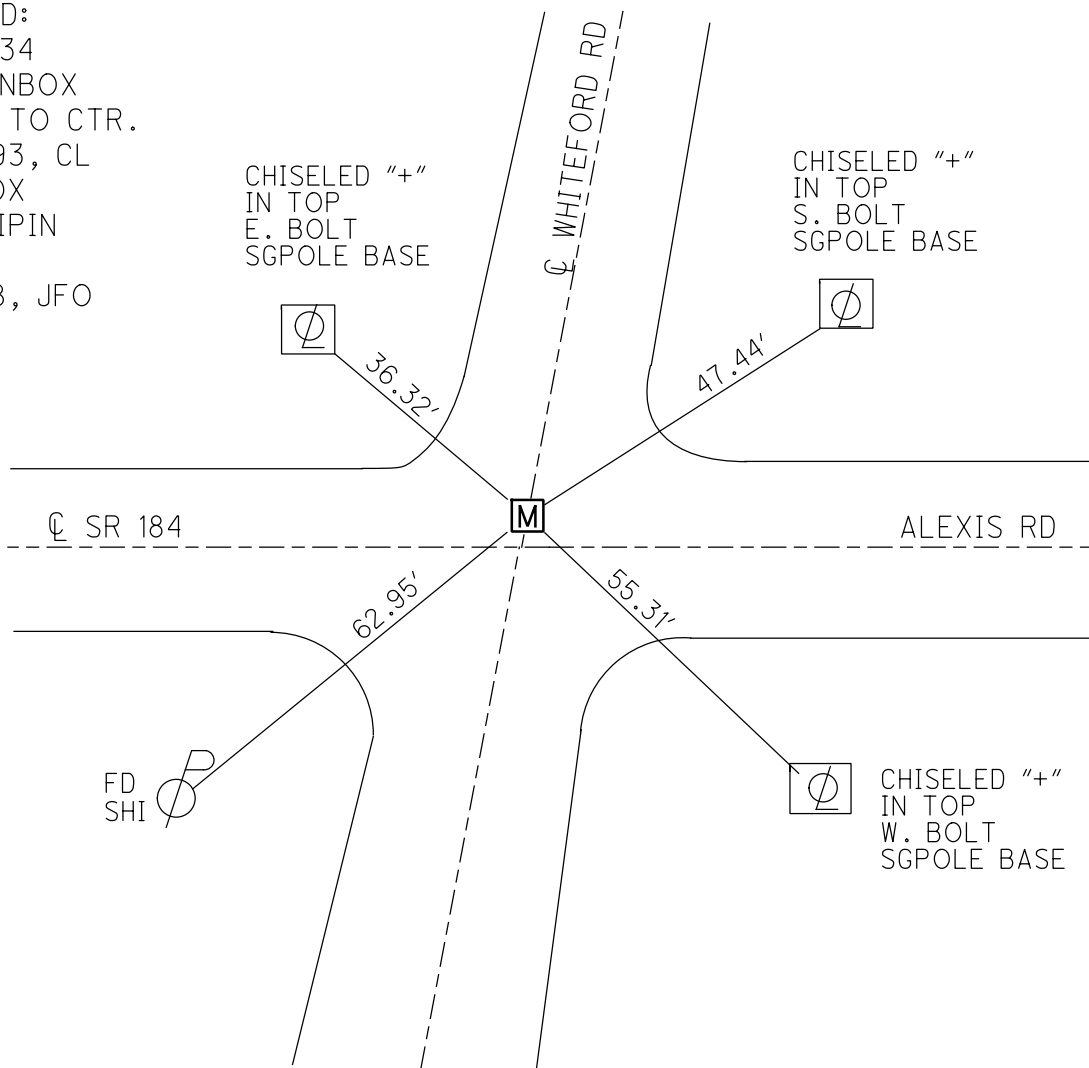

O.D.O.T. DISTRICT 2 SURVEY OFFICE (USE ONLY)

PERSONNEL	REFERENCE NO. <u>13</u>	SHEET <u>14</u> OF <u>18</u>
NOTES <u>HOMAN</u>	DATE <u>8/4/10</u>	ROUTE <u>SR. 184</u>
H.C. <u>ROUSOS</u>	WEATHER <u>SUNNY</u>	COUNTY <u>LUCAS</u>
R.C. <u>FINTEL</u>	TEMP. <u>80 F</u>	TOWNSHIP <u>SYLVANIA</u>
		SECTION <u>11</u>
		T <u>9</u> S R <u>6</u> E

TYPE MONUMENT I-PIN IN MONUMENT BOX
 ON SURFACE - ~~BELOW~~ ON _____
 LEFT - ☉ PAV'T - ~~RIGHT~~ 8.9'
 - TO - EDGE PAVEMENT
 S.L.M. 70+78

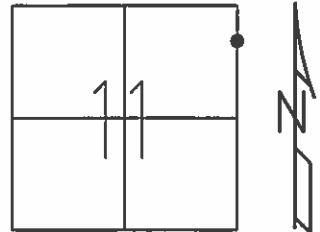

Grid: Northing: 749448.674 Easting: 1650203.402

RECORD:
 SLM.1.34

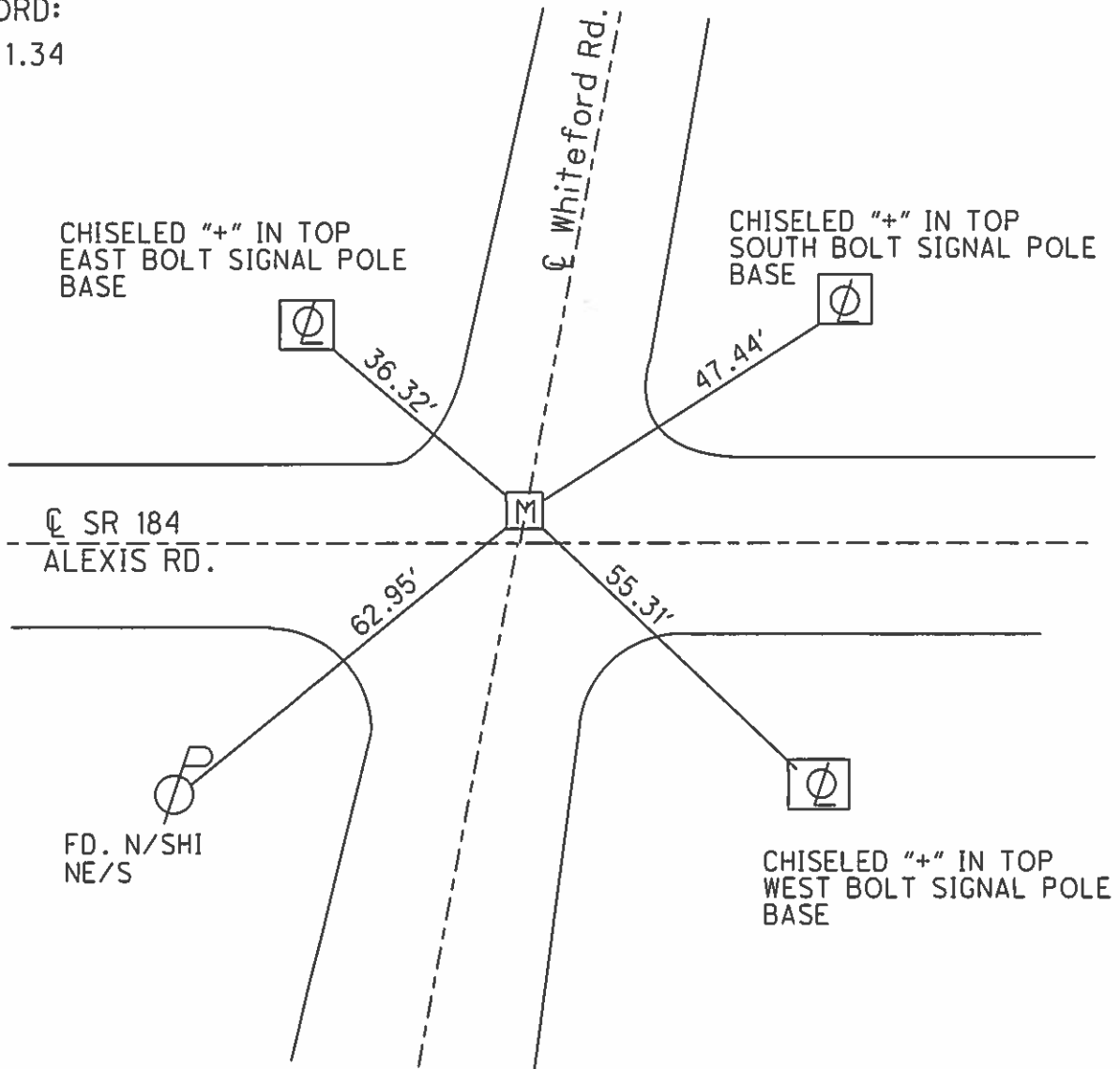

O.D.O.T. DISTRICT 2 SURVEY OFFICE

PERSONNEL _____

REFERENCE NO. 13

SHEET 12 OF 20

NOTES LOGRAKE

H.C. CORDES

R.C. ROMETO

CANTERBURY

DATE 7-19-93

WEATHER Clear

TEMP. +85

ROUTE S.R. #184

COUNTY LUCAS

TOWNSHIP _____

SECTION _____

T _____ R _____

TYPE MONUMENT Man Box - Meas. To Center

ON SURFACE - ~~BELOW~~ Yes

LEFT-~~€~~ PAV'T. - ~~RIGHT~~ 8.9'

TO EDGE PAVEMENT

S.L.M. 70778

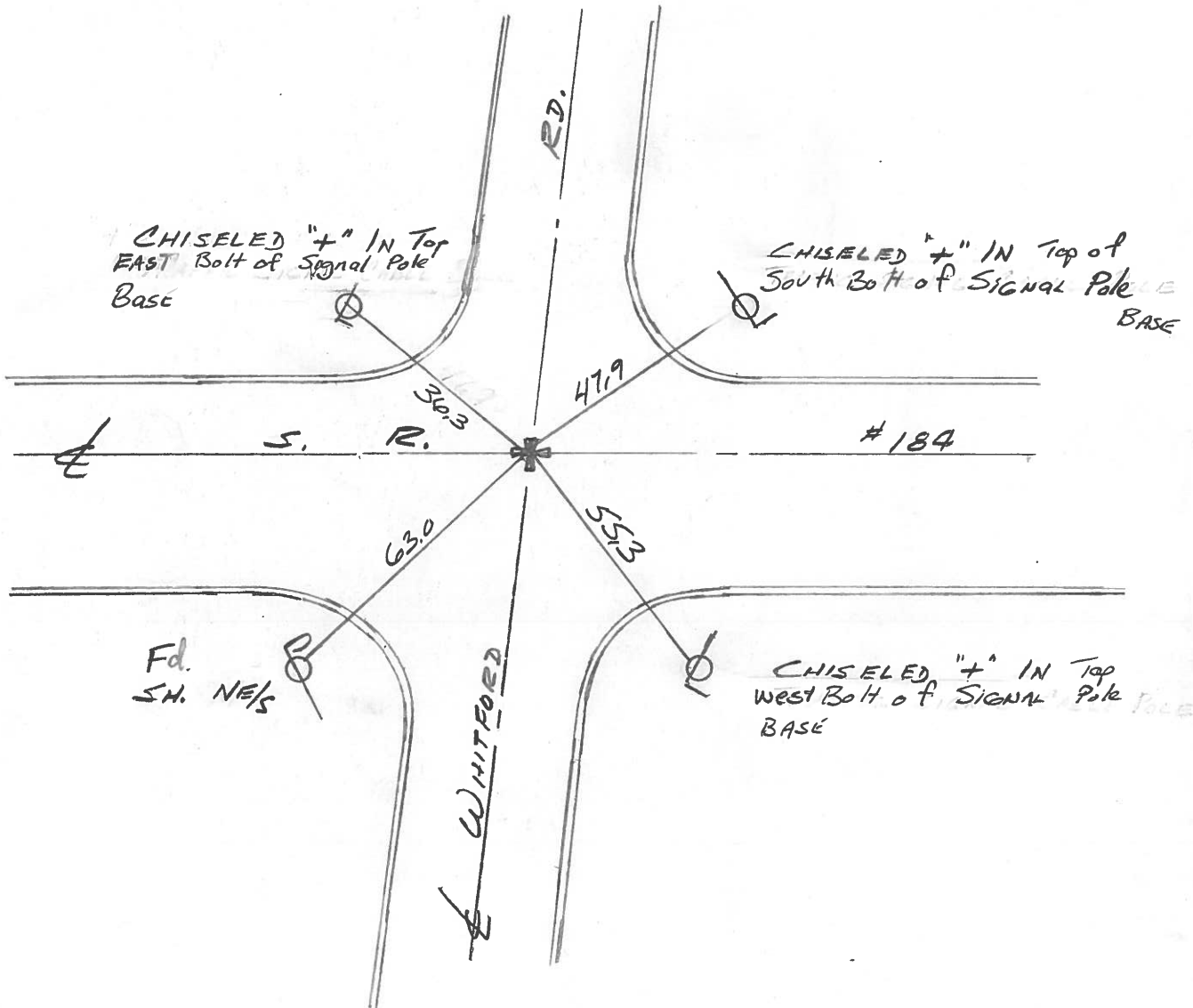
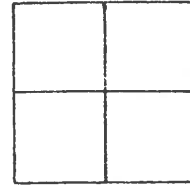

PERSONNEL	TITLE	PERSONNEL	TITLE	COUNTY	DATE
Stone				Lucas	20 Feb, 76
Michalak				S. R. 184	WEATHER Clear
Curtis				SEC. 1.00	TEMP. 33°

DESCRIPTION References to Control Points JOB NO.

LEFT CENTER LINE RIGHT

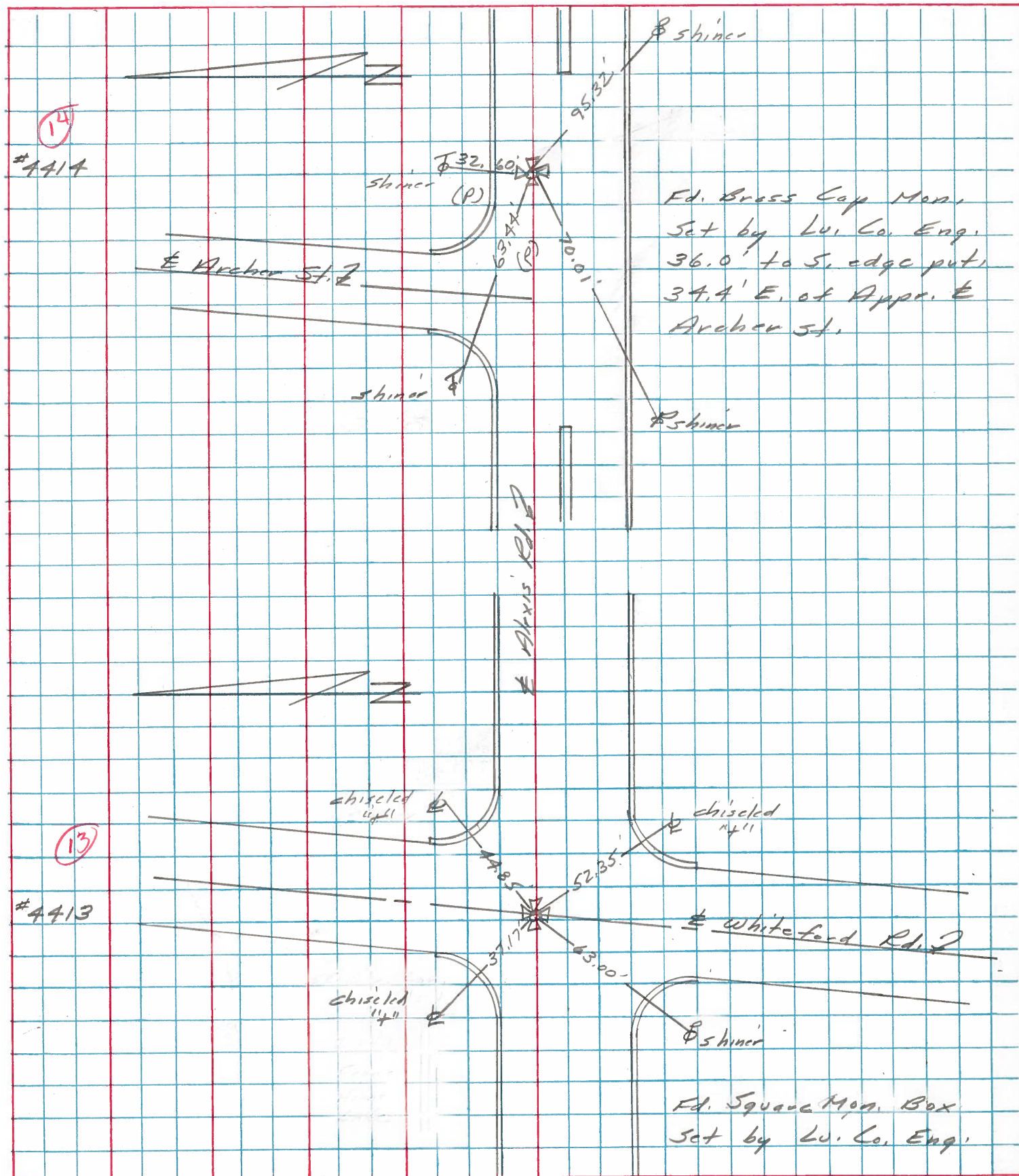

PERSONNEL	TITLE	PERSONNEL	TITLE	COUNTY	DATE
Stone	Notes			Lucas	28 June 68
Beck	Flag			S. R. 24-25 Bypass	WEATHER Cool
Michalak	Tape			SEC. Alexis Rd.	TEMP. 62°
Schroder	Tape				

DESCRIPTION References to Central Points JOB NO. _____

