

O.D.O.T. DISTRICT 2 SURVEY OFFICE (USE ONLY)

PERSONNEL

REFERENCE NO. 18

SHEET 1 OF 58

NOTES LOEHRKE

DATE 7/20/98

ROUTE SR 184

H.C. CORDES

WEATHER CLEAR

COUNTY LUCAS

R.C. ROMETO

TEMP. 78°

TOWNSHIP SYLVANIA

CANTERBURY

SECTION 12

DWG BY NIESE PID _____

T 9 S R 6 E

TYPE MONUMENT MONBOX

ON SURFACE - ~~BELOW~~ ON

OFFSET $\text{\textcircled{C}}$ PAVEMENT 10.4' LT : ~~RT~~

15.9' TO LT EDGE CURB

STATION: 102+36

HORZ.DATUM: _____ GEOID: _____

GRID: NORTHING: _____ EASTING: _____

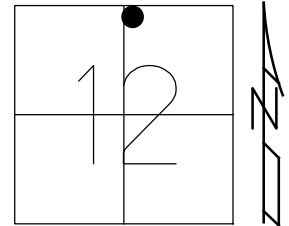

RECORD:
 ±225' WEST OF
 PLANTATION ST
 FD MONBOX
 MEASURED TO
 CENTER
 7/20/93, CL

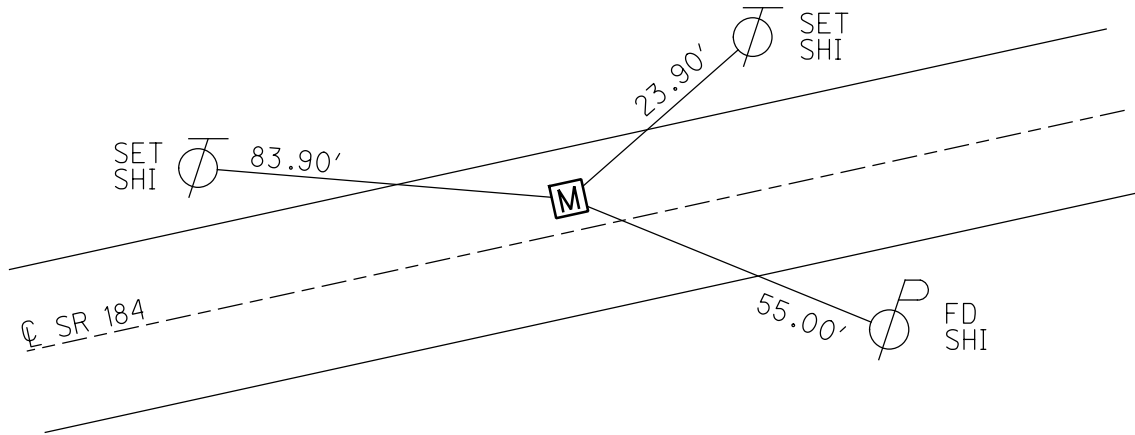

O.D.O.T. DISTRICT 2 SURVEY OFFICE

PERSONNEL _____

REFERENCE NO. 18

SHEET 16 OF 20

NOTES LOEHRKE

H.C. CORDES

R.C. POMETO

CANTERBURY

DATE 7-20-93

WEATHER CLEAR

TEMP. +78

ROUTE S.R. 184

COUNTY LUCAS

TOWNSHIP _____

SECTION _____

T. _____ R. _____

TYPE MONUMENT Mon Box - meas. to Center

ON SURFACE - BELOW Yes

LEFT-☉ PAV'T. - RIGHT 10.4

159 TO Lt EDGE PAVEMENT CURB

S.L.M. 102 + 36

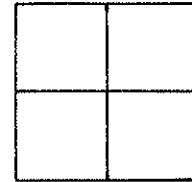

1225' West of
PLANTATION Ln.

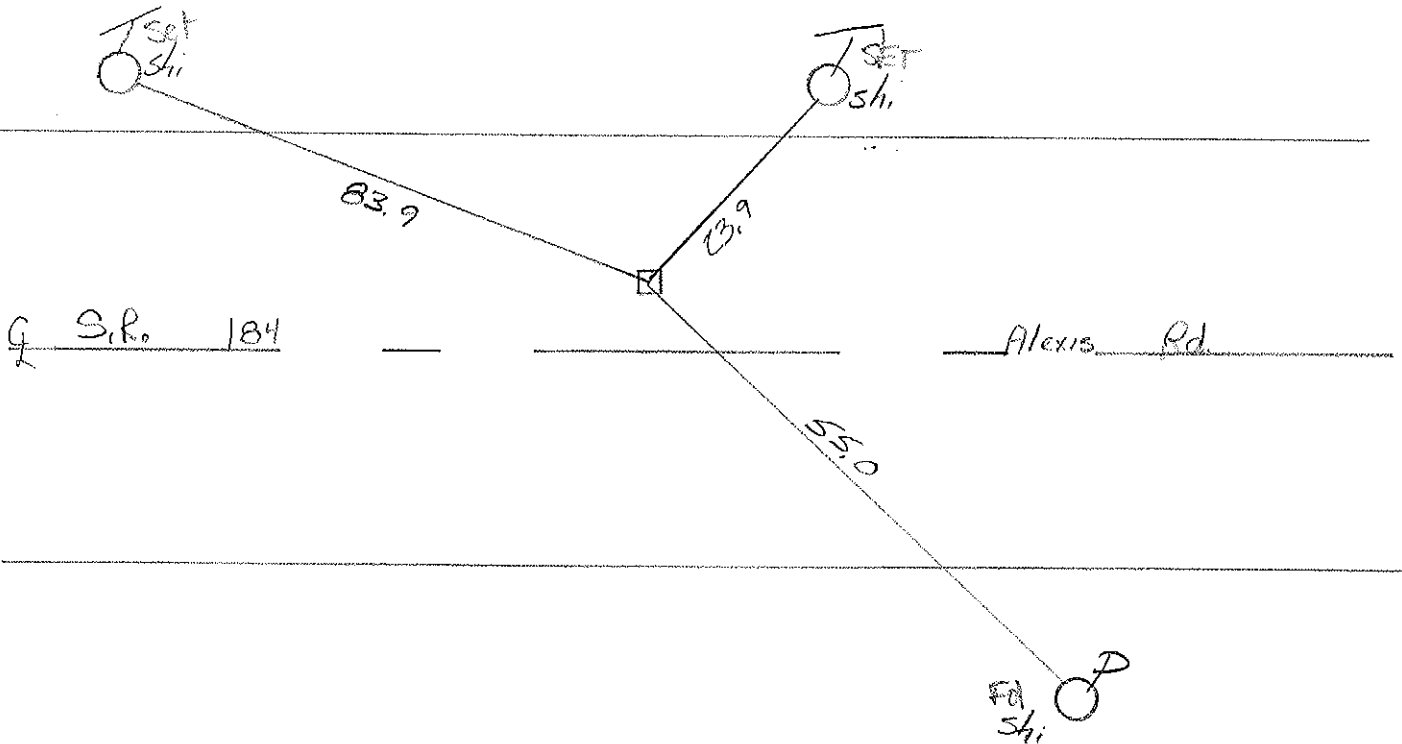

PERSONNEL TITLE PERSONNEL TITLE

COUNTY Lucas DATE 20 Feb. 76

Stone
Michalak
Curtis

S. R. 184 WEATHER Clear

SEC. 1.50 TEMP. 36°

DESCRIPTION

References to Control Points
LEFT CENTER LINE RIGHT

JOB NO.

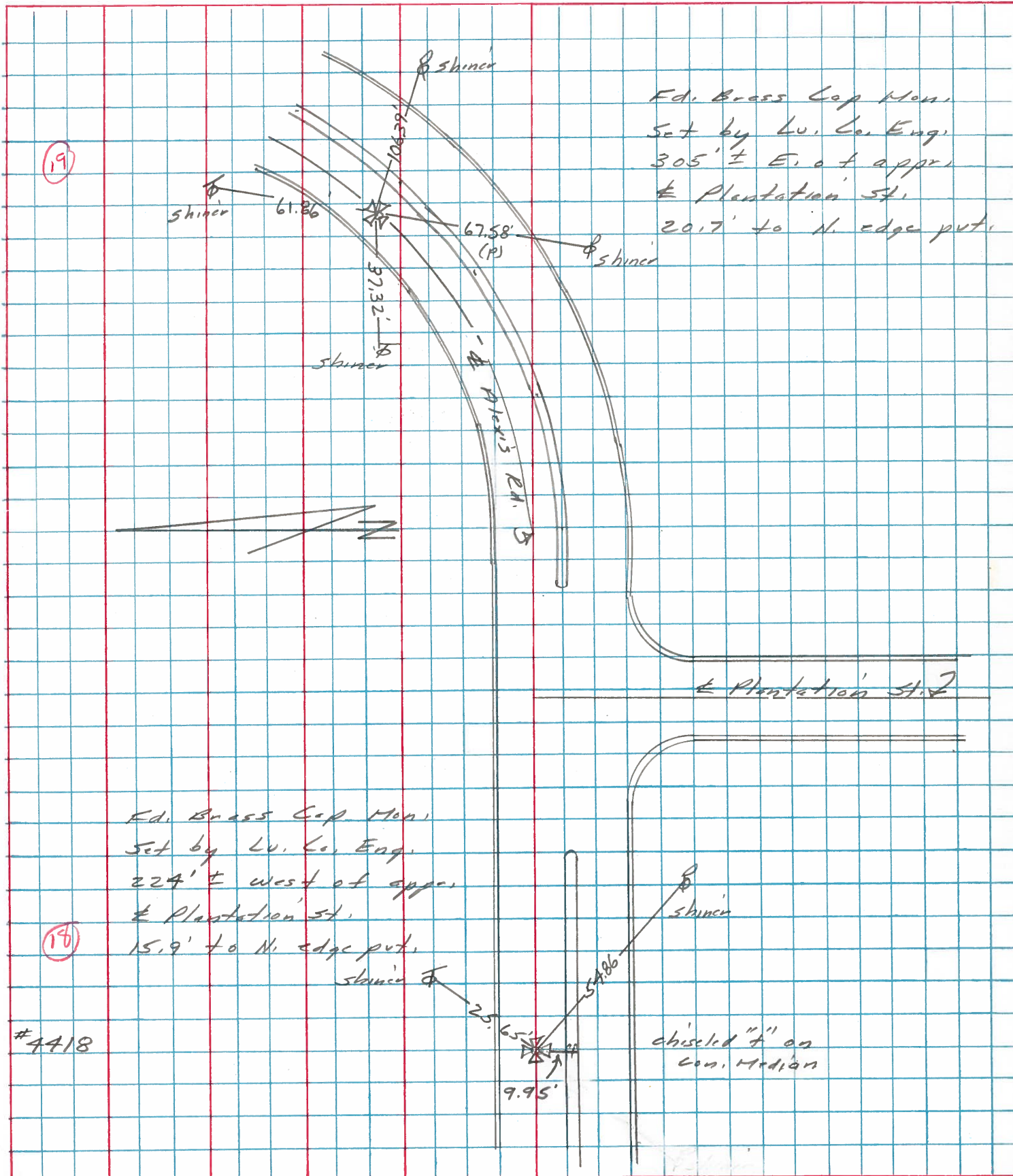

PERSONNEL	TITLE	PERSONNEL	TITLE	COUNTY	DATE	WEATHER	TEMP.
Stone	Notes			Lucas	1 July 68	Woods	78°
Michalak	Tape			S. R. 24-25 Bypass			
Schroder	Tape			SEC. Alexis Rd.			

DESCRIPTION References to Control Points JOB NO. _____
 LEFT CENTER LINE RIGHT

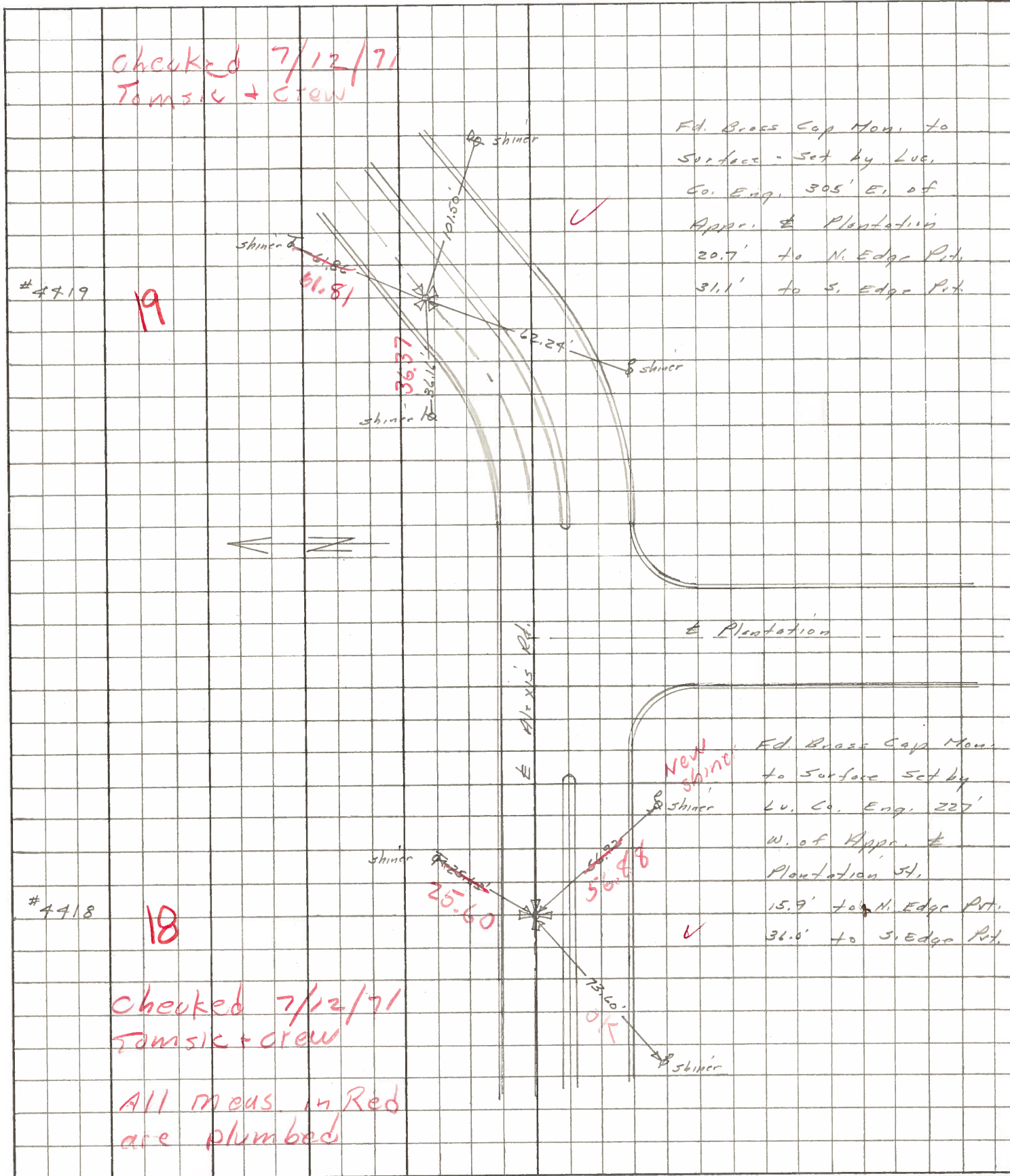

checked 7/12/71
Tamsik + crew

#4419

19

Ed. Brass Cap Mon. to
Surface - Set by Luc.
Co. Eng. 305' E. of
Appr. & Plantation
20.7' to N. Edge Pth.
31.1' to S. Edge Pth.

#4418

18

Ed. Brass Cap Mon.
to Surface Set by
Lu. Co. Eng. 227'
W. of Appr. &
Plantation St.
15.9' to N. Edge Pth.
36.0' to S. Edge Pth.

checked 7/12/71
Tamsik + crew

All meas. in Red
are plumbed

New shiner

✓

✓