

O.D.O.T. DISTRICT 2 SURVEY OFFICE (USE ONLY)

PERSONNEL _____

REFERENCE NO. 24

SHEET 9 OF 58

NOTES STONE DATE 2/20/76

ROUTE SR 184

H.C. MICHALAK WEATHER CLEAR

COUNTY LUCAS

R.C. CURTIS TEMP. 45°

TOWNSHIP CITY OF TOLEDO

DWG BY NIESE PID _____

SECTION 7

T 9 S R 7 E

TYPE MONUMENT BRASS CAP

ON SURFACE - ~~BELOW~~ ON

OFFSET ☉ PAVEMENT ON LT : RT

15.6' TO LT EDGE PAVEMENT

STATION: 137+81

HORIZ.DATUM: _____

GEOID: _____

GRID: NORTHING: _____

EASTING: _____

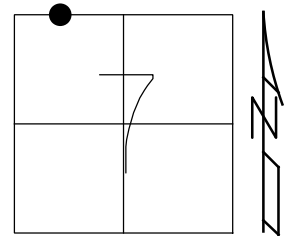

RECORD: P.I.
 Δ = RT
 FD BRASS CAP MON
 SET BY LUCAS
 COUNTY ENGINEER
 2/20/76, STONE

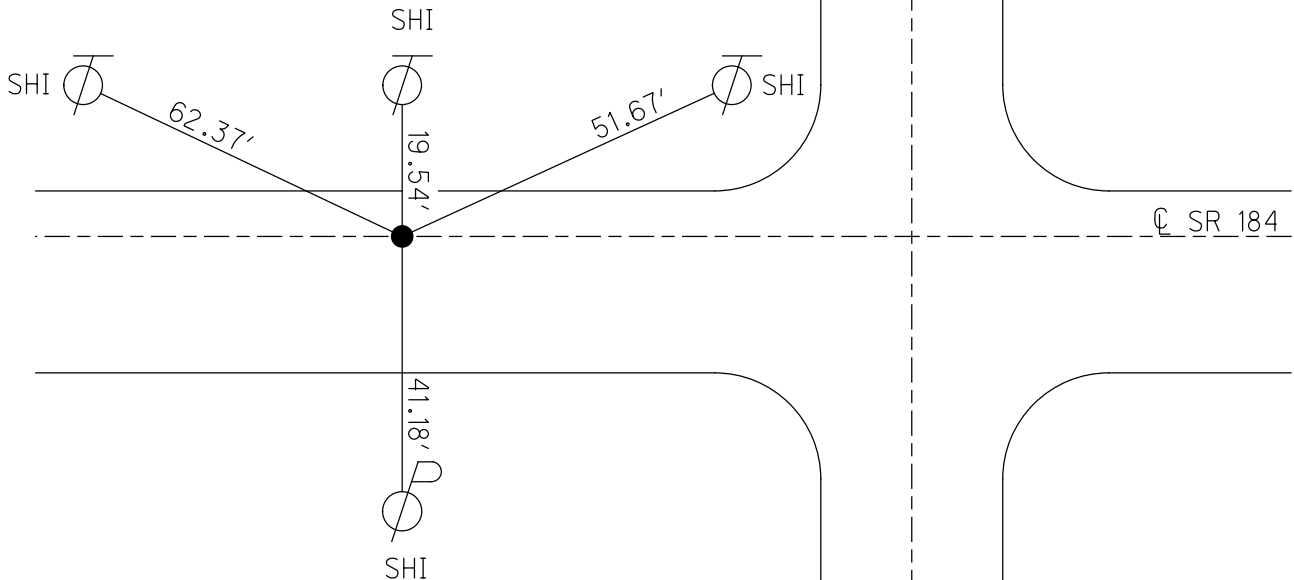

PERSONNEL	TITLE	PERSONNEL	TITLE	COUNTY	DATE	WEATHER	TEMP.
Stone				LUCAS	20 Feb. 76	Clear	45°
Michalek				S. R. 187			
Curtis				SEC. 2,00			

DESCRIPTION: *References to Control Points* JOB NO. _____

LEFT CENTER LINE RIGHT

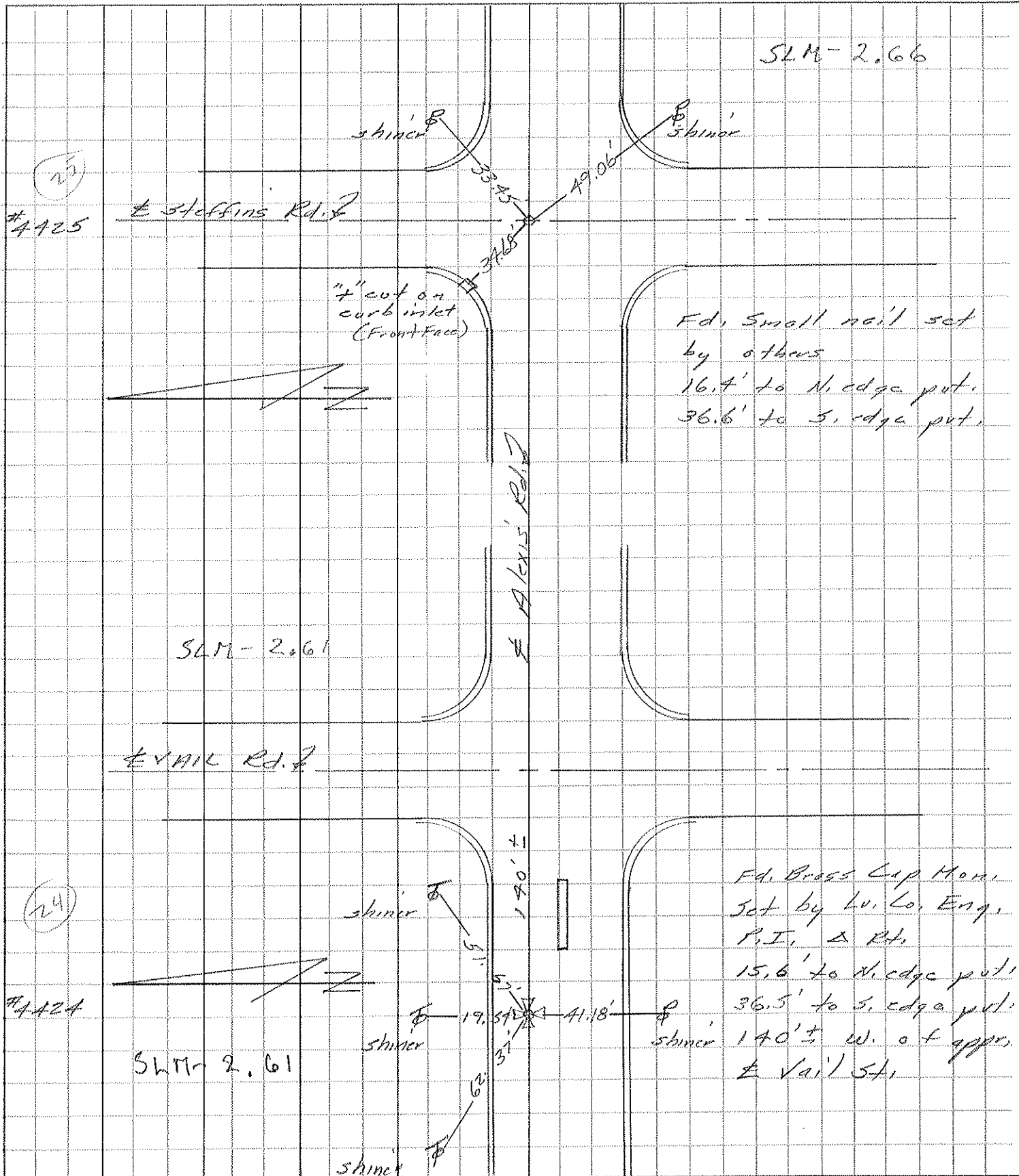

PERSONNEL	TITLE	PERSONNEL	TITLE
Stone	Notes		
Michalek	Tape		
Schnoder	Tape		

COUNTY Lucas DATE 1 July 68
 S. R. 24-25 Bypass WEATHER Warm
 SEC. Alexis Rd. TEMP. 80°

DESCRIPTION References to Control Points JOB NO. _____
 LEFT CENTER LINE RIGHT

