

O.D.O.T. DISTRICT 2 SURVEY OFFICE (USE ONLY)

PERSONNEL _____

REFERENCE NO. 49 A

SHEET 32 OF 58

NOTES CITY _____

DATE 1/13/92

ROUTE SR 184

H.C. OF _____

WEATHER _____

COUNTY LUCAS

R.C. TOLEDO

TEMP. _____

TOWNSHIP CITY OF TOLEDO

DWG BY NIESE

PID _____

SECTION 9

T 9 S R 7 E

TYPE MONUMENT MONBOX

ON SURFACE - ~~BELOW~~ ON _____

OFFSET C PAVEMENT ON _____ LT : RT

- TO - EDGE PAVEMENT

STATION: 263+97.38

HORZ. DATUM: _____

GEOID: _____

GRID: NORTHING: _____

EASTING: _____

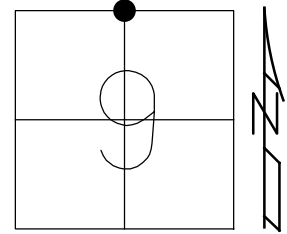

RECORD:
 TOLEDO PLAN
 LUC-SR 184-03.51
 PLAN ST 828+53.79
 FD MONBOX
 1/13/92, C.O.T.
 1/2 SEC LINE
 BETWEEN
 DOUGLAS & JACKMAN RD

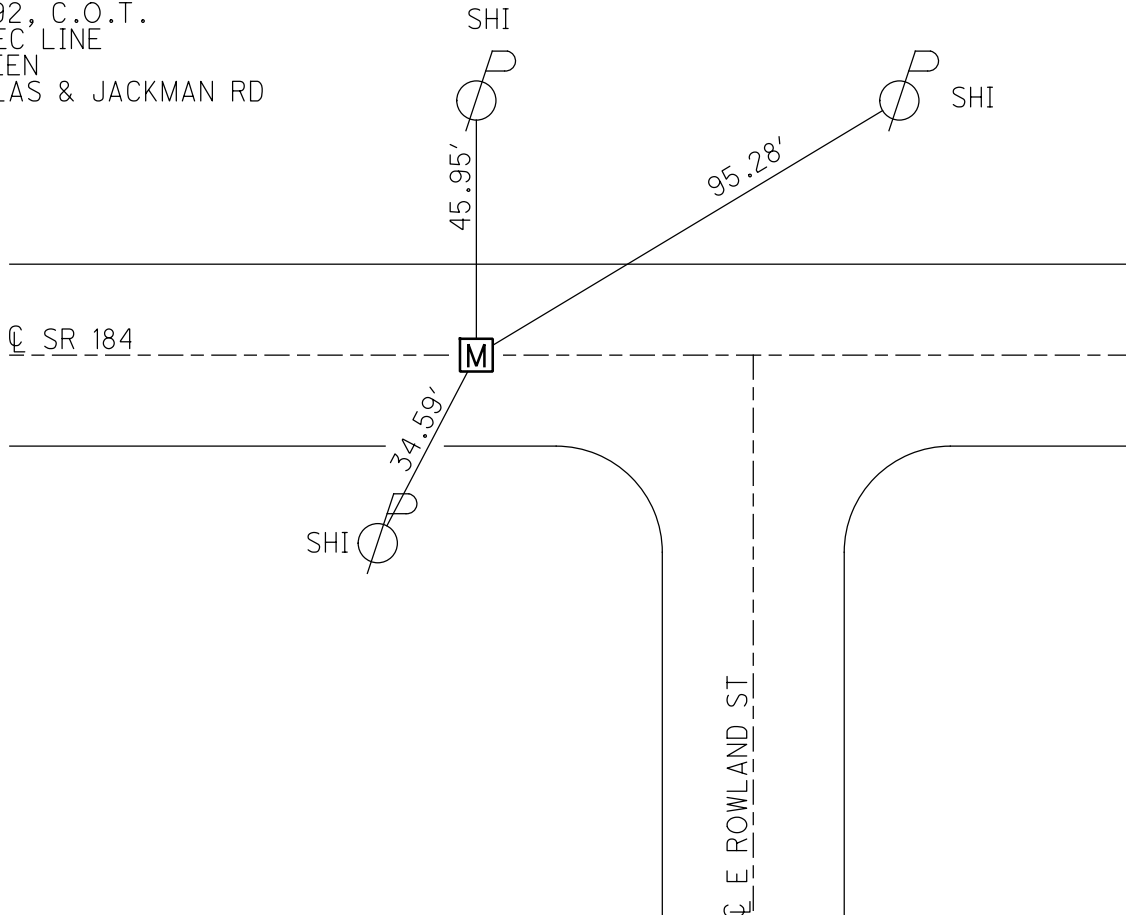

O.D.O.T. DISTRICT 2 SURVEY OFFICE

PERSONNEL _____

REFERENCE NO. 494

SHEET 4 OF 5

NOTES CITY

H.C. OF

R.C. TOLEDO

DATE 1-13-92

WEATHER _____

TEMP. _____

ROUTE 184

COUNTY LUCAS

TOWNSHIP WASHINGTON

SECTION 9

T. 2 S. R. 7 E.

TYPE MONUMENT Fd Man Box

ON SURFACE - BELOW SURFACE

LEFT - ☉ PAW'T. - RIGHT ☉

TO EDGE PAVEMENT

S.L.M. 263+97.38

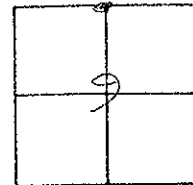

TOLEDO PLAN LUC.-SR-184-03.51

DRAWN BY WM LUCE

PLAN STA. = 828+53.79

