

O.D.O.T. DISTRICT 2 SURVEY OFFICE (USE ONLY)

PERSONNEL

REFERENCE NO. 53

SHEET 36 OF 58

NOTES STONE DATE 9/2/76
 H.C. MICHALAK WEATHER FAIR
 R.C. NEUSER TEMP. 64°
CURTIS/GRANATA

ROUTE SR 184
 COUNTY LUCAS
 TOWNSHIP CITY OF TOLEDO
 SECTION 10
 T 9 S R 7 E

DWG BY NIESE PID _____

TYPE MONUMENT MONBOX W/ 1" IPIN

ON SURFACE - ~~BELOW~~ ON

OFFSET ϕ PAVEMENT ON _____ LT : RT

_____ TO _____ EDGE PAVEMENT

STATION: 342+67

HORZ. DATUM: _____ GEOID: _____

GRID: NORTHING: _____ EASTING: _____

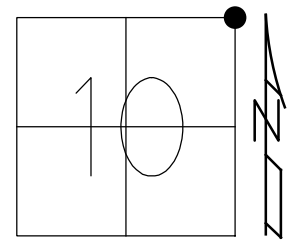

RECORD:
 FD MONBOX
 W/ 1" IPIN
 9/2/76, STONE

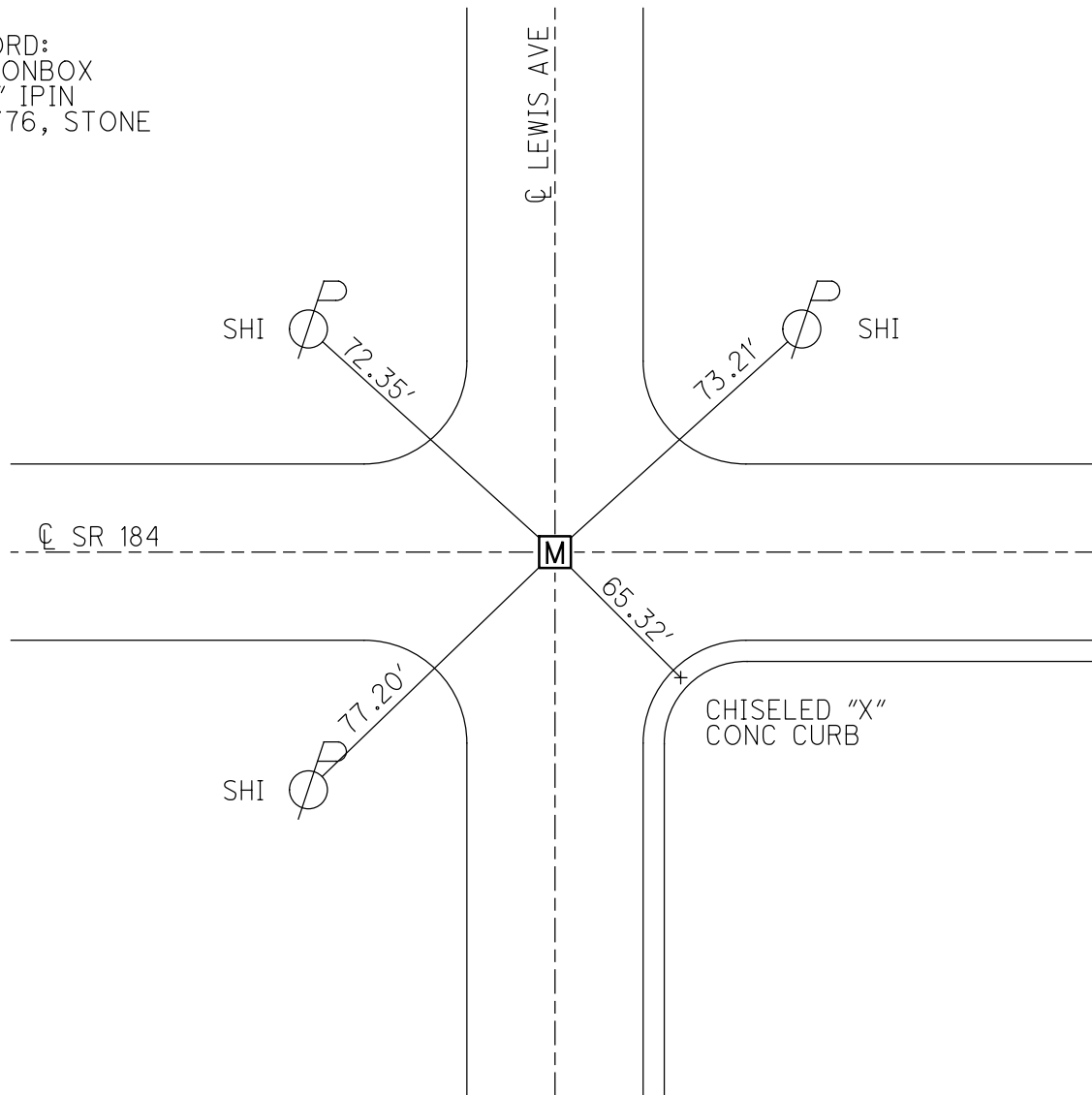

| PERSONNEL | TITLE | PERSONNEL | TITLE | COUNTY | DATE |
|-------------|------------------------------|-------------|-------|------------------|--------------|
| Stange | | Granata | | Lucas | 2 Sept. 76 |
| Michalek | | | | S. R. 184 | WEATHER Fair |
| Hansen | | | | SEC. 13611, R. 1 | TEMP. 64° |
| Curtis | | | | | |
| DESCRIPTION | References to Control Points | | | | JOB NO. |
| | LEFT | CENTER LINE | RIGHT | | |

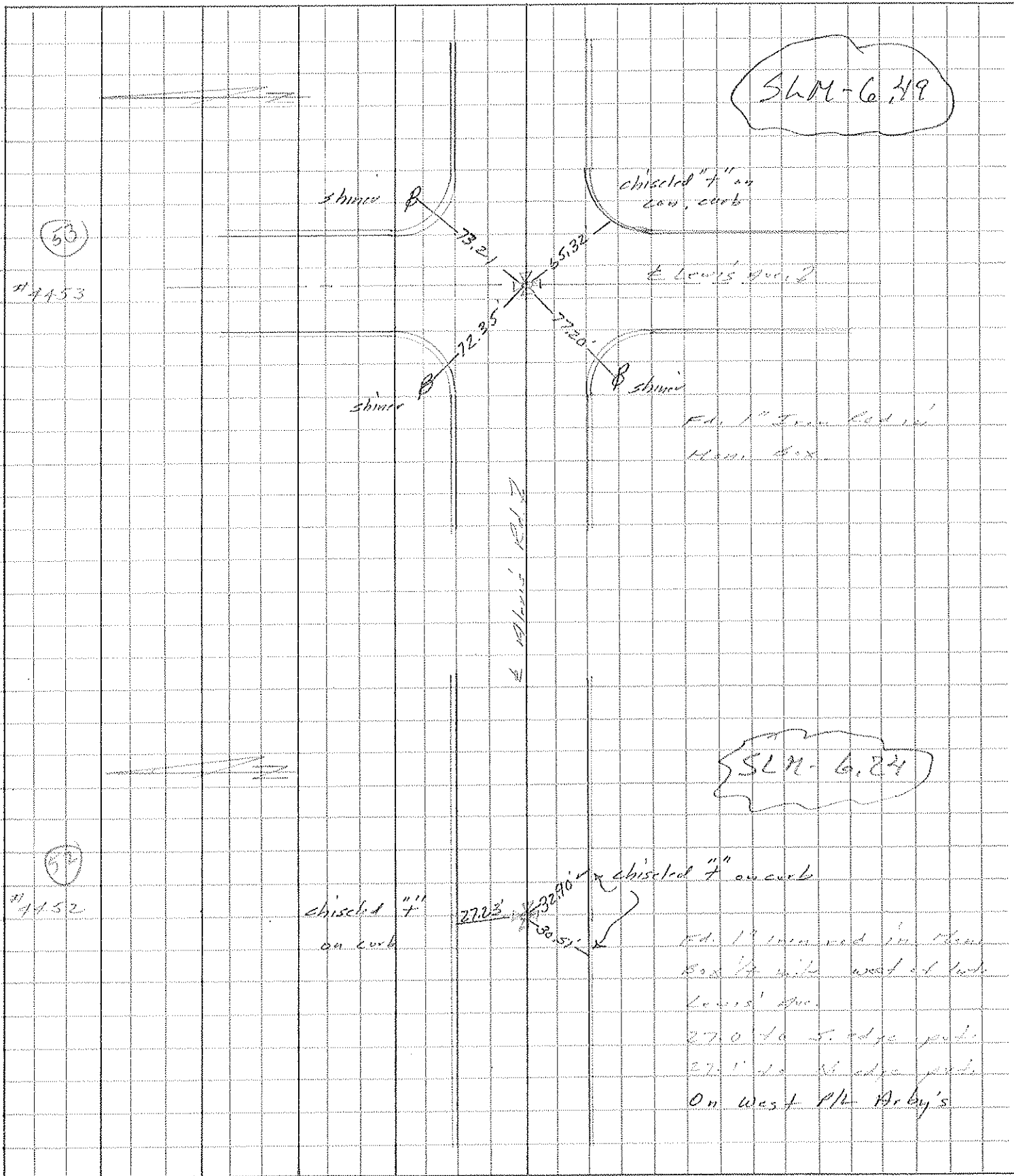

| PERSONNEL | TITLE | PERSONNEL | TITLE | COUNTY | DATE | WEATHER | TEMP. |
|-----------|-------|-----------|-------|---------------------|-----------|---------|-------|
| Stone | Notes | | | Lucas | 5 July 68 | Fair | 66° |
| Michalak | Tape | | | S. R. 27-25 By Pass | | | |
| Schroeder | Tape | | | SEC. Alexis Rd. | | | |

DESCRIPTION References to Control Points LEFT CENTER LINE RIGHT JOB NO.

