

O.D.O.T. DISTRICT 2 SURVEY OFFICE (USE ONLY)

PERSONNEL _____ REFERENCE NO. 12 A SHEET 6 OF 42
 NOTES WESTFALL DATE 8/2/13 ROUTE US 20A
 H.C. ROUSOS WEATHER SUNNY COUNTY LUCAS
 R.C. WESTFALL TEMP. 70° TOWNSHIP SWANTON
 _____ SECTION 9
 _____ T 7 N R 9 E

TYPE MONUMENT MONBOX, 5/8" IPIN
 ON SURFACE - ~~BELOW~~ ON
 LEFT - ☉ PAV'T - RIGHT -
- TO - EDGE PAVEMENT
 S.L.M. 161+74.10

Grid: Northing: 697963.543 Easting: 1603432.044

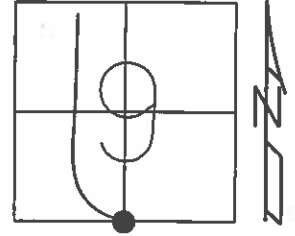

FD 1 1/2" SQ. BOLT
 IN MONBOX.
 SET BY LUCAS CO.
 6/28/85, I.S.

FD MONBOX
 GPS, REF9
 12/6/11, DCH

GPS, NEWREF9
 4/11/14, DCH

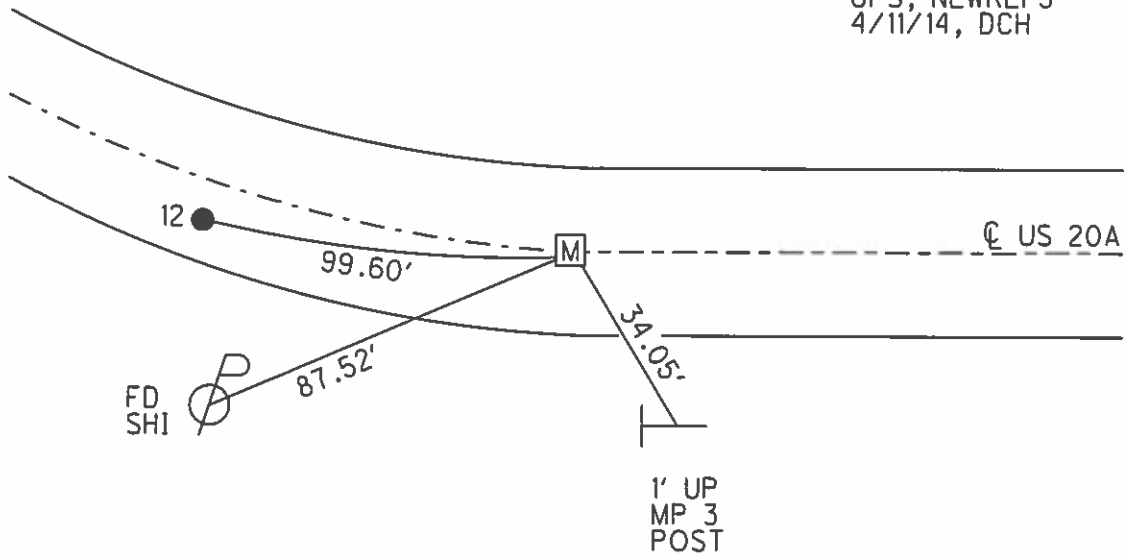

PERSONNEL TITLE PERSONNEL TITLE

COUNTY Lucas DATE 5 Nov. 64

Stone

S. R. # 2-20A WEATHER Mild

£

Crew

SEC. TEMP. 62°

DESCRIPTION REFERENCES to Control Pts. JOB NO.

LEFT CENTER LINE RIGHT

134+37.41 = N. E.S. £ Sec. 9
Fd. 1" I. Pin 1" Below Surface

34.26' N. to shiner in £
72.58' N.W. to S.E. Cor. House (2nd Block)
67.22' S.W. to shiner in £
54.58' S.S.W. to Shiner in £

See Sh #90-X for added detail

134+03.71 = P.I. Δ = 16° 01' Lt.
Fd. 1" I. Pin at Surface

48.34' N. to Shiner in £
53.40' S.W. to Shiner in £
73.39' S.S.E. to Shiner in £

159+92.90 = £ 295
Fd. 1" I. Pin in Mon. Box

45.54' S.S.E. to Chiseled "T" in Sign Post
100.37' N.E. to Shiner in £
60.44' N.W. to S.E. Cor. Bldg. (2nd Block)

" FINIS "