

O.D.O.T. DISTRICT 2 SURVEY OFFICE (USE ONLY)

PERSONNEL _____ REFERENCE NO. 19 SHEET 21 OF 52
 NOTES RHOADES DATE 8/10/22 ROUTE US 20A
 H.C. AUBLE WEATHER WARM COUNTY LUCAS
 R.C. NIESE TEMP. 70° TOWNSHIP MONCLOVA
 WHITAKER SECTION 11
 DWG BY RHOADES PID PAVETRAIN T 7 N R 9 E

TYPE MONUMENT MAG/WASHER
 ON SURFACE - ~~BELOW~~ ON
 OFFSET \odot PAVEMENT 1.5' LT : ~~RT~~
- TO - EDGE PAVEMENT
 STATION: 266+71.23

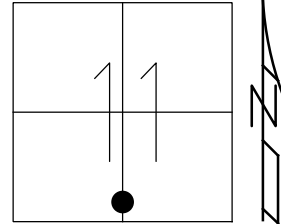

HORZ. DATUM: NAD83 2011 GEOID: NAVD88 2018
 GRID: NORTHING: 698039.157 EASTING: 1613906.795

RECORD:
 FD R.R.SPIKE
 3" DOWN
 6/28/85, I.S.
 FD R.R.SPIKE
 2" DOWN
 REF18
 8/5/13, DCH
 SET MAG NAIL
 NEWREF18
 4/11/14, DCH
 FD MAG/WASHER
 REF19
 8/10/22, DSA
 11/21/22, TDN

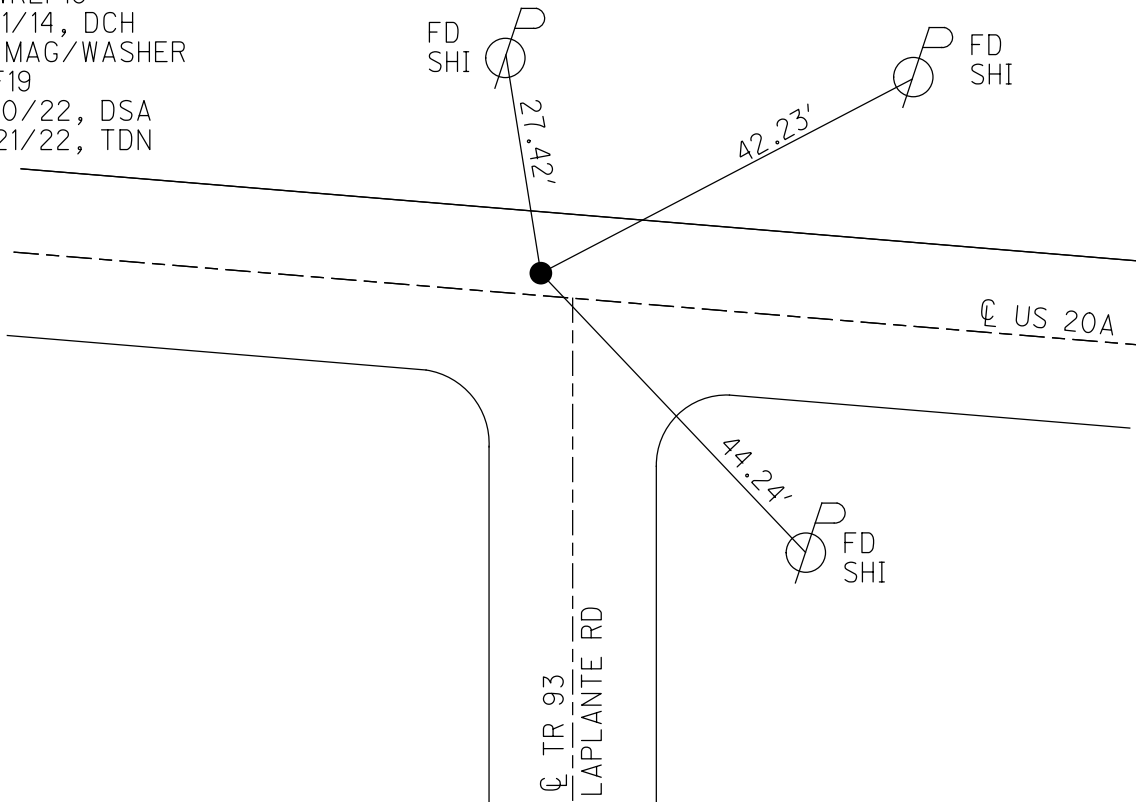

O.D.O.T. DISTRICT 2 SURVEY OFFICE (USE ONLY)

PERSONNEL _____ REFERENCE NO. 19 SHEET 21 OF 48

NOTES WESTFALL DATE 8/5/13 ROUTE US 20A
 H.C. ROUSOS WEATHER SUNNY COUNTY LUCAS
 R.C. WESTFALL TEMP. 67° TOWNSHIP MONCLOVA
 _____ KEFFER _____ SECTION 11
 _____ T 7 N R 9 E

TYPE MONUMENT RR SPIKE

~~ON SURFACE~~ - BELOW 2"

LEFT - ☉ PAV'T - RIGHT - _____

_____ TO _____ EDGE PAVEMENT

S.L.M. 266+71.23

GRID: NORTHING: 698039.150 EASTING: 1613906.672

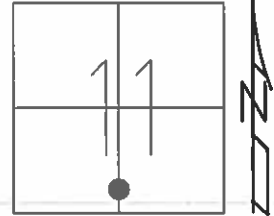

RECORD:
 FD RR SPIKE
 3" DEEP
 6/28/85, I.S.
 FD RR SPIKE
 2" DOWN
 GPS, REF18
 8/5/13, DCH
 SET MAG NAIL
 GPS, NEWREF18
 4/11/14, DCH

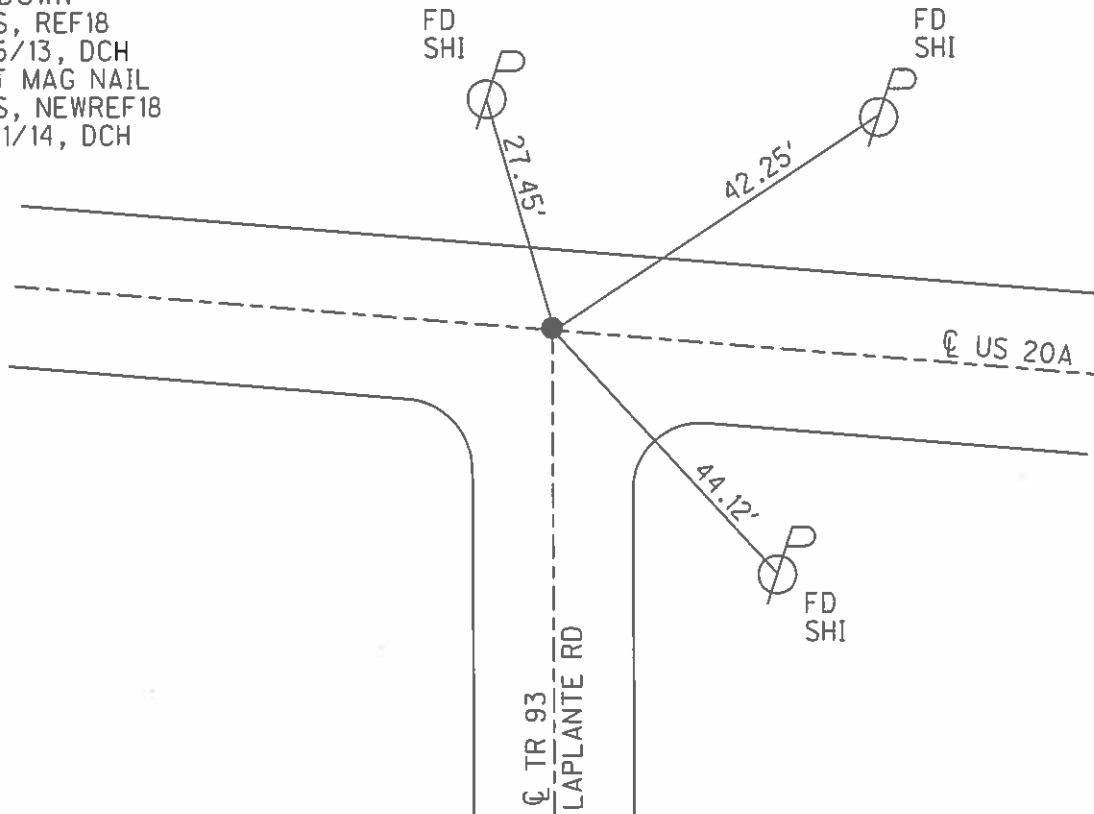

O.D.O.T. DISTRICT 2 SURVEY OFFICE (USE ONLY)

PERSONNEL _____ REFERENCE NO. 19 SHEET 15 OF 42
 NOTES WESTFALL DATE 8/5/13 ROUTE US 20A
 H.C. ROUSOS WEATHER SUNNY COUNTY LUCAS
 R.C. WESTFALL TEMP. 67° TOWNSHIP MONCLOVA
 _____ SECTION 11
 _____ T 7 N R 9 E

TYPE MONUMENT R.R.SPIKE
~~ON SURFACE~~ - BELOW 2"
 LEFT - ☉ PAV'T - RIGHT - _____
 - _____ TO _____ EDGE PAVEMENT
 S.L.M. 266+71.23

Grid: Northing: 698039.150 Easting: 1613906.672

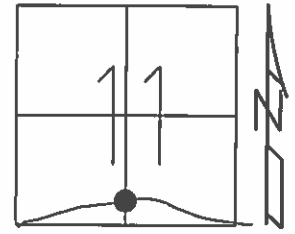

RECORD:
 FD R.R.SPIKE
 3" DEEP
 6/28/85, I.S.

FD R.R.SPIKE
 2" DOWN
 GPS, REF18
 8/5/13, DCH

SET MAG NAIL
 GPS, NEWREF18
 4/11/14, DCH

