

O.D.O.T. DISTRICT 2 SURVEY OFFICE (USE ONLY)

PERSONNEL _____ REFERENCE NO. 21 AC SHEET 26 OF 52
 NOTES RHOADES DATE 8/10/22 ROUTE US 20A
 H.C. AUBLE WEATHER SUNNY COUNTY LUCAS
 R.C. NIESE TEMP. 70° TOWNSHIP MONCLOVA
 WHITAKER SECTION 13
 DWG BY RHOADES PID PAVETRAIN T 7 N R 9 E

TYPE MONUMENT MAG/WASHER
 ON SURFACE - ~~BELOW~~ ON
 OFFSET 0.3' LT : ~~RT~~
 - TO - EDGE PAVEMENT
 STATION: 311+44

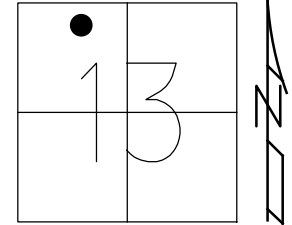

HORZ.DATUM: NAD83 2011 GEOID: NAVD88 2018
 GRID: NORTHING: 697488.674 EASTING: 1618344.672

RECORD:
 FD MAG NAIL
 REFA22
 8/5/13, DCH
 SET MAG/WASHER
 NEWREFA22
 4/11/14, DCH
 FD MAG/WASHER
 REFAC21
 8/10/22, DSA
 FDMAG SHANK
 11/21/22, TDN

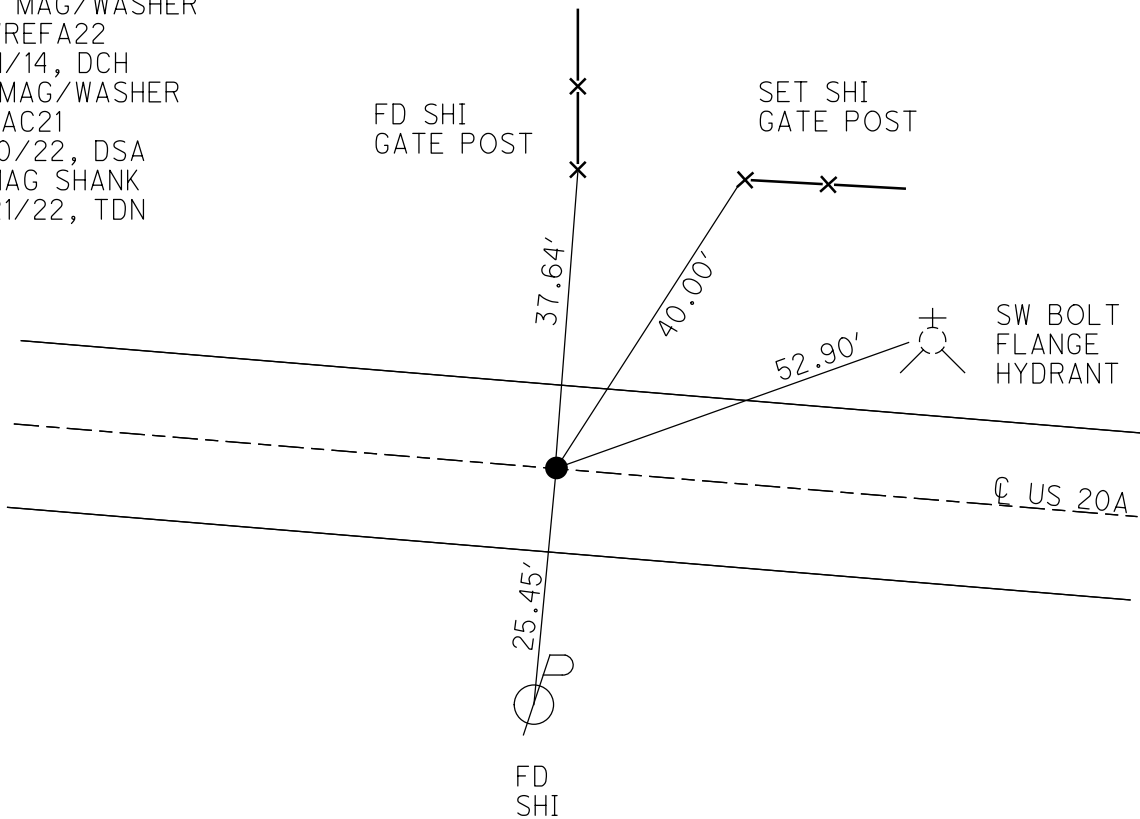

O.D.O.T. DISTRICT 2 SURVEY OFFICE (USE ONLY)

PERSONNEL _____ REFERENCE NO. 21 AC SHEET 26 OF 48

NOTES WESTFALL DATE 8/5/13 ROUTE US 20A
 H.C. ROUSOS WEATHER SUNNY COUNTY LUCAS
 R.C. WESTFALL TEMP. 67° TOWNSHIP MONCLOVA
 _____ KEFFER _____ SECTION 13
 T 7 N R 9 E

TYPE MONUMENT MAG NAIL
 ON SURFACE - ~~BELOW~~ ON _____
 LEFT - ☉ PAV'T - RIGHT _____
 - TO - EDGE PAVEMENT _____
 S.L.M. 311+44

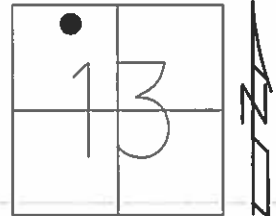

GRID: NORTHING: 697488.727 EASTING: 1618344.59

RECORD:
 FD MAG NAIL
 GPS, REFA22
 SET MAG/WASHER
 GPS, NEWREFA22
 4/11/14, DCH

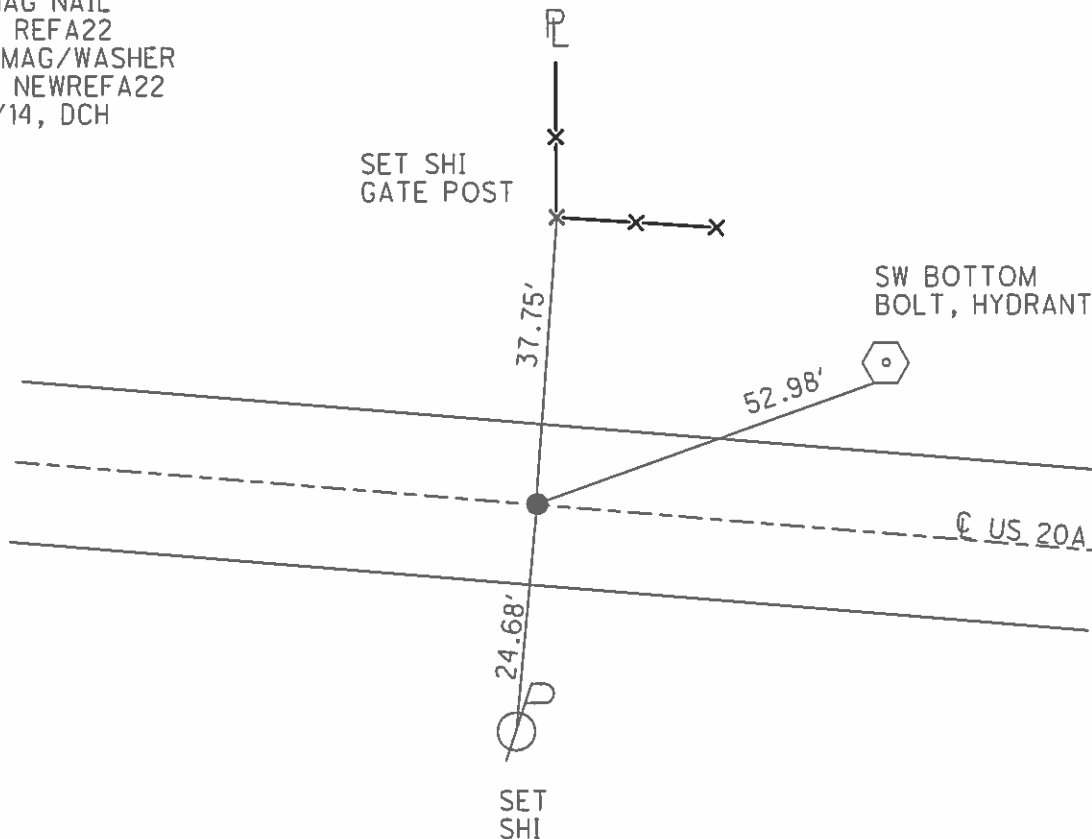

O.D.O.T. DISTRICT 2 SURVEY OFFICE (USE ONLY)

PERSONNEL _____ REFERENCE NO. 21 AC SHEET 20 OF 42
 NOTES WESTFALL DATE 8/5/13 ROUTE US 20A
 H.C. ROUSOS WEATHER SUNNY COUNTY LUCAS
 R.C. WESTFALL TEMP. 67° TOWNSHIP MONCLOVA
 _____ SECTION 13
 _____ T 7 N R 9 E

TYPE MONUMENT MAG NAIL
 ON SURFACE - ~~BELOW~~ ON _____
 LEFT - ☉ PAV'T - RIGHT - _____
 - TO - EDGE PAVEMENT
 S.L.M. 311+44

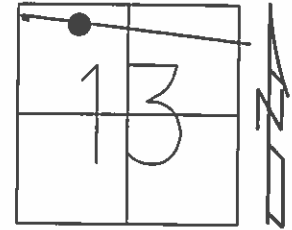

Grid: Northing: 697488.727 Easting: 1618344.59

FD MAG NAIL
 GPS, REFA22
 SET MAG/WASHER
 GPS, NEWREFA22
 4/11/14, DCH

