

O.D.O.T. DISTRICT 2 SURVEY OFFICE (USE ONLY)

PERSONNEL _____ REFERENCE NO. 32 BC SHEET 41 OF 48
 NOTES WESTFALL DATE 8/6/13 ROUTE US 20A
 H.C. ROUSOS WEATHER FAIR COUNTY LUCAS
 R.C. WESTFALL TEMP. 71° TOWNSHIP MONCLOVA
 _____ KEFFER _____ SECTION 33
 _____ T 2

TYPE MONUMENT P.K.SHANK
~~ON SURFACE~~ - BELOW 1"
 LEFT - ☉ PAV'T - RIGHT - _____
 - _____ TO - _____ EDGE PAVEMENT
 S.L.M. 506+73.53

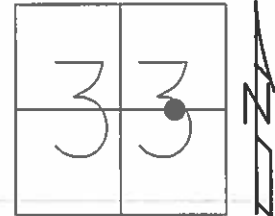

GRID: NORTHING: 697046.934 EASTING: 1637866.763

RECORD:
 SET P.K.NAIL
 7/1/85, IS
 FD P.K.SHANK
 1" BELOW
 GPS, REF36
 8/6/13, DCH
 SET MAG/WASHER
 GPS, NEWREF36
 4/16/14, DCH

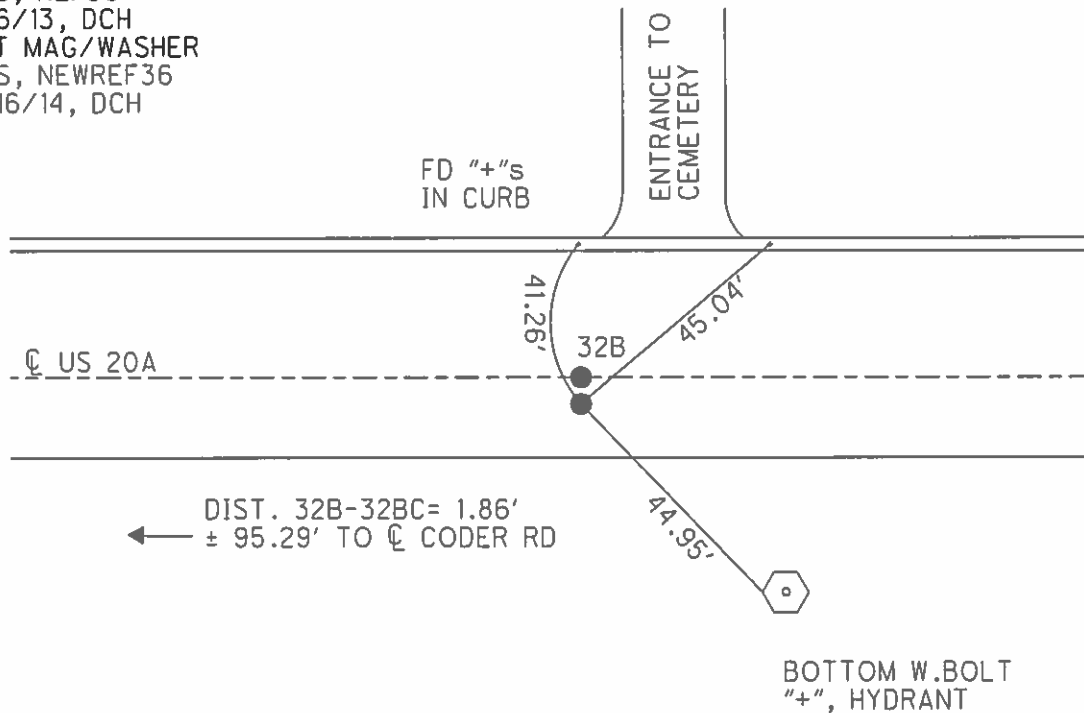

O.D.O.T. DISTRICT 2 SURVEY OFFICE (USE ONLY)

PERSONNEL _____ REFERENCE NO. 32 BC SHEET 35 OF 42
 NOTES WESTFALL DATE 8/6/13 ROUTE US 20A
 H.C. ROUSOS WEATHER FAIR COUNTY LUCAS
 R.C. WESTFALL TEMP. 71° TOWNSHIP MONCLOVA
 _____ SECTION 33
 _____ T 2

TYPE MONUMENT P.K.SHANK
~~ON SURFACE~~ - BELOW 1"
 LEFT - ☉ PAV'T - RIGHT - _____
 _____ TO _____ EDGE PAVEMENT
 S.L.M. 506+73.53

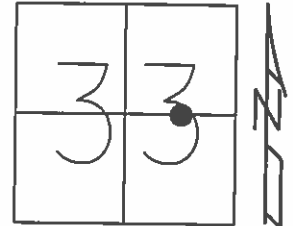

Grid: Northing: 697046.934 Easting: 1637866.763

RECORD:
 SET P.K.NAIL
 7/1/85, I.S.

FD P.K.SHANK
 1" BELOW
 GPS, REF36
 8/6/13, DCH

SET MAG/WASHER
 GPS, NEWREF36
 4/16/14, DCH

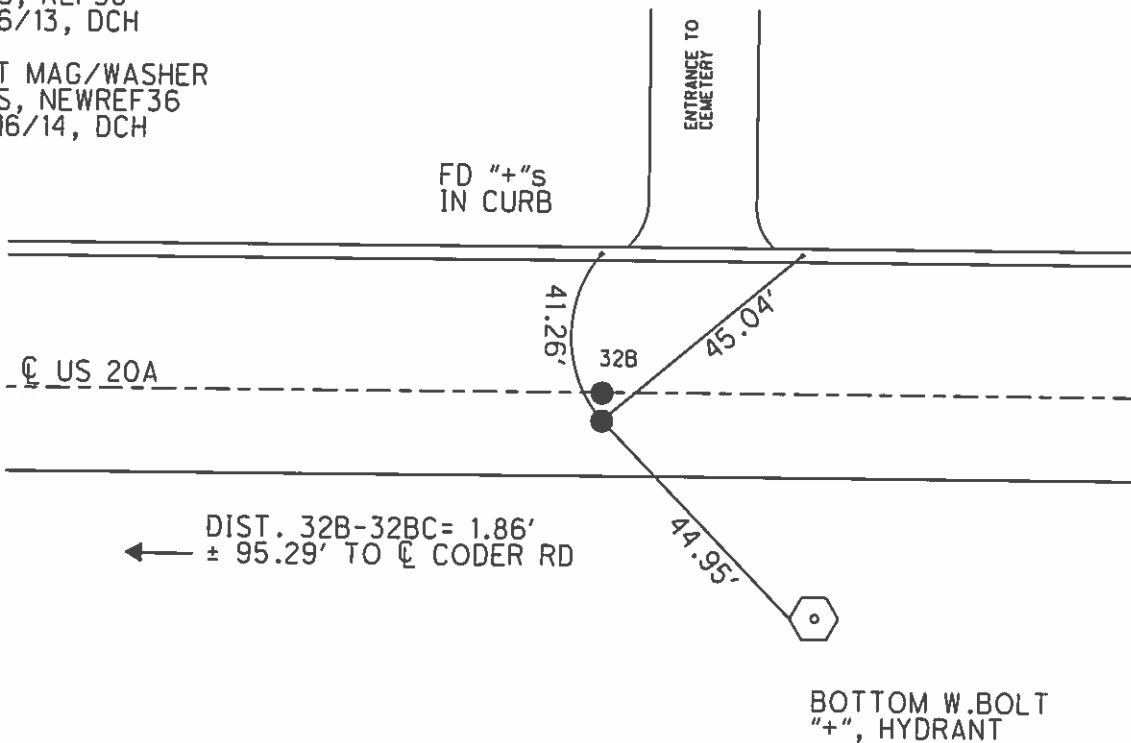

| PERSONNEL | TITLE | PERSONNEL | TITLE | COUNTY | DATE | S. R. | WEATHER | TEMP. |
|-----------|-------|-----------|-------|--------|------------|------------------|---------|-------|
| Stone | Notes | | | Lucas | 20 July 71 | US-20-A | Fair | 75° |
| Michalek | π | | | | | | | |
| Schroeder | H.C. | | | | | | | |
| Farr | RR | | | | | Alton Rd. - East | | |

DESCRIPTION: Alignment LEFT CENTER LINE RIGHT JOB NO.

