

O.D.O.T. DISTRICT 2 SURVEY OFFICE (USE ONLY)

PERSONNEL _____ REFERENCE NO. 36 SHEET 47 OF 48
NOTES WESTFALL DATE 8/7/13 ROUTE US 20A
H.C. ROUSOS WEATHER FAIR COUNTY LUCAS
R.C. WESTFALL TEMP. 73° TOWNSHIP MONCLOVA
KEFFER SECTION 35
T 2

TYPE MONUMENT MON BOX
ON SURFACE - ~~BELOW~~ ON
LEFT - ☉ PAV'T - RIGHT ON
24.5' TO RT GUTTER
S.L.M. 587+60.86

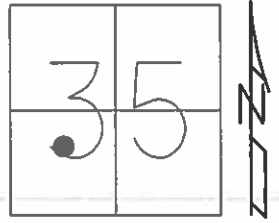

GRID: NORTHING: 695637.862 EASTING: 1645820.192

RECORD:
FD MON BOX
8/24/94, CL
FD MON BOX
1" IPIN
GPS, REF43
8/7/13, DCH

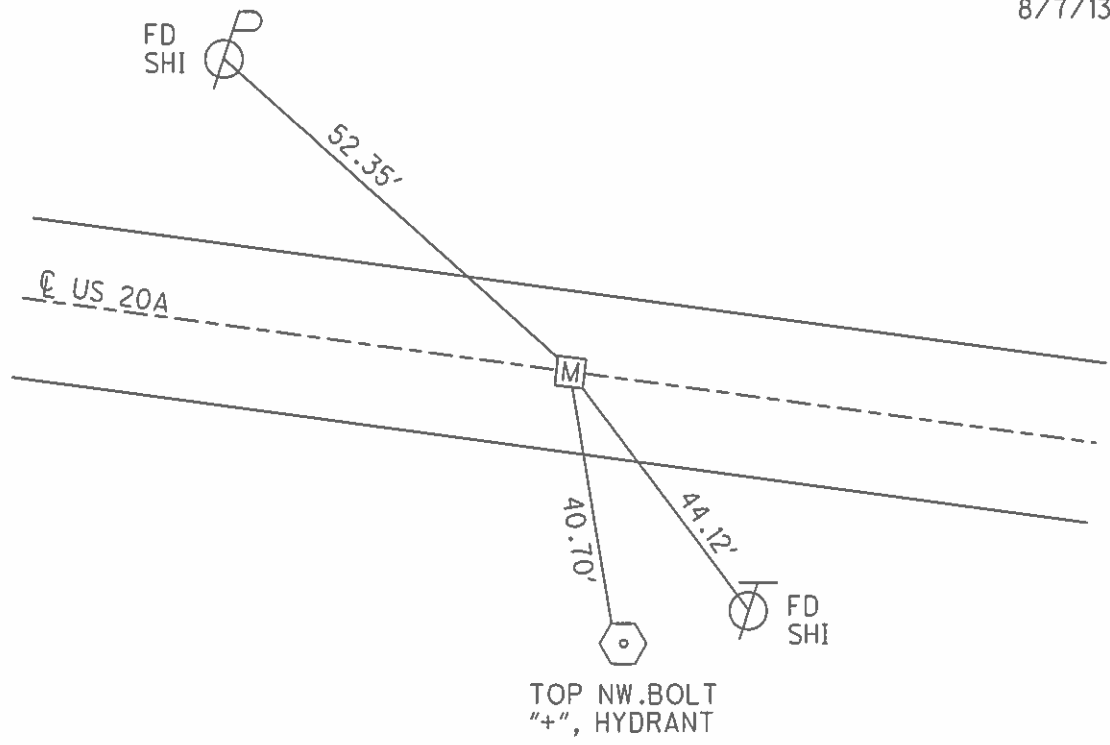

O.D.O.T. DISTRICT 2 SURVEY OFFICE (USE ONLY)

PERSONNEL _____ REFERENCE NO. 36 SHEET 41 OF 42
NOTES WESTFALL DATE 8/7/13 ROUTE US 20A
H.C. ROUSOS WEATHER FAIR COUNTY LUCAS
R.C. WESTFALL TEMP. 73° TOWNSHIP MONCLOVA
SECTION 35
T 2

TYPE MONUMENT MON.BOX
ON SURFACE - ~~BELOW~~ ON
LEFT - ☉ PAV'T - RIGHT ON
24.5' TO RT GUTTER
S.L.M. 587+60.86
Grid: Northing: 695637.862 Easting: 1645820.192

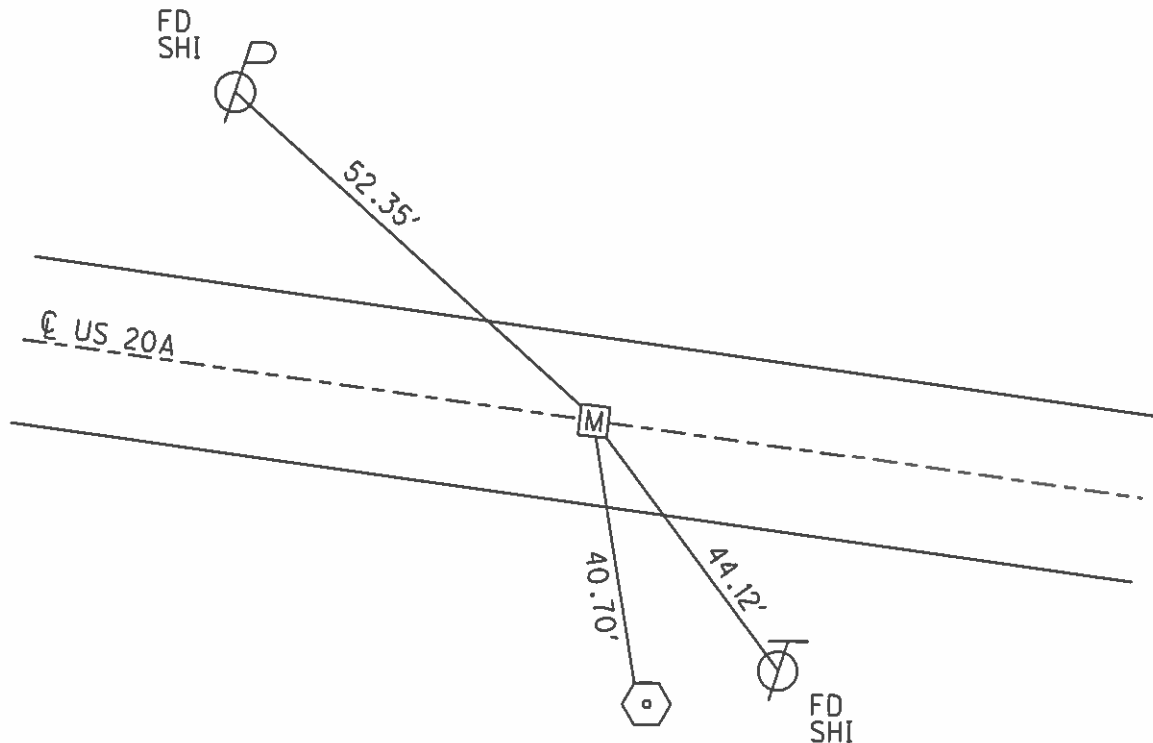
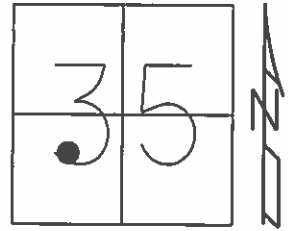

RECORD:
FD MON.BOX
8/24/94, CL

FD MON.BOX
1" IPIN
GPS, REF43
8/7/13, DCH