

O.D.O.T. DISTRICT 2 SURVEY OFFICE (USE ONLY)

PERSONNEL

REFERENCE NO. 38

SHEET 50 OF 51

NOTES LOEHRKE
 H.C. CANTERBURY
 R.C. HERMILLER

DATE 8/24/94
 WEATHER NICE
 TEMP. 70°

ROUTE US 20A
 COUNTY LUCAS
 TOWNSHIP 12 MILE RESERVE
 SECTION 35
 T 2

DWG BY NIESE PID _____

TYPE MONUMENT P.K. NAIL

ON SURFACE - ~~BELOW~~ ON _____

OFFSET \odot PAVEMENT 5.0' LT : ~~RT~~

- TO - EDGE PAVEMENT

STATION: 621+79

HORZ. DATUM: _____ GEOID: _____

GRID: NORTHING: _____ EASTING: _____

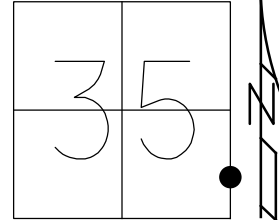

RECORD: P.C.
 STA. 467+25.10
 FD P.K. NAIL
 8/24/94, CL
 SET P.K. NAIL
 10/28/94, CL

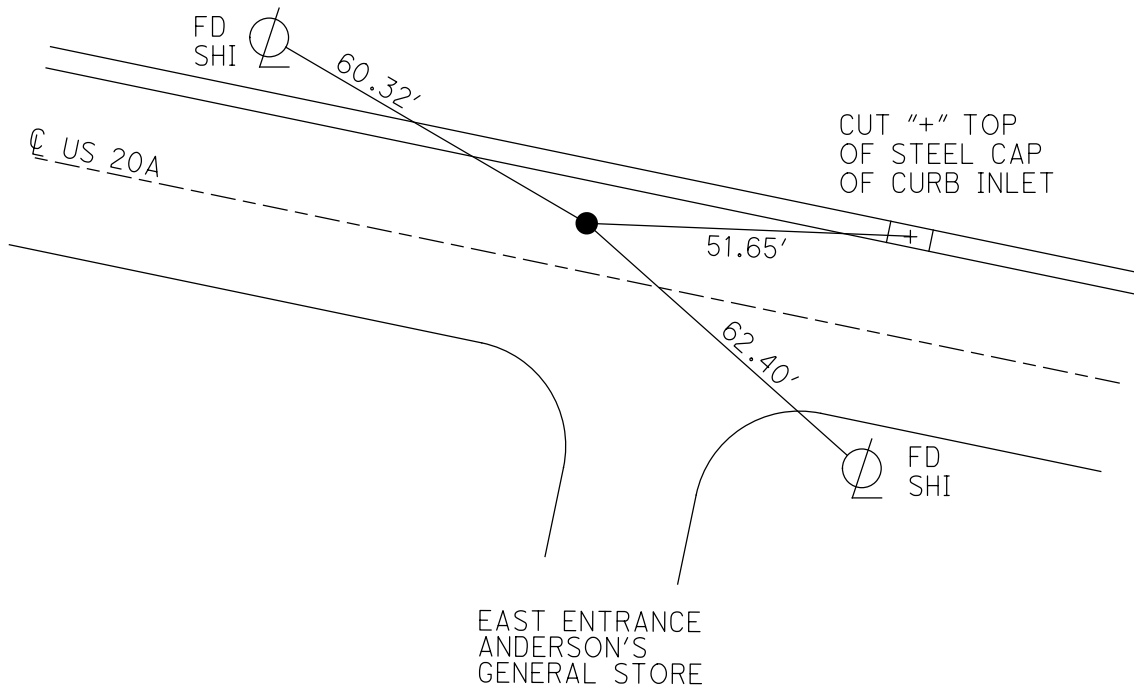

O.D.O.T. DISTRICT 2 SURVEY OFFICE

PERSONNEL _____

REFERENCE NO. 38

SHEET 6 OF 7

NOTES LOEHRKE

H.C. CANTERBURY

R.C. Hermiller

DATE 8-24-94

WEATHER Nice

TEMP. +70

ROUTE U.S. 20-A

COUNTY Lucas

TOWNSHIP _____

SECTION _____

T _____ R _____

TYPE MONUMENT P.K. NAIL ^{Reset} 10-28-94

ON SURFACE - BELOW Yes

LEFT - PAV'T. - RIGHT S.O.

TO EDGE PAVEMENT

S.L.M. 621+79

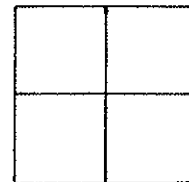

Records:

old sta = $467 + 25.10 = P/L$

