

O.D.O.T. DISTRICT 2 SURVEY OFFICE (USE ONLY)

PERSONNEL

REFERENCE NO. 39

SHEET 51 OF 51

NOTES LOEHRKE

DATE 8/24/94

ROUTE US 20A

H.C. CANTERBURY

WEATHER NICE

COUNTY LUCAS

R.C. HERMILLER

TEMP. 70°

TOWNSHIP 12 MILE RESERVE

SECTION 36

DWG BY NIESE PID _____

T 2

TYPE MONUMENT MONBOX

ON SURFACE - ~~BELOW~~ ON

OFFSET Q PAVEMENT ON LT : RT

25.0' TO LT ~~EDGE PAVEMENT~~ GUTTER

STATION: 635+76

HORIZ.DATUM: _____ GEOID: _____

GRID: NORTHING: _____ EASTING: _____

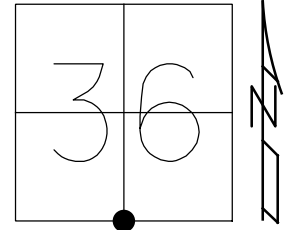

RECORD:
 STA. 481+01.12
 FD MONBOX
 8/24/94, CL

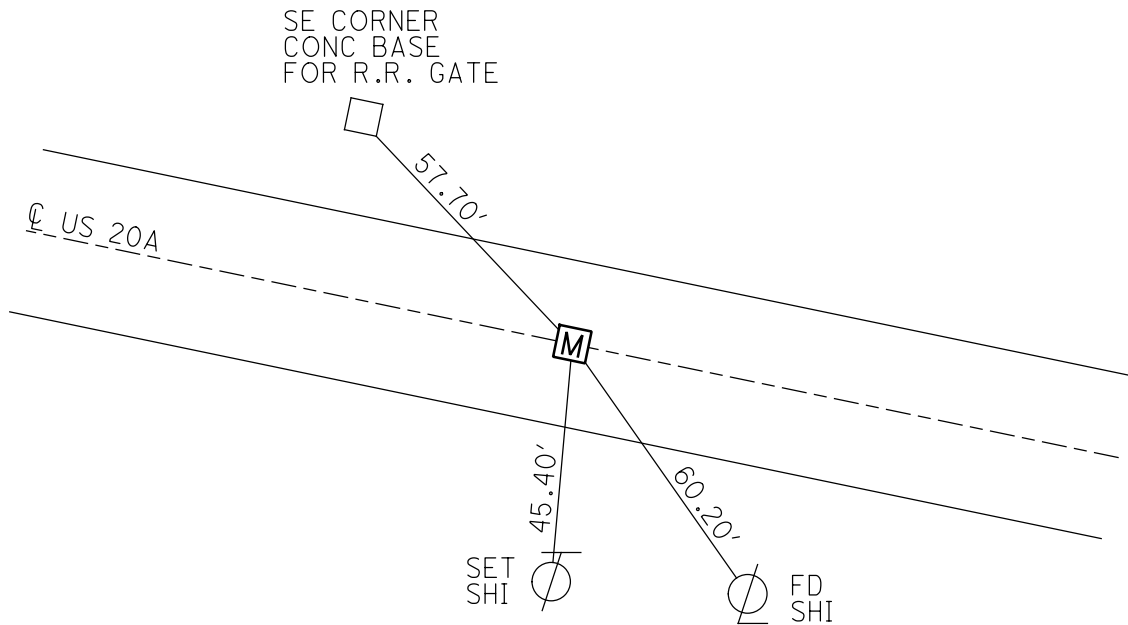

O.D.O.T. DISTRICT 2 SURVEY OFFICE

PERSONNEL _____

REFERENCE NO. 39

SHEET 7 OF 7

NOTES LOHRKE

H.C. CANTERBURY

DATE 8-24-94

ROUTE U.S. 20-A

R.C. HERMILLER

WEATHER Nice

COUNTY LUCAS

TEMP. +70

TOWNSHIP _____

SECTION _____

T. _____ R. _____

TYPE MONUMENT Mon Box

ON SURFACE - BELOW Yes

LEFT - Q PAV'T. - RIGHT Yes

25.0 TO Gutter EDGE PAVEMENT

S.L.M. 635776

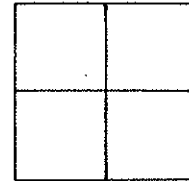

Records:

old sta = 481 + 01.12

