

O.D.O.T. DISTRICT 2 SURVEY OFFICE

PERSONNEL _____

REFERENCE NO. 28 C

SHEET 45 OF 45

NOTES STONE

DATE 4/27/82

ROUTE SR 295

H.C. NOUSER

WEATHER COOL

COUNTY LUCAS

R.C. MICHALAK

TEMP. 50°

TOWNSHIP SWANTON

SECTION 9,10,15,16

T 7 N R 9 E

TYPE MONUMENT MON.BOX

ON SURFACE - ~~BELOW~~ ON

LEFT - Q PAV'T - RIGHT ON

TO EDGE PAVEMENT

S.L.M. _____

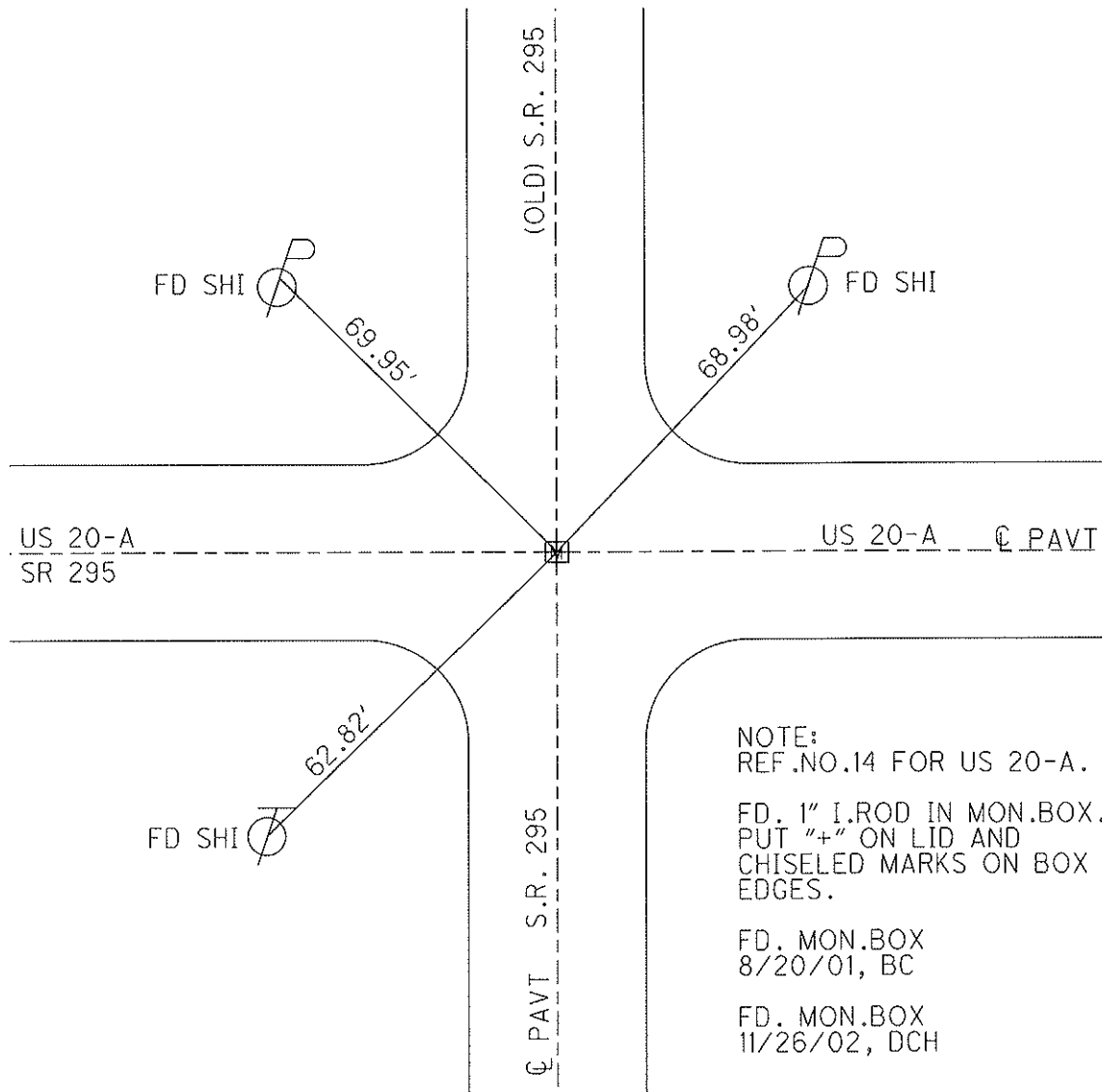
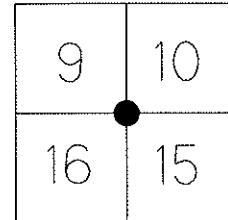

NOTE:
 REF.NO.14 FOR US 20-A.
 FD. 1" I.ROD IN MON.BOX.
 PUT "+" ON LID AND
 CHISELED MARKS ON BOX
 EDGES.
 FD. MON.BOX
 8/20/01, BC
 FD. MON.BOX
 11/26/02, DCH