

O.D.O.T. DISTRICT 2 SURVEY OFFICE (USE ONLY)

PERSONNEL

REFERENCE NO. 4

SHEET 5 OF 12

NOTES DENNO

DATE 2/25/66

ROUTE SR 246

H.C. CURTIS

WEATHER PARTLY CLOUDY

COUNTY LUCAS

R.C. GRANATA

TEMP. 26°

TOWNSHIP CITY OF TOLEDO

OMEY

SECTION 31

DWG BY NIESE PID _____

T 9 S R 7 E

TYPE MONUMENT BRASS MONUMENT

ON SURFACE - ~~BELOW~~ ON

OFFSET 0 PAVEMENT _____ LT : RT

- TO - EDGE PAVEMENT

STATION: 79+20

HORIZ.DATUM: _____

GEOID: _____

GRID: NORTHING: _____

EASTING: _____

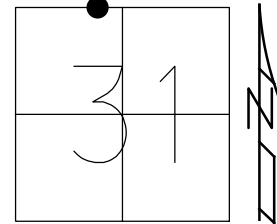

RECORD:
 FD IPIN
 REFERENCE #6
 3/11/53
 FD BRASS PLATE
 MONUMENT
 2/25/66, WD

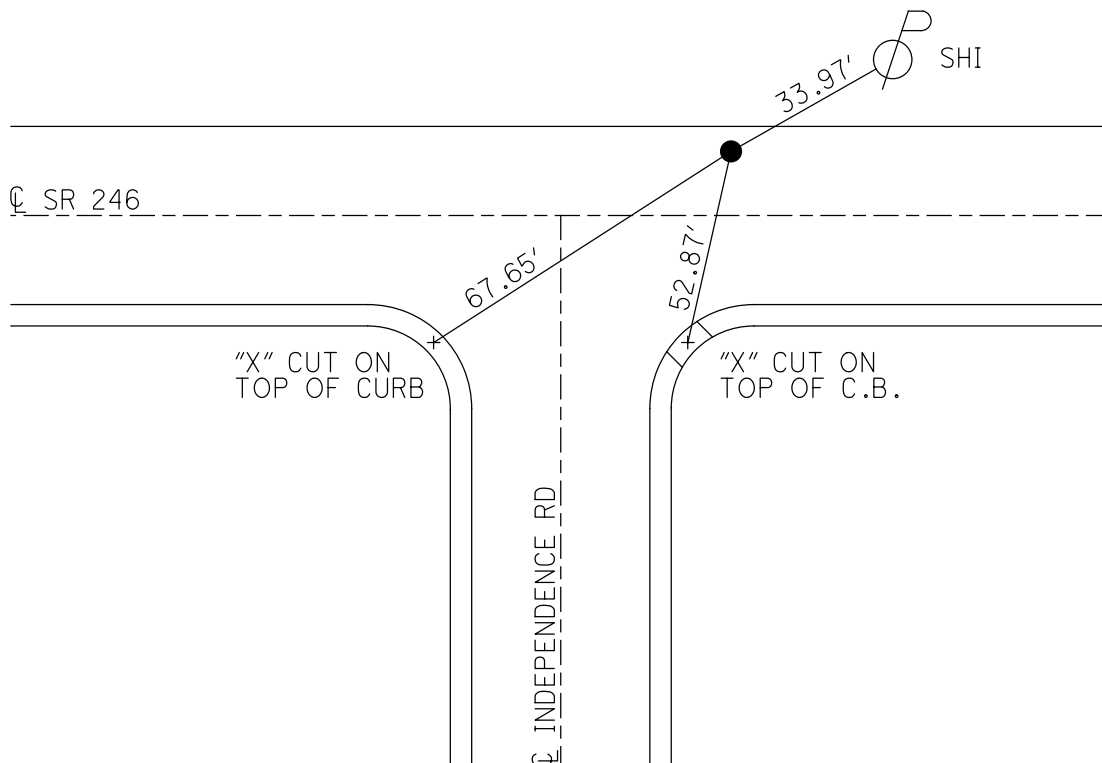

PERSONNEL	TITLE	PERSONNEL	TITLE	COUNTY	DATE	WEATHER	TEMP
W. Denno				Lucas	Feb. 25, 1966	Partly Cloudy	26°
D. Curtis				S. R. 246			
D. Granata							
E. Omev							

DESCRIPTION: S.R. 246 (Dorr St.) - Ref. Mon. & Control Points

