

O.D.O.T. DISTRICT 2 SURVEY OFFICE (USE ONLY)

PERSONNEL _____ REFERENCE NO. A SHEET 1 OF 26
 NOTES LEU DATE 8/8/17 ROUTE SR 295
 H.C. _____ WEATHER _____ COUNTY LUCAS
 R.C. _____ TEMP. _____ TOWNSHIP PROVIDENCE
 DWG BY MILLER PID 83894 SECTION 5
 T 5 N R 9 E

TYPE MONUMENT MONBOX W/ 3/4" IPIN
 ON SURFACE - ~~BELOW~~ ON _____
 OFFSET $\text{\textcircled{C}}$ PAVEMENT 2.1' ~~±~~ : RT
 - TO - EDGE PAVEMENT
 STATION: 5+84.5

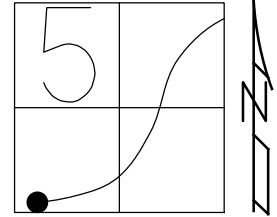

HORZ. DATUM: NAD83(2011) GEOID: 2012A
 GRID: NORTHING: 640178.338 EASTING: 1595420.313

RECORD:
 PRIOR REF6-US24
 FD MONBOX
 5-20-97, BVD

NOTE:
 REF: LUC-24-0.00
 PID: 25490, 83984
 NEW MON BOX SET PER PID
 #83894 WITH STRADDLERS, NO
 IRON PIN WAS FOUND INSIDE.
 ODOT STAFF SET 3/4" IRON PIN
 FROM STRADDERS. SHOT W/GPS,
 BUT DID NOT REFERENCE
 YEAR 2017

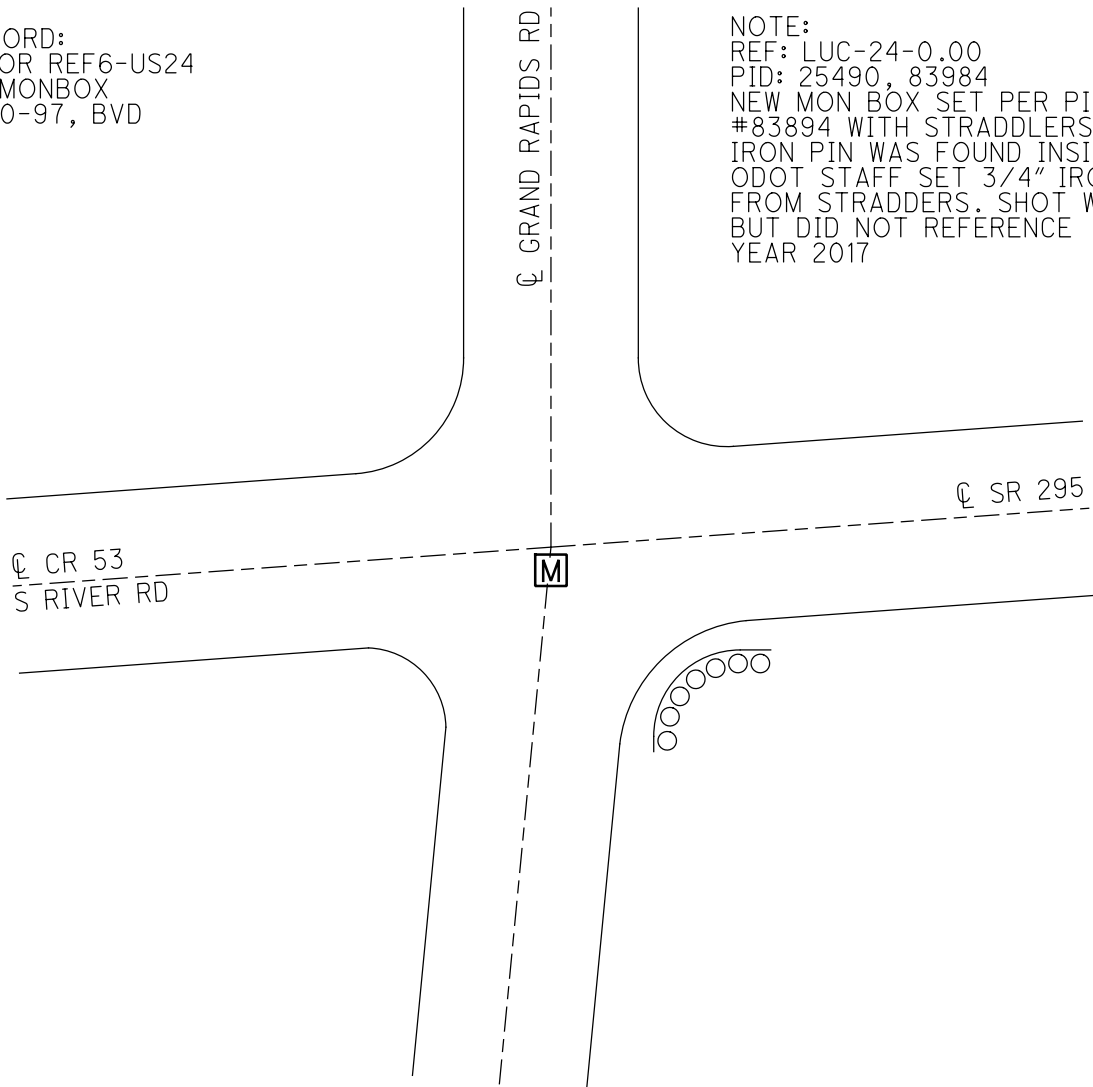

O.D.O.T. DISTRICT 2 SURVEY OFFICE

PERSONNEL _____

REFERENCE NO. 6

SHEET 8 OF 68

NOTES Huss

H.C. VAN DUSEN

DATE 5-20-97

ROUTE US-24

R.C. MOSER

WEATHER PTLY CLOUDY

COUNTY Lucas

TEMP. +61° F

TOWNSHIP Providence

SECTION 5

T 5 N R 9 E

TYPE MONUMENT MON. BOX

ON SURFACE - BELOW YES

LEFT - & PAV'T. - RIGHT 2.1

TO EDGE PAVEMENT

S.L.M. 65+66

