

O.D.O.T. DISTRICT 2 SURVEY OFFICE (USE ONLY)

PERSONNEL

REFERENCE NO. L

SHEET 11 OF 20

NOTES HUSS

DATE 5/28/97

ROUTE SR 295

H.C. VAN DUSEN

WEATHER CLOUDY/WINDY

COUNTY LUCAS

R.C. MOSER

TEMP. 61°

TOWNSHIP PROVIDENCE

SECTION 5

DWG BY MILLER

PID 83894

T 5 N R 9 E

TYPE MONUMENT P.K./WASHER

ON SURFACE - ~~BELOW~~ ON

OFFSET  $\odot$  PAVEMENT 3.9' LT : ~~RT~~

8.0' TO LT EDGE PAVEMENT

STATION: 80+34

HORIZ.DATUM: NAD83(2011)

GEOID: 12A NAVD88

GRID: NORTHING: 645168.762

EASTING: 1600528.892

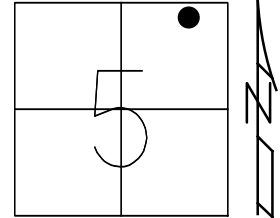

RECORD:  
PRIOR REF15-US24  
SET PK/WASHER  
10-21-97, SAH  
MONBOX  
0.75" IPIN  
REF12  
8-8-17, JLL

NOTE:  
REF: LUC-24-0.00  
PID: 25490, 83984

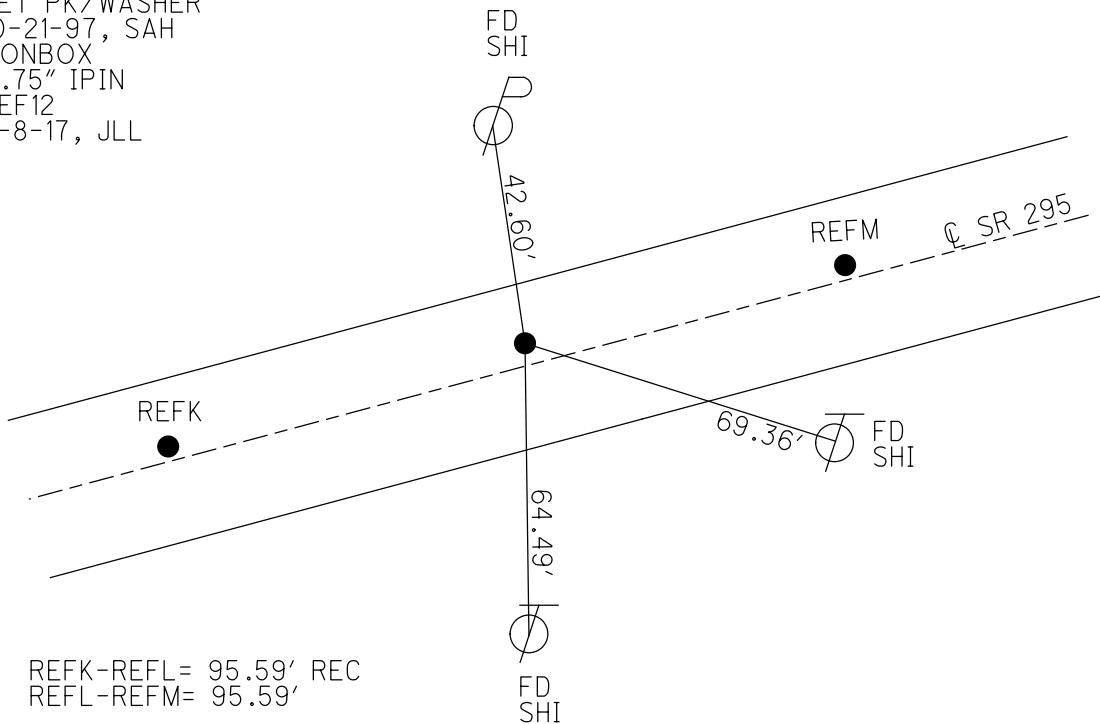

O.D.O.T. DISTRICT 2 SURVEY OFFICE

PERSONNEL \_\_\_\_\_

REFERENCE NO. 15

SHEET 19 OF 68

NOTES S. HUSS

H.C. B. VAN DUSEN

DATE 5-28-97

ROUTE US-24

R.C. K. MOSEL

WEATHER Partly Cloudy / Windy

COUNTY Lucas

\_\_\_\_\_

TEMP. +61°F

TOWNSHIP Providence

\_\_\_\_\_

SECTION 5

T 5 N R 9 E

TYPE MONUMENT PK WASHER

ON SURFACE - BELOW ON SURFACE

LEFT - C PAV'T. - RIGHT 3.9' Lt.

B.O. TO LT. EDGE PAVEMENT

S.L.M. 141 + 27

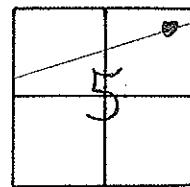

SET PK/WASHER  
10-21-97  
SAH

