

O.D.O.T. DISTRICT 2 SURVEY OFFICE (USE ONLY)

PERSONNEL \_\_\_\_\_ REFERENCE NO. 0 SHEET 15 OF 26  
 NOTES AUBLE DATE 11/6/20 ROUTE SR 295  
 H.C. AUBLE WEATHER SUNNY COUNTY LUCAS  
 R.C. O'DONNELL TEMP. 54° TOWNSHIP PROVIDENCE  
 DWG BY NIESE PID NO PID SECTION 33  
 T 6 N R 9 E

TYPE MONUMENT MONBOX W/ 3/4" IPIN  
 ON SURFACE - ~~BELOW~~ ON  
 OFFSET Q PAVEMENT 1.0' LT : ~~RT~~  
11.1' TO LT EDGE PAVEMENT  
 STATION: 82+30.7

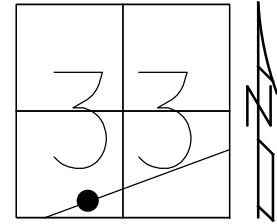

HORZ.DATUM: NAD83(2011) GEOID: NAVD88 2012A  
 GRID: NORTHING: 645237.196 EASTING: 1600707.038

RECORD: P.T.  
 PRIOR REF16-US24  
 FD P.K./WASHER  
 5/28/97, BVD  
 D.N.F  
 SET P.K./WASHER  
 FROM TIES  
 10-21-97, SAH  
 FD MONBOX  
 SET 3/4" IPIN  
 8/8/17, JLL

NOTE: P.T.  
 REF: LUC-24-0.00  
 PID: 25490, 83984  
 NEW MON BOX SET PER PID  
 #83894 WITH STRADDLERS, NO  
 IRON PIN WAS FOUND INSIDE.  
 ODOT STAFF SET 3/4" IRON PIN  
 FROM STRADDLERS. SHOT W/GPS,  
 BUT DID NOT REFERENCE  
 YEAR 2017

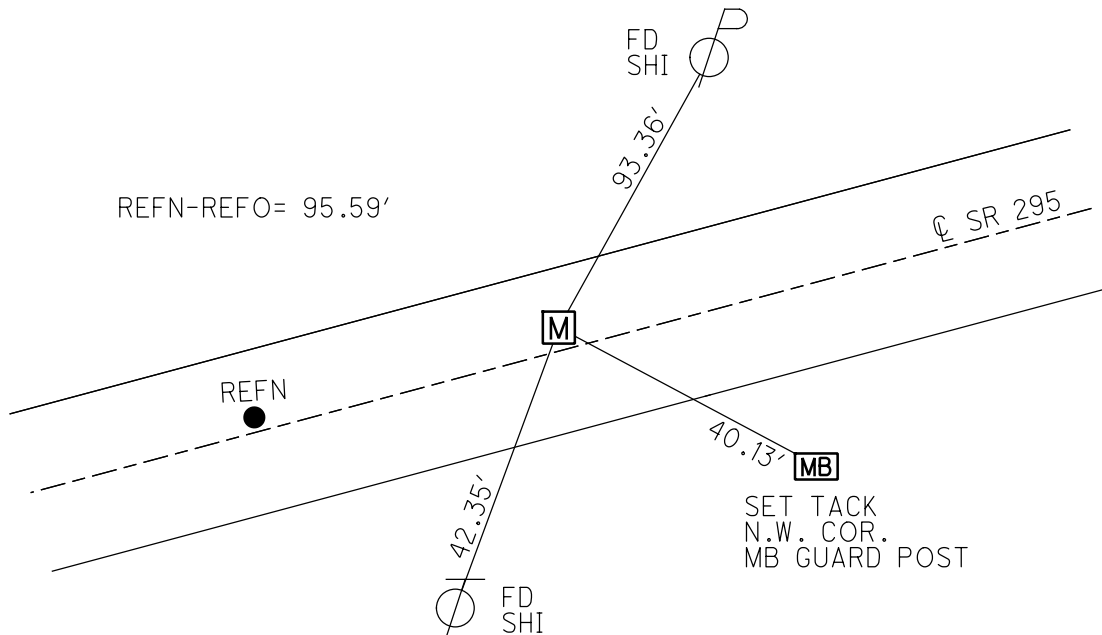

O.D.O.T. DISTRICT 2 SURVEY OFFICE (USE ONLY)

PERSONNEL

REFERENCE NO.   M  

SHEET  12  OF  20 

NOTES   HUSS  

DATE  5/28/97 

ROUTE  SR 295 

H.C.   VAN DUSEN  

WEATHER   CLOUDY/WINDY  

COUNTY   LUCAS  

R.C.   MOSER  

TEMP.   61°  

TOWNSHIP   PROVIDENCE  

DWG BY   MILLER  

PID   83894  

SECTION   5  

T  5  N R  9  E

TYPE MONUMENT   P.K./WASHER  

ON SURFACE - ~~BELOW~~   ON  

OFFSET  $\odot$  PAVEMENT   1.0'   LT : ~~RT~~

  11.1'   TO   LT   EDGE PAVEMENT

STATION:   82+23  

HORZ. DATUM:   NAD83(2011)  

GEOID:   12A NAVD88  

GRID: NORTHING:   645237.249  

EASTING:   1600707.034  

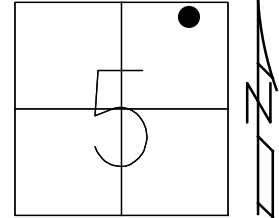

RECORD:  
 PRIOR REF16-US24  
 FD P.K./WASHER  
 5/28/97, BVD  
 D.N.F  
 SET P.K./WASHER  
 10-21-97, SAH  
 FD MONBOX  
 W/ 3/4" IPIN  
 REF13  
 8-8-17, JLL

NOTE:  
 REF: LUC-24-0.00  
 PID: 25490, 83984

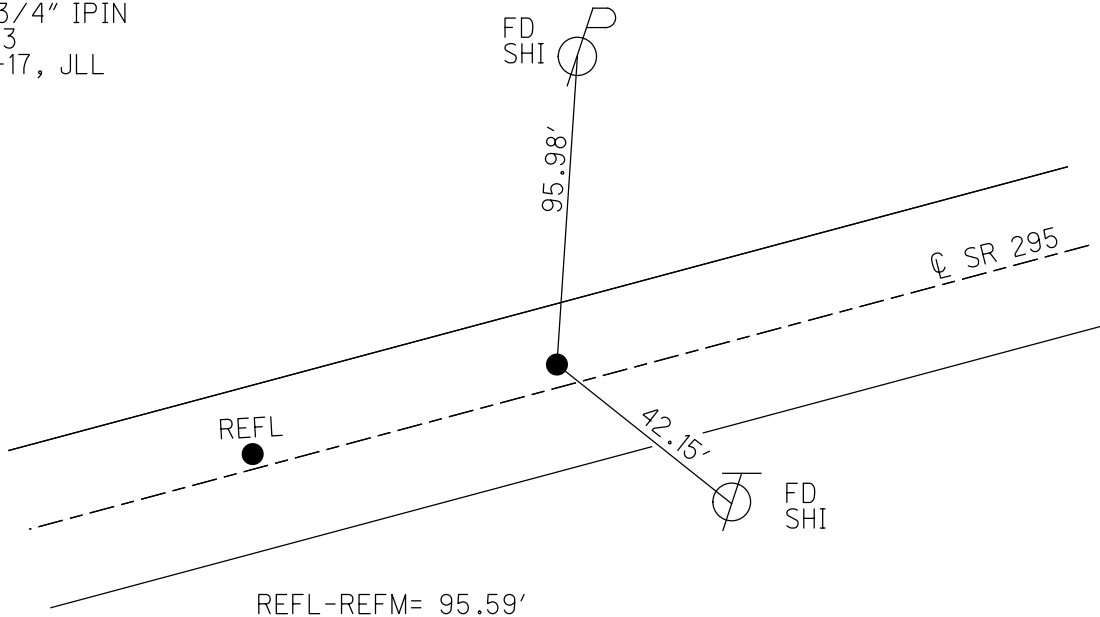

# O.D.O.T. DISTRICT 2 SURVEY OFFICE

PERSONNEL \_\_\_\_\_

REFERENCE NO. 16

SHEET 20 OF 68

NOTES S. HOSS

H.C. B. VAN DUSEN

DATE 5-28-97

ROUTE US-24

R.C. K. MOSER

WEATHER PARTLY CLOUDY - WINDY

COUNTY LUCAS

TEMP. 76.1°F

TOWNSHIP PROVIDENCE

SECTION 5

T S N R 9 E

TYPE MONUMENT PK NAIL/W

ON SURFACE - ~~BELOW~~ ON SURFACE

LEFT - ~~C PAV'T.~~ RIGHT 1.0' LT

11.1 TO LT EDGE PAVEMENT

S.L.M. 142722

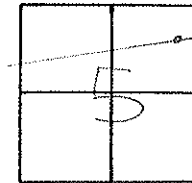

NOTE: UNABLE TO LOCATE ORIGINAL POINT!  
HAD TO RESET WITH OLD TIES.

"DID NOT FWD"  
SET PK/WASHER  
FROM OLD TIES  
10-21-97  
SAH

