

O.D.O.T. DISTRICT 2 SURVEY OFFICE (USE ONLY)

PERSONNEL _____ REFERENCE NO. 0 SHEET 14 OF 20
 NOTES HUSS DATE 5/28/97 ROUTE SR 295
 H.C. VAN DUSEN WEATHER CLOUDY/WINDY COUNTY LUCAS
 R.C. MOSER TEMP. 61° TOWNSHIP PROVIDENCE
 DWG BY MILLER PID 83894 SECTION 33
 T 6 N R 9 E

TYPE MONUMENT P.K./WASHER
 ON SURFACE - ~~BELOW~~ ON _____
 OFFSET \odot PAVEMENT 1.2' ~~±~~ : RT
10.8' TO RT EDGE PAVEMENT
 STATION: 99+32

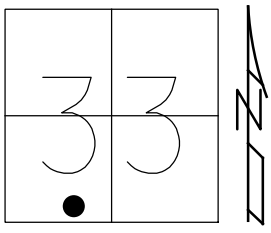

HORZ.DATUM: NAD83(2011) GEOID: 12A NAVD88
 GRID: NORTHING: 645799.632 EASTING: 1602321.296

RECORD:
 PRIOR REF17A-US24
 SET P.K./WASHER
 FD P.K./WASHER
 REFO
 10-21-97, SAH
 FD MONBOX
 W/ 3/4" IPIN
 REF15
 8-8-17, JLL

NOTE:
 REF: LUC-24-0.00
 PID: 25490, 83984

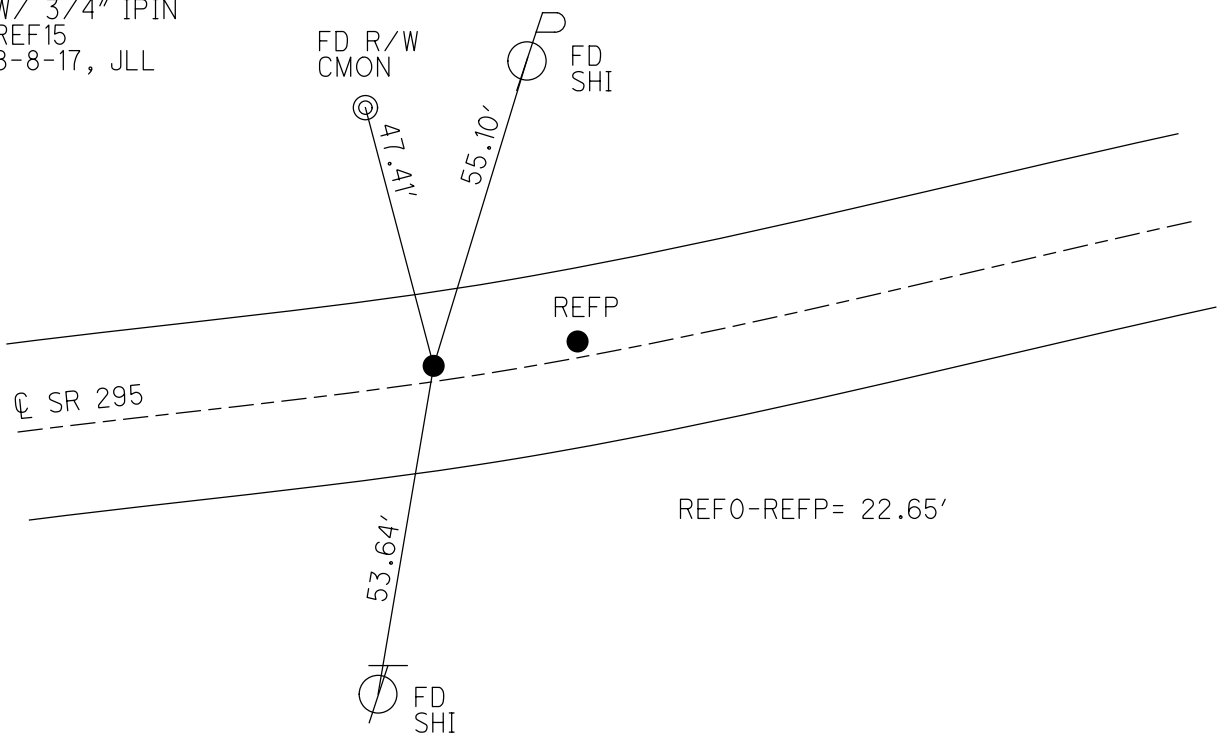

O.D.O.T. DISTRICT 2 SURVEY OFFICE

PERSONNEL

REFERENCE NO. 17-A

SHEET 22 OF 68

NOTES S. HOSS

H.C. B. VANDUSEN

R.C. K. MOSER

DATE 5-28-97

WEATHER PARTLY CLOUDY/WINDY

TEMP. 40°F

ROUTE US-24

COUNTY Lucas

TOWNSHIP Providence

SECTION 33

T. 6 N R. 9 E

TYPE MONUMENT PK & WASHER

ON SURFACE - BELOW YES

~~LEFT - C~~ PAV'T. - RIGHT 1.2' RT

10.9 TO RT EDGE PAVEMENT

S.L.M. 159+06

