

O.D.O.T. DISTRICT 2 SURVEY OFFICE (USE ONLY)

PERSONNEL

REFERENCE NO. Q

SHEET 16 OF 20

NOTES HUSS

DATE 5/28/97

ROUTE SR 295

H.C. VAN DUSEN

WEATHER PARTLY CLOUDY

COUNTY LUCAS

R.C. MOSER

TEMP. 61°

TOWNSHIP PROVIDENCE

SECTION 33

DWG BY MILLER PID 83894

T 6 N R 9 E

TYPE MONUMENT P.K./WASHER

ON SURFACE - ~~BELOW~~ ON

OFFSET CL PAVEMENT 4.6' ~~±~~ : RT

7.2' TO RT EDGE PAVEMENT

STATION: 120+66

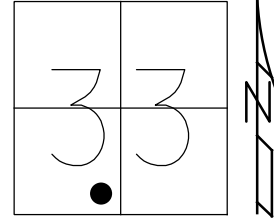

HORZ.DATUM: NAD83(2011)

GEOID: 12A NAVD88

GRID: NORTHING: 646644.288

EASTING: 1604280.877

RECORD: P.I.
 PRIOR REF19-US24
 FD P.K./WASHER
 5/28/97, BVD
 SET P.K./WASHER
 10-21-97, SAH
 FD MONBOX
 W/ 1" IPIN
 REF17
 8-8-17, JLL

NOTE:
 REF: LUC-24-0.00
 PID: 25490, 83984

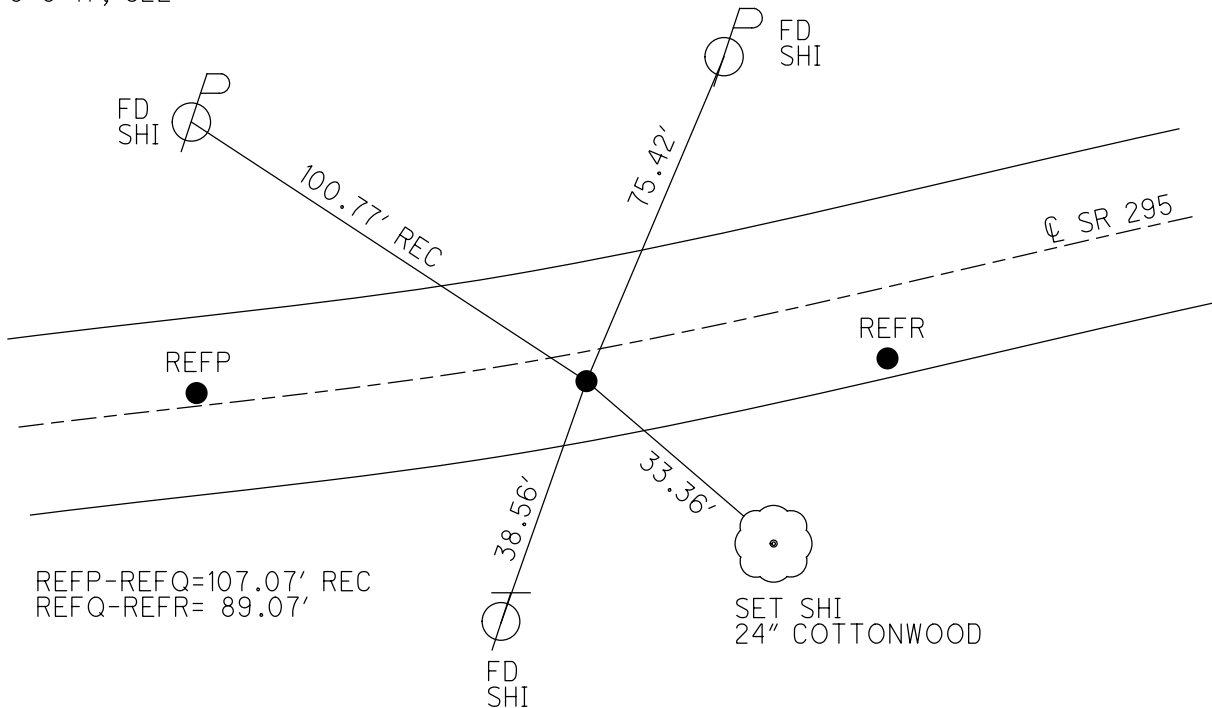

O.D.O.T. DISTRICT 2 SURVEY OFFICE

PERSONNEL

REFERENCE NO. 19

SHEET 24 OF 68

NOTES S. HOSS

H.C. B. VAN DUSEN

DATE 5-28-97

ROUTE US-24

R.C. K. MOSER

WEATHER PARTLY CLOUDY

COUNTY Lucas

TEMP. 161°F

TOWNSHIP Providence

SECTION 33

T. 6 N. R. 9 E.

TYPE MONUMENT PK NAIL & WASHER

ON SURFACE - BELOW YES

LEFT - C PAV'T. - RIGHT 4.6 RT

7.2' TO RT. EDGE PAVEMENT

S.L.M. 160+37

