

O.D.O.T. DISTRICT 2 SURVEY OFFICE(USE ONLY)

PERSONNEL _____ REFERENCE NO. 31 A SHEET 4 OF 24
 NOTES HUSS DATE 6/28/12 ROUTE SR 295
 H.C. CANTERBUYR WEATHER CLEAR/HOT COUNTY LUCAS
 R.C. HUSS TEMP. 94° TOWNSHIP SWANTON
 _____ SECTION 4
 _____ T 7 N R 9 E

TYPE MONUMENT _____ RR SPIKE _____
 ON SURFACE - ~~BELOW~~ _____ ON _____
~~LEFT~~ - Q PAV'T - RIGHT 1.9' _____
8.8' TO RT EDGE PAVEMENT _____
 S.L.M. _____ 665+55.37 _____

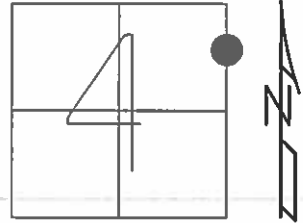

GRID: NORTHING: 707193.134 EASTING: 1606036.666

RECORD:
 SET SM RR SPK
 AT SURFACE
 8/11/86
 FD SM RR SPK
 9/15/10, JMH
 GPS REF A31
 10/13/10, JMH
 SET MAG/WASHER
 10/16/12. SDC
 GPS, NEWREFA31
 11/30/12, SDC

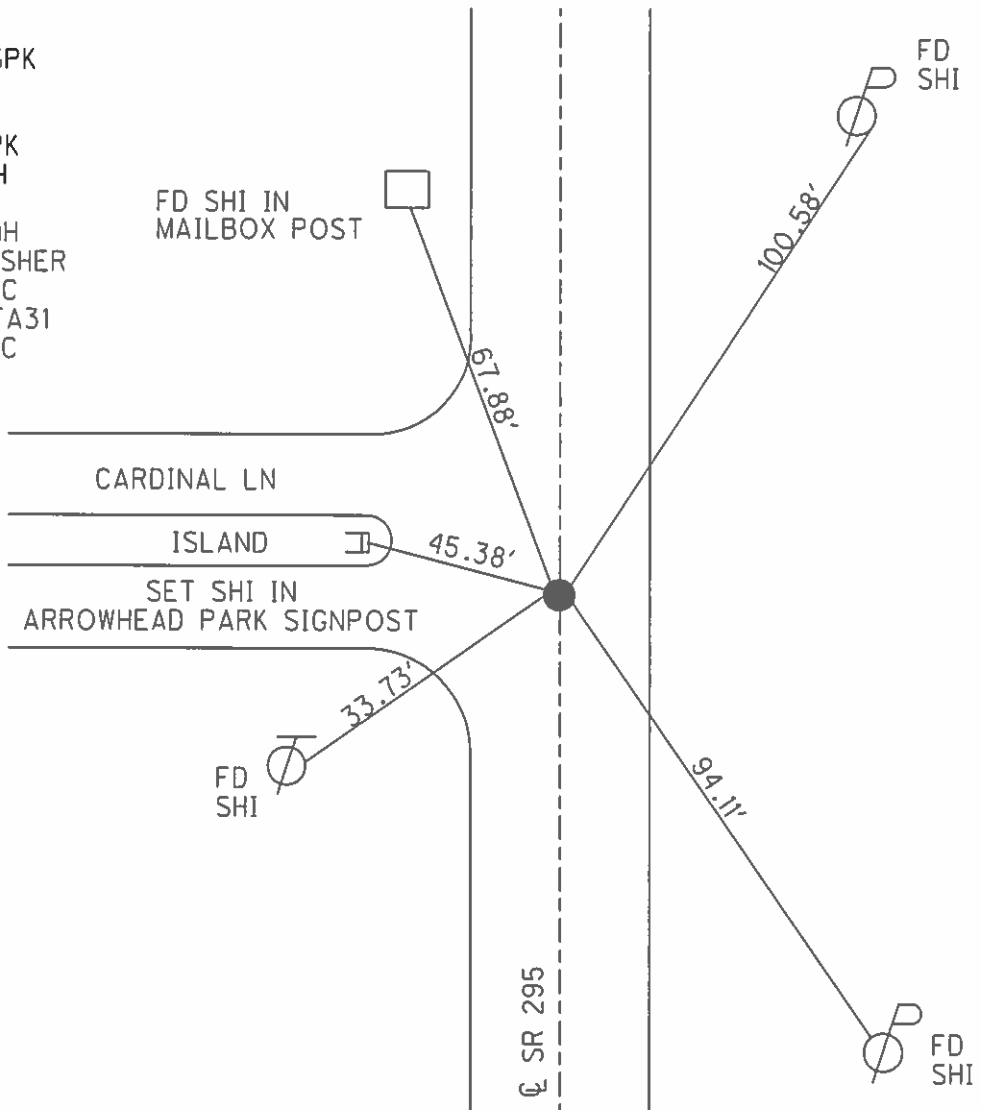

O.D.O.T. DISTRICT 2 SURVEY OFFICE (USE ONLY)

PERSONNEL	REFERENCE NO. <u>31 A</u>	SHEET <u>4</u> OF <u>24</u>
NOTES <u>HUSS</u>	DATE <u>6-28-12</u>	ROUTE <u>SR#295</u>
H.C. <u>CANTERBUYR</u>	WEATHER <u>CLEAR/HOT</u>	COUNTY <u>LUCAS</u>
R.C. <u>HUSS</u>	TEMP. <u>94°F</u>	TOWNSHIP <u>SWANTON</u>
		SECTION <u>4</u>
		T <u>7</u> N R <u>9</u> E

TYPE MONUMENT _____ R.R. SPIKE _____
 ON SURFACE - ~~BELOW~~ _____ ON _____
~~LEFT~~ - \odot PAV'T - RIGHT 1.9' _____
8.8' TO RT EDGE PAVEMENT _____
 S.L.M. 665+55.37 _____
 Grid: Northing: 707193.134 Easting: 1606036.666

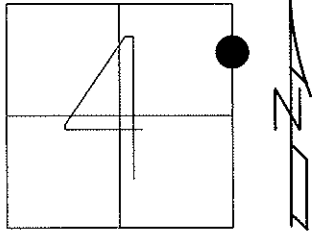

RECORD:
 SET SM RR SPK
 AT SURFACE 8-11-86

FD SM RR SPK 9-15-10 JMH

GPS REF A31,
 10/13/10 JMH

FD SHI IN
 MAILBOX POST

CARDINAL LN
 ISLAND \square
 SET N/SHI IN
 ARROWHEAD PARK SIGNPOST

FD SHI \odot

SET MAG/WASHER
 10/16/12, SDC

GPS, NEWREFA31
 11/30/12, SDC

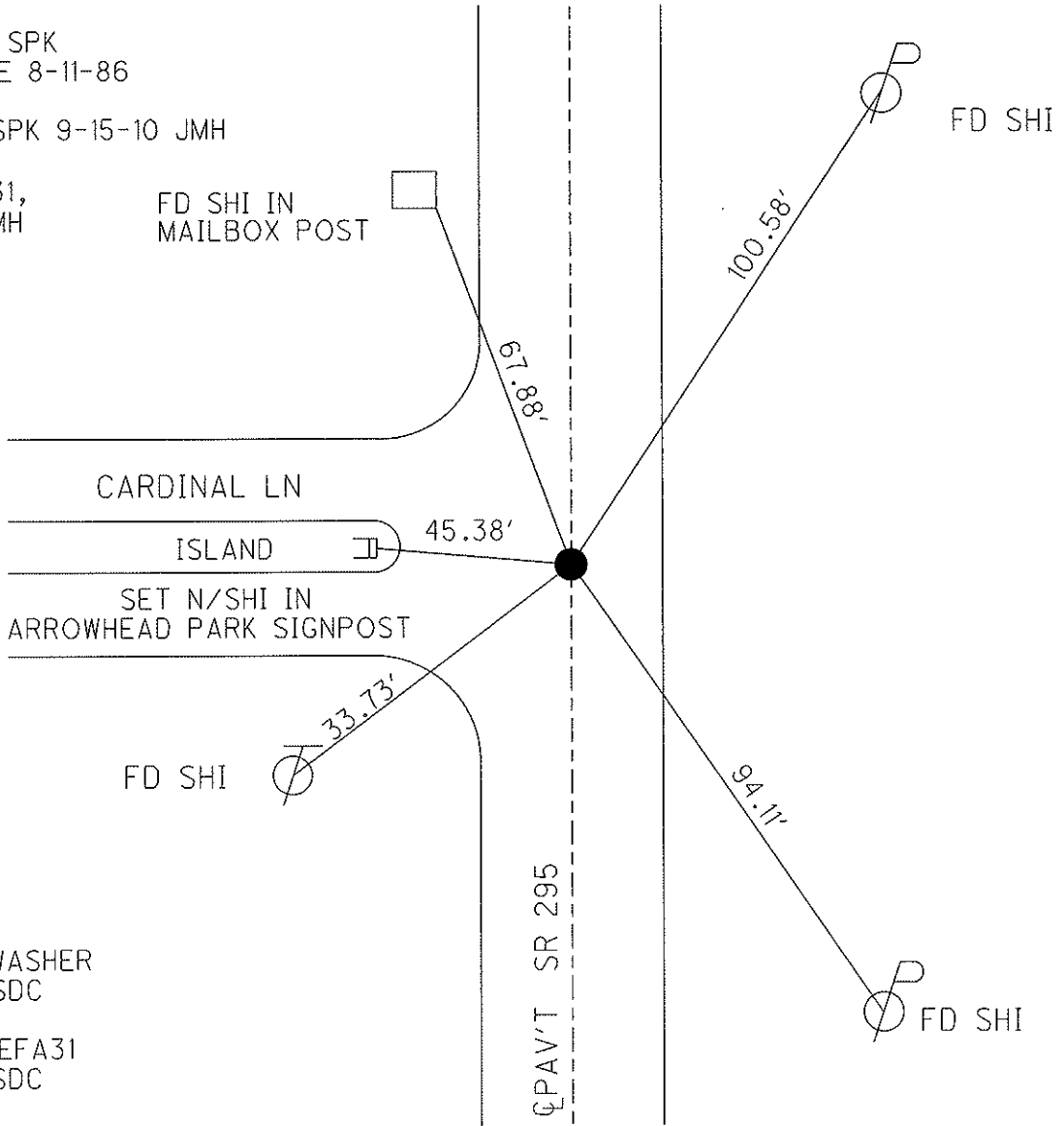

O.D.O.T. DISTRICT 2 SURVEY OFFICE

PERSONNEL

REFERENCE NO. 31-1A

SHEET 4 OF

NOTES 1. Stone

H.C. D. Curtis

R.C. J. Hauschalter

R. Michalak

DATE 6 May 86

WEATHER Cloudy

TEMP. 78°

ROUTE SR #295

COUNTY Lucas

TOWNSHIP Swanton

SECTION 4

T R

TYPE MONUMENT 1. Pin 1/2" 1" I. pipe

ON SURFACE - BELOW 3" deep

LEFT - PAV'T. - RIGHT

 TO EDGE PAVEMENT

S.L.M. 604+31

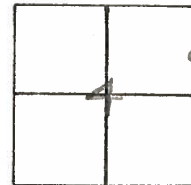

Set Small R.R. Spk. To Surface
8-11-86

