

O.D.O.T. DISTRICT 2 SURVEY OFFICE (USE ONLY)

PERSONNEL

REFERENCE NO. 49 A

SHEET 3 OF 8

NOTES RHOADES

DATE 11/15/23

ROUTE SR 295

H.C. NIESE

WEATHER SUNNY

COUNTY LUCAS

R.C. ASTON

TEMP. 43°

TOWNSHIP RICHFIELD

MILLER

SECTION 9

DWG BY RHOADES PID 105618

T 9 N R 5 E

TYPE MONUMENT MAG/WASHER

ON SURFACE - ~~BELOW~~ ON

OFFSET Q PAVEMENT ON LT : RT

- TO - EDGE PAVEMENT

STATION: 1215+69.64

HORIZ.DATUM: NAD83 (2011)

GEOID: NAVD88 2018

GRID: NORTHING: 746651.282

EASTING: 1602768.474

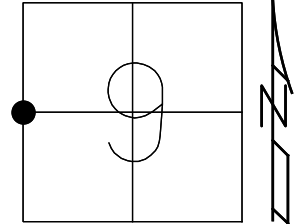

RECORD:
 FD P.K./WASHER
 5/17/05
 SET MAG/WASHER
 7/13/05, DCH
 FD MAG/WASHER
 REFA49
 3-6-19, LEU
 FD MAG/WASHER
 REF49A
 9/1/23,
 SET MAG/WASHER
 11/15/23, TDN

LUCAS LDP:
 N: 367609.944
 E: 112310.964

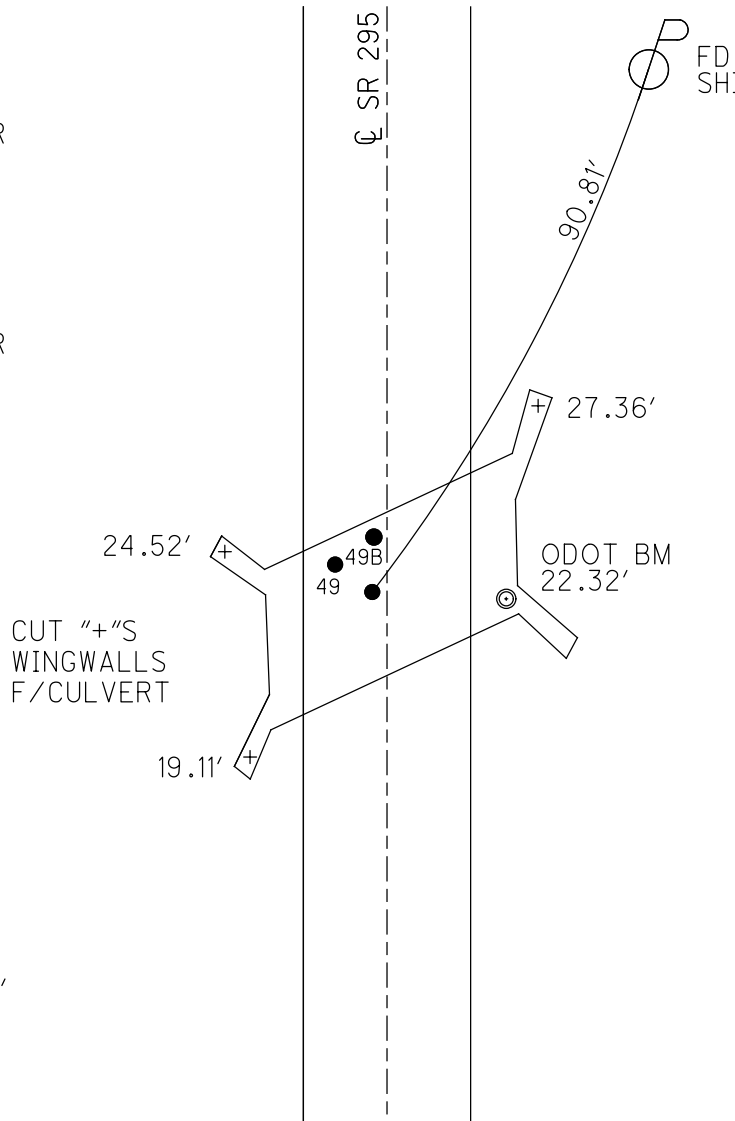

DIST.
 49-49A = 6.67'
 49A-49B = 1.45'
 49-49B = 6.80'

O.D.O.T. DISTRICT 2 SURVEY OFFICE (USE ONLY)

PERSONNEL

REFERENCE NO. 49A

SHEET 3 OF 8

NOTES JAMES

DATE 4-9-19

ROUTE SR 295

H.C. LEU

WEATHER SUNNY

COUNTY LUCAS

R.C. JAMES

TEMP. 55°F

TOWNSHIP RICHFIELD

DWG BY MAHLER

PID 107059

SECTION 9

T 9 N R 5 E

TYPE MONUMENT MAG/WASHER

ON SURFACE - ~~BELOW~~ ON

OFFSET \varnothing PAVEMENT ON ~~LT~~ : ~~RT~~

- TO - EDGE PAVEMENT

STATION: 1085+07.02

HORZ. DATUM: NAD83 (2011)

GEOID: NAVD88-2012A

GRID: NORTHING: 746651.300

EASTING: 1602768.527

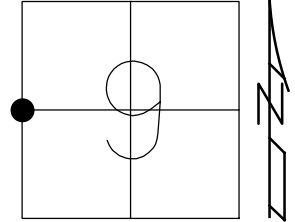

RECORD:
 FD P.K./WASHER
 5/17/05
 SET MAG/WASHER
 7/13/05, DCH
 FD MAG/WASHER
 REFA49
 3-6-19, LEU

DIST.
 49-49A = 6.68'
 49A-49B = 1.46'
 49-49B = 6.81'

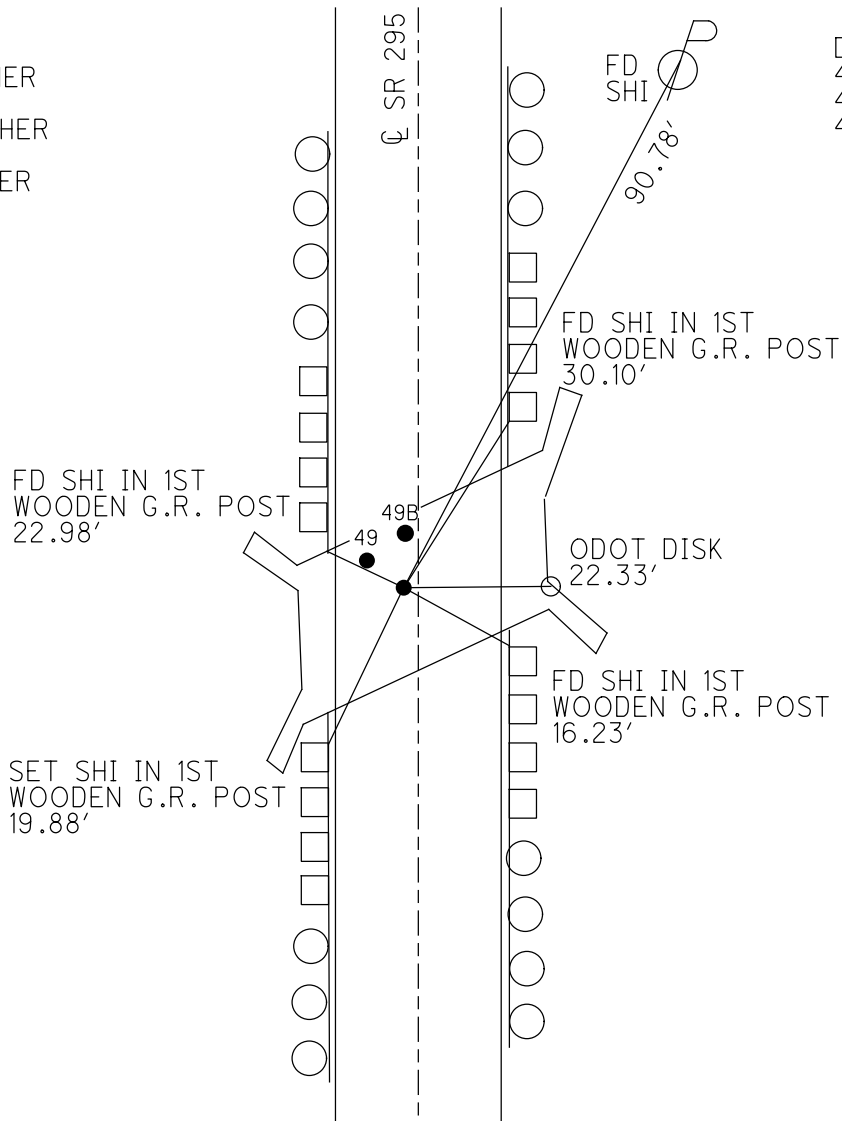

O.D.O.T. DISTRICT 2 SURVEY OFFICE (USE ONLY)

PERSONNEL _____ REFERENCE NO. 49A SHEET 3 OF 8
 NOTES HOMAN DATE 5/18/05 ROUTE SR 295
 H.C. NUHFER WEATHER SUNNY COUNTY LUCAS
 R.C. HERALD TEMP. 65° TOWNSHIP RICHFIELD
 _____ SECTION 9
 _____ T 9 N R 5 E

TYPE MONUMENT MAG/WASHER
 ON SURFACE - ~~BELOW~~ ON
 LEFT - ☉ PAV'T - RIGHT ON
 _____ TO _____ EDGE PAVEMENT
 S.L.M. 1085+20
 Grid: Northing: _____ Easting: _____

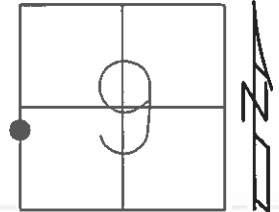

RECORD:
 FD P.K. NAIL/WASHER
 5/17/05
 SET MAG/WASHER
 7/13/05, DCH

NOTE:
 PT 49 BELIEVED TO
 BE ☉ R/W
 49 TO 49A = 6.65'
 49A TO 49B = 1.46'
 49 TO 49B = 6.79'

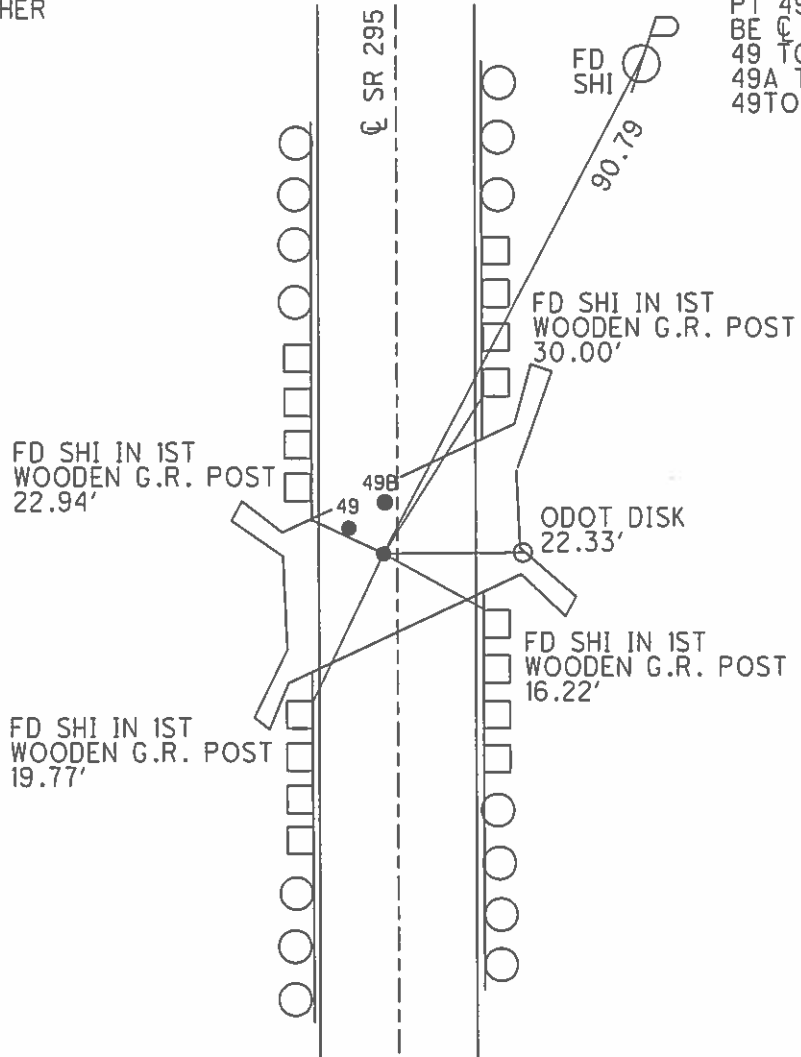

O.D.O.T. DISTRICT 2 SURVEY OFFICE

PERSONNEL

REFERENCE NO. 49 A

SHEET 3 OF 8

NOTES HOMAN

DATE 5-18-05

ROUTE SR 295

H.C. NUHFER

WEATHER SUNNY

COUNTY LUCAS

R.C. HERALD

TEMP. 65°

TOWNSHIP RICHFIELD

SECTION 8

T 9 S R 5 E

TYPE MONUMENT PK & WASHER

ON SURFACE - ~~BELOW~~ ON

LEFT - Q PAV'T - RIGHT ON

TO EDGE PAVEMENT

S.L.M. 1085+26

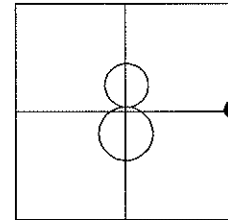

FOUND 5-16-05

SET MAG & WASHER
DCH, 7-13-05

NOTE:
PT 49 BELIEVED TO
BE Q R/W

FOUND SHINER IN
1ST WOODEN
GUARD RAIL POST
22.94'

FOUND SHINER IN
1ST WOODEN
GUARD RAIL POST
19.77'

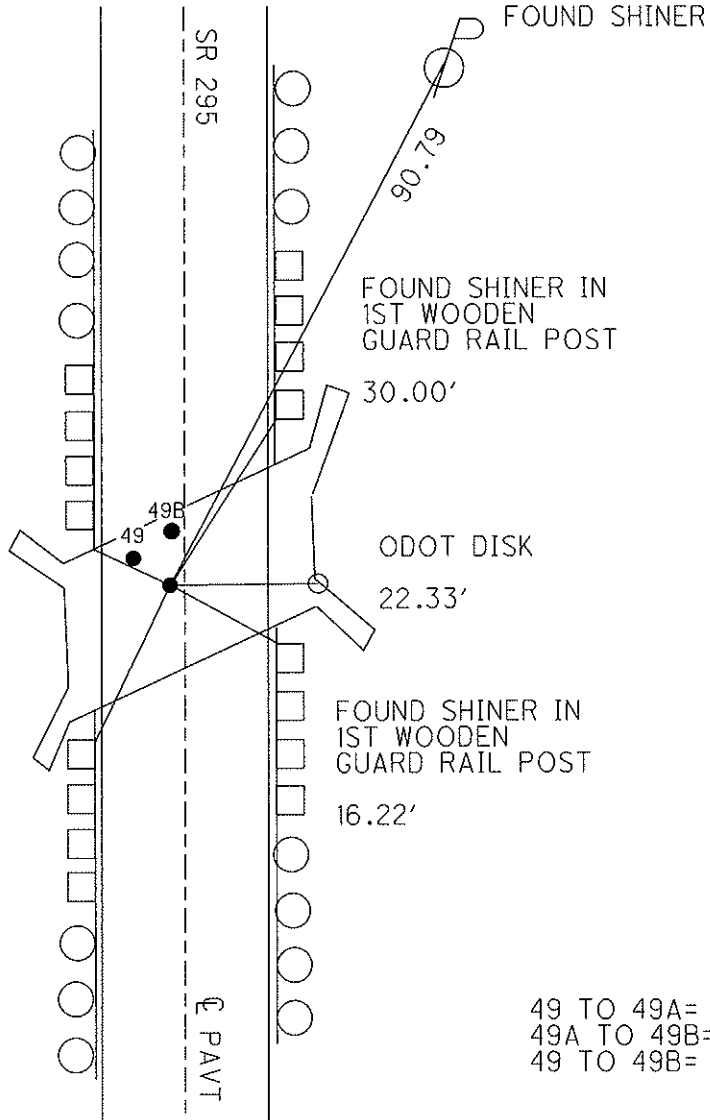

49 TO 49A= 6.65'
49A TO 49B= 1.46'
49 TO 49B= 6.79'