

10(95)
 Design
 Lucas

DESIGN DESIGNATION

Current A.D.T. (1995)	17,300
Design Year A.D.T. (2015)	23,200
D.H.V.	1856
D	54%
T	2%
V	25 MPH
Legal Speed Limit	25 MPH
Functional Classification	Urban Minor Arterial
No Design Exceptions Required	

STATE OF OHIO
 DEPARTMENT OF TRANSPORTATION
 LUC - SOUTH MAIN STREET
 CITY OF SYLVANIA
 LUCAS COUNTY

LUCAS COUNTY
 SOUTH MAIN STREET
 OHIO
 FHWA REGION
 FEDERAL PROJECT

PID : 10866

CM-000M(61)
 CMG-000M(61)

3070M

CONVENTIONAL SIGNS

County Line	-----	Existing Right of Way	EX: R/W
Township Line	-----	Proposed Right of Way	PROP. R/W
Section Line	-----	Property Line	-----
Corporation Line	-----	Railroad	-----
Fence Line (exist.)	x-x (prop.) x-x	Guardrail (existing)	--- (proposed) ---
Center Line	-----	Water Line	W
Trees or Stumps	○ or *	Gas Line	G
Utility Poles: Telephone	⊕	Sanitary	San.
Power	⊕	Storm	St.
Light	⊕	Electrical	E
Cable TV	⊕	Telephone	T
Traffic Signal	⊕	Gas Riser	⊕
Guy Pole	⊕	Telephone Riser	⊕

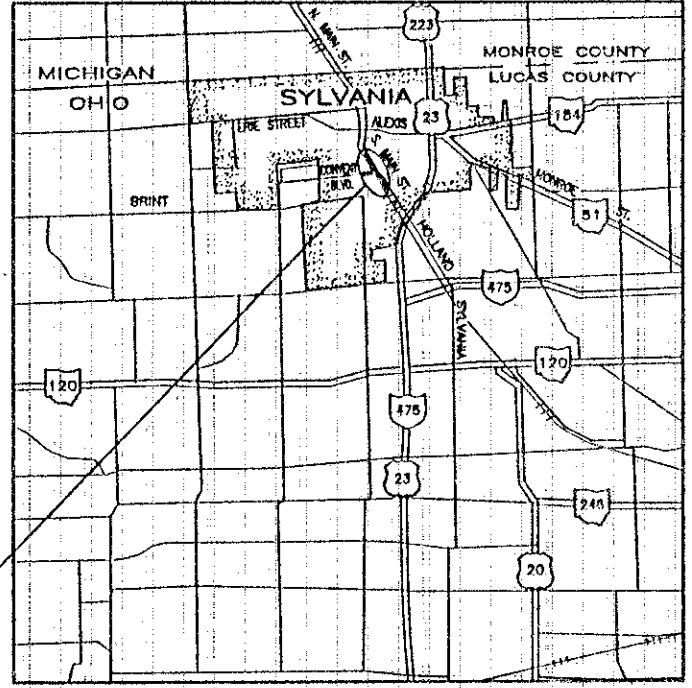

PROJECT SITE
 BEGIN PROJECT: STA. 1+15
 END PROJECT: STA. 8+64

1995 SPECIFICATIONS

The standard specifications of the State of Ohio, Department of Transportation, including changes and supplemental specifications listed in the proposal shall govern this improvement.

I hereby approve these plans and declare that the making of this improvement will not require the closing to traffic of the highway and that provisions for the maintenance and safety of traffic will be as set forth on the plans and estimates.

Approved: James E. Seney
 Mr. James E. Seney, Mayor, City of Sylvania
 Date: 5-30-95

Approved: Jeffrey P. Ballmer
 Mr. Jeffrey P. Ballmer, Public Service Director, City of Sylvania
 Date: 3/28/95

Approved: James O. Coyle
 District Deputy Director of Transportation
 Date: 6/17/95

Approved: _____
 Deputy Director, Design

Approved: Ray White
 Director, Department of Transportation
 Date: 8-18-95

INDEX OF SHEETS

Title Sheet	1
Typical Sections	2
General Notes	3
Maintenance of Traffic General Notes	4
General Summary	5 & 6
Subsummaries	7 - 11
Plan and Profile	12 - 14
Cross Sections	15 - 18
Intersection Detail	19
Traffic Control General Notes	20
Signal Subsummary	21
Pavement Marking and Sign Subsummary	22
Signal Plan	23
Traffic Signal Details	24
Signing and Striping Plan	25 & 26
Right-of-Way Plans	27-31

UNDERGROUND UTILITIES
 2 WORKING DAYS BEFORE YOU DIG
 Call 800-362-2784 (Toll Free)
 OHIO UTILITIES PROTECTION SERVICE
 NON-MEMBERS MUST BE CALLED DIRECTLY

PORTION TO BE IMPROVED
 STATE, FEDERAL & INTERSTATE ROADS
 OTHER ROADS

SCALES

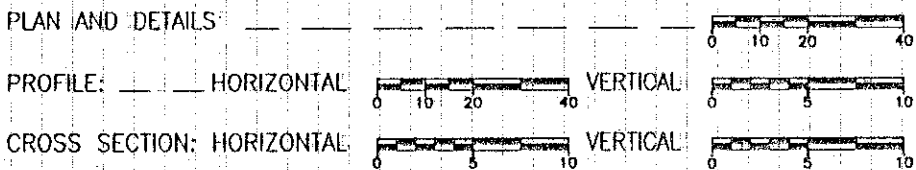

LINE DATA

Begin Project : Sta. 1+15
 End Project : Sta. 8+64
 Net Length of Project : 749 L.F. or 0.142 Mi.
 Add For Work :
 Main Street : Sta. -1+00 to Sta. 9+14 = 1014 L.F.
 Convent Blvd. : Sta. 3+00 to Sta. 5+84 = 284 L.F.
 Total Length of Work = 1298 L.F. or 0.246 Mi.

PROUDFOOT ASSOCIATES



BY: Thomas H. Yuravich
 DATE: MAR 22 1995
 P.E. No. 14171

SUPPLEMENTAL PRINTS OF STANDARD CONSTRUCTION DRAWINGS							
BP-3.1	2+21-92	MC-1	6-13-69	HL-10.12	5-1-87	TC-52.10	4-3-79
BP-4.1	2-21-92	MC-4	7-26-76	HL-20.11	5-1-87	TC-52.20	4-3-79
BP-5.1	10-28-94	MC-11	8-1-78	HL-30.11	5-1-87	TC-71.10	9-10-91
BP-7.1	10-30-92	MH-2	6-12-75	HL-30.22	5-1-87	TC-81.20	1-20-84
				HL-60.11	5-1-87	TC-82.10	8-29-84
				LA-1	6-1-79	TC-83.10	3-18-92
CB-3	5-1-79	MT-97.10	4-29-88			TC-83.20	1-20-84
CB-3A	5-1-79	MT-97.11	10-4-89			TC-85.10	1-20-84
MH-1	12-18-84	MT-99.10	11-14-86	TC-21.20	9-1-92	TC-85.20	1-20-84
MH-3	12-18-84	MT-99.20	4-29-88	TC-35.10	8-29-84		
I-1	12-18-84			TC-41.20	6-21-94		
				TC-41.40	6-18-79		
BP-1.1	2-21-92			TC-41.41	8-2-79		
BP-2.2	10-28-94			TC-42.20	3-26-79		

SUPPLEMENTAL SPECIFICATIONS	
820	6-14-95
931	7-17-95
942	6-14-95
944	3-23-95

C.A.P.
 DEPARTMENT OF TRANSPORTATION
 FEDERAL HIGHWAY ADMINISTRATION
 APPROVED : _____
 DIVISION ADMINISTRATOR DATE

Project: LUC - SOUTH MAIN ST.
 Date of Letting: _____ 19__ Contract No. _____

TOTAL NUMBER OF :
 5 OWNERSHIPS
 0 TOTAL TAKES
 0 OWNERSHIPS WITH STRUCTURES INVOLVED
 0 OWNERSHIP WITH "P" ITEMS

SUMMARY OF ADDITIONAL RIGHT-OF-WAY

LUCAS COUNTY
 SOUTH MAIN ST. / CONVENT BLVD.

OHIO
 FEDERAL
 PROJECT

29
 31

STATE JOB NO. 1027690
 P.I.D. NO. 10866

R/W PLANS
 3
 5

SHEET NO.	OWNER	AUDITOR'S PARCEL NUMBER	SHEET NO.	OWNER'S RECORD		RECORD AREA ACRES	TOTAL P.R.O. ACRES	GROSS TAKE ACRES	P.R.O. IN TAKE ACRES	NET TAKE ACRES	STRUCTURE	NET RESIDUE		TYPE FUND	REMARKS AND PERSONALITY	AS ACQUIRED	
				BOOK	PAGE							LEFT ACRES	RIGHT ACRES			BOOK	PAGE
1-WD	BEVERLY SINCLAIR	82-3874 82-3877	5	89-0261	C-11	1.13 (C) ±	0.246	0.239	0.207	0.032	NONE	0.852		LOCAL	IMPROVEMENTS PER PLAN		
2-WD	TOLEDO 76, INC., AN OHIO CORPORATION	82-4114 82-4117	5	88-0461	C-03	0.83 (C) ±	0.313	0.221	0.186	0.035	NONE	0.482		LOCAL	IMPROVEMENTS PER PLAN		
3-WD	ROBERT B. AND CAROL A. ESPLIN	82-4121	5	88-0338	A-11	0.52 (C) ±	0.066	0.079	0.066	0.013	NONE	0.441		LOCAL	IMPROVEMENTS PER PLAN		
4-WD	DAVID J. KUNTZ AND BRENDA S. CHILDERS	82-4124	5	92-0519	C-02	0.20 (C) ±	0.026	0.031	0.026	0.005	NONE	0.169		LOCAL	IMPROVEMENTS PER PLAN		
5-WD	VINCENT P. DI POPI, SR.	82-4127	5	94-0155	B-05	0.22 (C) ±	0.024	0.026	0.024	0.002	NONE	0.194		LOCAL	IMPROVEMENTS PER PLAN		

NOTE :
 WD PARCELS TO BE ACQUIRED
 IN THE NAME OF THE CITY
 OF SYLVANIA

NOTES :
 (C) ± DENOTES APPROXIMATE AREA, CALCULATED FROM RECORDED DATA
 (D) DENOTES DEED AREA
 (C) DENOTES AREA, CALCULATED FROM SURVEY AND RECORDED DATA

REVISION	DATE	DESCRIPTION

REVISION	DATE	DESCRIPTION

PLAN COMPLETION DATE



DRAWN: 243695S
 CHECKED: APPROVED:

R/W ONLY | S. MAIN & CONVENT BLVD.
PID-10866 | SJN-027690

EXISTING R/W AND PROPOSED CONSTR. CURVE DATA
(FROM 1929 PLAN S.H. (I.C.H.) 58)

R = 954.93' (R) T = 219.51' (R)
Dc = 6'-00" (R) L = 431.53' (R)
Δ = 25°33'30" (R)-LT.
P.I. = STA. 210+00 (OLD STATION)
= STA. 0+07.84 (TAN. STATION)
P.C. = STA. -2+11.87 (TAN. STATION, @ R/W & CONSTR.) = STA. 207+80.49 (R) - ORIG. STA.
P.T. = STA. 2+27.35 (TAN. STATION); (@ R/W & CONSTR. = STA. 2+19.86) STA. 212+12.02 (R) - ORIG. STA.

SOUTHWEST 1/4 OF SECTION 10, T. 9 S., R. 6 E.
IN THE CITY OF SYLVANIA, LUCAS COUNTY, OHIO.

LEGEND

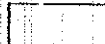
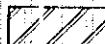
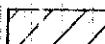
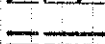
-  DENOTES PROPOSED PAVT. BUTT JOINT TYPE PER BP-3.1
 -  DENOTES PROPOSED 4' SIDEWALK OR CURB RAMP
 -  DENOTES PROPOSED DRIVE APRON
 -  DENOTES PROPOSED PAVEMENT WIDENING
 -  DENOTES PROPOSED 2 1/2" COMBINATION CURB AND GUTTER
 - R DENOTES RECORD ANGLE, BEARING OR DISTANCE
 - M DENOTES MEASURED ANGLE, BEARING OR DISTANCE
- *NOTE:
CONSTRUCTION LIMITS ARE THE R/W LIMITS UNLESS SHOWN OTHERWISE
- * DENOTES FLAG POLES TO BE REMOVED BY OWNER

SEE SHEET 5
MATCH LINE STA. 3+00

PROPOSED RIGHT BACK OF CURB CURVE DATA

R = 753.94' T = 70.20'
Dc = 7'-30"-00" L = 140.00'
Δ = 10'-30"
P.I. = STA. 1+65.00 (@ CONSTR.)

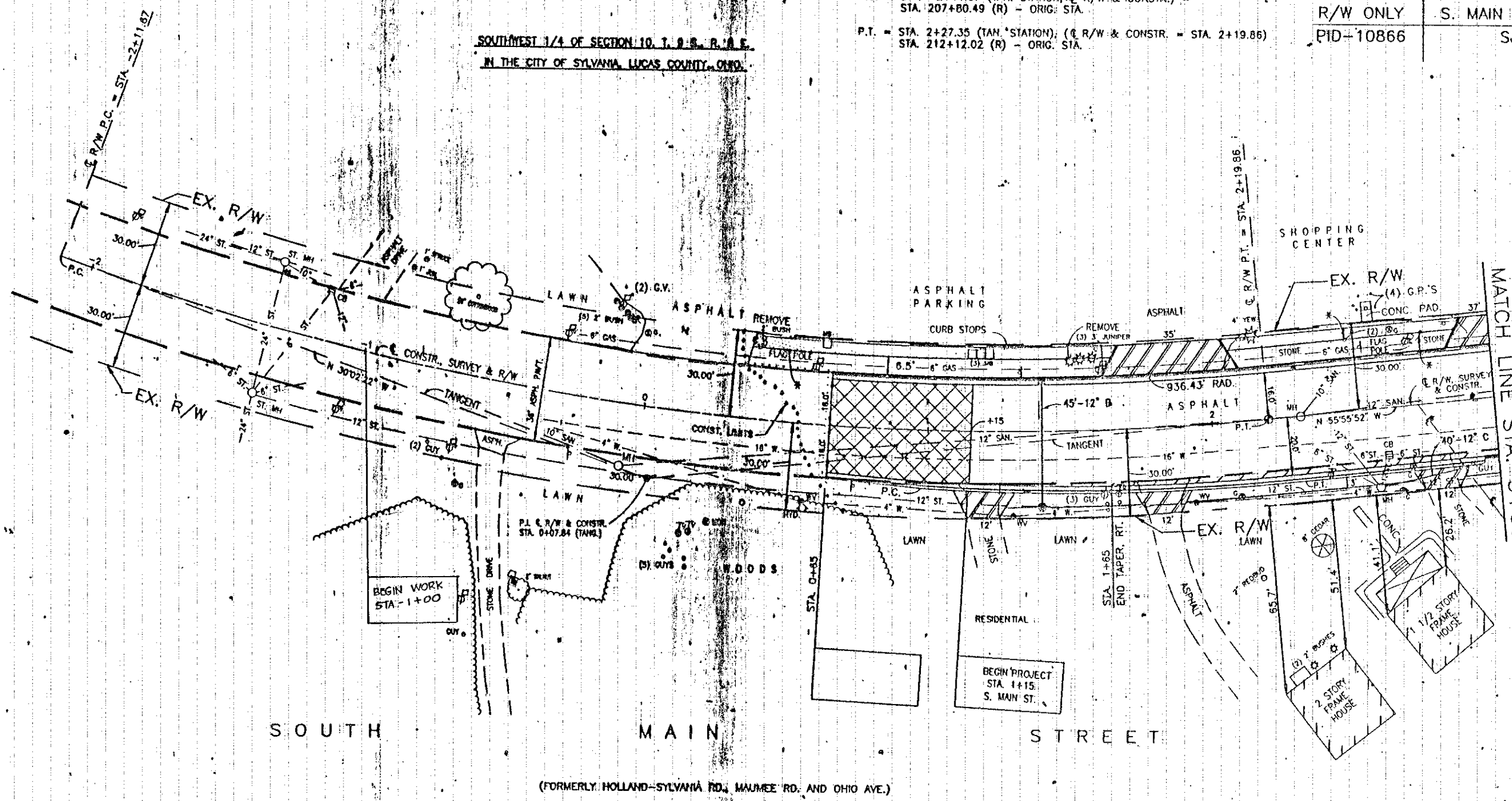
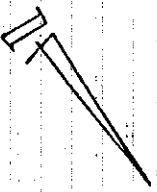
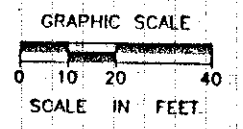

SOUTH MAIN STREET

(FORMERLY HOLLAND-SYLVANIA RD., MAUMEE RD. AND OHIO AVE.)

SOUTHWEST 1/4 OF SECTION 10, T. 9 S., R. 6 E.
IN THE CITY OF SYLVANIA, LUCAS COUNTY, OHIO.

REV'D.	DATE	DESCRIPTION

EXISTING C/R/W & CONSTR. CURVE DATA
(FROM 1929 PLAN S.H. (L.C.H.) 58)

R = 238.73' - R & M
Dc = 24'00"00" - R & M
Δ = 33'36"10" RT. (R), 33'36"00" RT. (M)
T = 72.08' - R & M
L = 140.01' - R, 140.00' (C)
P.I. = STA. 214+52.65 (S.H. (L.C.H.) 58)
P.T. = STA. 4+60.44 (NEW STA. - C/R/W & PROP CONSTR.)
P.C. = STA. 213+80.57 (R)
P.I. = STA. 214+52.65 (R)
P.T. = STA. 215+20.58 (R)

R/W PLANS

R/W ONLY: S. MAIN & CONVENT BLVD.
PID-10866 SJN+02769

NOTE: CONSTRUCTION LIMITS ARE THE P.M. LIMITS UNLESS SHOWN OTHERWISE

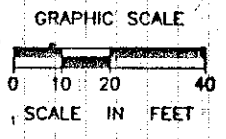

SOUTHWEST 1/4 OF SECTION 10, T. 9 S., R. 6 E.
IN THE CITY OF SYLVANIA, LUCAS COUNTY, OHIO.

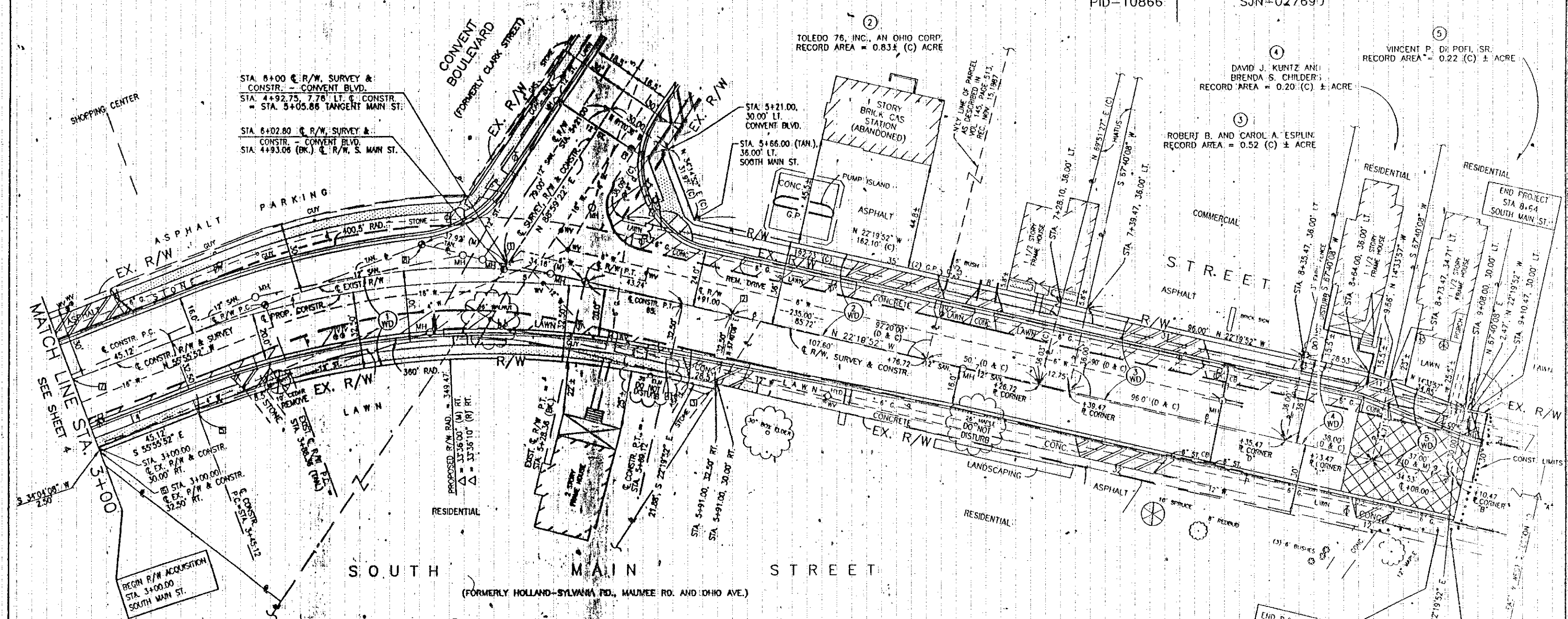

STA. 6+00 C/R/W, SURVEY & CONSTR. - CONVENT BLVD.
STA. 4+92.75, 7.76' LT. C/CONSTR. - S. MAIN ST.
STA. 5+05.86 TANGENT MAIN ST.

STA. 6+02.80 C/R/W, SURVEY & CONSTR. - CONVENT BLVD.
STA. 4+93.06 (BK.) C/R/W, S. MAIN ST.

TOLEDO 76, INC., AN OHIO CORP.
RECORD AREA = 0.83 ± (C) ACRE

DAVID J. KUNTZ AND BRENDA S. CHILDERS
RECORD AREA = 0.20 (C) ± ACRE

ROBERT B. AND CAROL A. ESPLIN
RECORD AREA = 0.52 (C) ± ACRE

VINCENT P. DI POPI, SR.
RECORD AREA = 0.22 (C) ± ACRE

POINT	STATION**	OFFSET	BEARING	DIST.
1	4+92.75	7.76' LT.	N 22°19'52" W	99.28'
2	5+91.00	0.00' RT.	N 67°40'08" E	32.50'
3	5+91.00	32.50' RT.	S 22°19'52" E	21.88'
4	5+69.12	32.50' RT.	S 39°07'52" E	202.02'
5	3+45.12	32.50' RT.	S 55°55'52" E	45.12'
6	3+00.00	32.50' RT.	S 34°04'08" W	32.50'
7	3+00.00	0.00' RT.	N 55°55'52" W	160.44'
8	4+57.12	17.03' LT.	N 22°19'52" W	37.92'

BEVERLY SINCLAIR
RECORD AREA = 1.13 (C) ± ACRES

SOUTHWEST 1/4 OF SECTION 10, T. 9 S., R. 6 E.
IN THE CITY OF SYLVANIA, LUCAS COUNTY, OHIO.

DENOTES CHORD BEARING & DISTANCE.
CURVE DATA - PROP. R/W

PROPOSED C/CONSTRUCTION CURVE DATA

R = 381.97' (M) P.I. = STA. 4+60.44 (TAN.)
Dc = 15'00"00" P.C. = STA. 3+52.61 (TAN.) (3+45.12 C/CONSTR.)
Δ = 33'36"10" (R) RT. P.T. = STA. 5+83.26 (TAN.) (5+69.12 C/CONSTR.)
Δ = 33'36"00" (M) RT.
T = 105.51'
L = 204.94'

1T = 115.32' (M)
L = 224.00' (M)

P.O.B. DISTANCES

	DISTANCE	BEARING
A TO B	1012.44'	S 22°19'52" E
A TO C	1049.44'	S 22°19'52" E
A TO D	1087.44'	S 22°19'52" E

STATIONS REFERENCE C/CONSTRUCTION

REV'D	DATE	DESCRIPTION