

O.D.O.T. DISTRICT 2 SURVEY OFFICE (USE ONLY)

PERSONNEL _____ REFERENCE NO. 19 SHEET 27 OF 38
 NOTES RHOADES DATE 10/6/15 ROUTE SR 2
 H.C. O'DONNELL WEATHER CLEAR COUNTY OTTAWA
 R.C. RHOADES TEMP. 65° TOWNSHIP CARROLL
 _____ SECTION 4
 _____ T 7 N R 15 E

TYPE MONUMENT MONBOX
 ON SURFACE - ~~BELOW~~ ON _____
 LEFT - ☉ PAV'T - RIGHT ON _____
12' TO RT EDGE PAVEMENT
 S.L.M. 421+84.03
 GRID: NORTHING: 706423.102 EASTING: 1796398.889

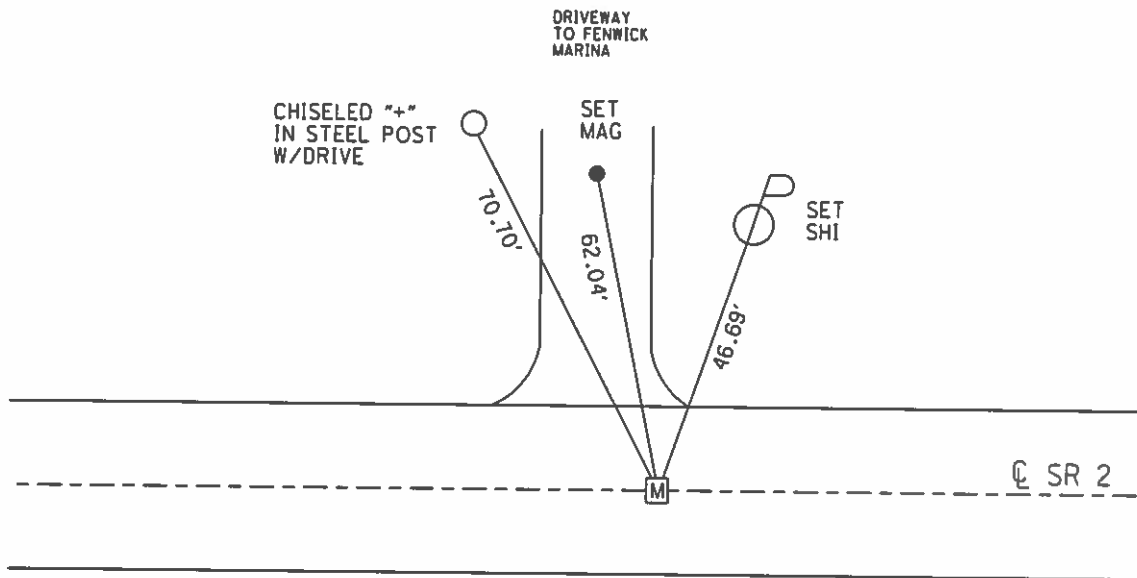
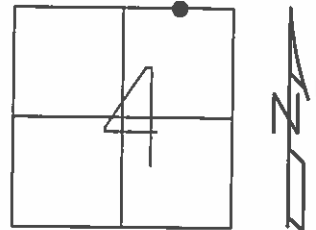

RECORD: P.I.
 STA. 421+74.45
 ADJ. BRASS MON.
 ON SURFACE
 6/13/68
 FD P.K./WASHER
 GPS, REF19
 11/28/11, MC
 FD P.K./WASHER
 4/23/13, SDC
 SET MAG/WASHER
 GPS, NEWREF19
 10/6/15, JFO

PERSONNEL TITLE PERSONNEL TITLE

COUNTY Ottawa DATE 10-31-74
7-17-74

S. R. R WEATHER Fair

SEC. 3 TEMP. 85°

DESCRIPTION S.R. # 19 East Benton Twp. JOB NO.

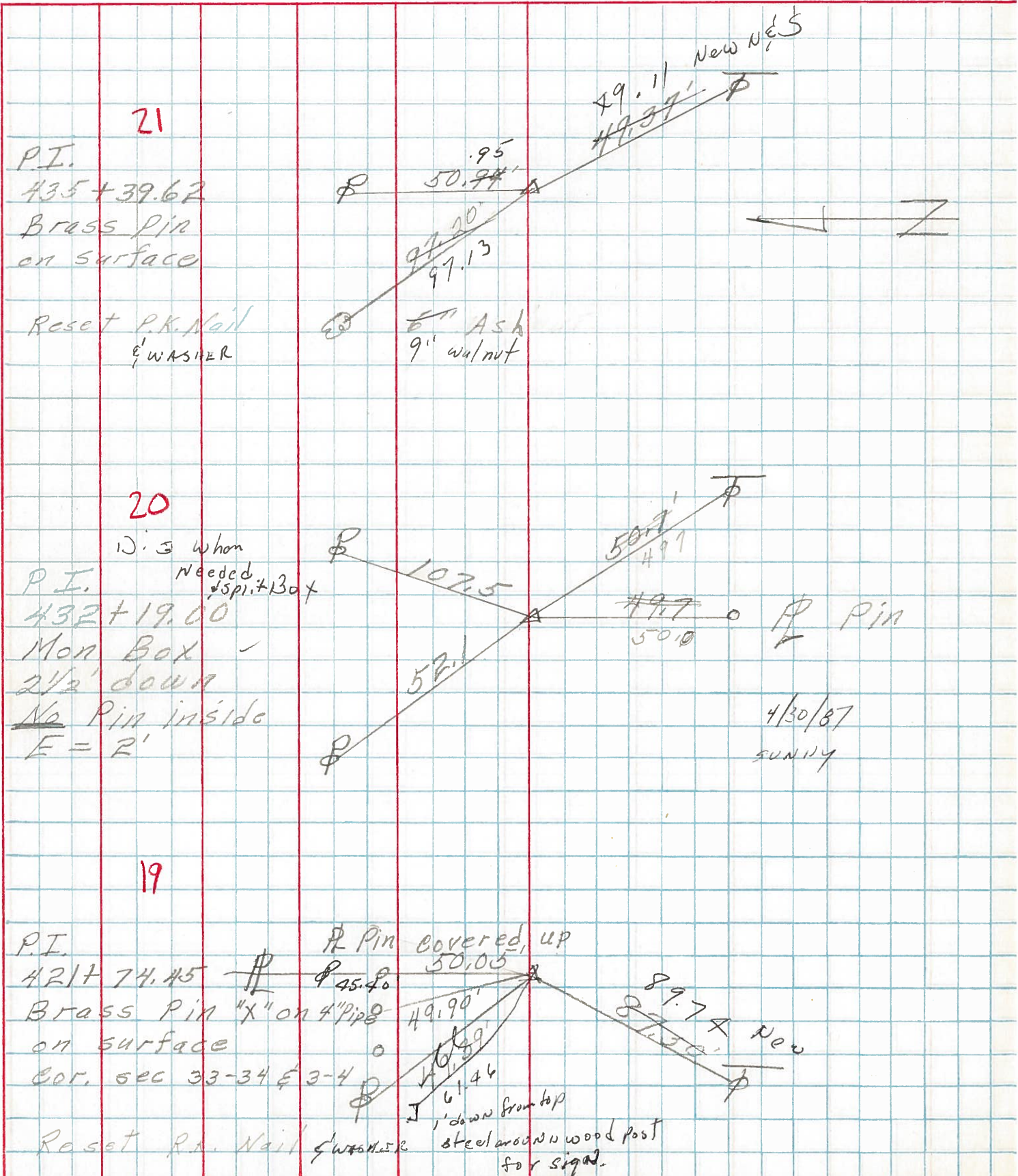

PERSONNEL	TITLE	PERSONNEL	TITLE	COUNTY	DATE
Schneider		Potts		Ottawa	6-13-68
Mosser				S. R. <u>2</u>	WEATHER <u>Cloudy</u>
Barbour				SEC. <u>S.R. #19 East</u>	TEMP. <u>60°</u>
Reading					

DESCRIPTION Ties for Control Points JOB NO. _____

