

O.D.O.T. DISTRICT 2 SURVEY OFFICE (USE ONLY)

PERSONNEL _____ REFERENCE NO. 37 G1 SHEET 2 OF 48
 NOTES MILLER DATE 1/24/23 ROUTE SR 2
 H.C. AUBLE WEATHER SUNNY COUNTY OTTAWA
 R.C. NIESE TEMP. 33° TOWNSHIP ERIE
 DWG BY RHOADES PID 107959 SECTION 33
 T 7 N R 16 E

TYPE MONUMENT MONBOX W/ 1" IPIN
 ON SURFACE - ~~BELOW~~ ON
 OFFSET \varnothing PAVEMENT ON LT : RT
±31' TO LT EDGE PAVEMENT
 STATION: 872+78.53

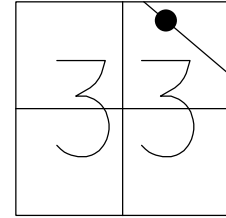

HORZ.DATUM: NAD83(2011) GEOID: NAVD88 2018
 GRID: NORTHING: 679018.100 EASTING: 1826803.719

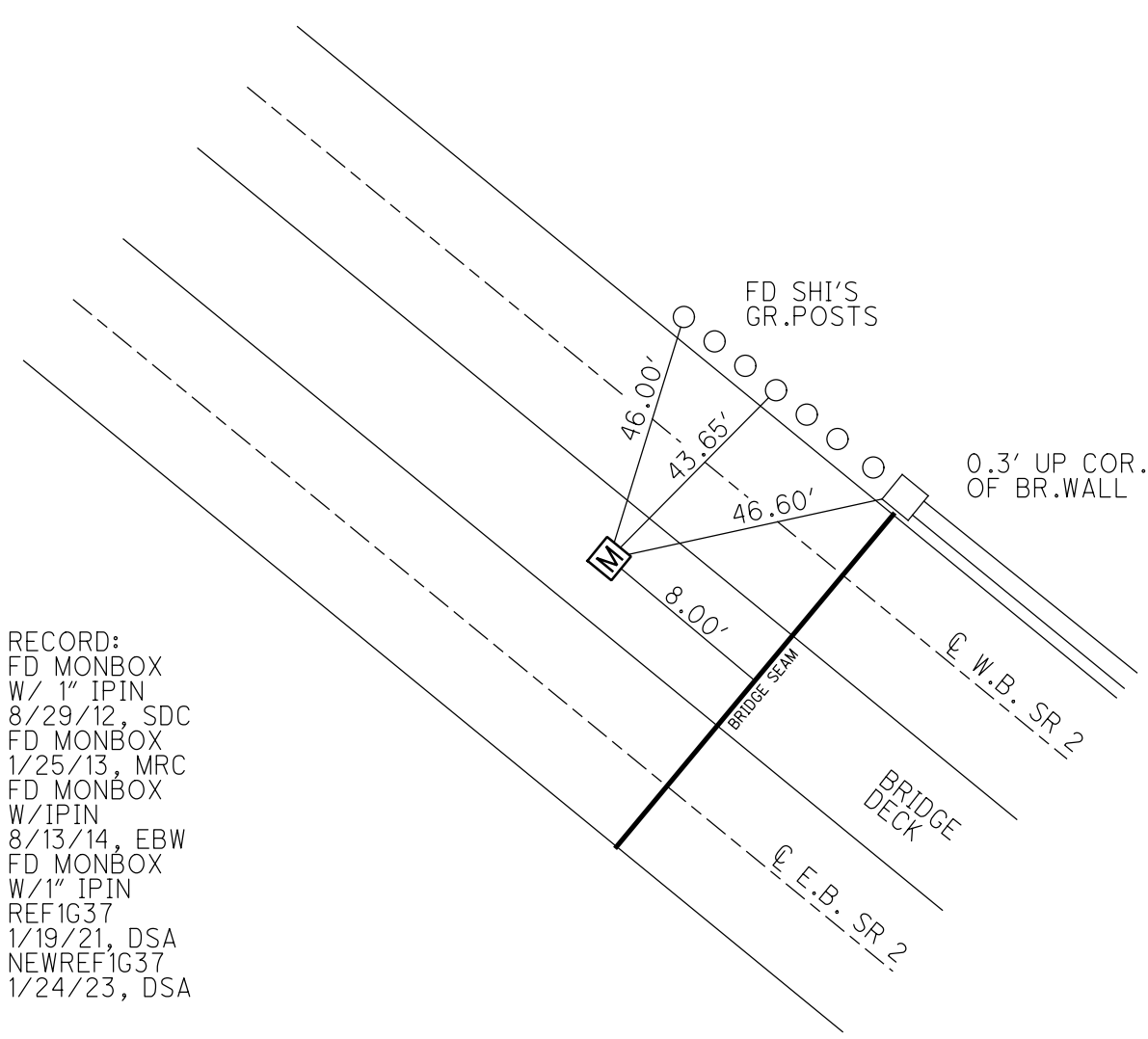

RECORD:
 FD MONBOX
 W/ 1" IPIN
 8/29/12, SDC
 FD MONBOX
 1/25/13, MRC
 FD MONBOX
 W/IPIN
 8/13/14, EBW
 FD MONBOX
 W/1" IPIN
 REF1G37
 1/19/21, DSA
 NEWREF1G37
 1/24/23, DSA

O.D.O.T. DISTRICT 2 SURVEY OFFICE (USE ONLY)

PERSONNEL _____ REFERENCE NO. 37 G1 SHEET 2 OF 45
 NOTES RHOADES DATE 1/19/21 ROUTE SR 2
 H.C. AUBLE WEATHER CLOUDY COUNTY OTTAWA
 R.C. _____ TEMP. 30° TOWNSHIP ERIE
 DWG BY NIESE PID 107959 SECTION 33
 T 7 N R 16 E

TYPE MONUMENT MONBOX W/ 1" IPIN
 ON SURFACE - ~~BELOW~~ ON
 OFFSET Q PAVEMENT ON LT : RT
±31' TO LT EDGE PAVEMENT
 STATION: 872+78.53

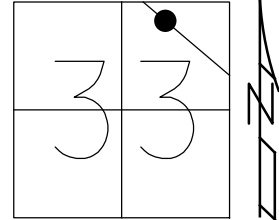

HORZ. DATUM: NAD83(2011) GEOID: NAVD88 2018
 GRID: NORTHING: 679018.102 EASTING: 1826803.701

RECORD:
 FD MONBOX
 W/ 1" IPIN
 8/29/12, SDC
 FD MONBOX
 1/25/13, MRC
 FD MONBOX
 W/IPIN
 8/13/14, EBW
 FD MONBOX
 W/1" IPIN
 REF1G37
 1/19/21, DSA

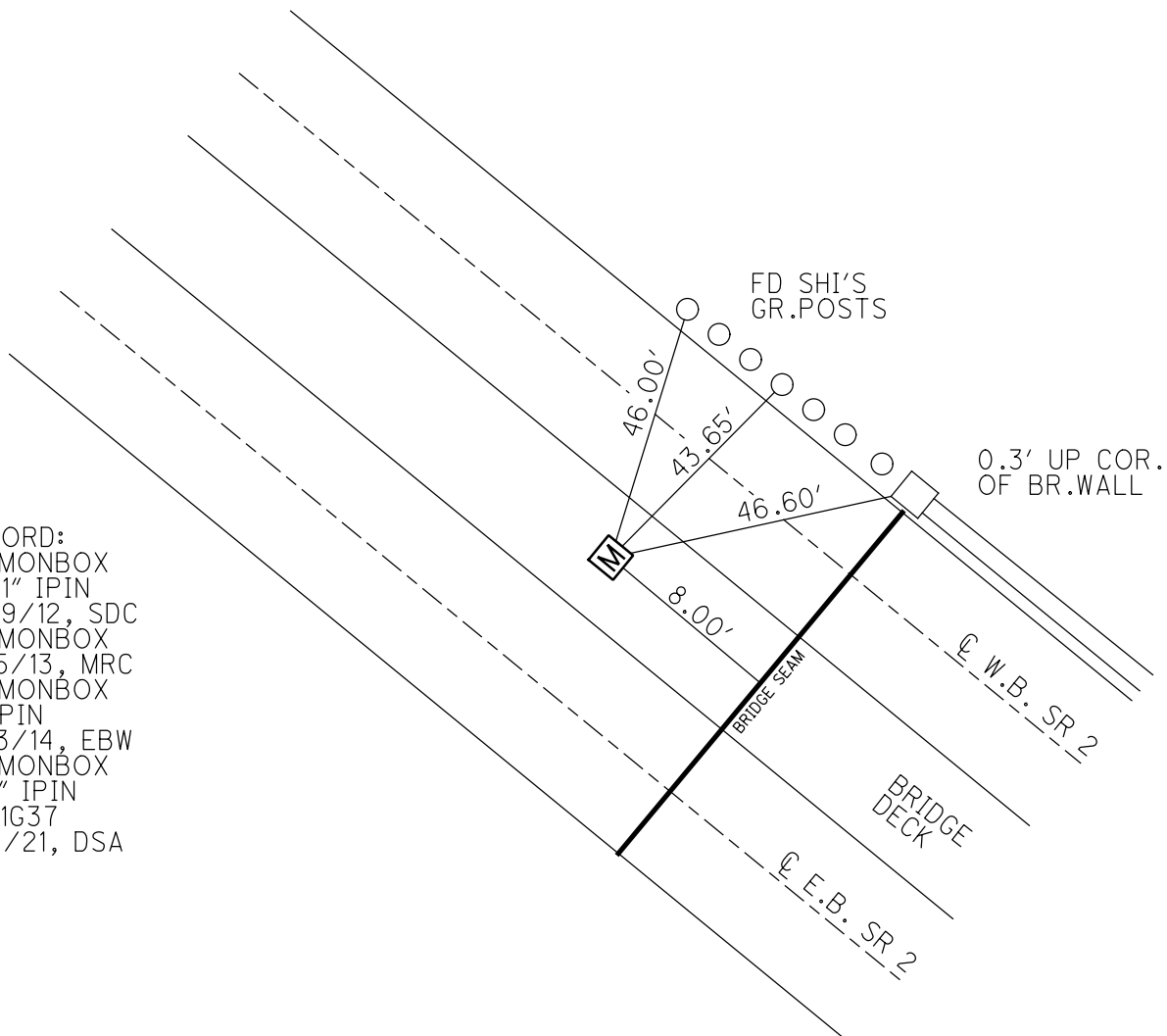

O.D.O.T. DISTRICT 2 SURVEY OFFICE (USE ONLY)

PERSONNEL _____ REFERENCE NO. G 1 SHEET 2 OF 3
 NOTES LEU DATE 8/13/14 ROUTE SR 2
 H.C. HOMAN WEATHER SUNNY COUNTY OTTAWA
 R.C. WESTFALL TEMP. 65° TOWNSHIP ERIE
 _____ SECTION 33
 _____ T 7 N R 16 E

TYPE MONUMENT MON.BOX, W/IPIN
 ON SURFACE - ~~BELOW~~ ON
 LEFT - Q PAV'T - RIGHT ON
31'± TO LT EDGE PAVEMENT
 S.L.M. 872+78.53
 GRID: NORTHING: 679018.122 EASTING: 1826803.734

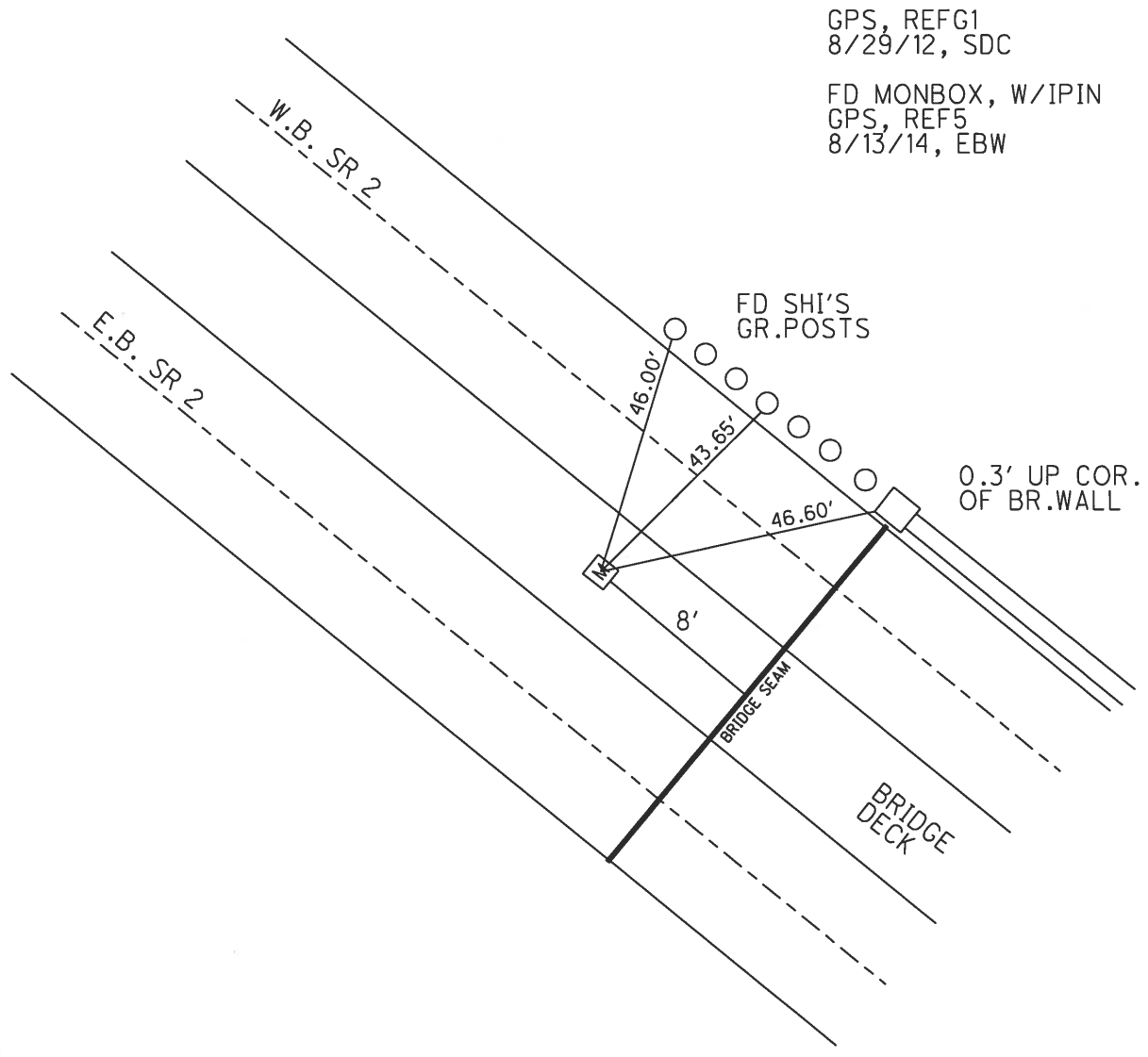
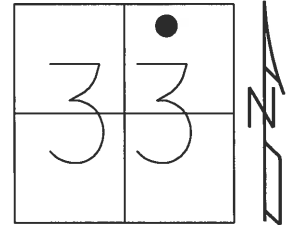

GPS, REF G1
 8/29/12, SDC

FD MONBOX, W/IPIN
 GPS, REF 5
 8/13/14, EBW

O.D.O.T. DISTRICT 2 SURVEY OFFICE (USE ONLY)

PERSONNEL _____

REFERENCE NO. 37G 1

SHEET 2 OF 3

NOTES RHOADES

DATE 1/25/13

ROUTE SR 2

H.C. CANTERBURY

WEATHER OVERCAST

COUNTY OTTAWA

R.C. LAU

TEMP. 18°

TOWNSHIP ERIE

SECTION 33

T 7 N R 16 E

TYPE MONUMENT MON.BOX

ON SURFACE - ~~BELOW~~ ON

LEFT - Q PAV'T - RIGHT ON

 TO EDGE PAVEMENT

S.L.M. 872+78.53

Grid: Northing: 679018.100 Easting: 1826803.670

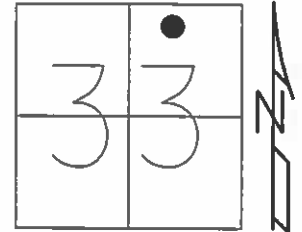

GPS, REFG1
8/29/12, SDC

