

O.D.O.T. DISTRICT 2 SURVEY OFFICE (USE ONLY)

PERSONNEL _____ REFERENCE NO. 41 SHEET 7 OF 45
NOTES RHOADES DATE 1/28/21 ROUTE SR 2
H.C. AUBLE WEATHER CLOUDY COUNTY OTTAWA
R.C. _____ TEMP. 22° TOWNSHIP ERIE
DWG BY NIESE PID 107959 SECTION 34
T 7 N R 16 E

TYPE MONUMENT FD 3 1/2" DISK ATOP CBAR
ON SURFACE - ~~BELOW~~ ON
OFFSET \varnothing PAVEMENT ON LT : RT
- TO - EDGE PAVEMENT
STATION: 922+12.66

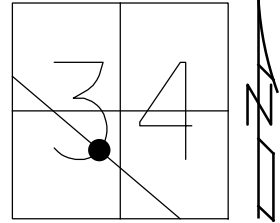

HORIZ.DATUM: NAD83(2011) GEOID: NAVD88 2018
GRID: NORTHING: 675819.636 EASTING: 1830560.742

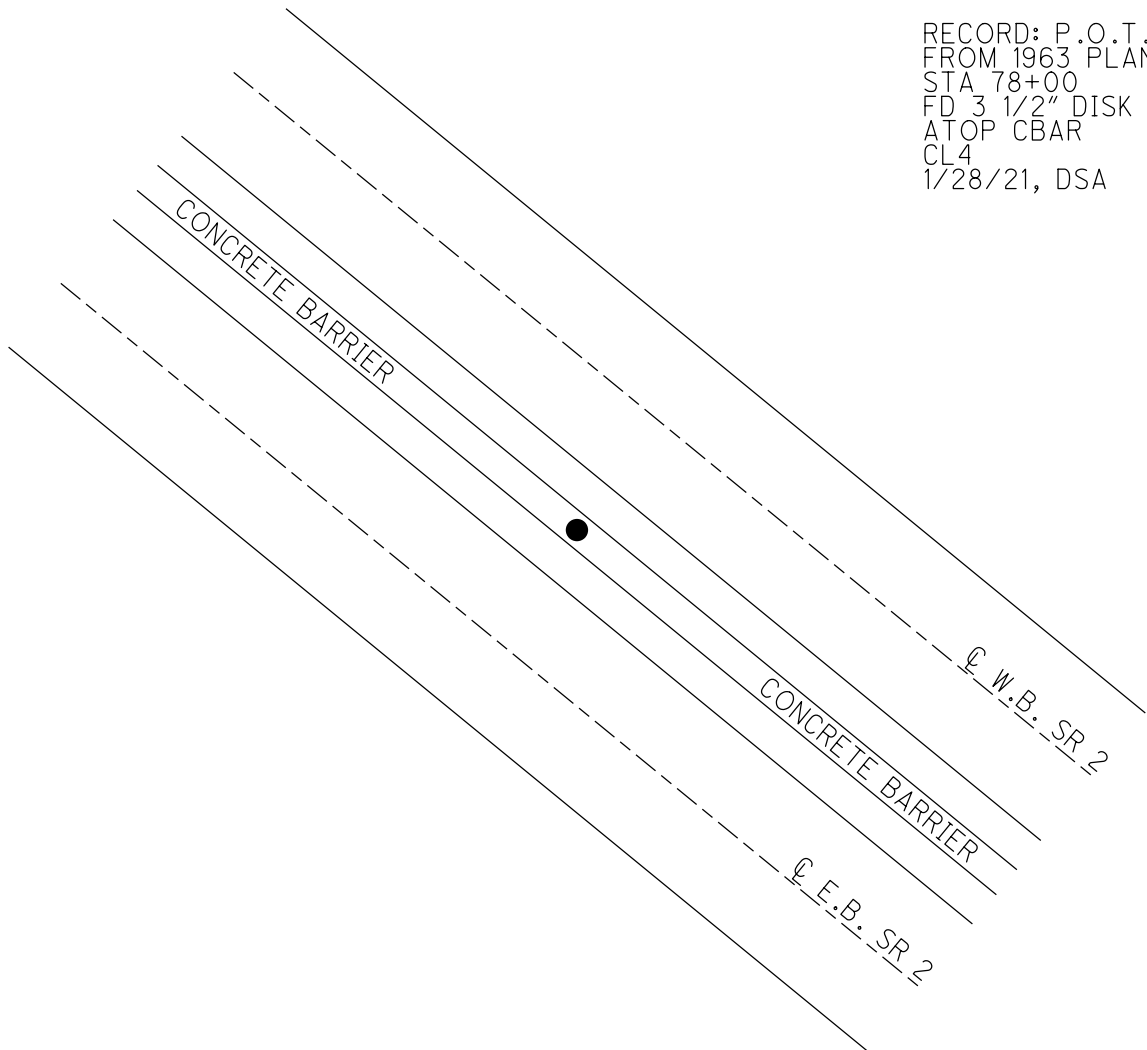

PERSONNEL TITLE PERSONNEL TITLE

Schneider

COUNTY Otawa

DATE 1-3-73

Mosser

S. R. 2

WEATHER Cold Cloud

Barbour

SEC. 16.48

TEMP. 35°

DESCRIPTION Sec. 34 E3

ERIE & Bay Twp.

JOB NO.

LEFT

CENTER LINE

RIGHT

P.O.T.
120+00
Mon. Box set in conc-



P.O.T.
110+00
Mon. Box set in conc-



P.O.T.
100+00
Mon. Box set in conc-



P.O.T.
92+00
Mon. Box set in conc-



P.O.T.
86+00
Mon. Box set in conc-



P.O.T.
78+00
Mon. Box set in conc-



P.O.T.
68+00
Mon. Box set in conc-

