

O.D.O.T. DISTRICT 2 SURVEY OFFICE (USE ONLY)

PERSONNEL \_\_\_\_\_ REFERENCE NO. 43 SHEET 9 OF 45  
NOTES RHOADES DATE 1/28/21 ROUTE SR 2  
H.C. AUBLE WEATHER CLOUDY COUNTY OTTAWA  
R.C. \_\_\_\_\_ TEMP. 22° TOWNSHIP ERIE  
DWG BY NIESE PID 107959 SECTION 34  
T 7 N R 16 E

TYPE MONUMENT FD 3 1/2" DISK ATOP CBAR  
ON SURFACE - ~~BELOW~~ ON  
OFFSET  $\varnothing$  PAVEMENT ON LT : RT  
     TO      EDGE PAVEMENT  
STATION: 936+13.41

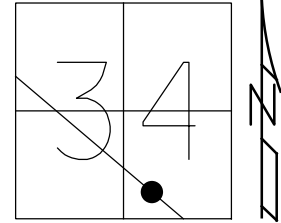

HORIZ.DATUM: NAD83(2011) GEOID: NAVD88 2018  
GRID: NORTHING: 674911.732 EASTING: 1831627.424

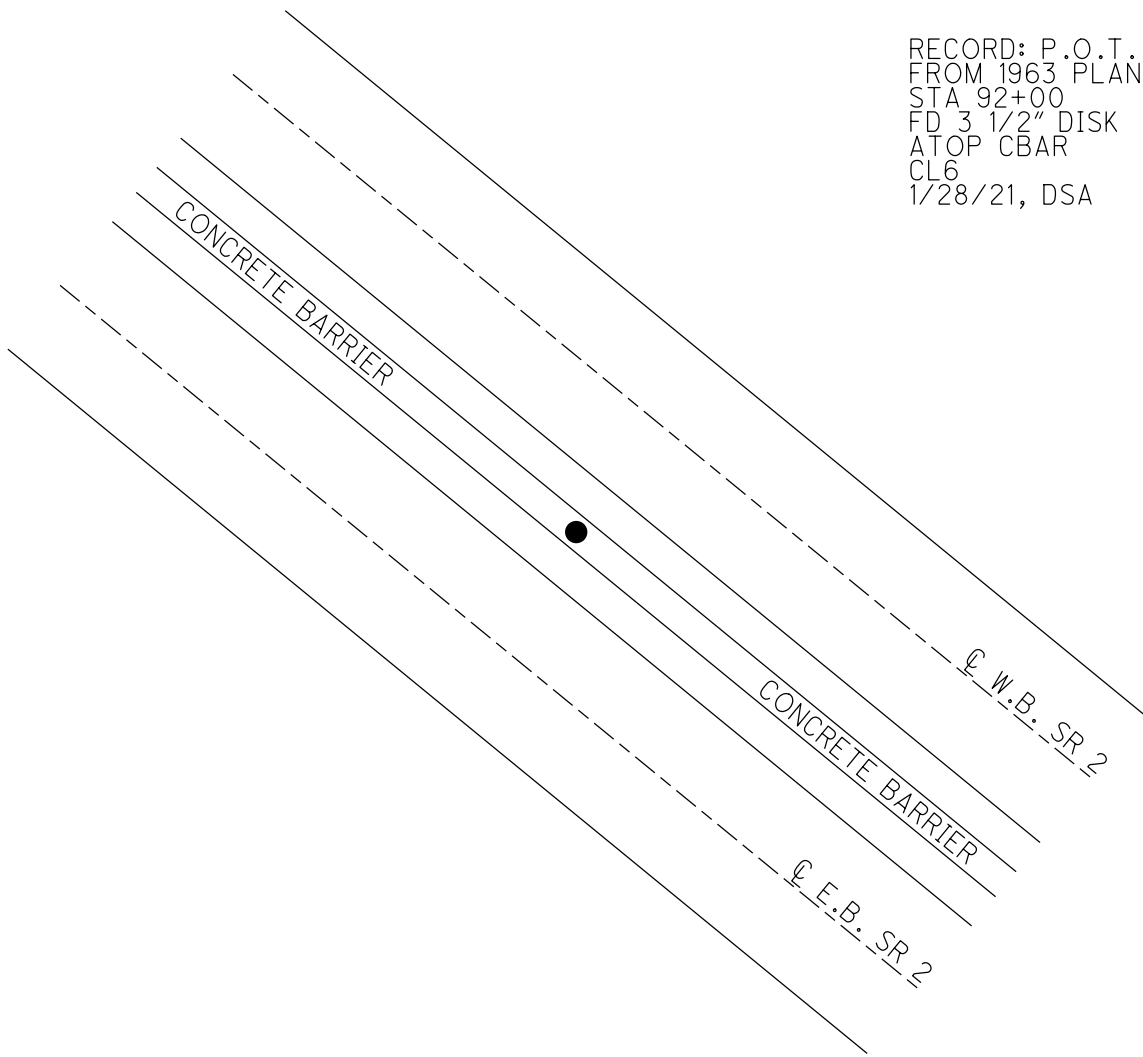

RECORD: P.O.T.  
FROM 1963 PLAN  
STA 92+00  
FD 3 1/2" DISK  
ATOP CBAR  
CL6  
1/28/21, DSA

PERSONNEL TITLE PERSONNEL TITLE

Schneider

COUNTY Otawa

DATE 1-3-73

Mosser

S. R. 2

WEATHER Cold Cloud

Barbour

SEC 16.48

TEMP 35°

DESCRIPTION Sec. 34 E3

ERIE & Bay Twp.

JOB NO.

LEFT

CENTER LINE

RIGHT

P.O.T.  
120+00  
Mon. Box set in conc-

P.O.T.  
110+00  
Mon. Box set in conc-

P.O.T.  
100+00  
Mon. Box set in conc-

P.O.T.  
92+00  
Mon. Box set in conc-

P.O.T.  
86+00  
Mon. Box set in conc-

P.O.T.  
78+00  
Mon. Box set in conc-

P.O.T.  
68+00  
Mon. Box set in conc-

