

O.D.O.T. DISTRICT 2 SURVEY OFFICE (USE ONLY)

PERSONNEL \_\_\_\_\_ REFERENCE NO. 47 SHEET 13 OF 45  
NOTES RHOADES DATE 1/28/21 ROUTE SR 2  
H.C. AUBLE WEATHER CLOUDY COUNTY OTTAWA  
R.C. \_\_\_\_\_ TEMP. 22° TOWNSHIP BAY  
DWG BY NIESE PID 107959 SECTION 2  
T 6 N R 16 E

TYPE MONUMENT FD 3 1/2" DISK ATOP CBAR  
ON SURFACE - ~~BELOW~~ ON  
OFFSET  $\varnothing$  PAVEMENT ON LT : RT  
- TO - EDGE PAVEMENT  
STATION: 971+12.87

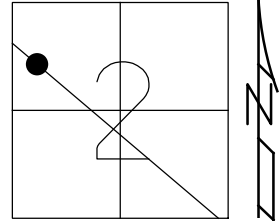

HORIZ.DATUM: NAD83(2011) GEOID: NAVD88 2018  
GRID: NORTHING: 672643.825 EASTING: 1834292.545

RECORD: P.O.T.  
FROM 1963 PLAN  
STA 127+00  
FD 3 1/2" DISK  
ATOP CBAR  
CL10  
1/28/21, DSA

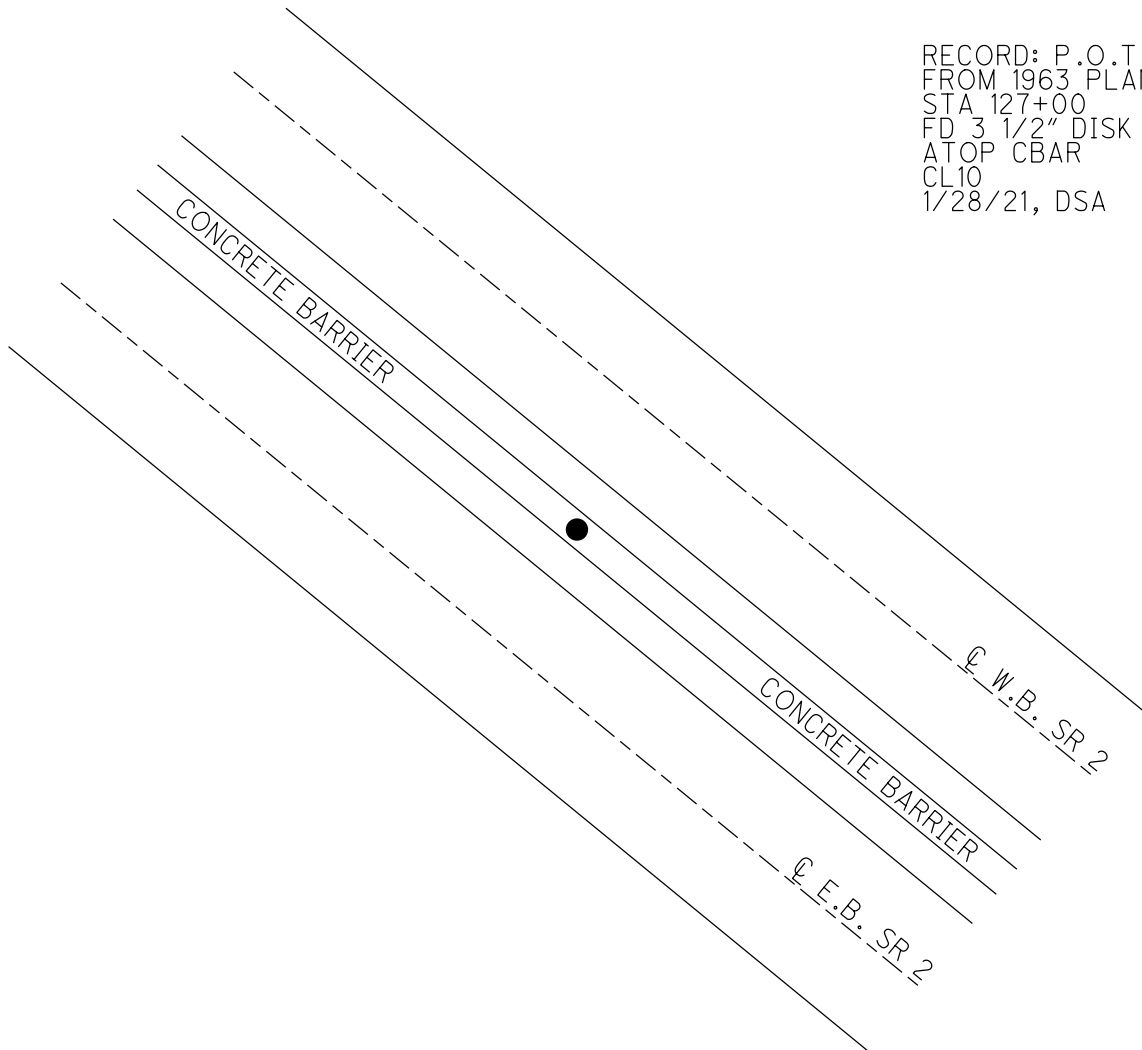

PERSONNEL TITLE PERSONNEL TITLE

SHEET NO. 4

COUNTY Ottawa

DATE 1-3-73

S. R. 2

WEATHER Cold-clear

SEC. 16.48

TEMP. 35.0

DESCRIPTION Sec-2 Bay Twp.

LEFT

CENTER LINE

RIGHT

JOB NO.

P.O.T.

176+00

Mon. Box set in conc.

P.O.T.

168+00

Mon. Box set in conc.

P.O.T.

160+00

Mon. Box set in conc.

P.O.T.

157+00

Mon. Box set in conc.

P.O.T.

143+00

Mon. Box set in conc.

P.O.T.

135+00

Mon. Box set in conc.

P.O.T.

127+00

Mon. Box set in conc.

