

O.D.O.T. DISTRICT 2 SURVEY OFFICE (USE ONLY)

PERSONNEL

REFERENCE NO. 58

SHEET 24 OF 45

NOTES RHOADES

DATE 1/19/21

ROUTE SR 2

H.C. AUBLE

WEATHER CLOUDY

COUNTY OTTAWA

R.C. _____

TEMP. 30°

TOWNSHIP BAY

DWG BY NIESE

PID 107959

SECTION 12

T 6 N R 16 E

TYPE MONUMENT CMON

ON SURFACE - ~~BELOW~~ ON

OFFSET 0 PAVEMENT ON LT : RT

- TO - EDGE PAVEMENT

STATION: 1064+00.59

HORZ.DATUM: NAD83(2011)

GEOID: NAVD88 2018

GRID: NORTHING: 667531.057

EASTING: 1841818.838

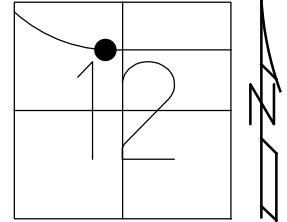

RECORD: P.T.
FROM 1963 PLAN
STA 219+88.37
STA 220+12
FD CMON
W/ 1/2" ROD
1/5/73
FD CMON
CL20
1/19/21, DSA

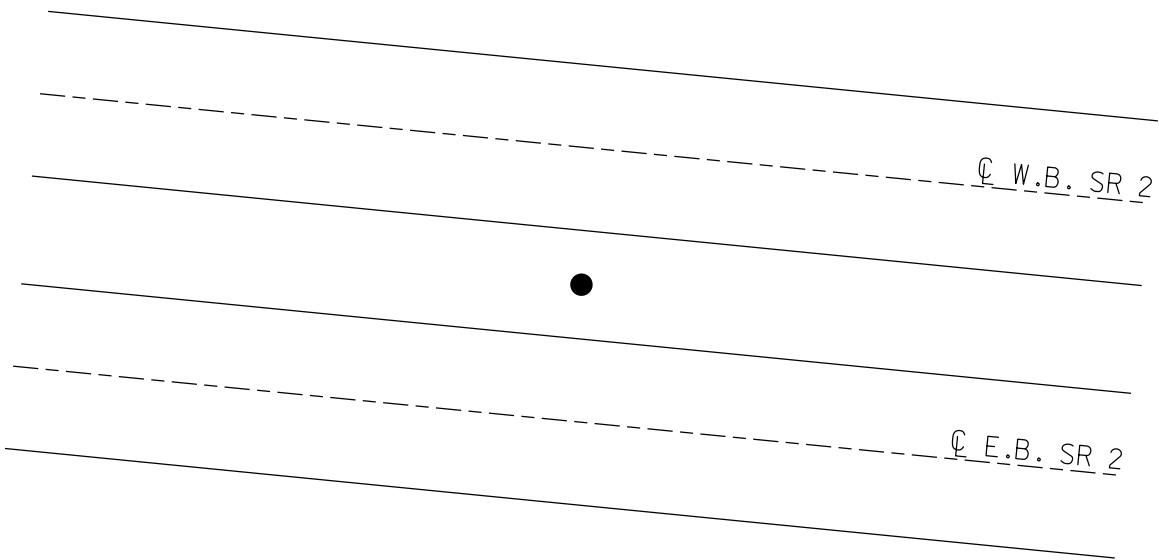

PERSONNEL TITLE PERSONNEL TITLE
 Schneider _____
 Mosser _____
 Barbour _____
 Geyman _____

COUNTY Ottawa DATE 1-5-73
 S. R. 2 WEATHER cloudy-windy
 SEC. 19.60 TEMP. 20°

DESCRIPTION sec 2-11 & 12 Bay Twp. JOB NO. _____

