

O.D.O.T. DISTRICT 2 SURVEY OFFICE (USE ONLY)

PERSONNEL

REFERENCE NO. 61

SHEET 26 OF 45

NOTES RHOADES

DATE 1/19/21

ROUTE SR 2

H.C. AUBLE

WEATHER CLOUDY

COUNTY OTTAWA

R.C. _____

TEMP. 30°

TOWNSHIP PORTAGE

DWG BY NIESE PID 107959

SECTION 7

T 6 N R 17 E

TYPE MONUMENT CMON

ON SURFACE - ~~BELOW~~ ON

OFFSET $\text{\textcircled{C}}$ PAVEMENT ON LT : RT

- TO - EDGE PAVEMENT

STATION: 1094+12.19

HORIZ.DATUM: NAD83(2011)

GEOID: NAVD88 2018

GRID: NORTHING: 667593.298

EASTING: 1844829.820

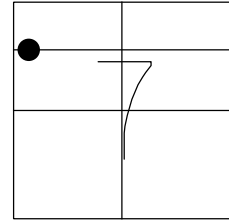

RECORD: P.O.T.
STA 249+56
FD CMON
W/ 1/2" ROD
1/18/73
FD CMON
CL22
1/21/21, DSA

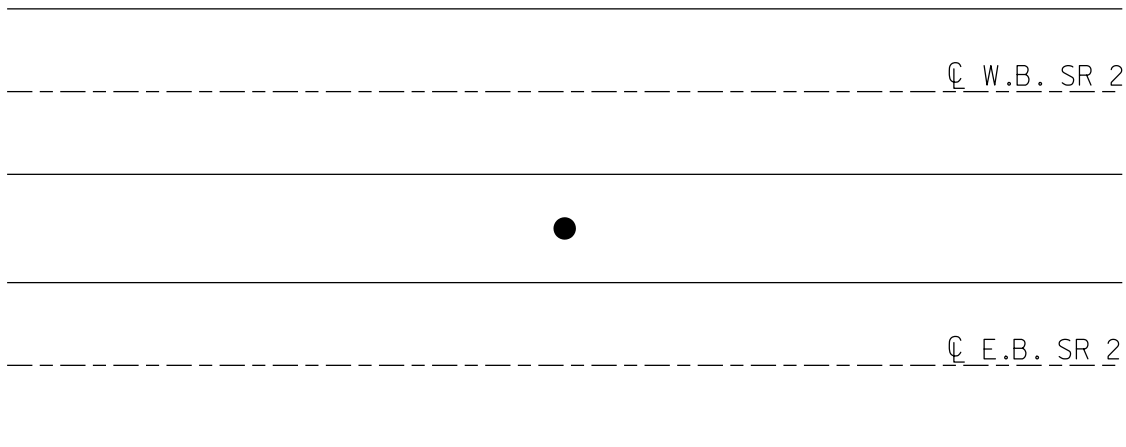

PERSONNEL TITLE PERSONNEL TITLE

Schneider
Mossler
Barbault
Geyman

COUNTY Ottawa DATE 1-18-73

S. R. 2 WEATHER Fair

SEC. 19.60 TEMP. 5.0°

DESCRIPTION sec 1267 Portage Twp. JOB NO.

P.O.T.
249+56
1/2" Rod in
Conc-Mon

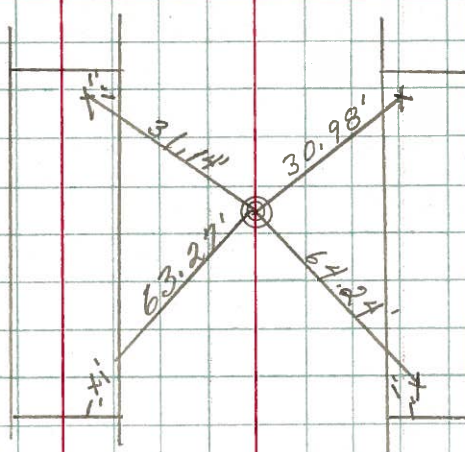

P.O.T.
240+00
1/2" Rod
in Conc-Mon.

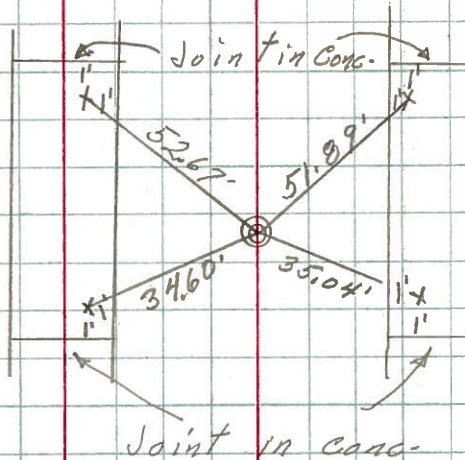

P.O.T.
230+00
Conc-Mon.
with 1/2" Iron pin

