

O.D.O.T. DISTRICT 2 SURVEY OFFICE (USE ONLY)

PERSONNEL

REFERENCE NO. 68

SHEET 31 OF 45

NOTES RHOADES

DATE 1/29/21

ROUTE SR 2

H.C. AUBLE

WEATHER CLOUDY

COUNTY OTTAWA

R.C. \_\_\_\_\_

TEMP. 30°

TOWNSHIP PORTAGE

DWG BY NIESE

PID 107959

SECTION 8

T 6 N R 17 E

TYPE MONUMENT CMON

ON SURFACE - ~~BELOW~~ ON

OFFSET Q PAVEMENT ON LT : RT

- TO - EDGE PAVEMENT

STATION: 1150+87

HORZ. DATUM: NAD83(2011)

GEOID: NAVD88 2018

GRID: NORTHING: 667496.289

EASTING: 1850502.980

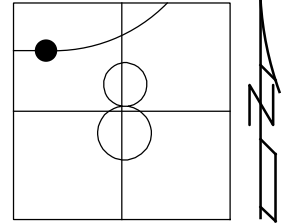

RECORD: P.C.  
FROM 1963 PLAN  
STA 307+12.24  
FD CMON  
W/ 1/2" ROD  
1/18/73  
FD CMON  
CL27  
1/21/21, DSA

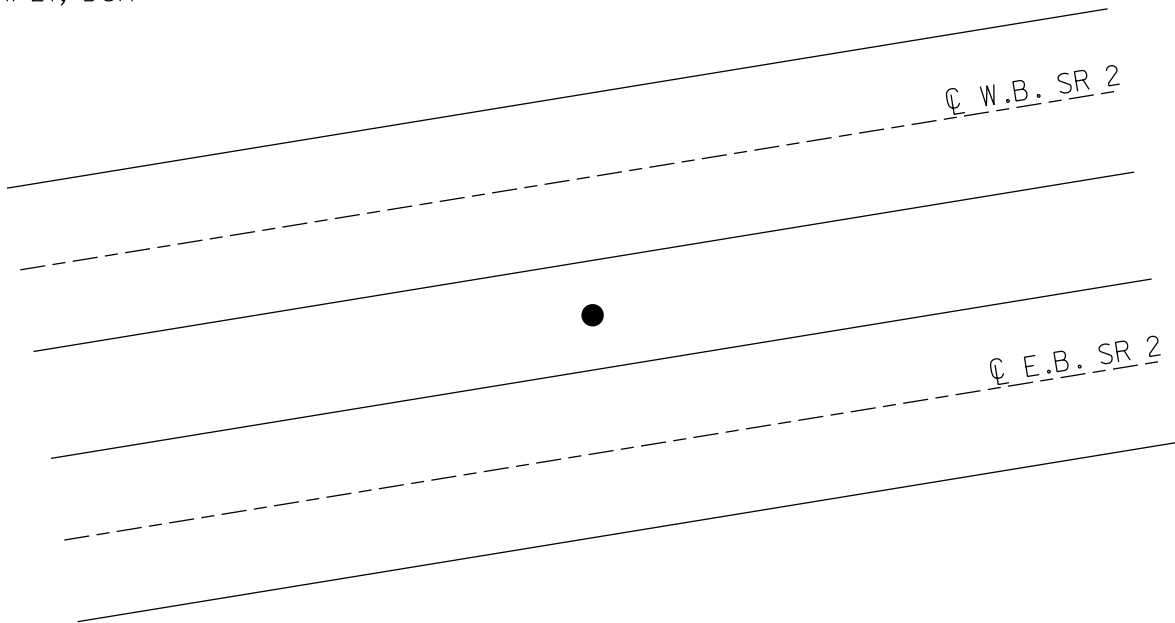

PERSONNEL TITLE PERSONNEL TITLE

COUNTY Ottawa DATE 1-18-73

S. R. 2 WEATHER Fair-windy

SEC. 19.60 TEMP. 55°

DESCRIPTION Sec. 8 Portage Twp. JOB NO.

LEFT CENTER LINE RIGHT

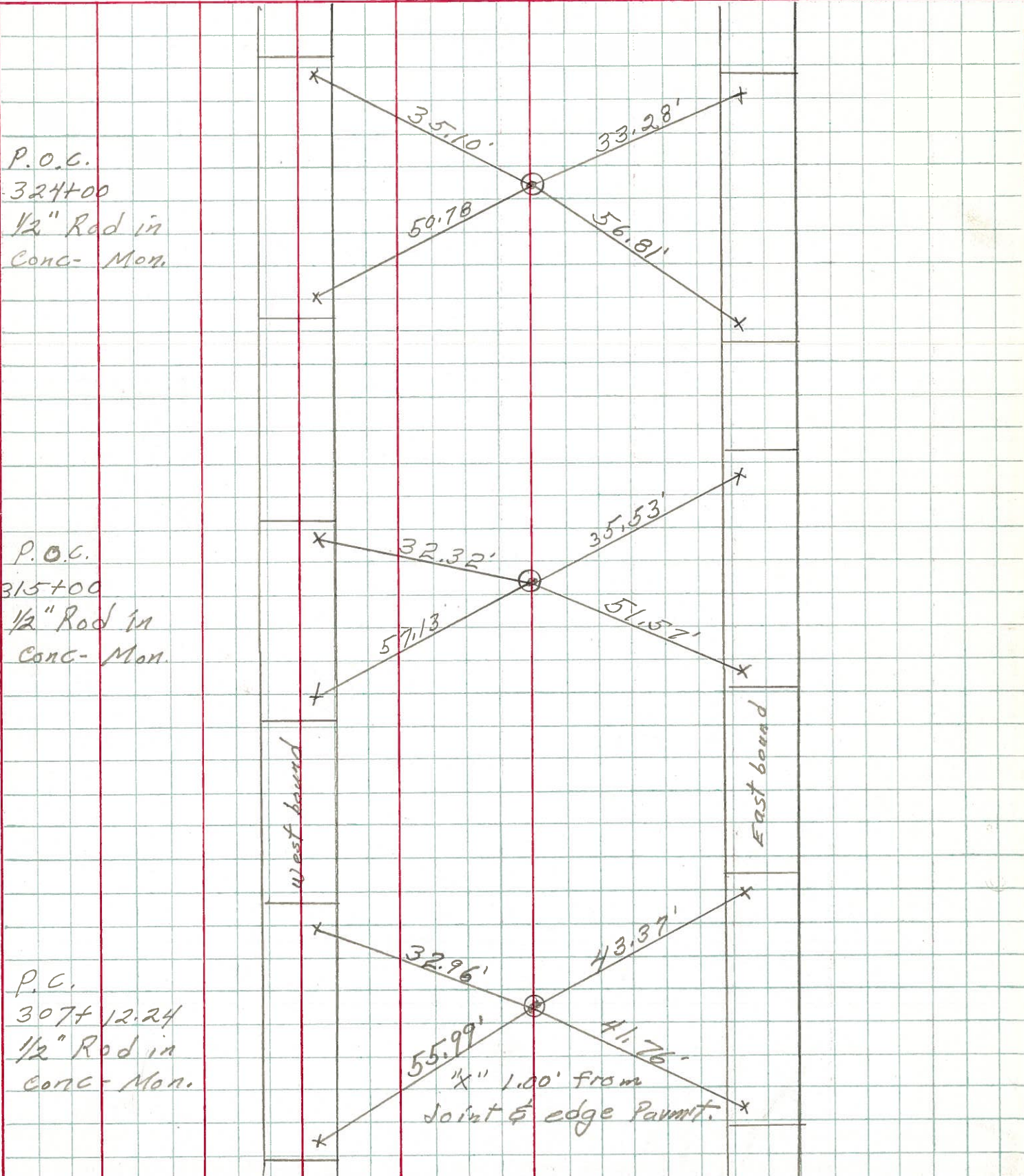

P.O.C.  
324+00  
1/2" Rod in  
Conc- Mon.

P.O.C.  
315+00  
1/2" Rod in  
Conc- Mon.

P.C.  
307+12.24  
1/2" Rod in  
Conc- Mon.

west bound

East bound

"x" 1.00' from Joint & edge Permit.